

953371-1

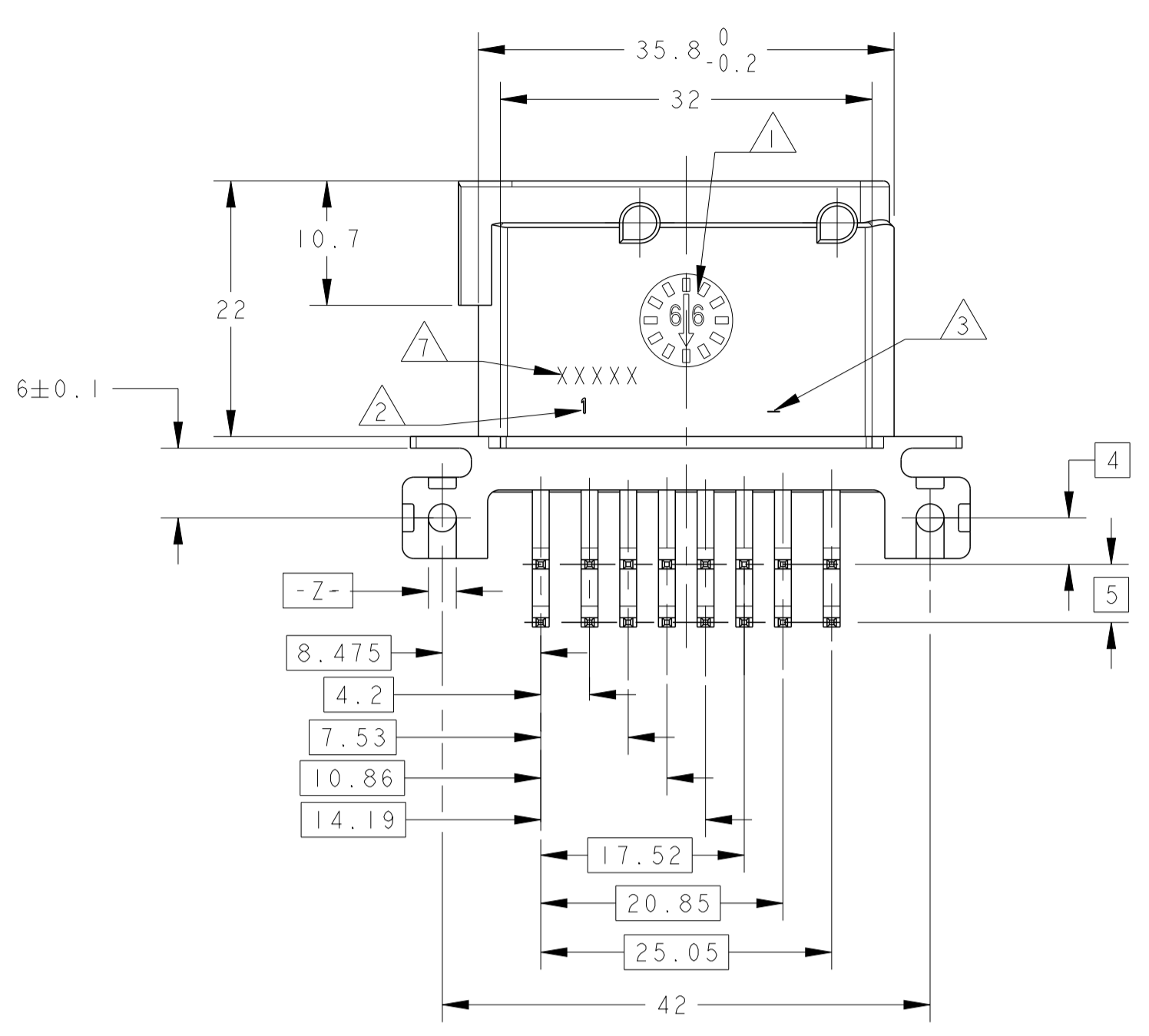

- NOTES:
- 1 CODING DATE
Date code
 - 2 CAVITY MARKING
N° d'empreinte du moule
 - 3 MOULE REVISION
Revision du moule
 - 4 TE LOGO
Logo TE
 - 5 TE ASSEMBLY PART NUMBER: 953371
Reference TE du produit assemblé: 953371
 - 6 MATERIAL: PBT/VALOX-20GF
Matiere: PBT/VALOX-20GF
 - 7 ASSEMBLY DATE MARKING
YY- LAST 2 DIGIT OF YEAR
WW- MANUFACTURING WEEK/ CALENDAR WEEK
D- DAY OF WEEK, SUNDAY=1
ex: 28 aug 2019 > 19354
Marquage de date d'assemblage au format AASSJ
AA- 2 dernier chiffre de l'année
SS- numeros des semaines
J- jour de la semaine, dimanche =1
ex: 28 Aout 2019 > 19354

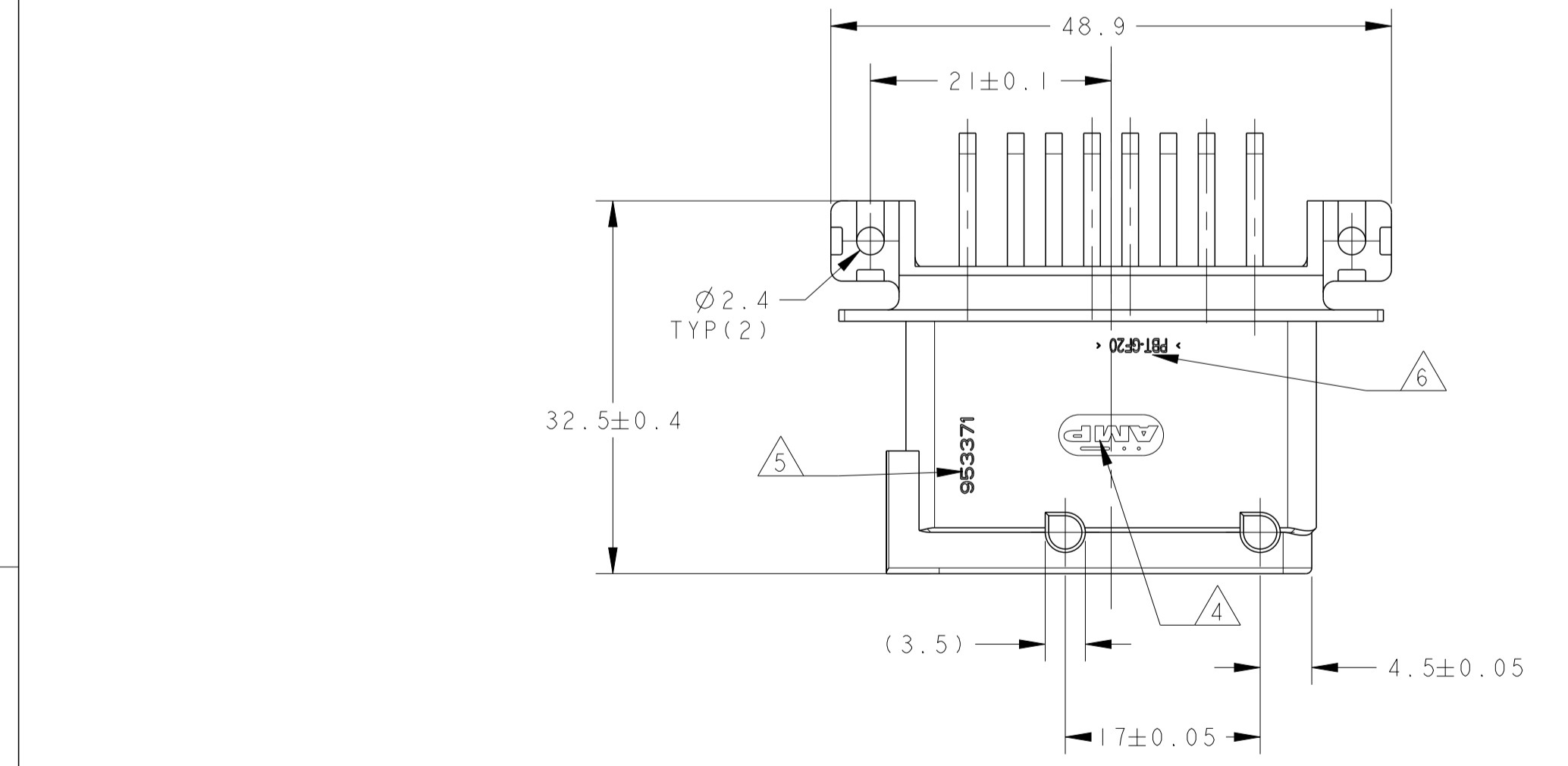
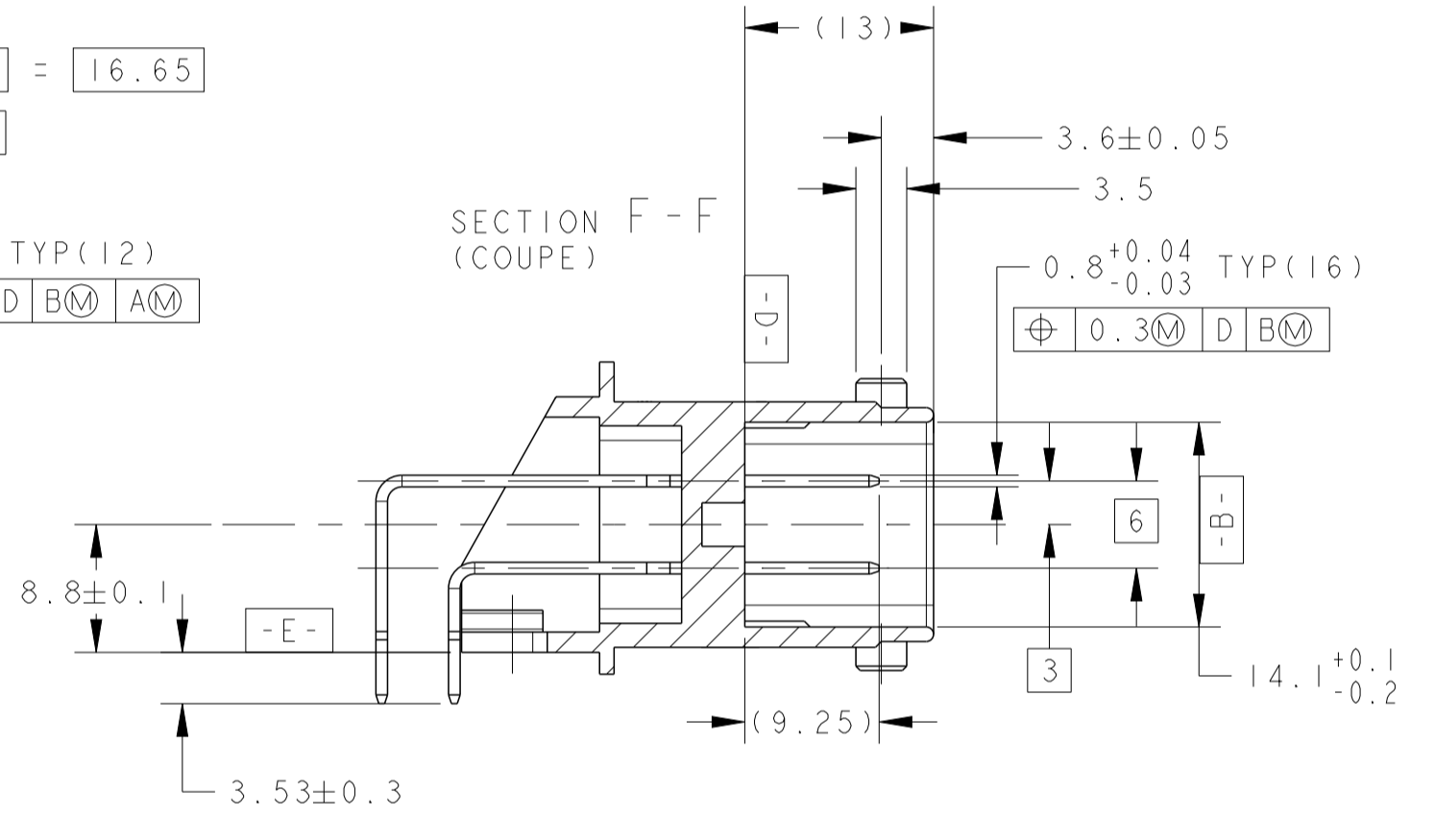
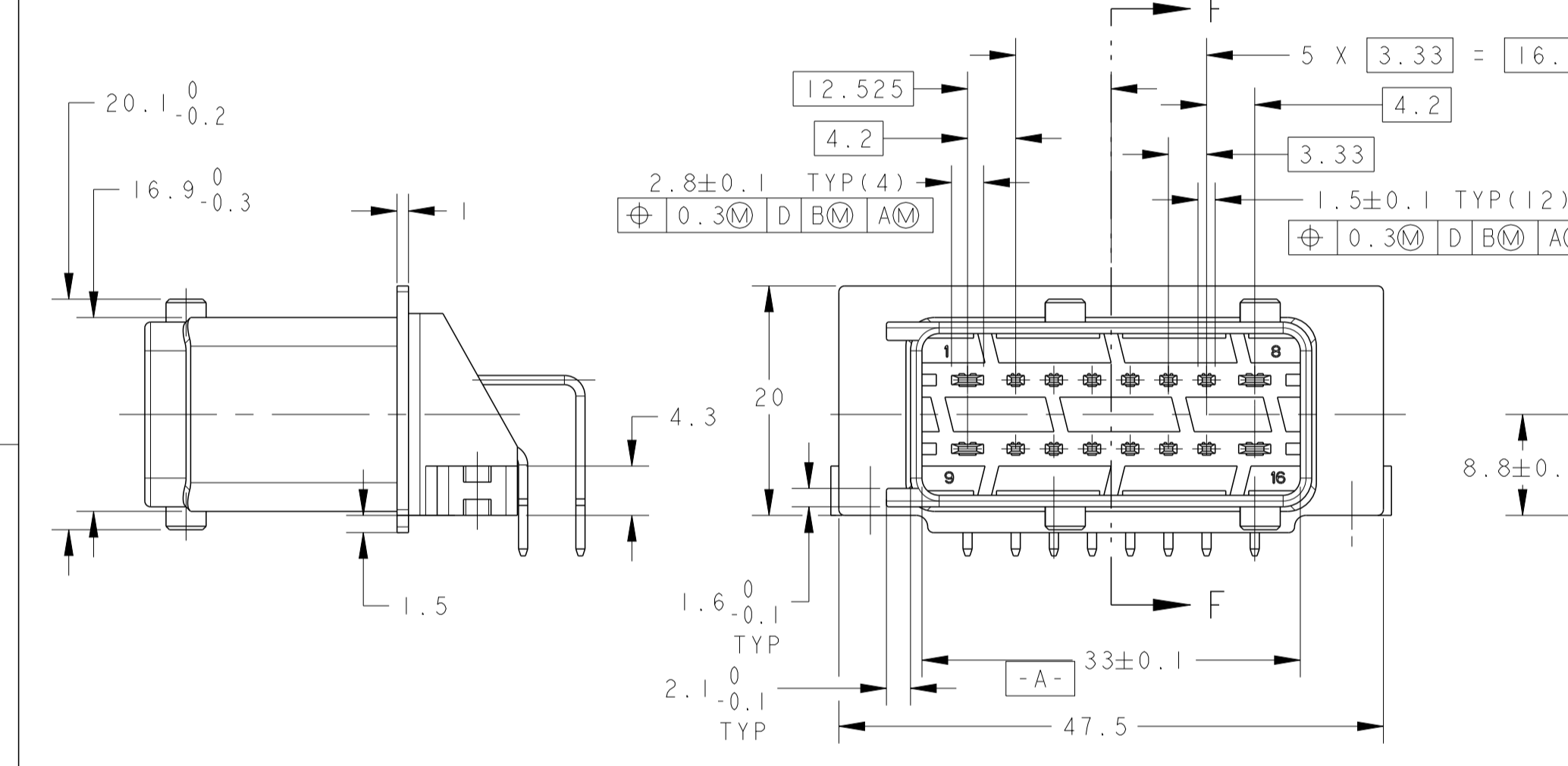

CODINGS (DETROMPAGES)			
953371-1 BLACK (NOIR)	ECHELLE 1:1	953371-4 WHITE (BLANC)	ECHELLE 1:1
953371-2 GREEN (VERT)	ECHELLE 1:1	953371-5 BROWN (MARRON)	ECHELLE 1:1
953371-3 BLUE (BLEU)	ECHELLE 1:1	953371-6 GREY (GRIS)	ECHELLE 1:1

QTY (QTE)	FINITION	MATERIAL (MATIERE)	DESIGNATION
12	POST-TIN (POST-ETAME)	BRASS (LAIION)	TAB 1.5 X 0.8 (LANGUETTE 1.5 X 0.8)
4	POST-TIN (POST-ETAME)	BRASS (LAIION)	TAB 2.8 X 0.8 (LANGUETTE 2.8 X 0.8)
1	-	PBT 20GF	16 W HOUSING (BOITIER 16 V)

REVISIONS						
P	LTN	REV	DESCRIPTION MODIFICATIONS	DATE	OWN	APPR
D			UP DATE THE DRAWING (MISE A JOUR)	02 NOV 04	NT, N	J, L
E			OBSOLETE SUFFIXE -2 / -5 / -6	11AUG2014	RC	JL
F			CHANGE DATE CODE	17OCT2019	RC	JL

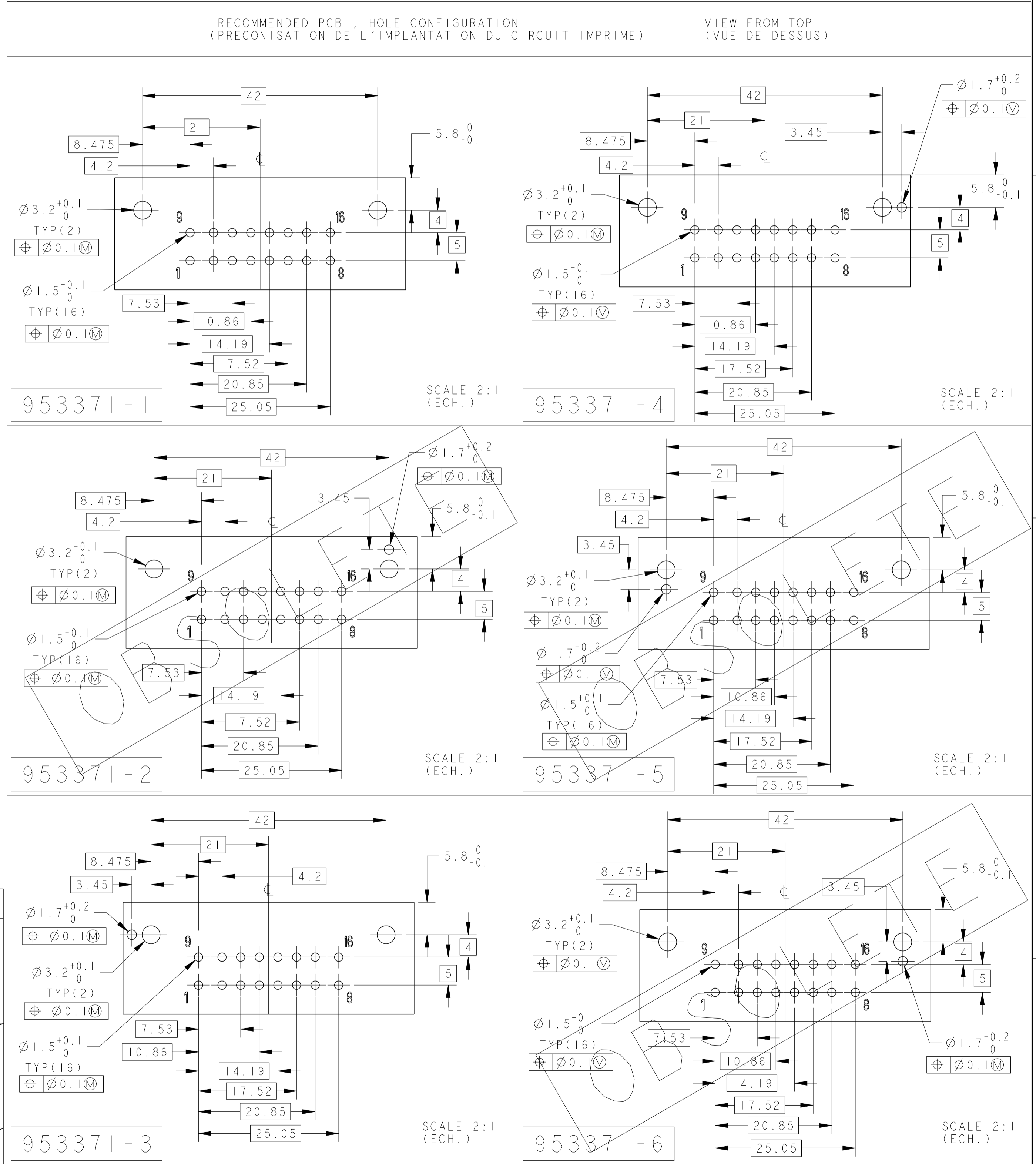

THIS DRAWING IS A CONTROLLED DOCUMENT. CE PLAN EST UN DOCUMENT CONTROLLE PAR AMF INCORPORATED. IL EST OBSOLETE SI LE REVUE, CONTACTER LE SERVICE TECHNIQUE D'AMF DE FRANCE POUR OBTENIR LA DERNIERE REVISION.		DIMENSIONS: mm		TOLERANCES UNLESS OTHERWISE SPECIFIED (TOLERANCES NON SPECIFIEES SUIVANT LE DECIMALS): mm ±0.2 ±0.1 ±0.05 ±0.025		FINISH: ±0.5		MATERIAL: -	
DWG/DESSIN: 03MARS98		INT. NGUYEN		CHECKER/VERIFIE: J. LAQUERRE		APPROVED/APPROUVE: -		NAME/TITRE: -	
CUSTOMER DRAWING /PLAN CLIENT		UNIFORMITY /ECHELLE 2:1		SCALE /ECHELLE 2:1		SHEET /FEUILLE 1 OF 1		REV F	