

# IndustrialNet™ M12 X-Code to RJ45 Panel Mount Adapters

# PANDUIT®

SPECIFICATION SHEET

## specifications

M12 X-code to RJ45 industrial adapters shall be applicable for use in manufacturing as well as other industrial environments and shall meet or exceed the requirements of the ANSI/TIA-568-C.2 Category 6A, ISO 11801 Class E<sub>A</sub>, IEC 61076-2-109 and ODVA Ethernet/IP<sup>^</sup>, PROFINET, and CC-Link standards. The adapter is available in straight and angled versions. The adapter shall incorporate an ingress protection rating of IP20 on the RJ45 side and IP67 on the M12 side when mated.



## technical information

<b>Electrical/mechanical performance:</b>	Exceeds channel requirements of ANSI/TIA-568-C.2 Category 6A and ISO 11801 Class E <sub>A</sub> at swept frequencies up to 500 MHz; meets the requirements of the ODVA EtherNet/IP <sup>^</sup> , PROFINET and CC-Link standards
<b>IEC compliance:</b>	Meets IEC 61076-2-109
<b>IP compliance:</b>	Rated IP20 (RJ45) and IP67 (M12 side)
<b>UL compliance:</b>	Compliant
<b>RoHS compliancy status:</b>	Compliant
<b>Temperature rating:</b>	Operating -25°C to 80°C (-13°F to 176°F) Storage -40°C to 85°C (-40°F to 185°F)
<b>Configuration:</b>	Connector 1 - RJ45 Jack, Connector 2 - M12 Jack
<b>Cable Access:</b>	Angled/Straight
<b>Packaging:</b>	1 unit per polyethylene bag, 15 units per carton

## key features and benefits

<b>PA UL V0 housing with 360° shielding:</b>	Ensures secure data transmission in high noise (EMI/RFI) environments for optimal performance
<b>Field attachable:</b>	Can be terminated without any special tools for fast installation
<b>Suitable for harsh environments:</b>	Withstands light wash down situations and operates in an extended temperature range for use in demanding applications

## applications

The IndustrialNet™ M12 X-Code to RJ45 Panel Mount Adapter connects the M12 industrial Ethernet with the RJ45 network. A key component to the overall industrial Ethernet application, the adapter is the interface that protects the integrity of the Ethernet data transfer

from the switch or PLC out to the devices or up to the horizontal plant backbone. The adapter is fully shielded for use in high noise (EMI/RFI) environments and is appropriate for data transmissions up to 10 Gb/s per IEEE802.3an.

## IndustrialNet™ M12 X-Code to RJ45 Panel Mount Adapters

<b>Straight adapter:</b>	ICAM12XRJS
<b>90° angled adapter:</b>	ICAM12X90RJS
<b>IndustrialNet™ Category 6 S/FTP Copper Cable – Flame Retardant, Halogen-Free</b>	
<b>4-pair, color yellow:</b>	ISX6004AYL-LED
<b>4-pair, color red:</b>	ISX6004ARD-LED
<b>IndustrialNet™ Category 5e SF/UTP Copper Cable – TPE Jacket</b>	
<b>CM 4-pair, color teal:</b>	ISFCH5C04ATL-XG
<b>IndustrialNet™ Category 6A/6/5e RJ45 Field Terminable Plug</b>	
<b>Field terminable plug:</b>	ISPS688FA
<b>IndustrialNet™ M12 X-Code Field Terminable Plug</b>	
<b>Field terminable plug:</b>	ISPS6A88MFA
<b>IndustrialNet™ Category 5e Shielded 600 V-Rated Patch Cords</b>	
<b>CM/CMX, color Teal:</b>	ISTPHCH1MTL*
<b>IndustrialNet™ DIN Rail Mount Patch Panel</b>	
<b>8-port:</b>	CDPP8RG
<b>Mini-Com® DIN Rail Mount Adapter</b>	
<b>1-port:</b>	CADIN1IG**

\* For other lengths, change the length designation (1M) of the part number to the desired length (0.3M, 0.6M, 2M, 3M, 5M, or 10M); to designate color, replace TL (Teal) suffix with BL (Black), RD (Red), or YL (Yellow). For example, the part number of a 2-meter teal patch cord is ISTPHCH2MTL.

\*\* For standard colors other than International Gray, replace IG in part number with BL (Black), EI (Electric Ivory), IW (Off White), or WH (White).

<sup>^</sup>EtherNet/IP is a trademark of ODVA.

# IndustrialNet™ M12 X-Code to RJ45 Panel Mount Adapters

## Dimensions

### ICAM12XRJS - Industrial M12 X-Code, 8 pin Female to RJ45 Cat 6A Jack Straight

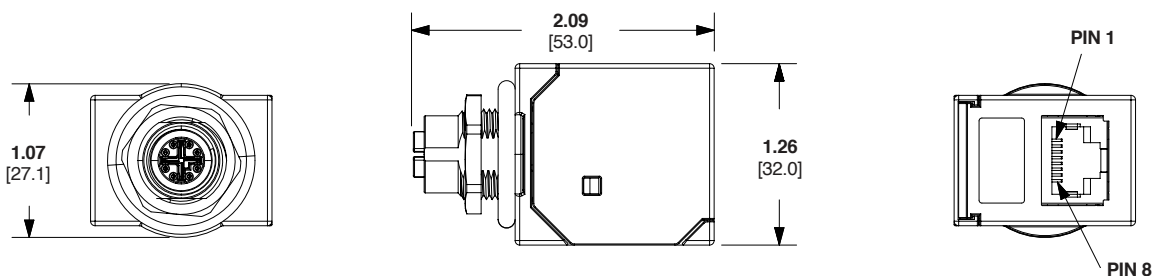

### ICAM12X90RJS - Industrial M12 X-Code, 8 pin Female to RJ45 Cat 6A Jack 90-Degree

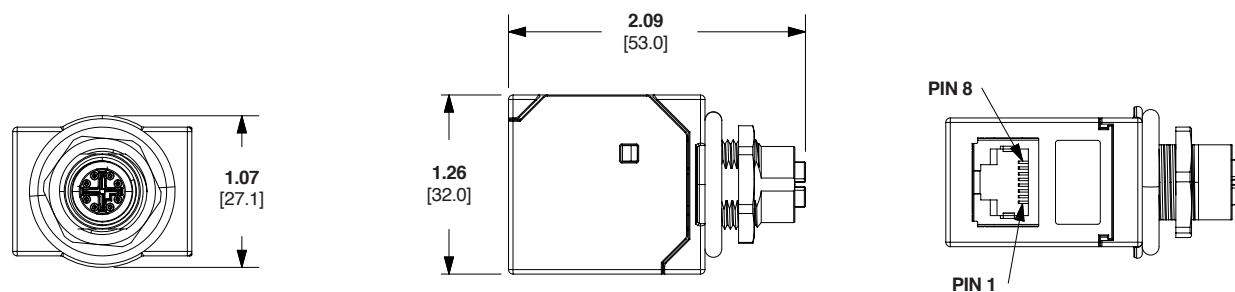

### Pin Assignments and Recommended M12 Panel Cut-Out

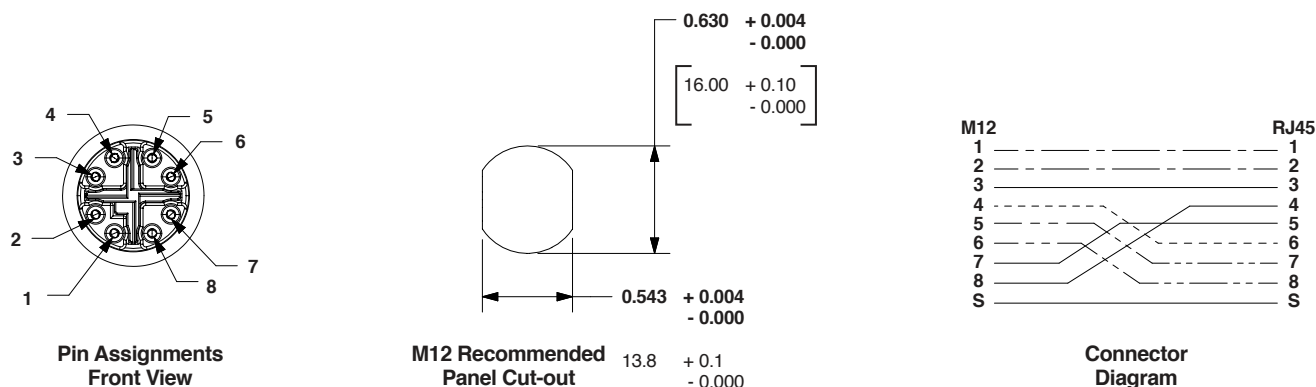

Dimensions are in inches. [Dimensions in brackets are metric.]

#### WORLDWIDE SUBSIDIARIES AND SALES OFFICES

PANDUIT US/CANADA  
Phone: 800.777.3300

PANDUIT EUROPE LTD.  
London, UK  
Phone: 44.20.8601.7200

PANDUIT SINGAPORE PTE. LTD.  
Republic of Singapore  
Phone: 65.6305.7575

PANDUIT JAPAN  
Tokyo, Japan  
Phone: 81.3.6863.6000

PANDUIT LATIN AMERICA  
Guadalajara, Mexico  
Phone: 52.33.3777.6000

PANDUIT AUSTRALIA PTY. LTD.  
Victoria, Australia  
Phone: 61.3.9794.9020

For a copy of Panduit product warranties, log on to [www.panduit.com/warranty](http://www.panduit.com/warranty)

# PANDUIT®

Visit us at [www.panduit.com/ia](http://www.panduit.com/ia)

[iai@panduit.com](mailto:iai@panduit.com)

©2019 Panduit Corp.  
ALL RIGHTS RESERVED.  
COSP413--WW-ENG  
3/2019