

THIS DRAWING IS A CONTROLLED DOCUMENT FOR AMP INC. IT IS SUBJECT TO CHANGE AND THE CONTROLLING ENGINEERING ORGANIZATION SHOULD BE CONTACTED FOR THE LATEST REVISION.

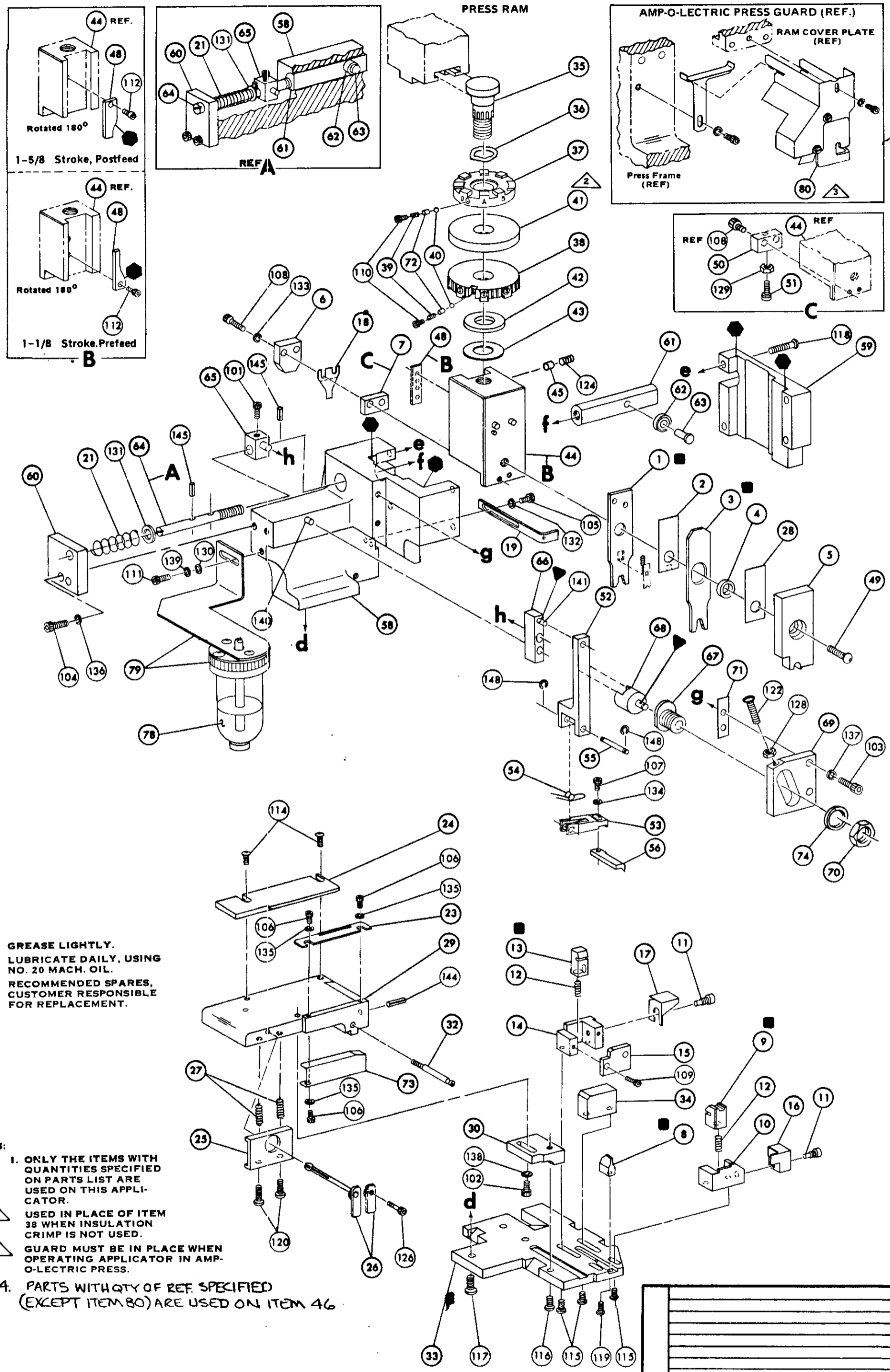

KEY:
 ● GREASE LIGHTLY.
 ● LUBRICATE DAILY, USING NO. 20 MACH. OIL.
 ■ RECOMMENDED SPARES, CUSTOMER RESPONSIBLE FOR REPLACEMENT.

NOTES:
 1. ONLY THE ITEMS WITH QUANTITIES SPECIFIED ON PARTS LIST ARE USED ON THIS APPLICATOR.
 2. USED IN PLACE OF ITEM 38 WHEN INSULATION CRIMP IS NOT USED.
 3. GUARD MUST BE IN PLACE WHEN OPERATING APPLICATOR IN AMP-O-LECTRIC PRESS.
 4. PARTS WITH QTY OF REF SPECIFIED (EXCEPT ITEM 80) ARE USED ON ITEM 46.

REF	PART NO.	DESCRIPTION	NO.	REQ.	PART NO.	DESCRIPTION	NO.
	162	REF 690517-1	SPACER		71		
	161	22594-8	NUT, HEX		70		
	160	240628-1	PLATE, ADJUSTMENT		69		
	159	240626-1	SHAFT, PIVOT		68		
	158	240633-1	BUSHING		67		
	157	455680-1	LEVER, INTERMEDIATE		66		
	156	240629-1	BLOCK, PIVOT		65		
	155	240632-2	SCREW, ADJUSTMENT, FEED ROD		64		
	154	240659-3	PIN, CAM ROLLER		63		
	153	240658-1	ROLLER, CAM		62		
	152	454398-2	ROD, FEED		61		
	151	454178-1	GUIDE, FEED ROD		60		
	150	454220-1	CAP, HOUSING		59		
	149	REF 454485-1	HOUSING		58		
REF	21045-3	RING, RETNG "C" (.187 DIA) FEED FINGER PIN			57		
	147	1 690542-2	PAWL, FEED		56		
	146	REF 240624-1	PIN, FEED FINGER		55		
REF	5- 21028-1	PIN, SLTD SPRING (.125 DIA x .50) ADJ ROD			54		
1	4- 21028-0	PIN, SLTD SPRING (.093 DIA x .75) S. G. PL			53		
	145	REF 691499-1	SPRING, FEED FINGER		52		
	144	REF 690541-1	FINGER, FEED		51		
	143	REF 455679-1	LEVER, TERMINAL FEED ARM		50		
	142	1 811242-2	BUMPER, HOLLOW		49		
REF	1- 21030-1	PIN, DOWEL (.187 DIA x .50) LEVER			48		
REF	1- 21030-6	PIN, DOWEL (.187 DIA x 1.25) HOUSING			47		
1	21024-5	WASHER, LOCK (NO. 10) LUB ASSY			46		
1	21024-5	WASHER, LOCK (NO. 10) STRIP GUIDE ADJ BLK			45		
REF	21024-5	WASHER, LOCK (NO. 10) ADJ PLATE			44		
REF	21024-5	WASHER, LOCK (NO. 10) FEED GUIDE ROD			43		
3	21057-2	WASHER, LOCK (NO. 4) FRONT STRIP GUIDE			42		
1	21024-4	WASHER, LOCK (NO. 8) FEED FINGER			41		
Z	21024-4	WASHER, LOCK (NO. 8) DEPRESSOR			40		
1	21024-4	WASHER, LOCK (NO. 8) STRIPPER			39		
REF	21899-4	WASHER, FLAT (5/16 DIA) SCREW ADJ			38		
1	21899-2	WASHER, FLAT (NO. 10) LUB ASSY			37		
1	21068-5	NUT, HEX MACH (6-32) HOLDDOWN			36		
REF	21068-5	NUT, HEX MACH (6-32) FEED ADJ			35		
	127	1 22480-5	WASHER, SPRING		34		
	126	1 690212-1	POST, RAM		33		
	125	1 690786-6	SUPPORT, TERMINAL		32		
1	21009-2	SCREW, SKT SET (1/4-20 x .25) (NYLOK) RAM			31		
	123	1 690432-3	SCREW, ADJUSTMENT		30		
REF	3- 21064-2	SCREW, RD HD MACH (6-32 x 1.50) FEED ADJ			29		
	122				28		
2	2- 21002-9	SCREW, BTN HD SKT CAP (10-32 x .75) DRAG			27		
1	22733-8	SCREW, BTN HD SKT CAP (8-32 x .38) ANVIL			26		
REF	2- 21002-9	SCREW, BTN HD SKT CAP (10-32 x .75) CAP			25		
REF	1- 24073-9	SCREW, BTN HD SKT CAP (NYLOK) 1/4-20 x .75 HSG			24		
REF	2- 21002-7	SCREW, BTN HD SKT CAP (10-32 x .50) S.G. ADJ BLK			23		
4	2- 21002-2	SCREW, BTN HD SKT CAP (8-32 x .50) SHEAR			22		
2	2- 21002-2	SCREW, BTN HD SKT CAP (8-32 x .50) R. S. G.			21		
	113				20		
1	2- 21003-0	SCREW, FLAT HD SKT CAP (6-32 x .50) CAM			19		
1	3- 21000-4	SCREW, SKT HD CAP (10-32 x .38) LUB ASSY			18		
2	23030-1	SCREW, SKT HD CAP (6-32 x .25) (NYLOK) C.P. DISC			17		
	109	SCREW, SKT HD CAP (6-32 x .) R. SHEAR PLATE			16		
2	221000-8	SCREW, SKT HD CAP (8-32 x .62) DEPRESSOR			15		
1	2- 21000-8	SCREW, HEX HD CAP (8-32 x .31) FEED FINGER			14		
3	1- 21000-3	SCREW, SKT HD CAP (4-40 x .25) F. STRIP GUIDE			13		
1	2- 21000-7	SCREW, SKT HD CAP (8-32 x .50) STRIPPER			12		
REF	3- 21000-7	SCREW, SKT HD CAP (10-32 x .75) FEED ROD G.			11		
REF	3- 21000-6	SCREW, SKT HD CAP (10-32 x .62) FEED ADJ BLK			10		
1	3- 21000-4	SCREW, SKT HD CAP (10-32 x .38) S.G. ADJ BLK			9		
REF	455749-1	GUARD ASSY (WINDOW)			8		
1	1-465184-0	LUBRICATOR ASSY			7		
REF	8529312	OIL SYNTHETIC			6		
	77				5		
	76	1 1-455689-4	DEPRESSOR, SHEAR REAR		4		
	75	1 238011-4	SPACER, TUBULAR, INS CRIMPER		3		
REF	458109-1	WASHER, FLAT, SPECIAL			2		
1	454877-3	PLATE, STRIP GUIDE COVER			1		
2	690603-1	SPRING, ASSIST					

CRIMPING DATA				THIS APPLICATOR WILL APPLY	
PAD LETTER	CRIMP HEIGHT	WIRE SIZE	WIRE STRIP LENGTH	SOX	PIN
A	.068	# 14		66578	66577
B	.059	# 16		66651	66650
C	.052	# 18			
D	NOT	USED			

CRIMP	SIZE	TYPE	FEED	USED ON
WIRE	.090	F		MACH NO.
INSULATION	.120	0	.500	565435-5

INSULATION RANGE	WIRE RANGE	APPLICATOR INSTRUCTION
.080-.105	18-14	8c40

REMARKS: AMP-O-LECTRIC PRE-FEED

SET UP PAGE	LAYOUT NO.	AMP INCORPORATED HARRISBURG, PENNA.
458637-1	679	
DRAWN	APPROVED	LOC A C NO. 687997-2 REV H
BAWLEE	10-29-73	
CHECKED	REL	
10-31-73	11-21-73	

I. D. PLATE (REF): 461264-1

APPLICATOR MINIATURE QUICK CHANGE SIDE-FEED (TYPE II .062 DIA. PIN & SOX.)

REV	DATE	DESCRIPTION
H	0150-6987-96	
G	EQ-A-272390	
F	K-N A 160588	
E3	REV PER ECN	
E2	SUBD BY 461757-2	
E1	ADD ITEM 66650, 66651	
D	REV ITEM 37	
C	REV PER ECN	
B	REV PER ECN	
A	REV PER ECN	
01	ADD'D ITEM 66551 PER ECN	

THIS INFORMATION IS CONFIDENTIAL AND IS DISCLOSED TO YOU ON CONDITION THAT NO FURTHER DISCLOSURE IS MADE BY YOU TO OTHER THAN AMP PERSONNEL, WITHOUT WRITTEN AUTHORIZATION FROM AMP INCORPORATED, HARRISBURG, PA.

DIMENSIONS IN INCHES DO NOT SCALE PRINT