

Table with 4 columns: PART NUMBER, REV, FIRST USED, CARRIER TYPE. Lists parts like 680832-1 CUT, 680832-2 CUT, 680832-3 CUT, 680832-4 NON-CUT.

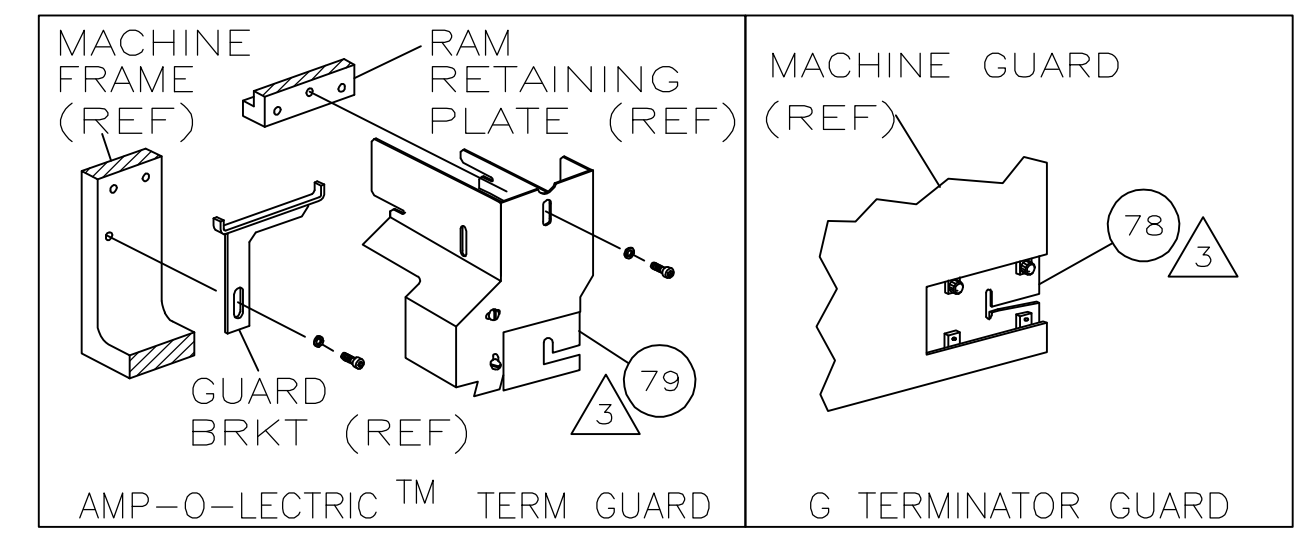

Table with columns: REF, PART NO, DESCRIPTION, ITEM NO. Lists parts like LEADMAKER POST FEED, BENCH MODEL K PRE FEED, BENCH MODEL G PRE FEED.

Table with columns: LOC, DIST, REVISIONS. Shows revision history for description 'SIDE FEED HDM APPLICATOR'.

TERMINAL NAME: 1.5 SYSTEM SEALED CONNECTOR. CRIMP DATA (NON-AMP TERMINAL-MFR SPEC). Table with columns: PAD LTR, CRIMP HEIGHT, WIRE SIZE, CRIMP SIZE, TYPE, RANGE, WIRE, INSUL. Also includes WIRE STRIP LENGTH, TERM APPL SPEC, FEED, APPL INSTRUCTION, SET UP GAGE, LAYOUT.

- RECOMMENDED SPARE PARTS. GREASE LIGHTLY. GUARD MUST BE IN PLACE WHEN OPERATING APPLICATOR IN A BENCH MACHINE. LUBRICATE DAILY USING NO. 20 MACHINE OIL. ITEMS WITH QTY OF REF SPECIFIED (EXCEPT ITEMS 78 AND 79) ARE USED ON ITEM 46. THIS APPLICATOR APPLIES TERMINAL WITH A SEAL. APPLY TORQ-SEAL IN ALLEN SOCKET TO FILL HOLE AFTER FLAT HD HAS BEEN ADJUSTED TO CORRECT HEIGHT AT QUALIFICATION. APPLY #1-23419-5 LOC-TITE TO THREADS. CUT TO LENGTH AT ASSY.

Main parts list table with columns: REF, QTY, PART NO, DESCRIPTION, ITEM NO. Lists numerous components like PIN, WIRE DISC, WASHER, RING, ADJ BLOCK, STRIPPER, SPRING, CAM, and various SCRs.

Continuation of parts list table with columns: REF, QTY, PART NO, DESCRIPTION, ITEM NO. Lists components like NUT, HEX, PLATE, ADJUSTMENT, SHAFT, PIVOT, BUSHING, LEVER, INTERMEDIATE, BLOCK, PIVOT, SCREW, ADJ FEED ROD, PIN, CAM ROLLER, ROLLER, CAM, ROD, FEED, GUIDE, FEED ROD, CAP, RAM, HOUSING, PAWL, FEED, PIN, FEED FINGER, SPRING, FEED FINGER, HOLDER, FEED FINGER, LEVER, TERMINAL FEED ARM, BUMPER, HOLDDOWN, SPACER, TONKER, CAM, PRE-FEED 1 5/8 ST, CAM, PRE-FEED 1 1/8 ST, CAM, POST-FEED 1 5/8 ST, APPLICATOR, BASIC (SUBASSY), PLUG, NYLON, RAM, WASHER, LAMINATED, WASHER, RAM, BOLT, CRIMPER (5/16x1.00), BALL, STEEL, SPRING, COMPRESSION, DISC, INSULATION, WIRE DISC, PLASTIC, WASHER, SPRING, POST, RAM, SUPPORT, TERMINAL, PLATE, BASE, BLOCK, STRIP GUIDE ADJ, STRIP GUIDE PLATE ASSY, SPACER, FRONT SHEAR DEP, SPRING, DRAG, LEVER, DRAG RELEASE, DRAG, TERMINAL, GUIDE, STRIP (REAR), GUIDE, STRIP (FRONT), STRIPPER, SPRING, FEED RETURN, STRIPPER, GUARD, CHIP, FRONT, SHEAR HOLDER (NON-CUT), SPRING, SHEAR, STOP, SHEAR, HOLDER, SHEAR (FRONT), SHEAR, FLOAT (FRONT), ANVIL, DEPRESSOR, SHEAR (FRONT), SPACER, BLOCK CRIMPER, CRIMPER, INSULATION, SPACER, CRIMPER, CRIMPER, WIRE.

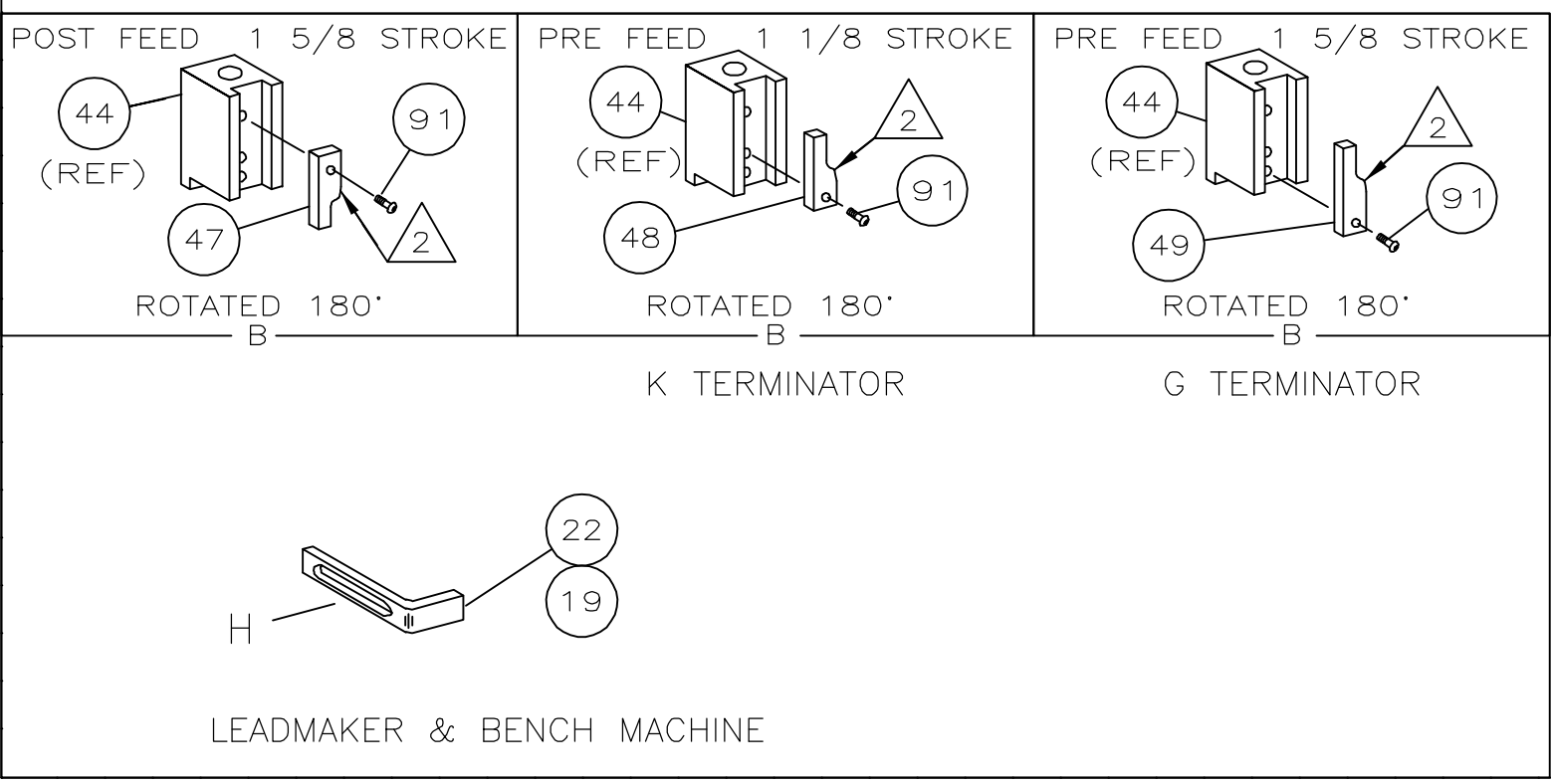

THIS DRAWING IS A CONTROLLED DOCUMENT. DIMENSIONS: INCHES. TOLERANCES UNLESS OTHERWISE SPECIFIED: 0 PLC ± .0005, 1 PLC ± .0005, 2 PLC ± .0005, 3 PLC ± .0005, 4 PLC ± .0005. MATERIAL: -. FINISH: -. WEIGHT: -. APPLICATION SPEC: -. DRAWING NO: A1 00779. CUSTOMER DRAWING. SHEET 1 OF 2 REV C.

LOC		DIST		REVISIONS			
F	LTR	DESCRIPTION	DATE	OWN	APVD		
A	66	SEE SHEET 1					

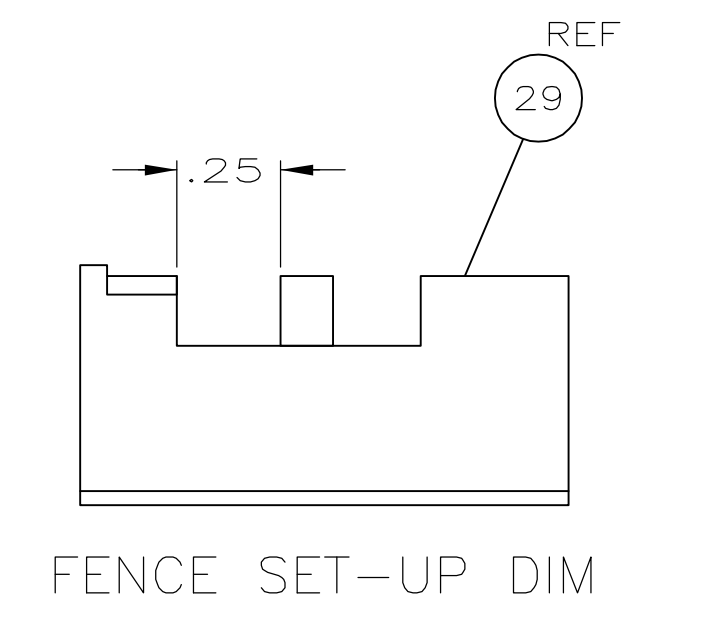
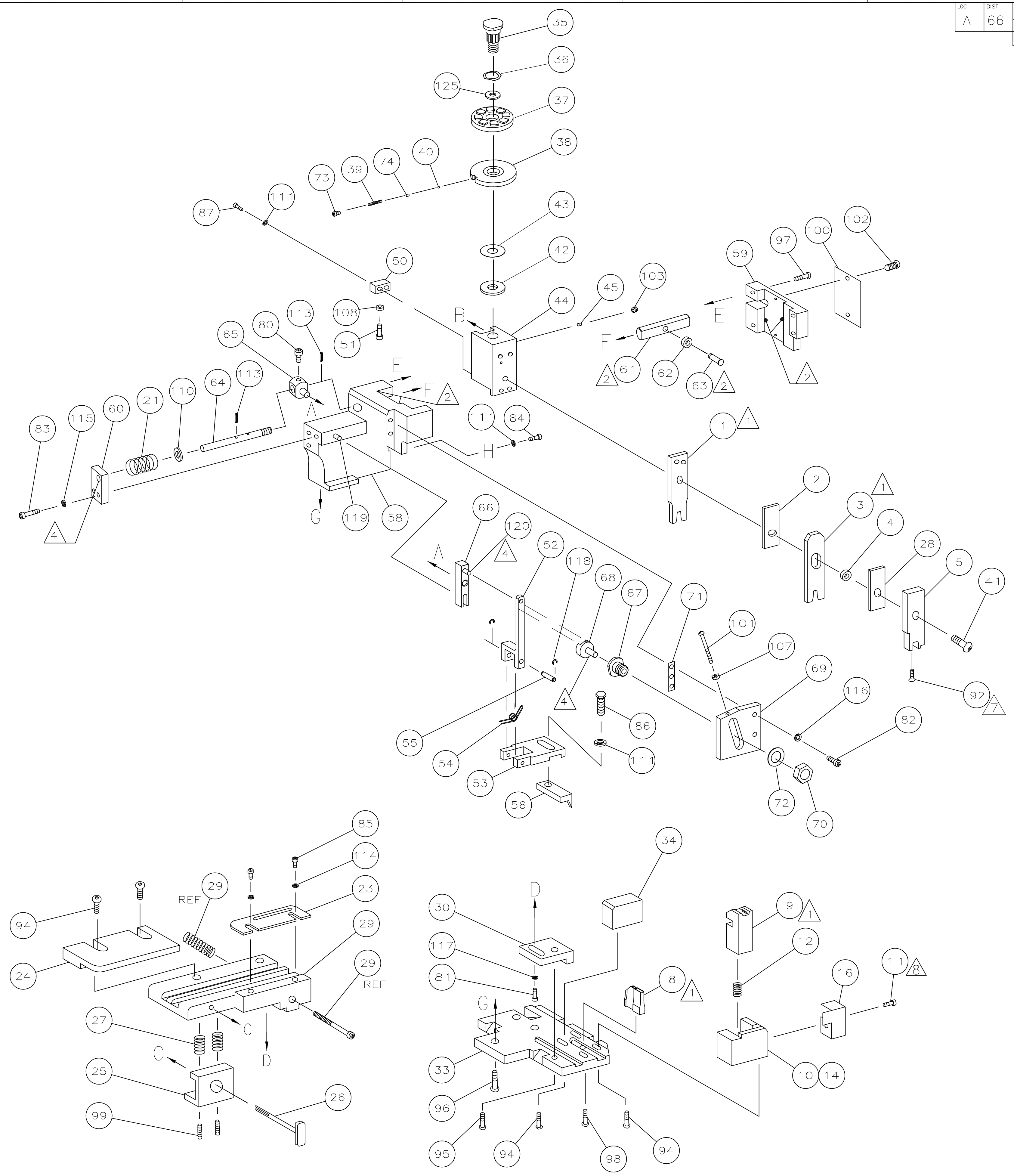
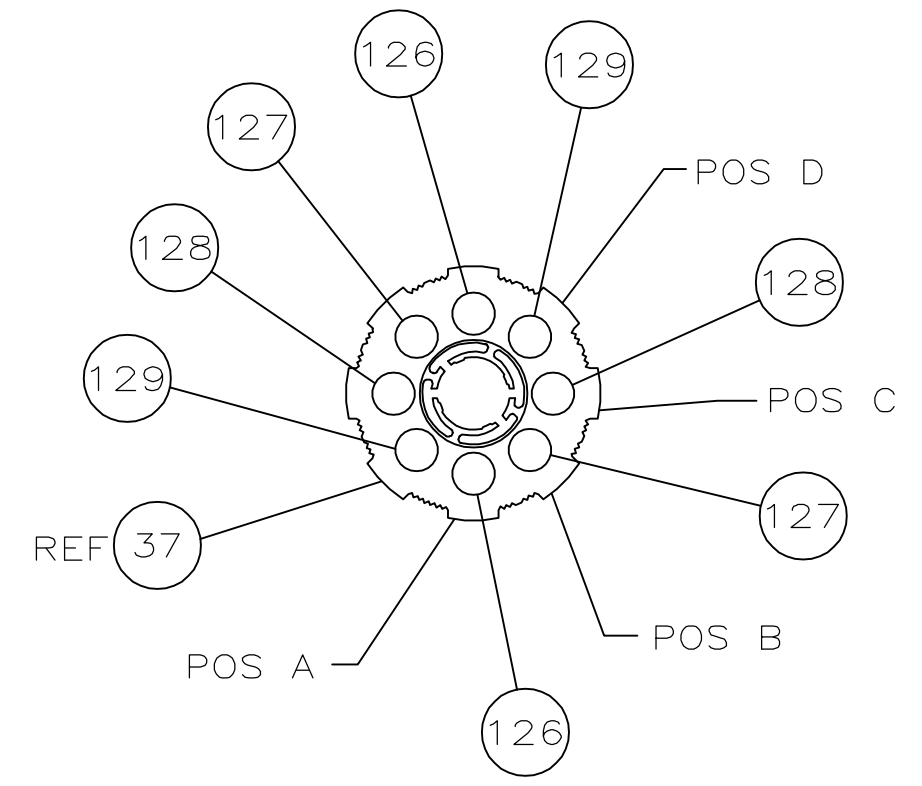

THIS DRAWING IS A CONTROLLED DOCUMENT.		DWN B.HIGMAN 19MAY99		Tyco Electronics Corporation Harrisburg, PA 17105-3608	
DIMENSIONS: INCHES		TOLERANCES UNLESS OTHERWISE SPECIFIED:		APVD T.ELBIN 19MAY99	
0 PLC ± .01		1 PLC ± .01		NAME SIDE FEED HDM APPLICATOR	
1 PLC ± .01		2 PLC ± .02		PRODUCT SPEC	
2 PLC ± .02		3 PLC ± .02		APPLICATION SPEC	
3 PLC ± .02		4 PLC ± .02		SIZE CASE CODE DRAWING NO	
4 PLC ± .02		ANGLES ± .5		RESTRICTED TO	
MATERIAL		FINISH		WEIGHT F	
				A1 00779 C=680832	
				CUSTOMER DRAWING	
				SCALE - SHEET 2 OF 2 REV C	