

PC BOARD VERSIONS		
PRODUCTNR:	PCB THICKNESS	DIM"A"
89035-X01LF	1.6	2.90
89035-X11LF	2.4	3.53

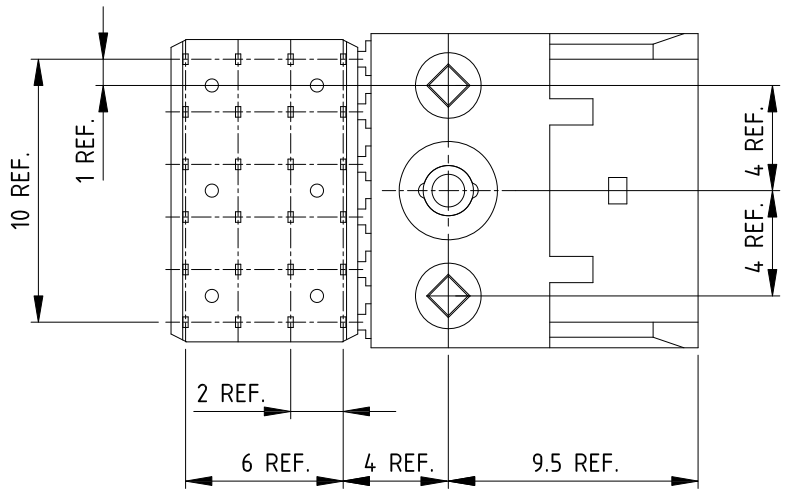

PRODUCT AFTER PC BOARD APPLICATION.

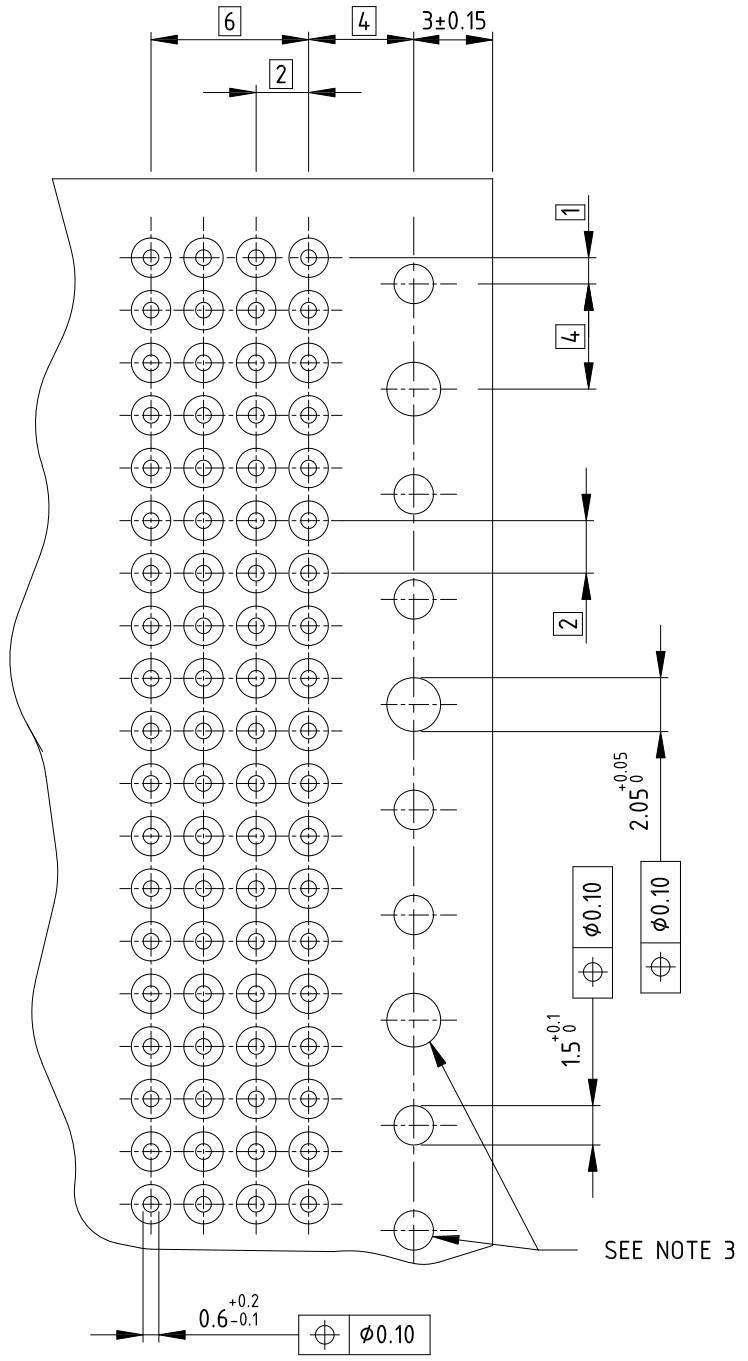
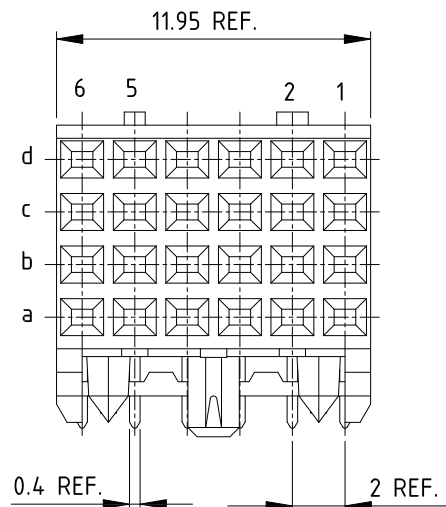
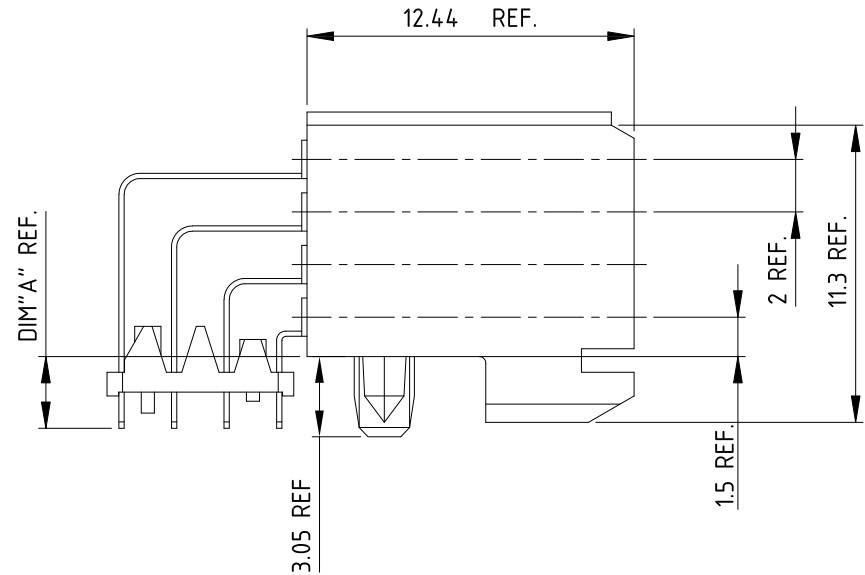
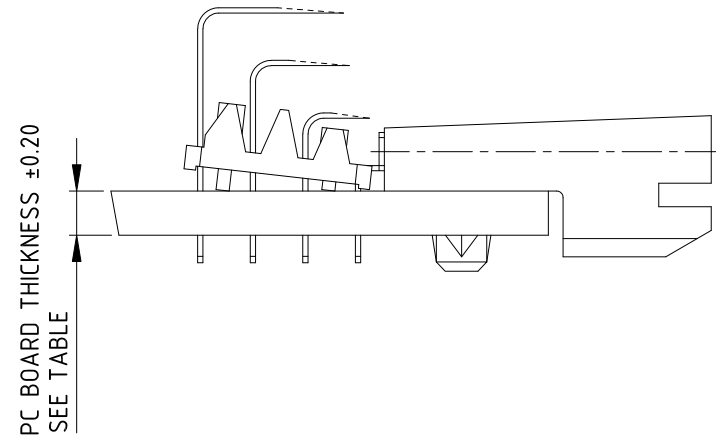

NOTES:

- MATERIAL : BODY : LCP UL94-V0  
: CONTACT : COPPER ALLOY.
- FOR PLATING PERFORMANCE REFER DRAWING # 10159408.  $\triangle$
- INDICATED HOLES ARE UNPLATED.
- THIS PRODUCT MEETS EUROPEAN UNION DIRECTIVES AND OTHER COUNTRY REGULATIONS AS DESCRIBED IN GS-47-0004.
- THE HOUSING WILL WITHSTAND EXPOSURE TO 260° PEAK TEMPERATURE FOR 10 SECONDS IN A WAVE SOLDER APPLICATION.
- A  $\triangle$  SYMBOL WILL BE NEXT TO ANY DIMENSION, VIEW, OR NOTE WHICH HAS BEEN MODIFIED WITH THE CURRENT DRAWING REVISION.

PART NUMBER : 89035-XY1LF

NOTE 2  $\triangle$

mat'l. code		surface		tolerance		projection		product family	
		ISO 1302 <input checked="" type="checkbox"/>		ISO 406 ISO 1101				METRAL	
ltr		ecn no	dr	date		tolerances unless otherwise specified		title	
M	SG09-0068	CENH		2009-06-06		0±0.3		RA FEMALE SIGNAL	
N	ELX-I-30829	SA		2018-04-28		linear .00±0.13		12mm PRESS PEG	
P	ELX-I-35736	MINI		2020-09-15		0°±2°		scale -	
				dr		H.BOUWKNEGT		1992-12-16	
				enr		ARUN		2020-09-17	
				chr		ALEX		2020-09-17	
				appd		SAN0J		2020-09-17	
sheet index		revision sheet		P		P		P	
		1 2		3					
								Amphenol FCI	
								dwg no	
								89035	
								type	
								Product Customer Drawing	
								sheet 1 of 3	
								size	
								A2	

PC BOARD VERSIONS		
PRODUCTNR:	PCB THICKNESS	DIM"A"
89035-X02LF	1.6	2.90
89035-X12LF	2.4	3.53
89035-X04LF	1.6	2.90
89035-X05LF	1.6	2.90

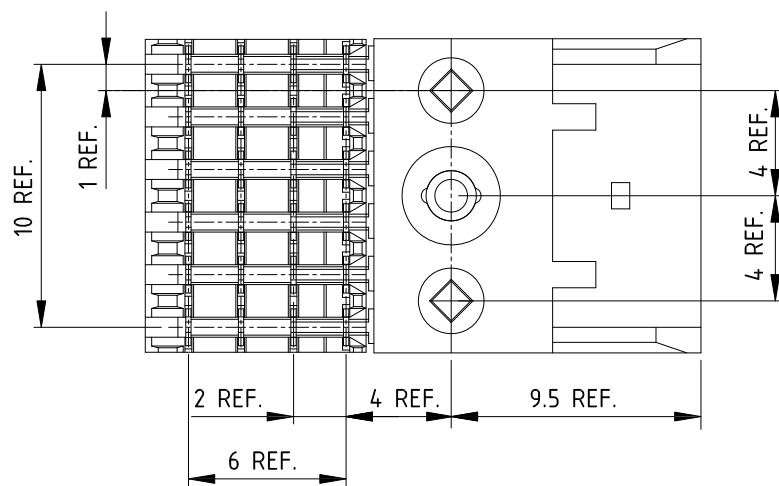
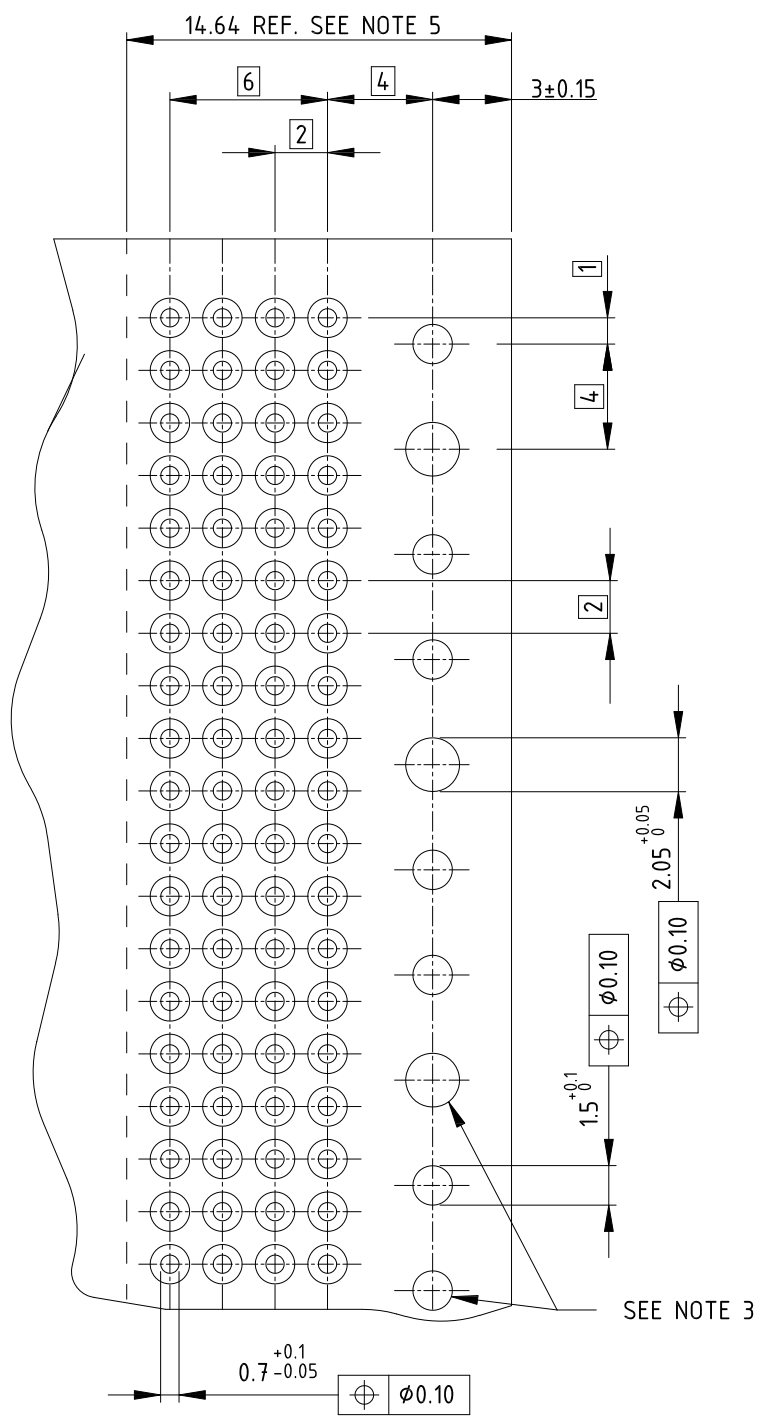
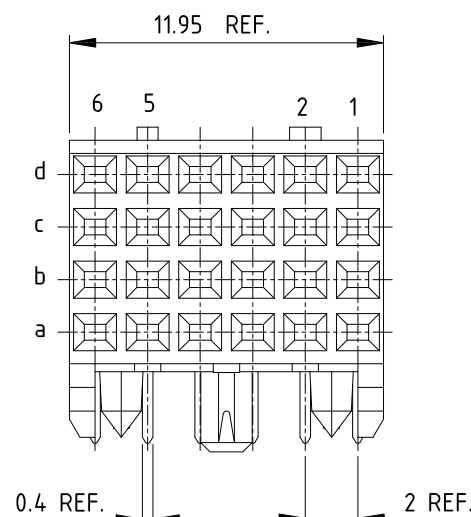
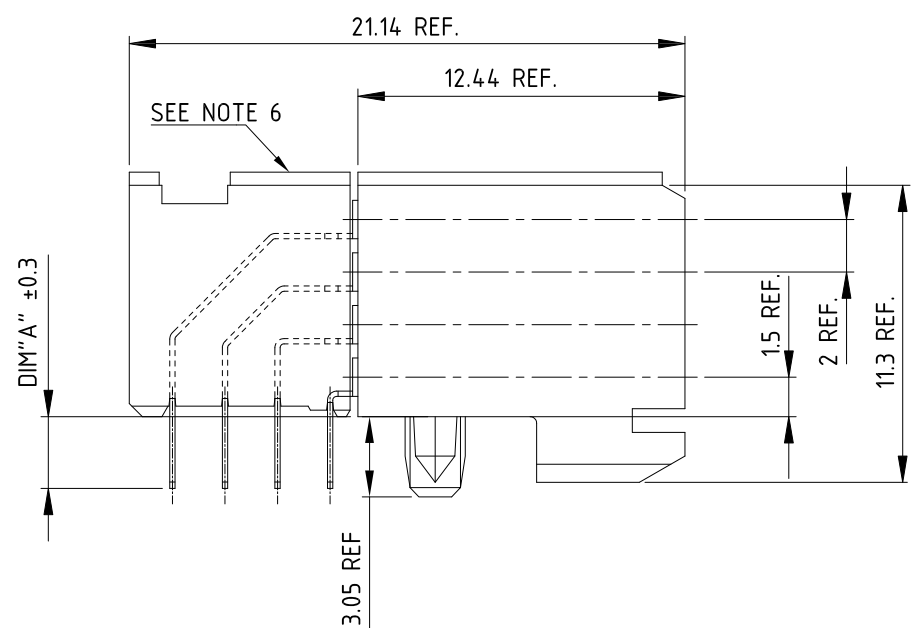
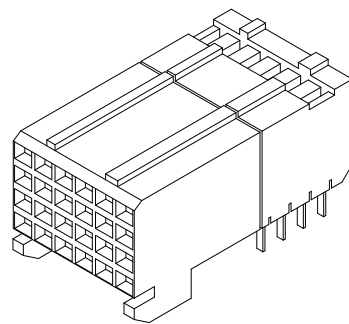

PRODUCT AFTER PC BOARD APPLICATION.

PC BOARD THICKNESS ±0.20  
SEE TABLE

LOADING LAYOUTS

'X' Denotes contact loaded position.

89035-X04LF						
ROW	6	5	4	3	2	1
D	X	-	X	X	X	X
C	X	-	X	X	X	X
B	-	-	X	X	-	-
A	X	-	X	X	-	X

89035-X05LF						
ROW	6	5	4	3	2	1
D	X	-	X	-	X	-
C	-	X	-	X	-	X
B	X	-	X	-	X	-
A		X	-	X	-	X

RECOMMENDED HOLE PATTERN,  
COMPONENT SIDE.

PART NUMBER : 89035-XYLFF

NOTES:

- MATERIAL : BODY : LCP UL94-V0  
: CONTACT : COPPER ALLOY.
- FOR PLATING PERFORMANCE REFER DRAWING # 10159408.  $\Delta$
- INDICATED HOLES ARE UNPLATED.
- THIS PRODUCT MEETS EUROPEAN UNION DIRECTIVES AND OTHER COUNTRY REGULATIONS AS DESCRIBED IN GS-47-0004.
- SET BACK FOR PRESS BLOCK.
- TOP SURFACE OF PRESS BLOCK MAY EXTEND UP TO 0.4MM HIGHER THAN HOUSING. THIS MAY AFFECT THETAILED LENGTH BEFORE APPLICATION TO A BOARD.
- THE HOUSING WILL WITHSTAND EXPOSURE TO 260° PEAK TEMPERATURE FOR 10 SECONDS IN A WAVE SOLDER APPLICATION.
- A  $\Delta$  SYMBOL WILL BE NEXT TO ANY DIMENSION, VIEW, OR NOTE WHICH HAS BEEN MODIFIED WITH THE CURRENT DRAWING REVISION.

mat'l. code		surface ISO 1302 <input checked="" type="checkbox"/> ISO 406 ISO 1101		projection 		product family METRAL	
ltr	ecn no	dr	date	tolerances unless otherwise specified		title	
M	SG09-0068	CENH	2009-06-06	angles	0±0.3	RA FEMALE SIGNAL	
N	ELX-1-30829	SA	2018-04-28	linear	.00±0.13	12mm PRESS PEG	
P	ELX-1-35736	MINI	2020-09-15	0°±2	0.00±0.050	scale	mm
sheet index		revision		dr		dwg no	
1		P 1		H.BOUWKNEGT 1992-12-16		sheet 2 of 3	
2		P 2		enr ARUN 2020-09-17		size	
3		P 3		chr ALEX 2020-09-17		A2	
				appd SANJ 2020-09-17		89035	
						type Product Customer Drawing	

PC BOARD VERSIONS		
PRODUCTNR:	PCB THICKNESS	DIM "A"
89035-X03LF	1.6	2.90
89035-X13LF	2.4	3.53

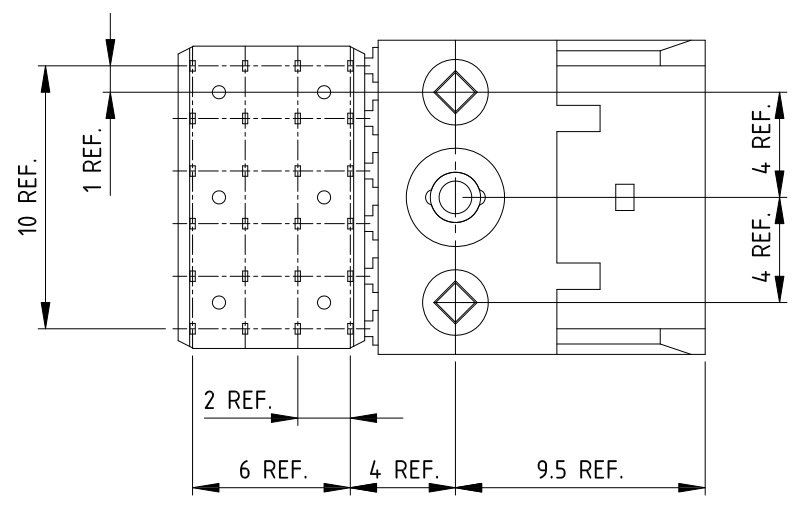
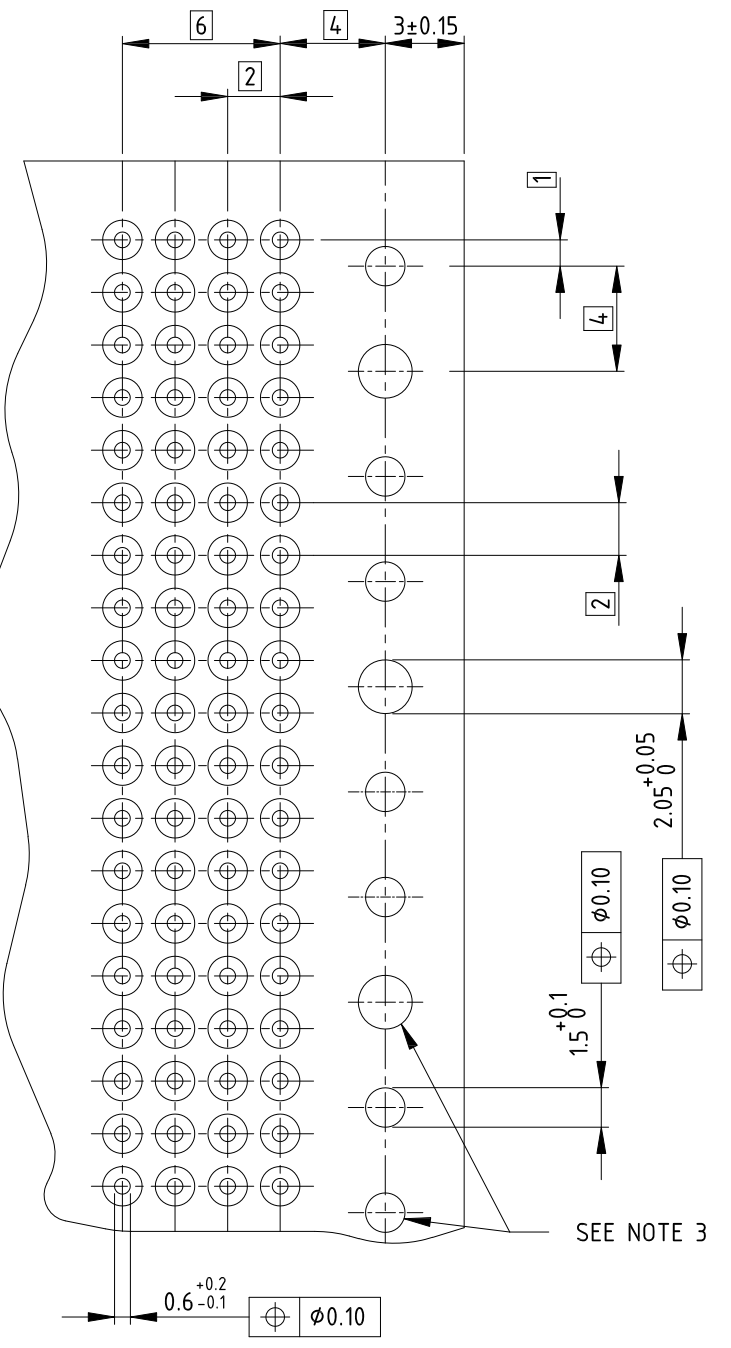
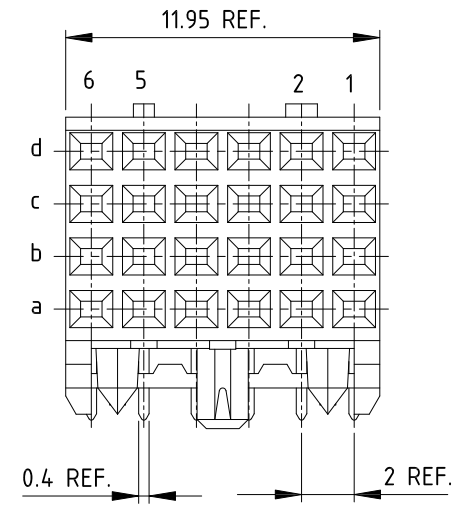
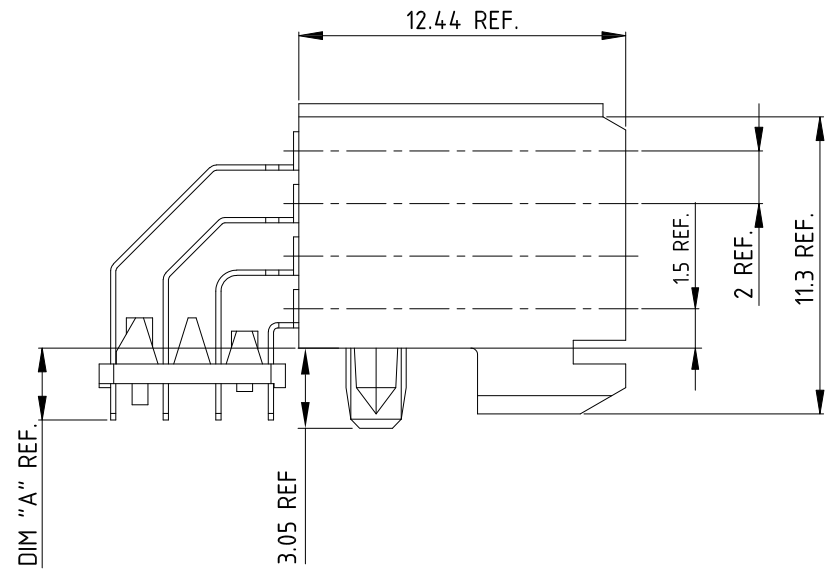

PRODUCT AFTER PC BOARD APPLICATION.

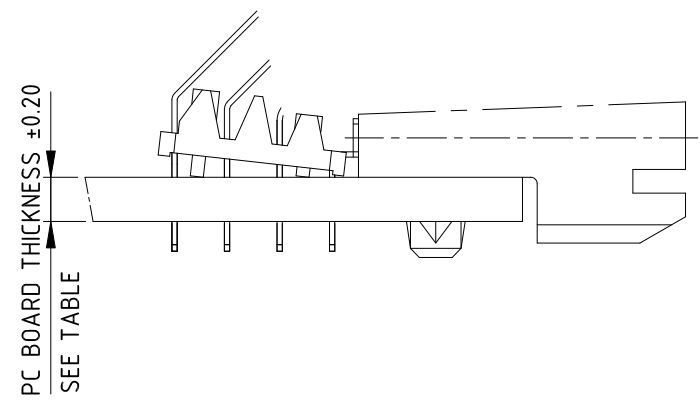

NOTES:

- MATERIAL : BODY : LCP UL94-V0  
: CONTACT : COPPER ALLOY.
- FOR PLATING PERFORMANCE REFER DRAWING # 10159408.  $\triangle$
- INDICATED HOLES ARE UNPLATED.
- THIS PRODUCT MEETS EUROPEAN UNION DIRECTIVES AND OTHER COUNTRY REGULATIONS AS DESCRIBED IN GS-47-0004.
- THE HOUSING WILL WITHSTAND EXPOSURE TO 260° PEAK TEMPERATURE FOR 10 SECONDS IN A WAVE SOLDER APPLICATION.
- A  $\triangle$  SYMBOL WILL BE NEXT TO ANY DIMENSION, VIEW, OR NOTE WHICH HAS BEEN MODIFIED WITH THE CURRENT DRAWING REVISION.

NOTE 2  $\triangle$

PART NUMBER : 89035-XYLLF

mat'l. code		surface		tolerance		projection		product family	
		ISO 1302		ISO 406 ISO 1101		mm		METRAL	
litr		ecn no		dr		date		title	
M		SG09-0068		CENH		2009-06-06		RA FEMALE SIGNAL	
N		ELX-1-30829		SA		2018-04-28		12mm PRESS PEG	
P		ELX-1-35736		MINI		2020-09-15		0°±2°	
				dr		H.BOUWKNEGT		1992-12-16	
				enr		ARUN		2020-09-17	
				chr		ALEX		2020-09-17	
				appd		SAN0J		2020-09-17	
sheet index		revision sheet		P		P		P	
		1		2		3			
								dwg no	
								89035	
								type	
								Product Customer Drawing	
								sheet 3 of 3	
								size	
								A2	