

EBS+x SOFT | Spherical revolving handle

Soft-touch technopolymer

EBS+x | Spherical revolving handle

Technopolymer

METRIC

SOFT

RoHS

PP

TPE

+176 °F
+32 °F

MATERIAL

High-resilience polypropylene based (PP) technopolymer, coated with "soft-touch" thermoplastic elastomer (TPE) chemically bonded, hardness 70 Shore A, black colour, matte finish.
The coating material is produced from FDA compliant raw material (FDA CFR.21 and EU 10/2011).

STANDARD EXECUTION

Zinc-plated steel pin, hexagon socket at threaded end.

FEATURES AND APPLICATIONS

The coating, with "soft-touch" elastomer, improves the grip even in the presence of oils, greases and sweat from the hand. For this reason it is suitable for fitness machines, tools and machines for gardening and goods transport, high-precision instruments and disability aids.



ERGOSTYLE® ELESAs Original design

METRIC

RoHS

PP

+176 °F
+32 °F

MATERIAL

High-resilience polypropylene based (PP) technopolymer, black colour, matte finish.

STANDARD EXECUTION

Zinc-plated steel pin, hexagon socket at threaded end.



ERGOSTYLE® ELESAs Original design

Conversion Table	
1 mm = 0,039 inch	
D	
mm	inch
45	1.77
48	1.89

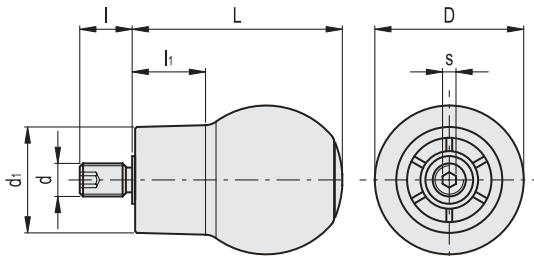

METRIC

Code	Description	D	L	d6g	d1	l	l1	s	⚖
247051	EBS.48 SOFT+x-M10	48	66	M10	35	17	23	5	100

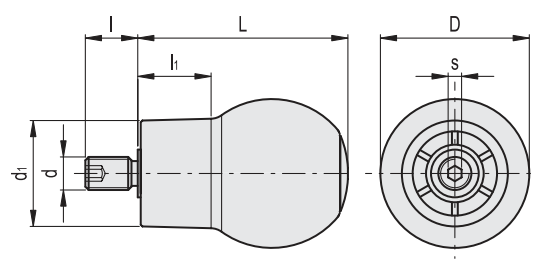

METRIC

Code	Description	D	L	d6g	d1	l	l1	s	⚖
247011	EBS.45+x-M10	45	63	M10	32	17	21.5	5	89

- 1
- 2
- 3
- 4
- 5
- 6
- 7
- 8
- 9
- 10
- 11
- 12
- 13
- 14
- 15
- 16
- 17
- 18

Fixed & Revolving handles