

0.5mm Pitch
SERIES

6292

0.5mmピッチ RA SMT 上接点 スライドロック
0.5mmPitch RA SMT Top contact Slide lock

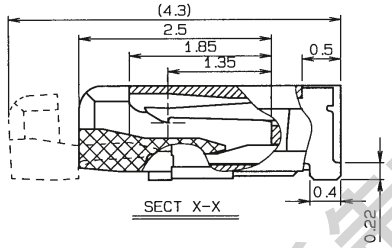
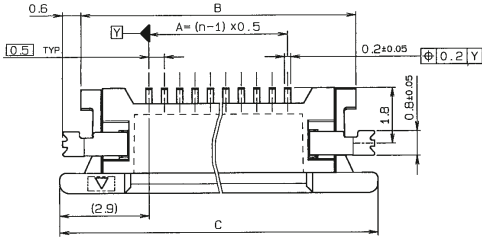

| 極数 NO. OF POS. | A | B | C | D |
|-------------------|-----|-----|------|------|
| 5 | 20 | 64 | 7.8 | 3.1 |
| 6 | 25 | 69 | 8.3 | 3.6 |
| 7 | 30 | 74 | 8.8 | 4.1 |
| 8 | 35 | 79 | 9.3 | 4.6 |
| 9 | 40 | 84 | 9.8 | 5.1 |
| 10 | 45 | 89 | 10.3 | 5.6 |
| 11 | 50 | 94 | 10.8 | 6.1 |
| 12 | 55 | 99 | 11.3 | 6.6 |
| 13 | 60 | 104 | 11.8 | 7.1 |
| 14 | 65 | 109 | 12.3 | 7.6 |
| 15 | 70 | 114 | 12.8 | 8.1 |
| 16 | 75 | 119 | 13.3 | 8.6 |
| 17 | 80 | 124 | 13.8 | 9.1 |
| 18 | 85 | 129 | 14.3 | 9.6 |
| 19 | 90 | 134 | 14.8 | 10.1 |
| 20 | 95 | 139 | 15.3 | 10.6 |
| 21 | 100 | 144 | 15.8 | 11.1 |
| 22 | 105 | 149 | 16.3 | 11.6 |
| 23 | 110 | 154 | 16.8 | 12.1 |
| 24 | 115 | 159 | 17.3 | 12.6 |
| 25 | 120 | 164 | 17.8 | 13.1 |
| 26 | 125 | 169 | 18.3 | 13.6 |
| 27 | 130 | 174 | 18.8 | 14.1 |
| 28 | 135 | 179 | 19.3 | 14.6 |
| 29 | 140 | 184 | 19.8 | 15.1 |
| 30 | 145 | 189 | 20.3 | 15.6 |

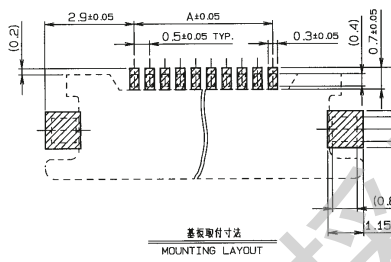
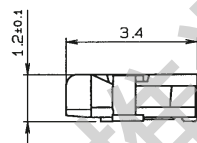
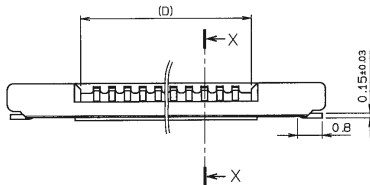

| | FPC | | FFC | |
|----|--|-----------|---------------------------------------|---------------------------------------|
| | 1 | 2 | 1 | 2 |
| M | 0.5±0.12 | 0.5±0.1 | 0.5±0.1 | 0.5±0.08 |
| P | 0.5±0.02 | 0.5±0.05 | 0.5±0.03 | 0.5±0.05 |
| A | A±0.03 | A±0.05 | A±0.03 | A±0.05 |
| W | W±0.07 | W±0.07 | W±0.07 | W±0.07 |
| Wp | 0.35 ^{+0.04} _{-0.03} | 0.35±0.05 | 0.3 ^{+0.05} _{-0.02} | 0.3 ^{+0.05} _{-0.02} |

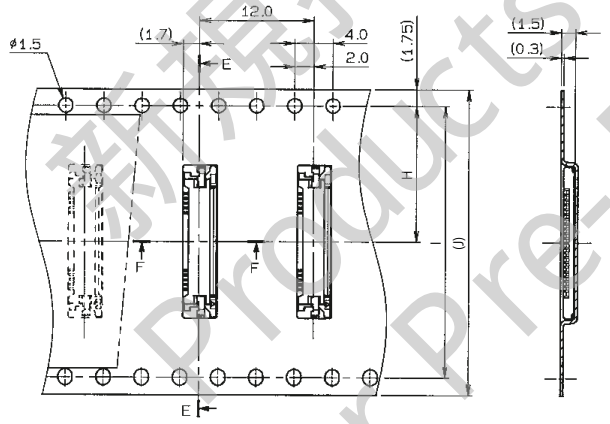
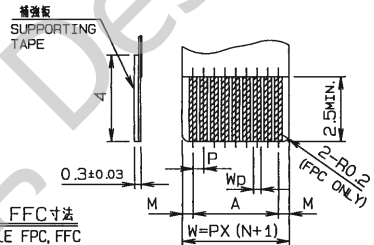

SECT. E-E

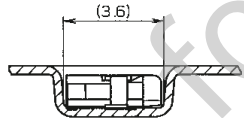

SECT. F-F

| 極数 NO. OF POS. | H | I | J |
|-------------------|------|------|----|
| 5 | 11.5 | — | 24 |
| 6 | 11.5 | — | 24 |
| 7 | 11.5 | — | 24 |
| 8 | 11.5 | — | 24 |
| 9 | 11.5 | — | 24 |
| 10 | 11.5 | — | 24 |
| 11 | 11.5 | — | 24 |
| 12 | 11.5 | — | 24 |
| 13 | 11.5 | — | 24 |
| 14 | 11.5 | — | 24 |
| 15 | 11.5 | — | 24 |
| 16 | 11.5 | — | 24 |
| 17 | 11.5 | — | 24 |
| 18 | 11.5 | — | 24 |
| 19 | 11.5 | — | 24 |
| 20 | 11.5 | — | 24 |
| 21 | 14.2 | 28.4 | 32 |
| 22 | 14.2 | 28.4 | 32 |
| 23 | 14.2 | 28.4 | 32 |
| 24 | 14.2 | 28.4 | 32 |
| 25 | 14.2 | 28.4 | 32 |
| 26 | 14.2 | 28.4 | 32 |
| 27 | 14.2 | 28.4 | 32 |
| 28 | 14.2 | 28.4 | 32 |
| 29 | 14.2 | 28.4 | 32 |
| 30 | 14.2 | 28.4 | 32 |

注文コード ORDERING CODE
04 6292 OXX 000 XXX+

RoHS 対応品
RoHS Compliant Product

800+ : スズ銅めっき Sn-Cu Plated
829+ : 金めっき Au Plated

極数 NUMBER OF POSITIONS

生産対応可能極数については、営業部にご確認願います。
Feel free to contact our sales department for available numbers of positions.

梱包数量 2000個/リール
PACKING QUANTITY : 2000/Reel