

LOC		DIST		REVISIONS			
P	LTR	DESCRIPTION	DATE	DMN	APVD		
C		REVISED PER ECO-12-007807	06AUG12	KH	SM		

- 1 UNIT ACCEPTS 1.14 [.045] SQUARE OR ROUND POST.
- 2 PREFERRED SL-156 CONTACTS FOR USE WITH THIS UNIT ARE 350980, 640252, 640706, 640707, 641550 AND 770258 (ALL DASH NUMBERS).
- 3 UNIT ACCEPTS KEYING PLUG 640254-1 AND KEYING PIN 640255-1.
- 4 CIRCUIT I.D. NUMBER(S) TO BE LOCATED SEQUENTIALLY AS SHOWN OR ONLY NO. 1 CIRCUIT PLACED ON TOP OF HOUSING.
- 5 CIRCUITS 5 & 9 ARE MOLDED CLOSED.
- 6 DIMENSIONS IN BRACKETS ARE IN INCHES.

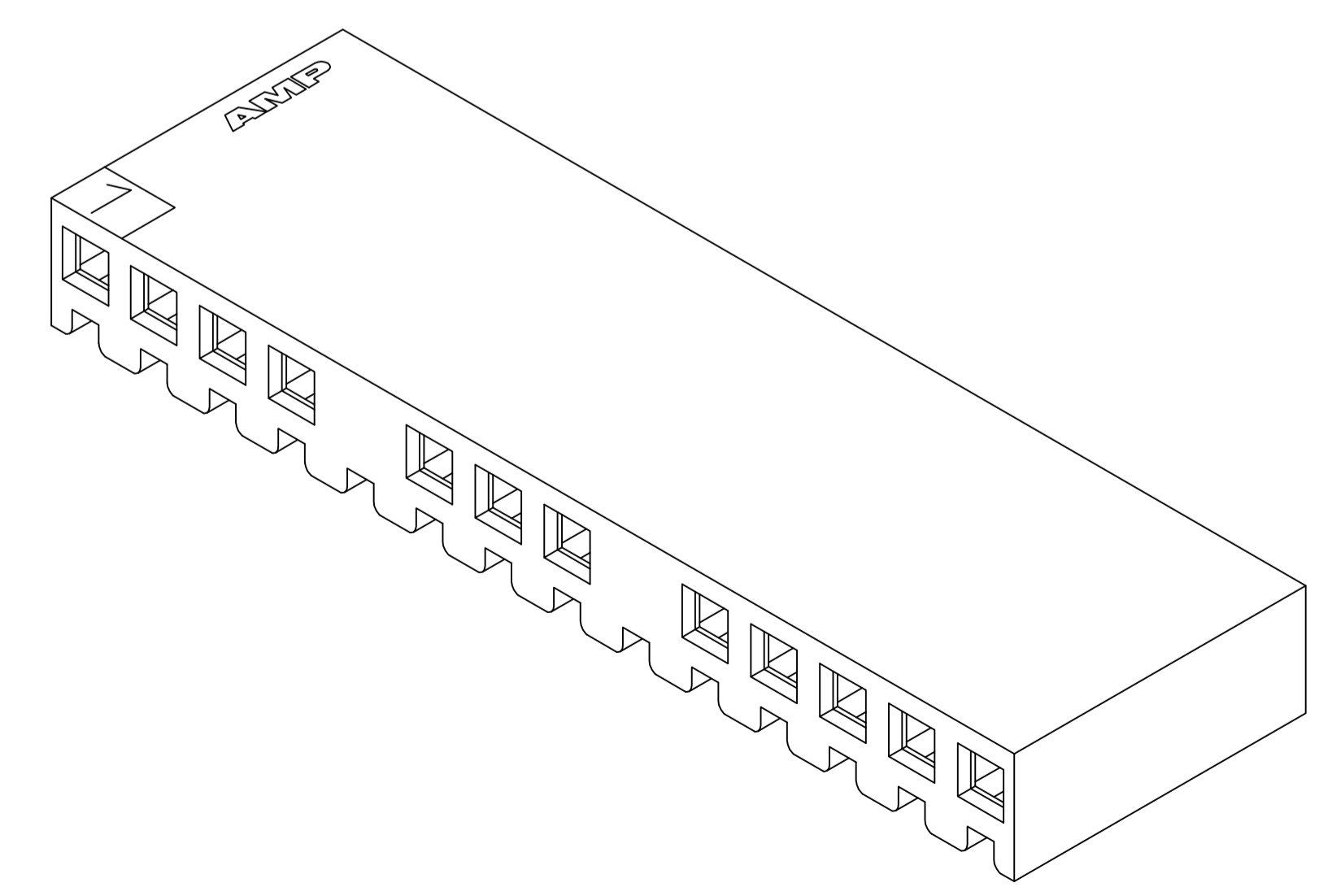

3-DIMENSIONAL MODEL NTS

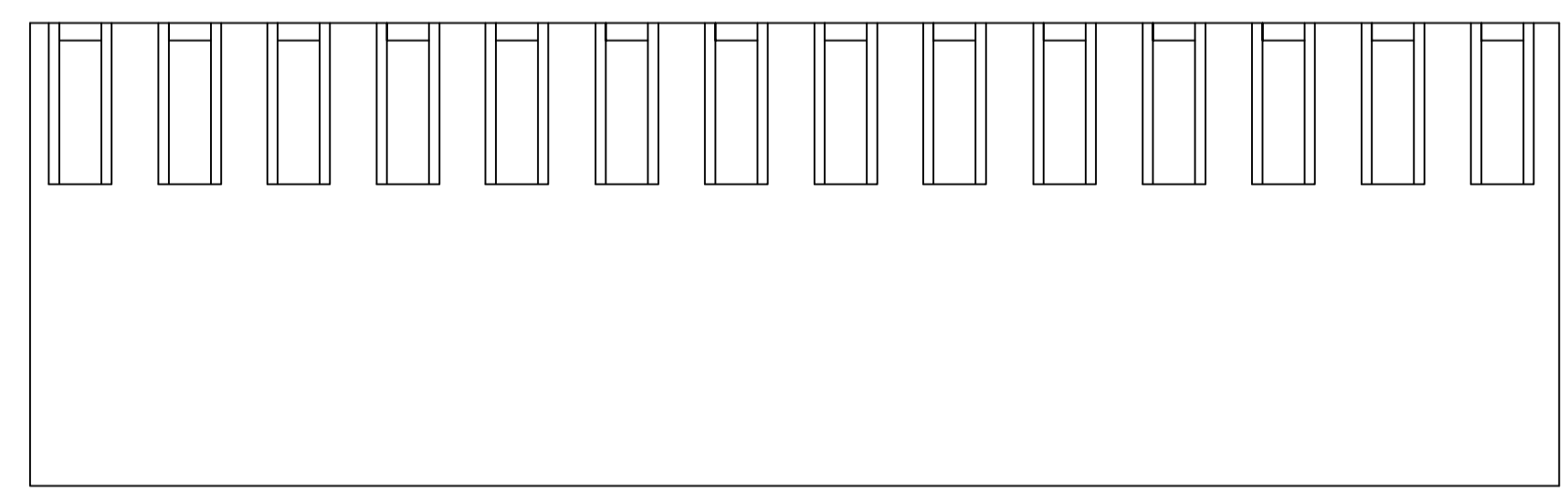
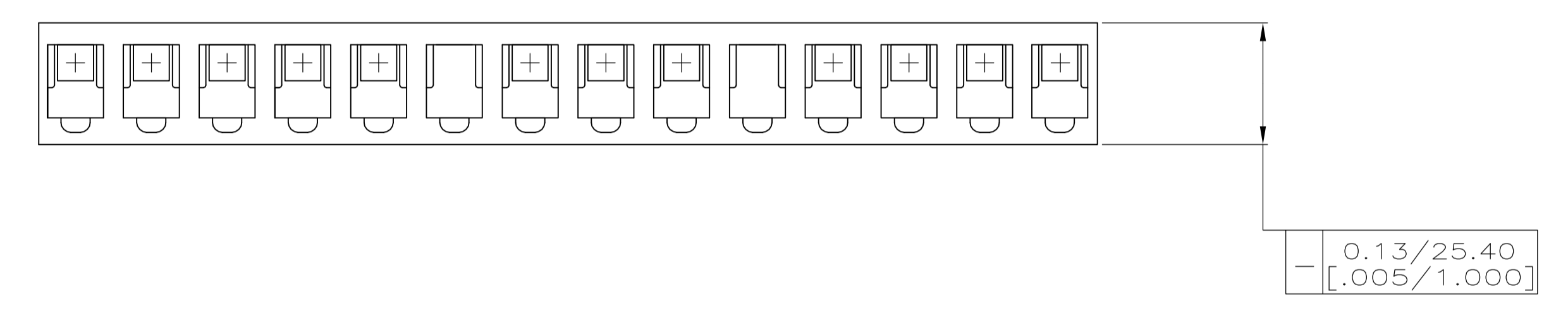
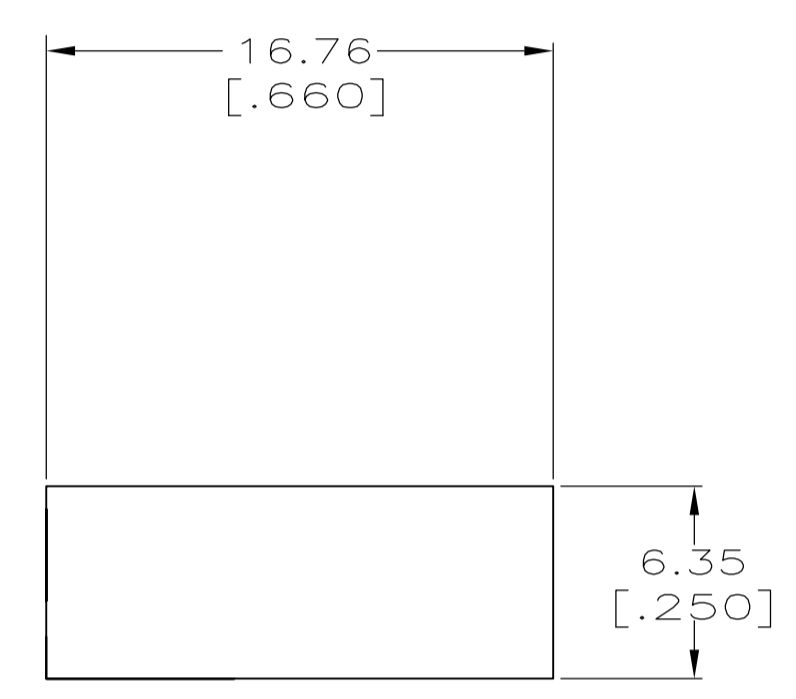
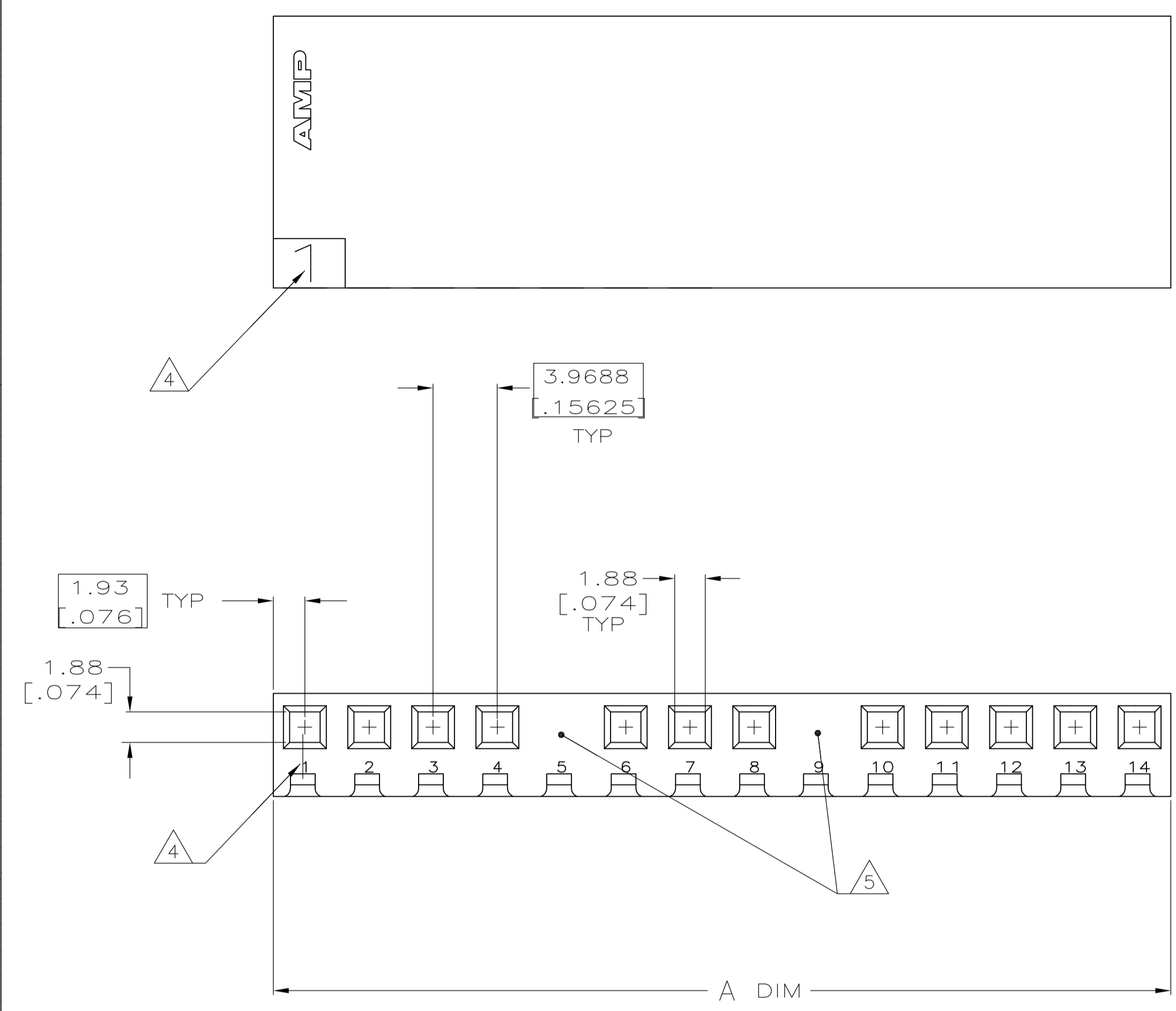
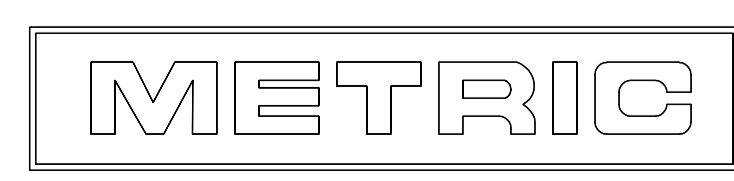

55.45 [2.183]	14	1-770893-4
A ±0.25 [.010]	NO. OF CIRCUITS	PART NUMBER

THIS DRAWING IS A CONTROLLED DOCUMENT.		DIN K. SALMON 9-17-92		NAME	
DIMENSIONS: mm [INCHES]		CHK R. SWING 9-17-92		APVD	
TOLERANCES UNLESS OTHERWISE SPECIFIED:		PRODUCT SPEC		APPLICATION SPEC	
0. PLC ± -	1. PLC ± -	SIZE		CAGE CODE	
2. PLC ± -	3. PLC ± 0.13 [.005]	A1		DRAWING NO.	
4. PLC ± -	ANGLES ± ± -	770893		RESTRICTED TO	
MATERIAL NYLON,UL 94V-0 NATURAL	FINISH -	WEIGHT -		CUSTOMER DRAWING	
		SCALE 4:1		SHEET 1 OF 1	
				REV C	