

**P.C.B. HOLE DIM. ACTION PIN**

DRILLED HOLE	: 1,15 ± 0,025 mm
FIN. HOLE	: 0,94 to 1,09 mm
AFTER REFLOW	: 0,91 to 1,09 mm
Cu-thks	: 0,025 to 0,075 mm
SnPb-thks	: 0,004 to 0,010 mm

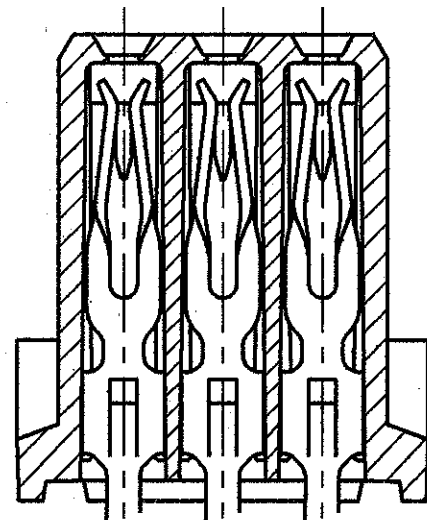

**NOTES:**

- 1** CONNECTOR MEETS THE REQUIREMENTS ACC. DIN 41612 AND DIN 41611, PART 2 AND 5.
- 2** MATERIAL CONTACT: PHOSPHORBRONZE. MATERIAL HOUSING: GLASSFILLED THERM. POLYESTER.
- 3** AT CONTACT AREA 1,25 μm GOLD OVER 1,25 μm NICKEL. REMAINDER 1,25 μm TIN-LEAD (93/7).
- 4** AT CONTACT AREA 0,8 μm GOLD OVER 1,25 μm NICKEL. REMAINDER 1,25 μm TIN-LEAD (93/7).
- 5** AT CONTACT AREA AND AREA **Δ** 1,25 μm GOLD OVER 1,25 μm NICKEL. AT ACTION PIN AREA 1,25 μm TIN LEAD (93/7).
- 6** AT CONTACT AREA AND AREA **Δ** 0,8 μm GOLD OVER 1,25 μm NICKEL. AT ACTION PIN AREA 1,25 μm TIN LEAD (93/7).
- 7** CONNECTOR PRINTED WITH PARTNUMBER AND DATECODE ON OUTSIDE OF MATING AREA OF ROW c.

**DO NOT SCALE**  
DIMENSIONS IN mm

**METRIC**

THIRD ANGLE  
PROJECTION

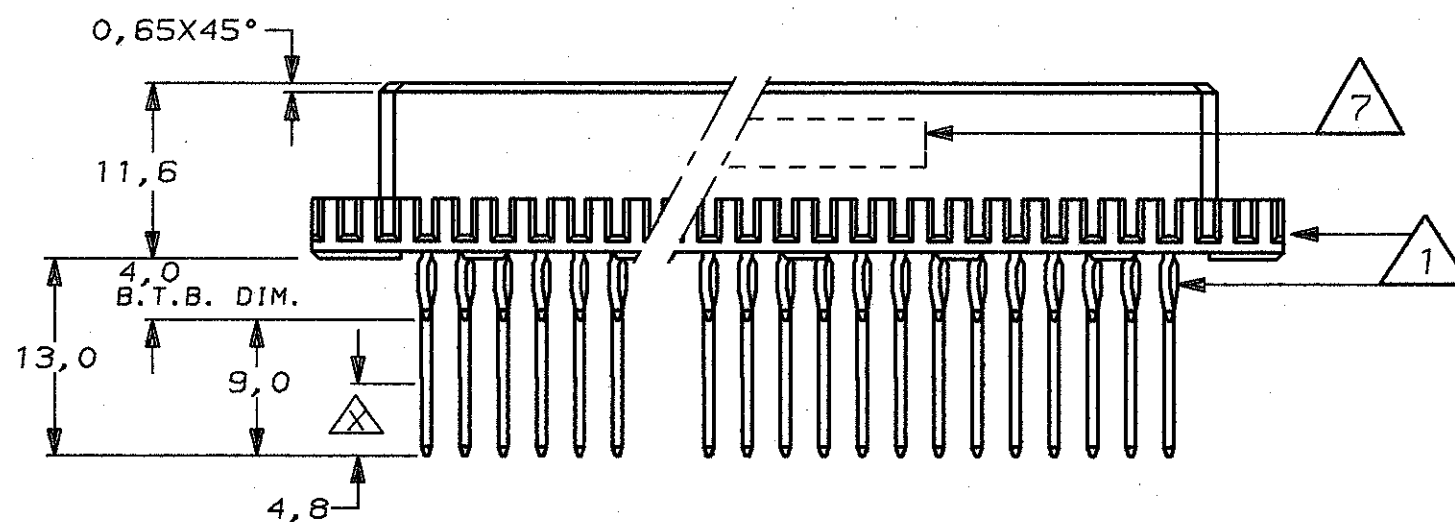
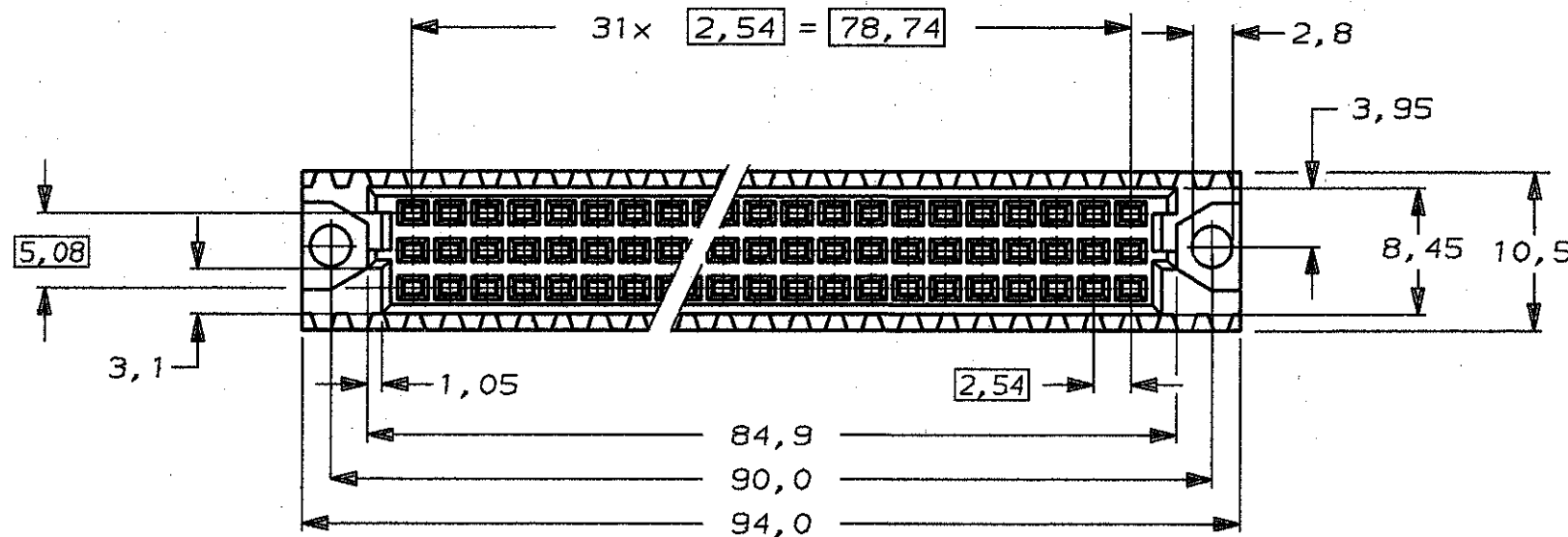
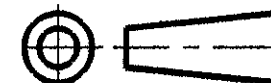

ROW c	00
ROW b	XX
ROW a	XX
POS	32 31 30 29 28 27 26 25 24 23 22 21 20 19 18 17 16 15 14 13 12 11 10 9 8 7 6 5 4 3 2 1

AN ASTERISK ,,X'' DENOTES A W.W. CONTACT.  
AN ASTERISK ,,O'' DENOTES A B.T.B. CONTACT.

<b>Δ</b> 6	<b>Δ</b> 2	1-100434-4
<b>Δ</b> 5	<b>Δ</b> 2	1-100434-1
<b>Δ</b> 4	<b>Δ</b> 2	100434-4
<b>Δ</b> 3	<b>Δ</b> 2	100434-1

		FINISH	MATERIAL	PARTNUMBER
-	-	-	-	-
-	-	-	-	-
-	-	-	-	-
-	-	-	-	-
0	H-8981	R.v.L.	-	24.07.91
LTR. REVISION RECORD		DR.	CHK.	DATE
DR.:	R.v.Lokven	CHK.:	J.v.Grunsvan	APP.:
DATE:	24.07.91	DATE:	08.10.91	DATE:
			L.v.Soest	08.10.91

<b>CUSTOMER DRAWING</b>		FOR REFERENCE ONLY WILL NOT BE UPDATED
© COPYRIGHT 19- BY AMP-HOLLAND B.V. ALL INTERNATIONAL RIGHTS RESERVED.AMP PRODUCTS MAY BE COVERED BY U.S. AND FOREIGN AND/OR PATENTS PENDING. THIS DRAWING IS UNPUBLISHED RELEASED FOR PUBLICATION		
<b>AMP</b>		AMP-HOLLAND B.V. 's-Hertogenbosch, The Netherlands.
NAME 96 POS. FEMALE B.T.B.-W.W. CONN. ASS'Y ACC. DIN 41612 WITH ACTION-PIN FOR 1,6mm. P.C.BOARD THK'S		
DWG. No.	REV. LTR.	SHEET
C-100434	0	1 OF 1