

THIS DRAWING IS A CONTROLLED DOCUMENT.

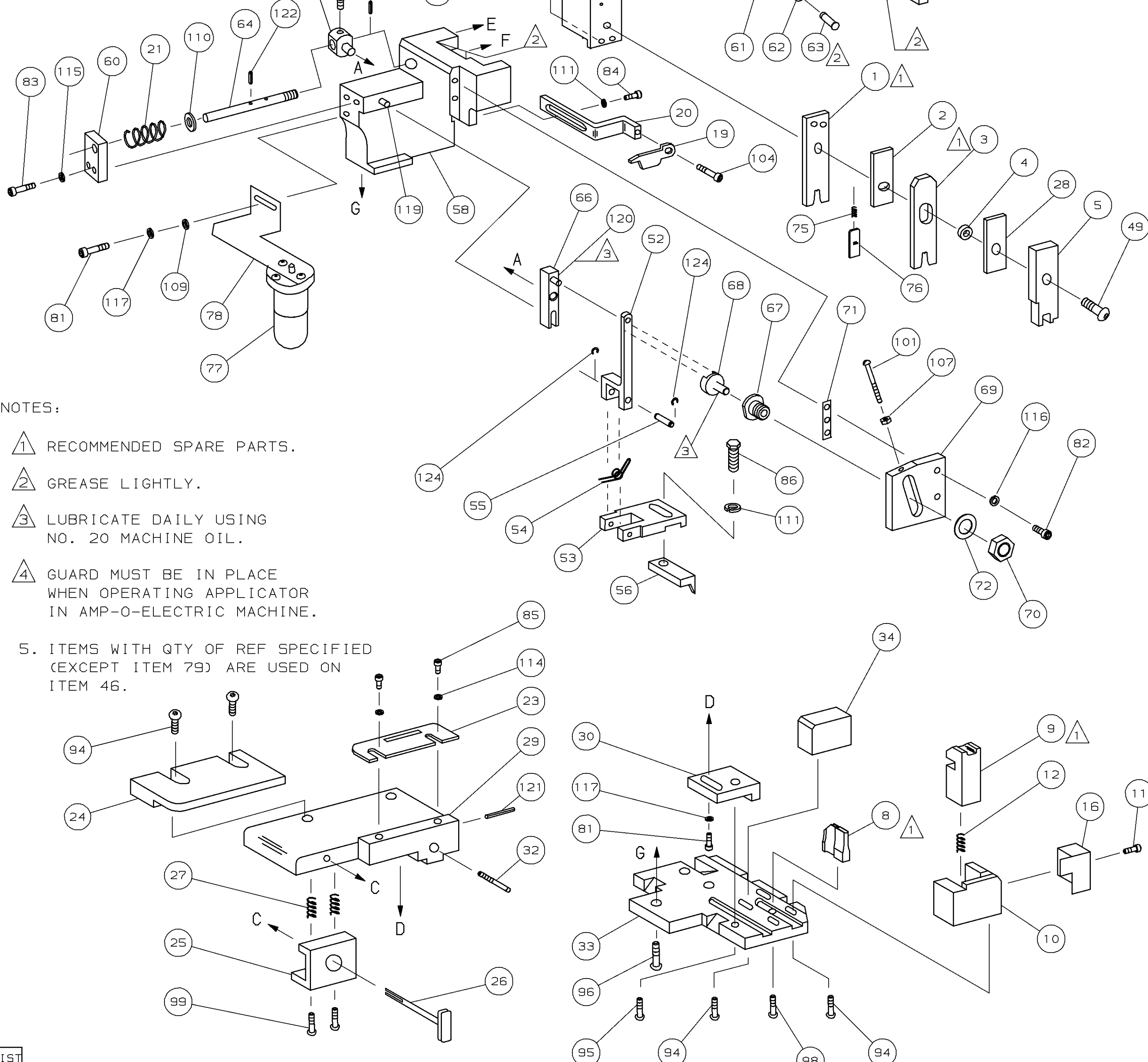
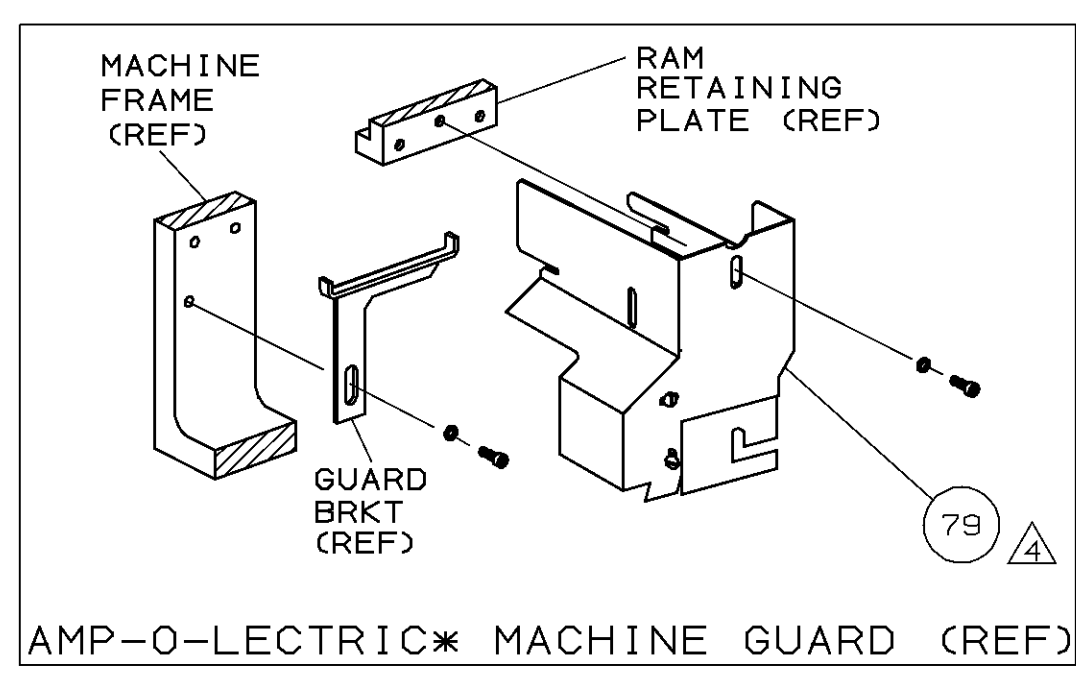
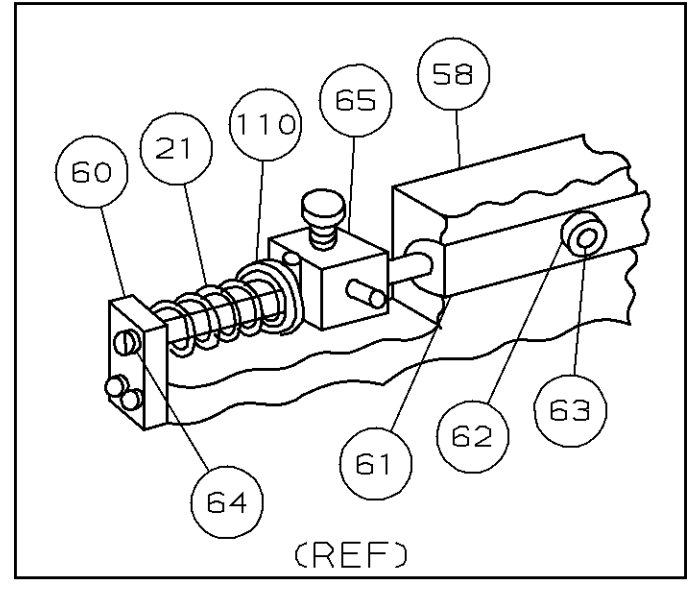
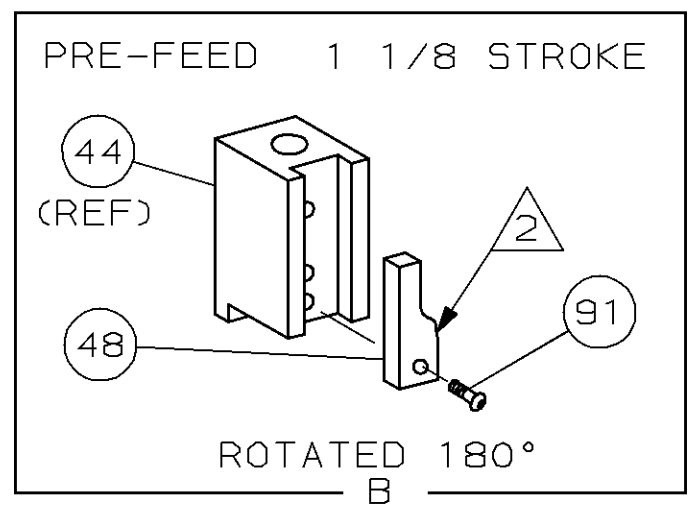

- NOTES:
- 1 RECOMMENDED SPARE PARTS.
 - 2 GREASE LIGHTLY.
 - 3 LUBRICATE DAILY USING NO. 20 MACHINE OIL.
 - 4 GUARD MUST BE IN PLACE WHEN OPERATING APPLICATOR IN AMP-O-ELECTRIC MACHINE.
 - 5. ITEMS WITH QTY OF REF SPECIFIED (EXCEPT ITEM 79) ARE USED ON ITEM 46.

REF	DESCRIPTION	QTY	REF	DESCRIPTION	QTY
REF	21045-3 RING, RET "C" (.187ø) FEED FINGER PIN	124	REF	454220-1 CAP, HOUSING	59
REF	5-21028-1 PIN, SLT SPR (.125øx.50) ADJ ROD	123	REF	454485-1 HOUSING	58
1	4-21028-0 PIN, SLT SPR (.093øx.75) ST GUIDE PL	121	REF	690542-2 PAWL, FEED	56
REF	1-21030-1 PIN, DOWEL (.187øx.50) LEVER	120	REF	240624-1 PIN, FEED FINGER	55
REF	1-21030-6 PIN, DOWEL (.187øx1.25) HOUSING	119	REF	691499-1 SPRING, FEED FINGER	54
2	21024-5 WASHER, LOCK (NO. 10) ADJ BLOCK	117	REF	690541-1 FINGER, FEED	53
REF	21024-5 WASHER, LOCK (NO. 10) ADJ PLATE	116	REF	455679-1 LEVER, TERMINAL FEED ARM	52
REF	21024-5 WASHER, LOCK (NO. 10) FEED GUIDE ROD	115	1	811242-2 BUMPER, HOLDDOWN	51
2	21024-2 WASHER, LOCK (NO. 4) FRONT STRIP GUIDE	114	1	690753-1 SPACER, TONKER	50
		113	1	7-21002-9 BOLT, CRIMPER (5/16-24x1.00)	49
		112	1	690602-5 CAM, PRE-FEED 1 1/8 STROKE	48
4	21024-4 WASHER, LOCK (NO. 8) STRIPPER	111			47
REF	21899-4 WASHER, FLAT (5/16 DIA) SCREW ADJ	110	1	459456-1 APPLICATOR, BASIC (SUBASSY)	46
1	21899-2 WASHER, FLAT (NO. 10) LUB ASSY	109	1	690191-1 PLUG, NYLON	45
1	21018-5 NUT, HEX (NO. 6) HOLDDOWN	108	1	455673-1 RAM	44
REF	21018-5 NUT, HEX (6-32) FEED ADJ	107	1	690125-1 WASHER, LAMINATED	43
		106	1	690124-1 WASHER, RAM	42
		105	2	23241-6 BALL, STEEL	41
1	456567-1 SCR, SHLD (.188øx.125) STRIPPER	104	2	690170-1 SPRING, COMPRESSION	40
1	21009-2 SCR, SKT SET (1/4-20x.25) LOC-WEL) RAM	103	1	690142-1 DISC, INSULATION	39
2	21017-2 SCR, DRIVE (#2x.19) ID PLATE	102	1	4-690141-1 DISC, WIRE	38
REF	6-23715-5 SCR, PAN HD (6-32x1.50) FEED ADJ	101	1	22480-5 WASHER, SPRING	37
1	461264-1 PLATE, IDENTIFICATION	100	1	690212-1 POST, RAM	36
2	2-21002-9 SCR, BHC (10-32x.75) DRAG	99	1	690786-6 SUPPORT, TERMINAL	35
1	22733-8 SCR, BHC (8-32x.38) LOC-WEL) ANVIL	98	REF	455675-1 PLATE, BASE	34
REF	2-21002-9 SCR, BHC (10-32x.75) CAP	97	1	690432-3 SCREW, ADJUSTMENT	33
REF	2-22733-8 SCR, BHC (1/4-20x.62) HOUSING	96			32
REF	2-21002-7 SCR, BHC (10-32x.50) SG ADJ BLOCK	95	REF	455689-1 BLOCK, STRIP GUIDE ADJ	30
6	2-21002-2 SCR, BHC (8-32x.50) SHEAR	94	1	455671-1 PLATE, STRIP GUIDE	29
		93	1	1-455888-0 SPACER, FRONT SHEAR DEP	28
		92	2	1-22284-0 SPRING, DRAG	27
1	1-21002-7 SCR, BHC (6-32x.38) CAM	91	1	690546-1 LEVER, DRAG RELEASE	26
		90	1	240792-1 DRAG, STOCK	25
		89	1	3-690504-5 GUIDE, STRIP (REAR)	24
		88	1	690438-1 GUIDE, STRIP (FRONT)	23
		87			22
1	2-22603-0 SCR, HEX HEAD (8-32x.31) FEED FINGER	86	REF	4-22284-9 SPRING, FEED RETURN	21
2	1-21000-3 SCR, SKT CAP (4-40x.25) F STRIP GUIDE	85	1	458950-1 ARM, STRIPPER	20
1	2-21000-7 SCR, SKT CAP (8-32x.50) STRIPPER	84	1	458949-1 STRIPPER	19
REF	3-21000-7 SCR, SKT CAP (10-32x.75) FEED ROD GD	83			18
REF	3-21000-6 SCR, SKT CAP (10-32x.62) FEED ADJ BLK	82			17
2	3-21000-4 SCR, SKT CAP (10-32x.38) SG ADJ BLK	81	1	691667-1 GUARD, CHIP (FRONT)	16
REF	3-21000-4 SCR, SKT CAP (10-32x.38) PIVOT BLOCK	80			15
REF	455749-1 GUARD, WINDOW	79			14
1	1-465184-0 LUBRICATOR ASSY	78			13
REF	852931-2 OIL, LUBRICATING	77	1	5-22280-0 SPRING, SHEAR	12
1	693183-4 WIRE DEPRESSOR	76	1	690461-1 STOP, SHEAR	11
1	1-23147-2 SPRING, COMPRESSION	75	1	690459-1 HOLDER, SHEAR (FRONT)	10
2	690603-1 SPRING, ASSIST	74	1	462006-2 SHEAR, FLOAT (FRONT)	9
2	23030-1 SCR, SKT CAP (6-32x.25) CP DISC	73	1	1-690514-8 ANVIL	8
REF	458109-1 WASHER, SPECIAL	72			7
REF	690517-1 SPACER	71			6
REF	22594-8 NUT, HEX	70	1	2-455889-0 DEPRESSOR, SHEAR (FRONT)	5
REF	240628-1 PLATE, ADJUSTMENT	69	1	2-238011-2 SPACER, TUBULAR	4
REF	240626-1 SHAFT, PIVOT	68	1	5-456135-2 CRIMPER, INSULATION	3
REF	240633-1 BUSHING	67	1	693184-9 SPACER, CRIMPER	2
REF	455680-1 LEVER, INTERMEDIATE	66	1	817331-4 CRIMPER, WIRE	1
REF	240629-1 BLOCK, PIVOT	65			
REF	240632-2 SCREW, ADJUSTMENT FEED ROD	64			
REF	240659-3 PIN, CAM ROLLER	63			
REF	240658-1 ROLLER, CAM	62			
REF	454398-2 ROD, FEED	61			
REF	454178-1 GUIDE, FEED ROD	60			

REMARKS	NO	REV
APPL USED ON MACHINE PART NO	MACH SERIAL NO	DISTRIBUTION
CUSTOMER NAME	APPL SERIAL NO	ORIGINAL
ADDRESS	PURCHASE ORDER	CUSTOMER COPY
CITY	ENG APP	FIELD ENG COPY

CRIMPING DATA				APPLICATOR WILL APPLY	
PAD LTR	CRIMP HEIGHT	WIRE SIZE	WIRE STRIP LENGTH		66622-2
A	.026±.0015	30,28 OR 26			
B	NOT	USED			
C	NOT	USED			
D	NOT	USED			
CRIMP SIZE	TYPE	FEED	APPL INST		
WIRE .033	F	.390	AI 8040		
INSUL .100	0				
WIRE RANGE 30-26	INSULATION RANGE .060-.105	MACHINE NO 565435-5			

AMP-O-ELECTRIC PRE-FEED OBSOLETE

SET UP GAGE 10-1	458637-1 512	DR 11/18/88	APP 11/18/88	LOC A	NO D	REV B1
CHK 11/18/88	REL 11/18/88	A-CHECKER	R-ENTERLINE			
AMP INCORPORATED Harrisburg, Pa.				567304-2		
MINIATURE QUICK CHANGE APPLICATOR SIDE FEED (AMPLIMATE CONTACT)						

CUSTOMER AND ASSEMBLY DRAWING

JAN 4, 1989
 RELEASED FOR PUBLICATION
 BY AMP INCORPORATED. ALL RIGHTS RESERVED.
 COPYRIGHT 1989
 THIS DRAWING IS UNPUBLISHED
 AMP 1756 REV 3-92