

LOC		DIST		REVISIONS				
P	LTR	DESCRIPTION	DATE	DMN	APVD			
A1		REVISED PER ECO-08-009053	16APR08	DH	AS			
A2		REVISED PER ECO-10-000444	16JAN10	KK	AEG			

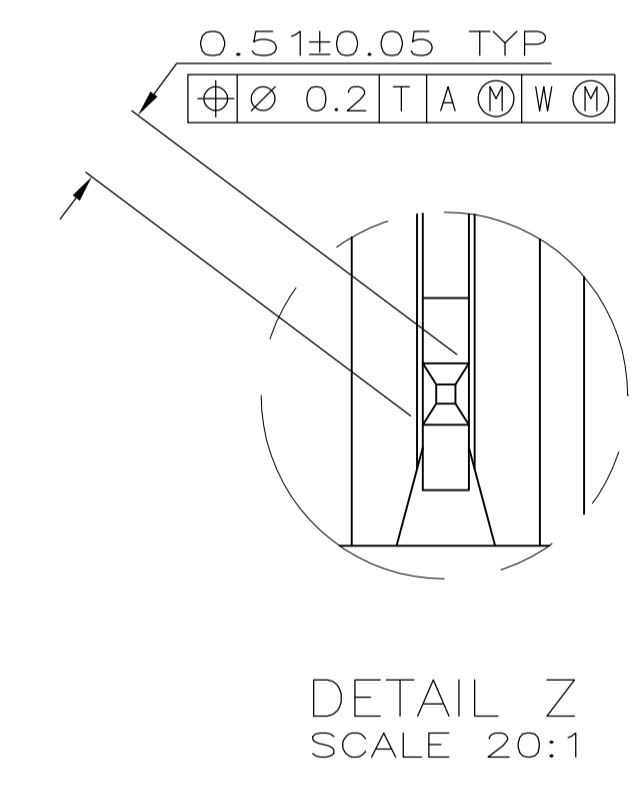
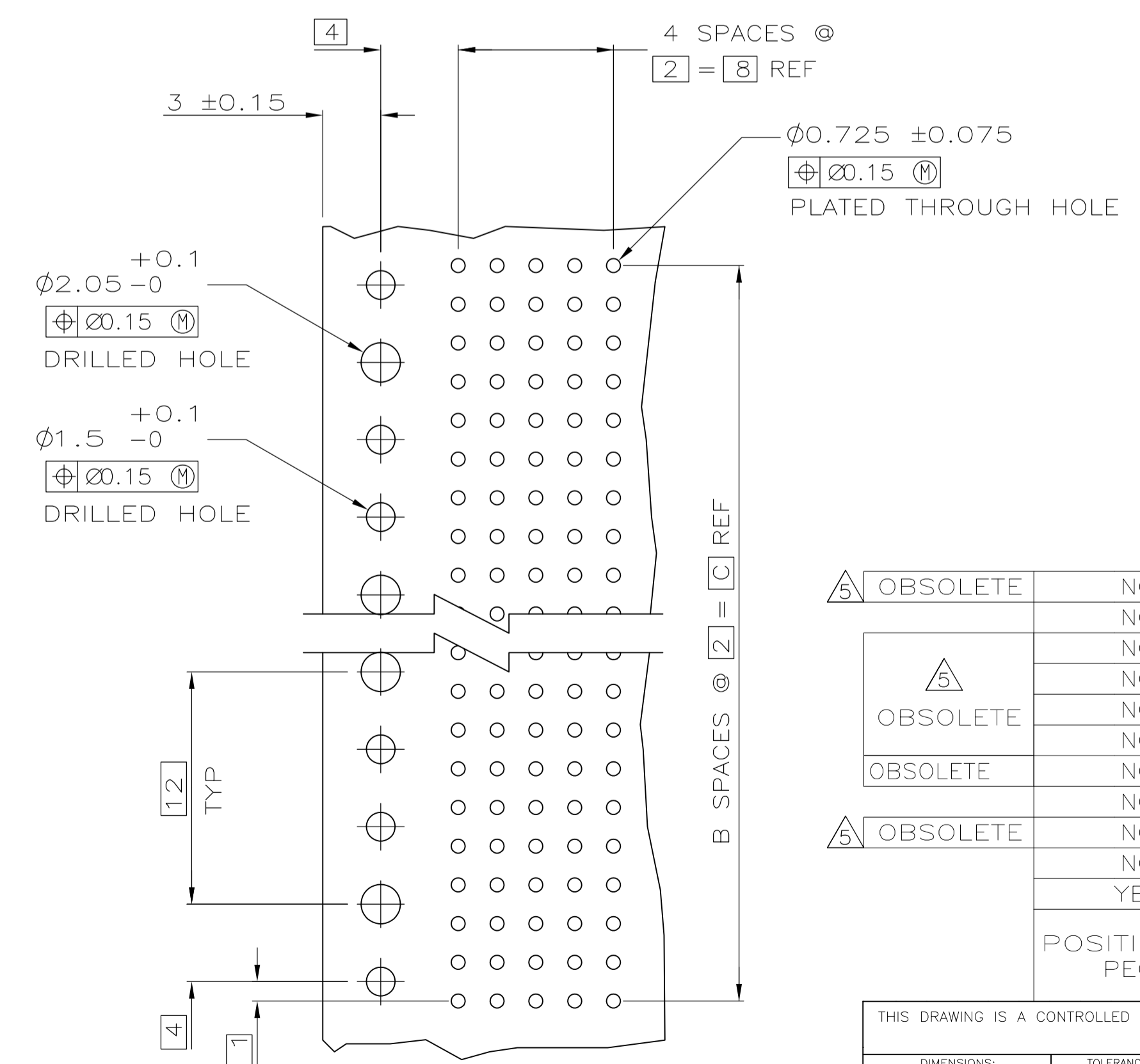
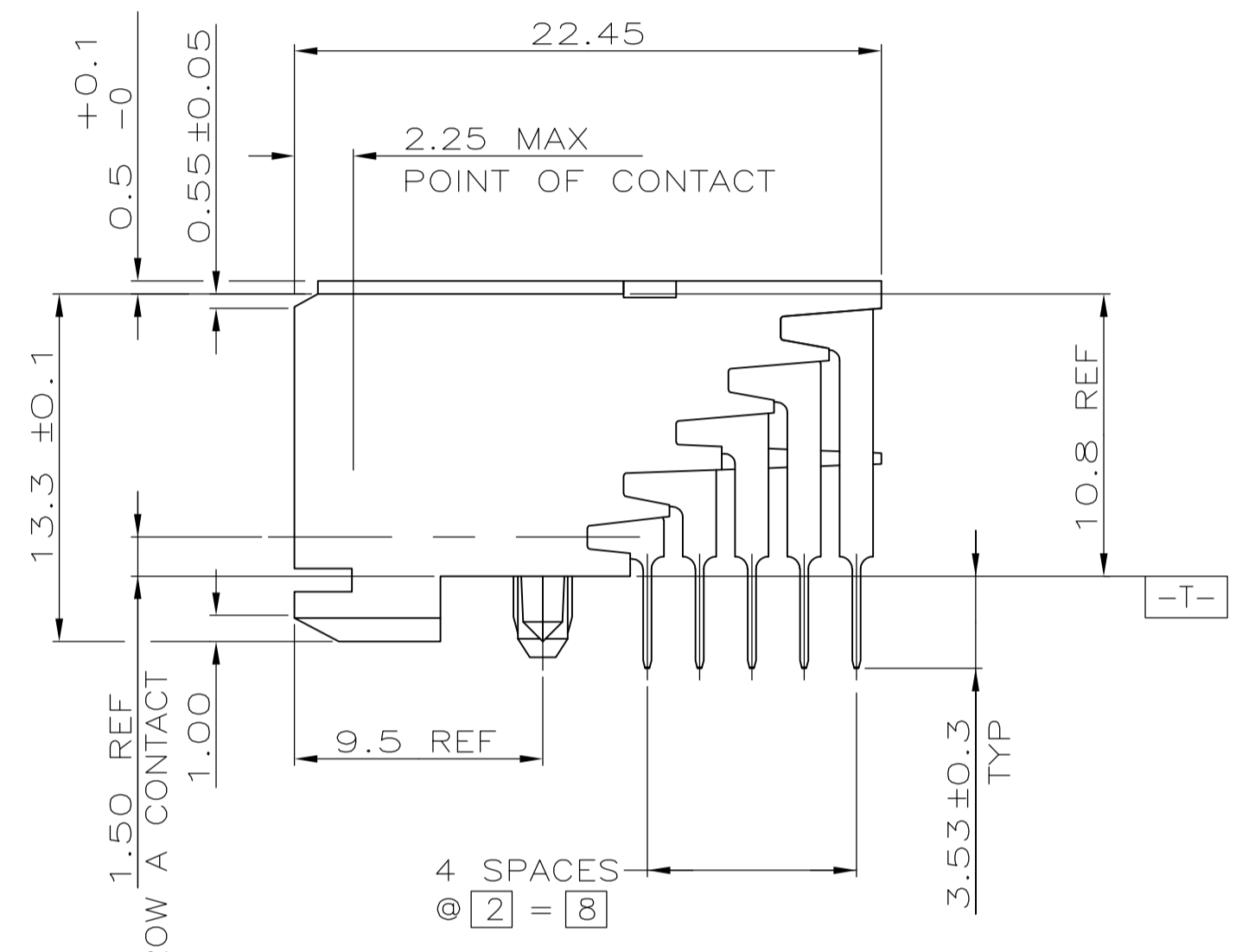
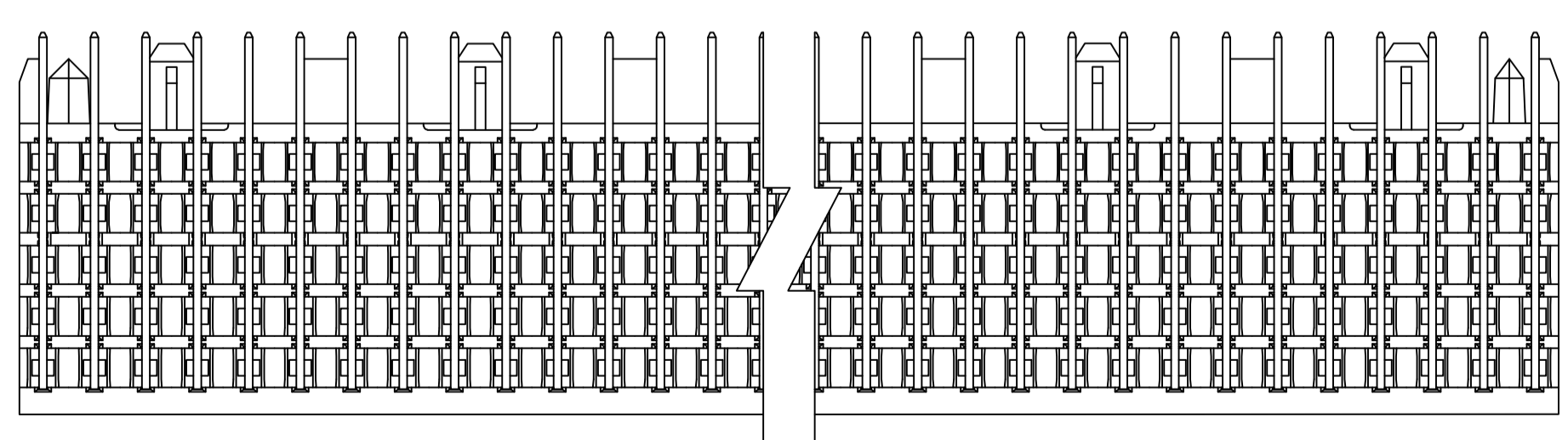
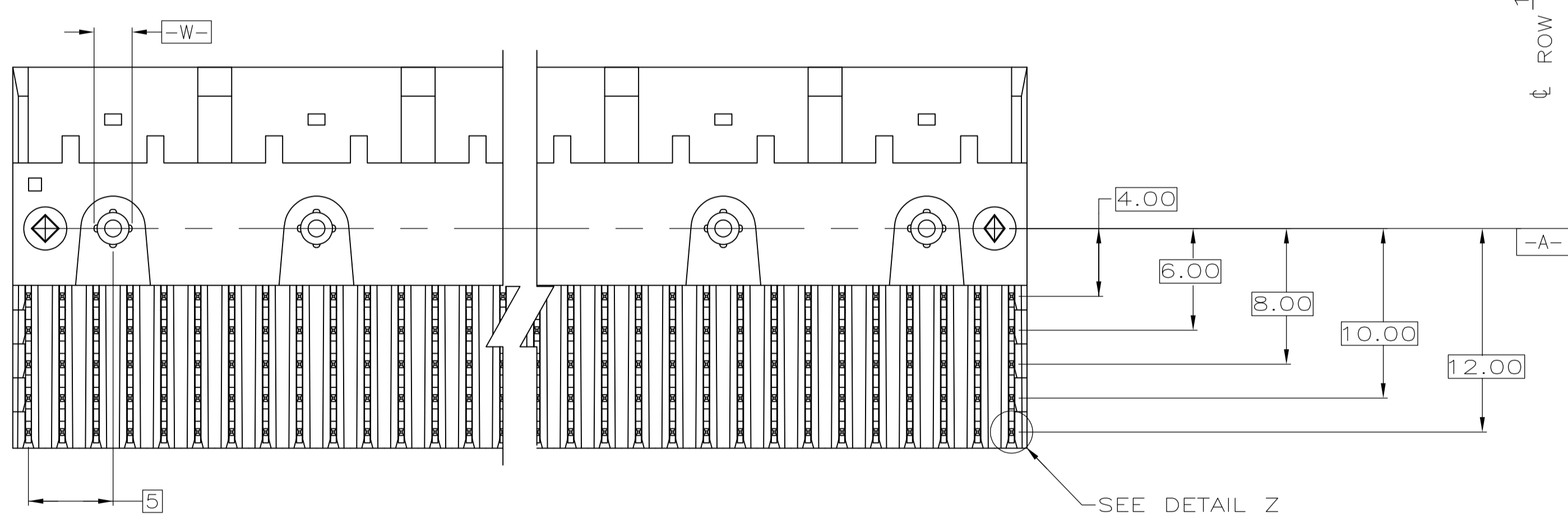
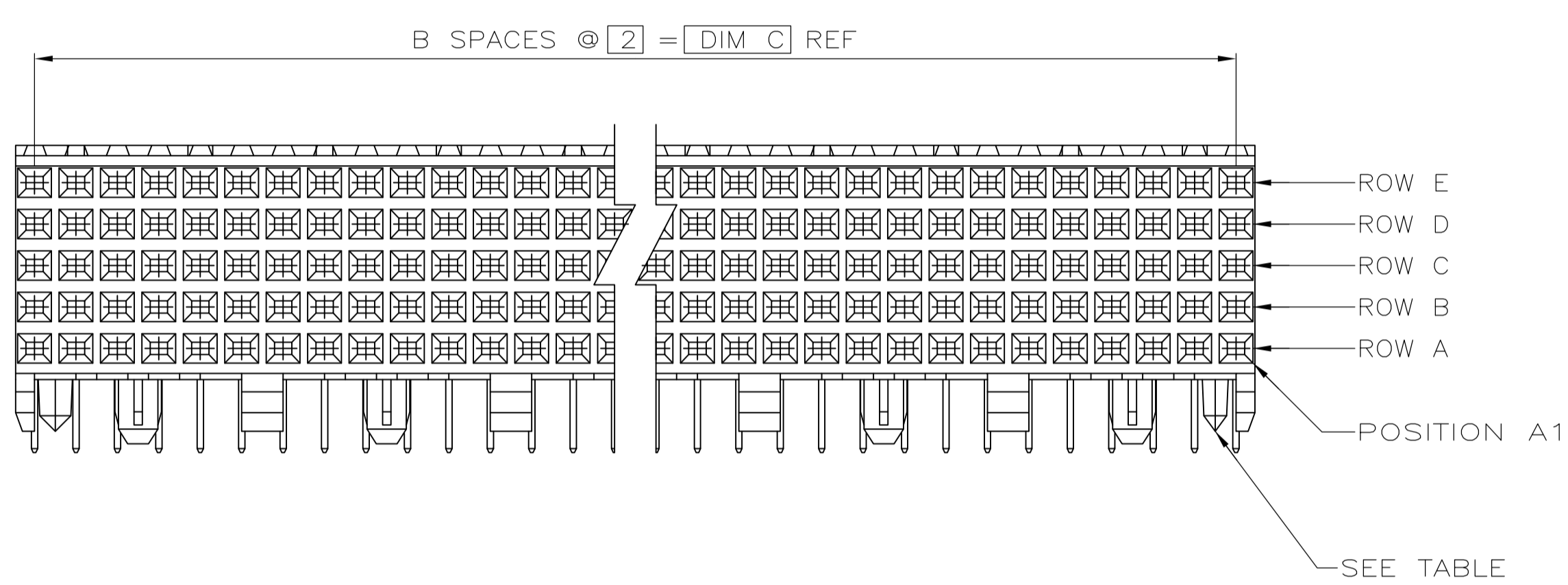
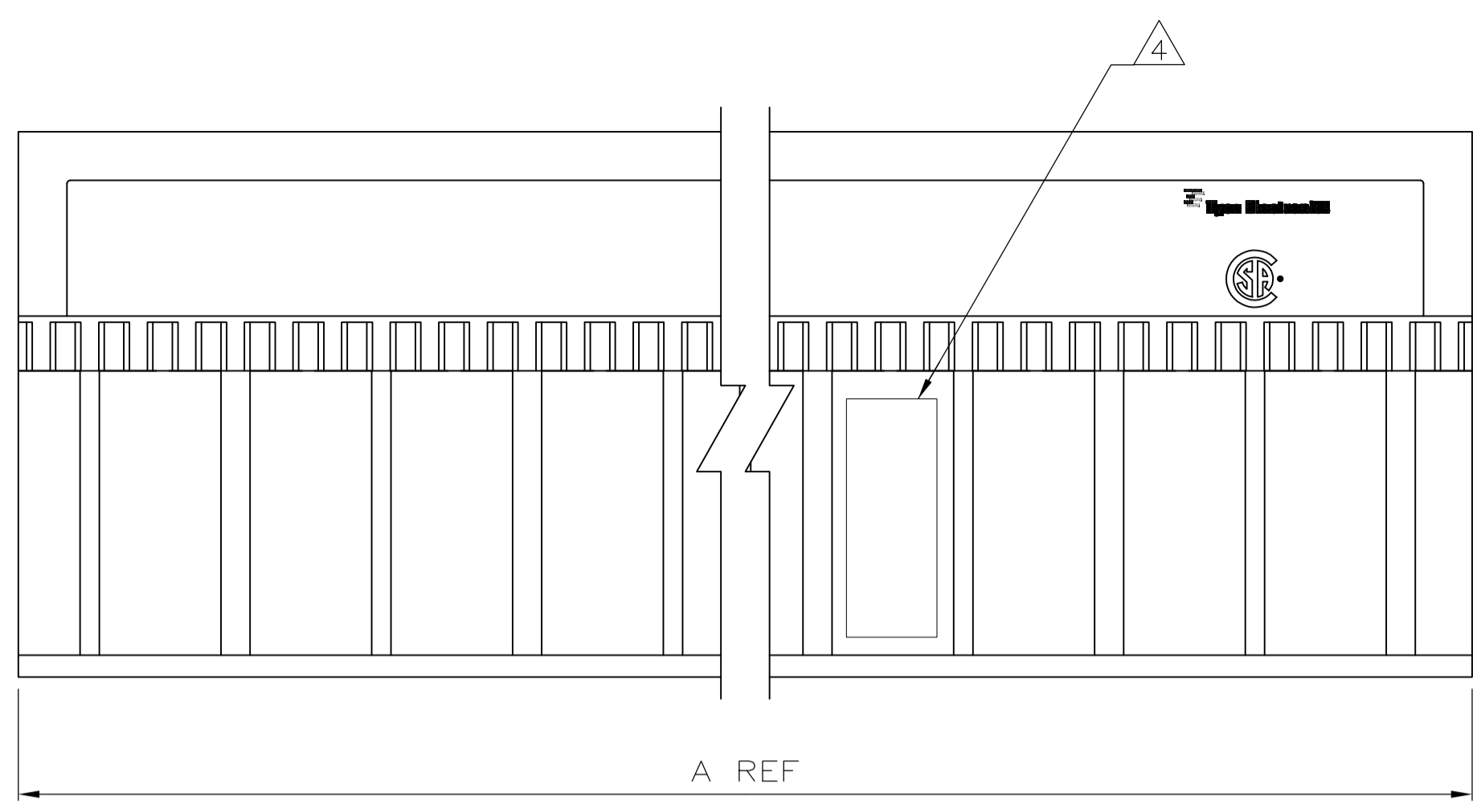

- △ HOUSING MATERIAL: LIQUID CRYSTAL POLYMER  
COLOR: NATURAL.
- △ CONTACT MATERIAL: PHOSPHOR-BRONZE.
- △ CONTACT FINISH:(A)  
UNDERPLATE (ENTIRE CONTACT):  
0.00127 MIN NICKEL PER SAE-AMS-QQ-N-290  
ON MATING SURFACES:  
CONFORMS TO ALL TESTING SPECIFIED FOR TELCORDIA  
UNCONTROLLED ENVIRONMENT.  
ON LEADS:  
0.00381 MIN MATTE TIN PER ASTM B 545 OVER UNDERPLATE.  
LUBRICATION (MIN MATING SURFACES):  
SURFACE CONDITIONER AFTER PLATING.
- △ PART MARKING LOCATED APPROXIMATELY AS SHOWN.
- △ OBSOLETE PARTS: OBSOLETE CIS STREAMLINING PER D.RENAUD/D.SINISI

△ OBSOLETE	NO	130	65	131.88	330	1-5223007-1
	NO	118	59	119.88	300	1-5223007-0
△ OBSOLETE	NO	106	53	107.88	270	1-5223007-9
	NO	94	47	95.88	240	1-5223007-8
	NO	82	41	83.88	210	1-5223007-7
	NO	70	35	71.88	180	1-5223007-6
OBSOLETE	NO	58	29	59.88	150	1-5223007-5
	NO	46	23	47.88	120	1-5223007-4
△ OBSOLETE	NO	34	17	35.88	90	1-5223007-3
	NO	22	11	23.88	60	1-5223007-2
	YES	10	5	11.88	30	1-5223007-1
POSITIONING PEGS		C	B	A	NO OF SIGNAL POSN	PART NUMBER

RECOMMENDED CIRCUIT PATTERN  
 PER IPC-D300 TYPE II, CLASS C  
 (COMPONENT SIDE)

THIS DRAWING IS A CONTROLLED DOCUMENT.

DIMENSIONS:	TOLERANCES UNLESS OTHERWISE SPECIFIED:	APPROVED:	DATE:
mm	0.13	R. WERTZ	19NOV04
0.13	0.13	R. WERTZ	19NOV04
0.13	0.13	R. WERTZ	19NOV04
0.13	0.13	R. WERTZ	19NOV04
0.13	0.13	R. WERTZ	19NOV04
0.13	0.13	R. WERTZ	19NOV04
0.13	0.13	R. WERTZ	19NOV04

THIS DRAWING IS A CONTROLLED DOCUMENT. BY: B. MCMASTER, CHK: R. WERTZ, DATE: 19NOV04, NAME: R. WERTZ, PRODUCT SPEC: ASSEMBLY, RECEPTACLE, SIGNAL, RIGHT ANGLE, Z-PACK 2mm FB, 5 ROW, SOLDER LEAD, APPLICATION SPEC: --, SIZE: A1, CAGE CODE: 00779, DRAWING NO: C=5223007, WEIGHT: --, RESTRICTED TO: --, MATERIAL: --, FINISH: --, CUSTOMER DRAWING: --, SCALE: 4:1, SHEET: 1 OF 1, REV: A2