

STRAIGHT PLUG SOLDER TYPE

R125.055.702

CABLE .141

Series : SMA-27

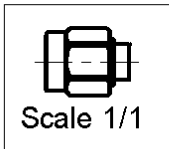
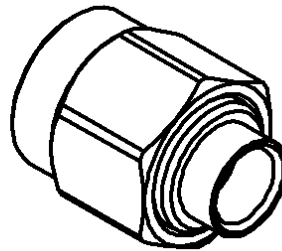
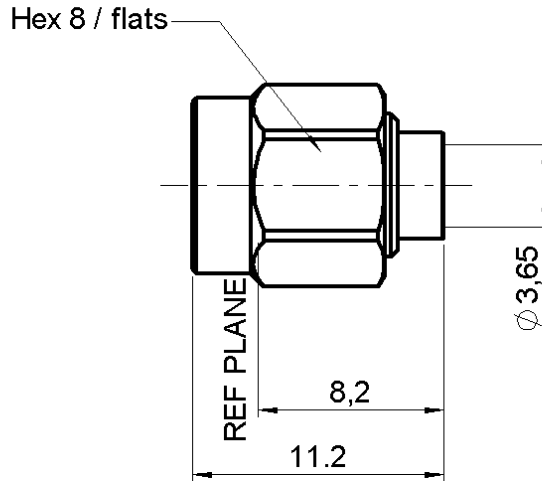

All dimensions are in mm.



COMPONENTS	MATERIALS	PLATINGS (µm)
BODY	STAINLESS STEEL	GOLD 0.5 OVER NICKEL 2
CENTER CONTACT	BRASS	GOLD 1.3 OVER NICKEL 2
OUTER CONTACT	-	-
INSULATOR	PTFE	-
GASKET	SILICONE RUBBER	-
OTHERS PARTS	STAINLESS STEEL	GOLD 0.5 OVER NICKEL 2
-	-	-
-	-	-

Issue : 0203 C

In the effort to improve our products, we reserve the right to make changes judged to be necessary.



STRAIGHT PLUG SOLDER TYPE

R125.055.702

CABLE .141

Series : SMA-27

PACKAGING

Standard	Unit	Other
100	'W' option	Contact us

SPECIFICATION

ELECTRICAL CHARACTERISTICS

Impedance		50	Ω
Frequency		0-27	GHz
VSWR	1.05 +	0.008	x F(GHz) Maxi
Insertion loss		0.03	\sqrt{F} (GHz) dB Maxi
RF leakage	- (90	- F(GHz)) dB Maxi
Voltage rating		500	Veff Maxi
Dielectric withstanding voltage		1000	Veff mini
Insulation resistance		5000	M Ω mini

CABLE ASSEMBLY

Stripping	a	b	c	d	e	f
mm	3.17	0.00	0.00	0.00	0.00	0.00

Assembly instruction :

Recommended cable(s)
RG 402
KS 2

Cable retention

- pull off **270** N mini
- torque **NA** N.cm

MECHANICAL CHARACTERISTICS

Center contact retention			
Axial force – Mating end		NA	N mini
Axial force – Opposite end		NA	N mini
Torque		NA	N.cm mini

Recommended torque			
Mating		100	N.cm
Panel nut		NA	N.cm
Clamp nut		NA	N.cm
A/F clamp nut		0.000	mm

Mating life		500	Cycles mini
Weight		2.226	g

TOOLING

Part Number	Description	Hexagon
.	.	.
R282.053.000	STRIPPING TOOL	
R282.120.000	SMA BOX SOLDER TYPE	
R282.067.000	POINTER GAUGE	

OTHERS CHARACTERISTICS

-

ENVIRONMENTAL

Operating temperature		-65/+105	$^{\circ}$ C
Hermetic seal		NA	Atm.cm ³ /s
Panel leakage		NA	

Issue : 0203 C

In the effort to improve our products, we reserve the right to make changes judged to be necessary.



STRAIGHT PLUG SOLDER TYPE

R125.055.702

CABLE .141

Series : SMA-27

COMPONENTS

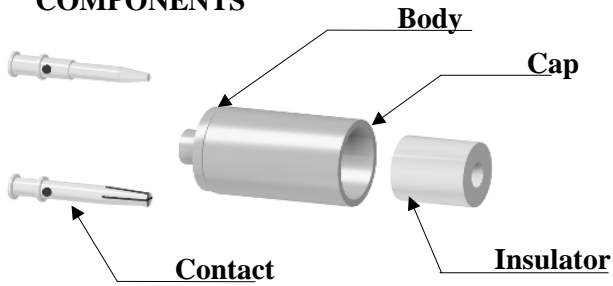

STRIPPING DIMENSIONS

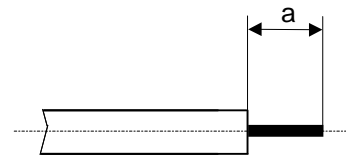

We recommend a cable thermal preconditioning before assembly

1

Strip the cable with the cable stripping tool
Trim the cable inner conductor with the trimmer.
Clean the cable.



3

After cooling, remove the assembly from the jig.
Screw the positioner B onto the assembly jig.
Slide the cable into the connector until it bottoms against the positioner B.
Tighten.
Put three rings of solder around the cable and solder.

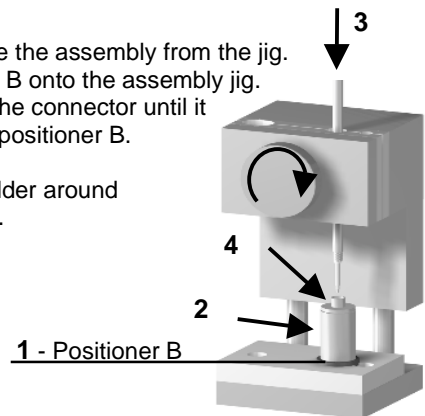

2

Mount the positioner A.
Slide the centre contact into the positioner A.
Insert the solder gauge between the centre contact and the cable.
Tighten.
Solder the centre contact.

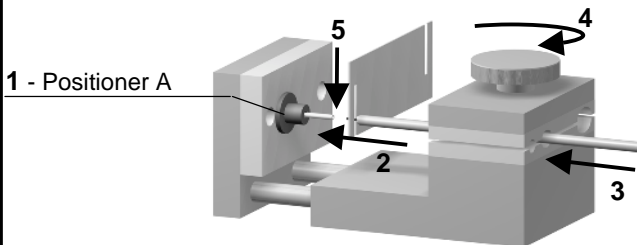

4

After cooling, remove the assembly from the jig.
Screw dielectric recess gauge and trim dielectric.

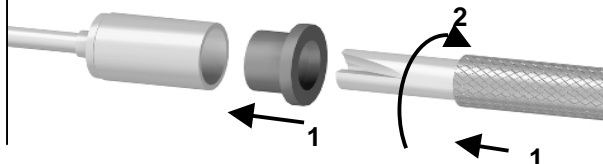

5

Screw dielectric insert tool onto the connector and insert the insulator with the dielectric plunger.

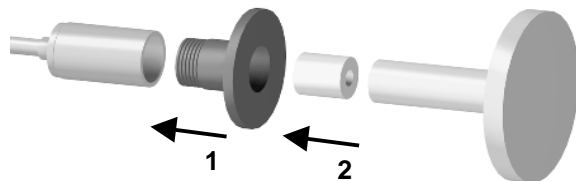

Issue : 0203 C

In the effort to improve our products, we reserve the right to make changes judged to be necessary.

