

REV	DOCUMENT	CHANGED BY	CHECK
6	202793	GRT 10APR01	SAV
7	204628	GRT 3 JAN 02	SAV

2X  $\phi$ .094

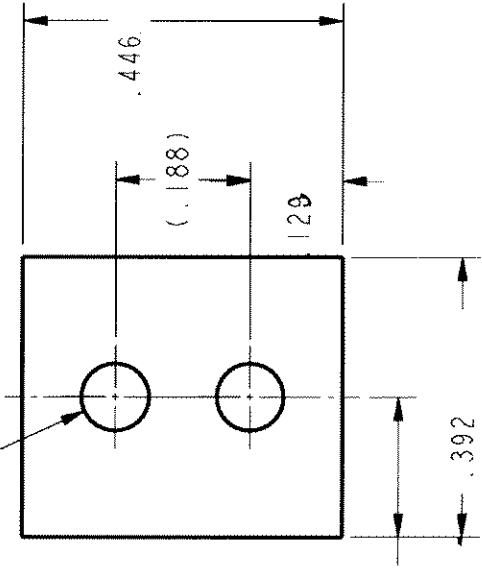

NOTES  
 - MOUNTING HOLES MUST ACCEPT PINS OR SCREWS OF  $\phi$ .087 MAX ON  $.188 \pm .002$  CENTERS  
 - MATERIAL: NEOPRENE COATED FIBERGLASS CLOTH

UNLESS OTHERWISE SPECIFIED TOLERANCES ARE:	<input checked="" type="checkbox"/> US (INCH)	<input type="checkbox"/> METRIC
NO PLACE	$\pm .040$	$\pm 1$
ONE PLACE	$\pm .030$	$\pm 0,4$
TWO PLACE	$\pm .015$	$\pm 0,15$
THREE PLACE	$\pm .005$	$\pm$
ANGLES	$\pm$	$\pm$
RAW MATERIAL - COMMERCIAL STANDARD		

THIRD ANGLE PROJECTION



DRAWN	GRT	10APR01
CHECK	SAV	10APR01
THIS DRAWING COVERS A PROPRIETARY ITEM AND IS THE PROPERTY OF HONEYWELL SENSING AND CONTROL. THIS DRAWING IS NOT TO BE COPIED OR USED WITHOUT THE PERMISSION OF HONEYWELL.		
DIMENSIONS ARE TO BE MET BEFORE PROTECTIVE COATINGS ARE APPLIED		
PTC3D	ASME Y14.5M-1994	

<b>Honeywell</b>	
Sensing and Control	
TITLE	
<b>INSULATOR, ELECTRICAL</b>	
SIZE DWG TYPE	DRAWING NAME
<b>A</b>	<b>JX-10131</b>
SCALE 4 :	SHEET 1 OF 1

REV	7
SIZE DWG TYPE	DRAWING NAME
<b>A</b>	<b>JX-10131</b>
SCALE 4 :	SHEET 1 OF 1