

REV	ECN	APP'D
-	4520	IQ 8/21/01
A	4646	IQ 11/7/01
B	4752	IQ 2/12/02
C	5742	PN 12/28/05

## ELFH SERIES PART NUMBERING SCHEME

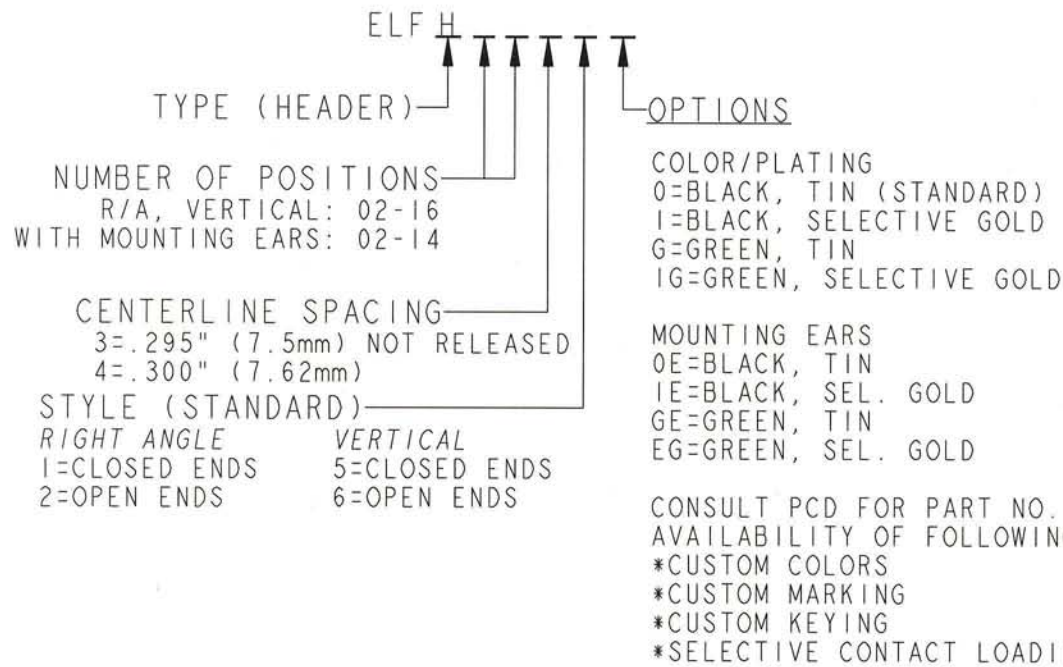

**RU RATINGS**

CURRENT - 15A  
VOLTAGE - 300V  
U.L. FILE NO. PENDING

**SA RATINGS**

CURRENT - 15 A  
VOLTAGE - 450 V  
CSA FILE NO. PENDING

DIN VDE 0627:1986  
DIN VDE 0110-1:1989  
EN 60947-1:1991  
EN 60947-7-1:1992

CURRENT - 15 A  
VOLTAGE - 450 V  
TUV FILE NO. PENDING

**MATERIALS:**  
HOUSING: PPT, UL 94 V-0  
CONTACT: BRASS

**MAX OPERATING TEMPERATURE:**  
105°C

<b>DIMENSIONS</b> ANSI Y14.5M UNITS: INCHES Pro/E FILE	<b>TOLERANCES</b> .XX ±0.01 .XXX ±0.005 ANGLES ±1.0°	<b>PROJECTION</b> 	<b>Amphenol Pcd</b>		<b>TITLE</b> ELFH SERIES HEADER ASSEMBLY 7.5mm/.300 PITCH		
			ENGR S.HORNER 01-Aug-01		SIZE	DWG NO.	REV
ORIGINAL STAMPED IN RED			CHKD I. QUINN 8/21/01		A	ELFH02410	C
THIS DOCUMENT CONTAINS PROPRIETARY INFORMATION WHICH IS THE CONFIDENTIAL PROPERTY OF AMPHENOL PCD, INC. PEABODY, MA, USA			APPD I. QUINN 8/21/01		CODE: 58982	SCALE: NONE	SHEET 1 OF 2

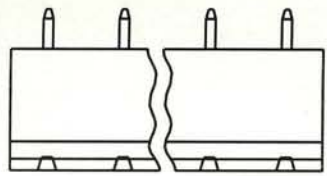

CLOSED ENDS

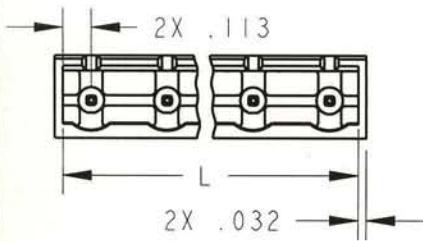

VERTICAL

RIGHT ANGLE

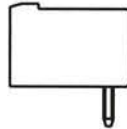

$$L = (\text{NUM OF POS} \times \text{CL}) - .074$$

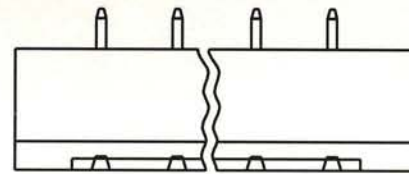

MOUNTING EARS

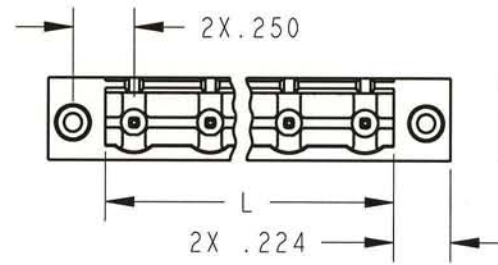

VERTICAL

RIGHT ANGLE

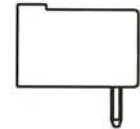

$$L = (\text{NUM OF POS} \times \text{CL}) - .074$$

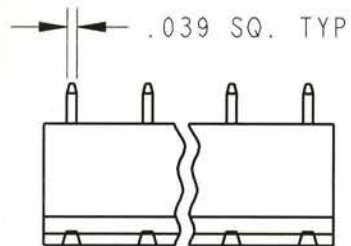

OPEN ENDS

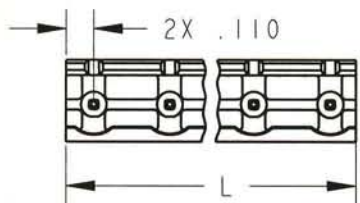

VERTICAL

RIGHT ANGLE

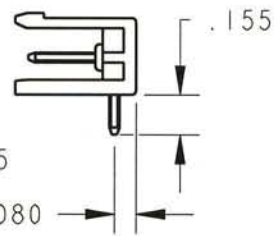
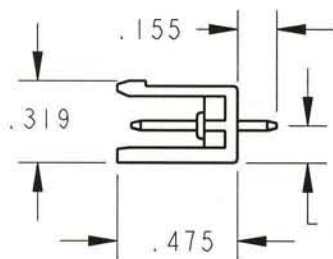

$$L = (\text{NUM OF POS} \times \text{CL}) - .100$$

PRINTED CIRCUIT BOARD CONFIGURATION

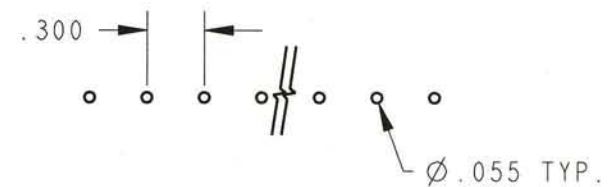

RECOMMENDED PCB THICKNESS: .062 ± .008

SIZE	DWG NO.	REV
A	ELFH02410	C
CODE: 58982	SCALE: NONE	SHEET 2 OF 2