

WADI rail cable gland

K160-1xxx-zz

Dome nut	Brass CuZn39Pb3, nickel-plated
Sealing insert	TPE TPS
Gland body	Brass CuZn39Pb3, nickel-plated
O-ring	Nitrile rubber NBR
Connecting thread	metric, as per EN 60423



Properties

- tested fire resistance Integrity criterion E30 according to EN 45545-3
- material of the sealing insert fulfills superior claims on fire protection according to UL 94 V-0 and EN 45545-2, R22: HL3 / R23: HL3
- large-area sealing protects the cable
- increased anchorage with high retention
- wide sealing and clamping range
- halogen-free
- high UV, ozone and weather resistance

Temperature range -60°C / +100 °C (dynamic)

Protection grade IP66 / IP67 / IP69

Test standard
EN 62444
EN 45545-2
EN 45545-3

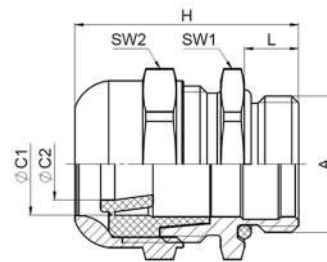

Features

Connecting thread standard length

A	ØC	Ø C1	Ø C2	L	SW1	SW2	H		Part No.
M12x1, 5	3 - 8	3 - 5	5 - 8	6,5	16	16	25,5	100	K160-1012-00
M16x1, 5	5 - 10,5	5 - 7,5	7,5 - 10,5	7,0	20	20	31,5	100	K160-1016-00

A	ØC	Ø C1	Ø C2	L	SW1	SW2	H	 VPE	Part No.
M20x1, 5	8 - 15	8 - 10,5	10,5 - 15	8,0	25	25	33	50	K160-1020-00
M25x1, 5	12,5 - 20,5	12,5 - 15,5	15,5 - 20,5	8,0	32	32	35,5	50	K160-1025-00
M32x1, 5	17 - 25,5	17 - 20,5	20,5 - 25,5	9,0	36	36	40,5	25	K160-1032-00
M40x1, 5	24 - 33	24 - 29	29 - 33	9,0	45	45	43	10	K160-1040-00
M50x1, 5	31 - 42	31 - 37,5	37,5 - 42	10,0	55	55	47,5	5	K160-1050-00
M63x1, 5	40 - 53	40 - 46	46 - 53	10,0	70	70	53	5	K160-1063-00