

Recommended Panel Cut-out

21XXX515-01
Pin Number

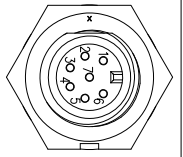
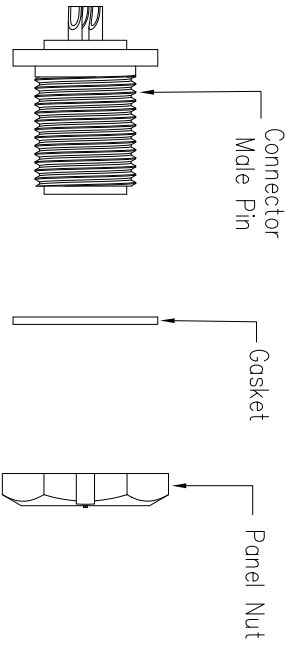
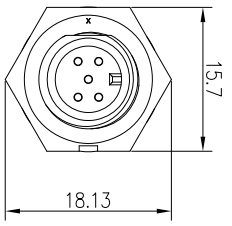
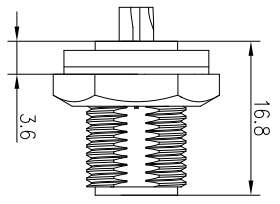
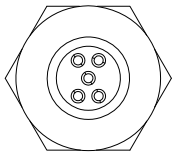

7 Pin

P/N: 21007515-01

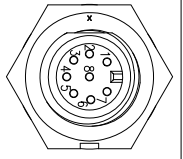

8 Pin

P/N: 21008515-01

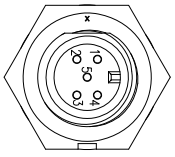
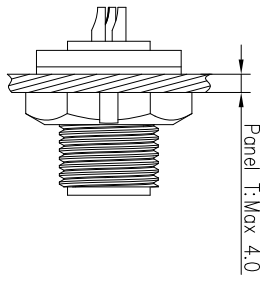

5 Pin

P/N: 21005515-01

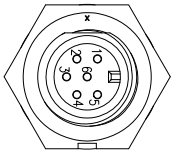

6 Pin

P/N: 21006515-01

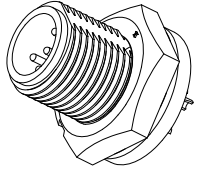

Pin Assignments Front View

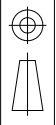

UNIT: mm
DESCRIPTION: Mini Series Screw Type Front Mount With Male Pin

TOLERANCE	±0.25	SCALE	4:5	SHEET	1 OF 1
.X	±0.15	REV	C1	SIZE	A4
.XX	±0.05	* : Inspection Item			
.XXX	±1°				
ANGLES					

REV.	EN. NO.	DESCRIPTION	SIGN	DATE
C1	N/A	INITIAL DRAWING	Victory	2019/08/20

- Specification:
1. Operation Temperature: -45°C~105°C.
 2. Insulation Resistance: 100MΩat DC 500V.
 3. Contact Resistance: <10mΩ.
 4. Withstand Voltage: 1500V AC.
 5. Operating Current: 2A.
 6. Operating Voltage: AC 50V.
 7. Waterproof Rate: IP67(Mated).
 8. Connector: Nylon+GF, Black.
 9. Panel Nut: Nylon, Black.
 10. Gasket: Silicon, Gray.
 11. Male Pin: Copper Alloy, Gold Plated.
 12. Torque Rate: 0.5~0.7N•m.
 13. RoHS Compliant.
 14. UL Compliant.
 15. Mating Cap P/N: 806-00028-00

PART NO	21XXX515-01	DRAWN BY	Victory	DATE	2019/08/20
DWG NO		CHECKED BY	Ivon	DATE	2019/08/20
CUSTOMER		APPROVED BY	Ponson	DATE	2019/08/20

