

.050" [1.27mm] CONTACT CENTERS [PCI]

DIMENSIONS

Dimensions in [] are in millimeters, all others in inches

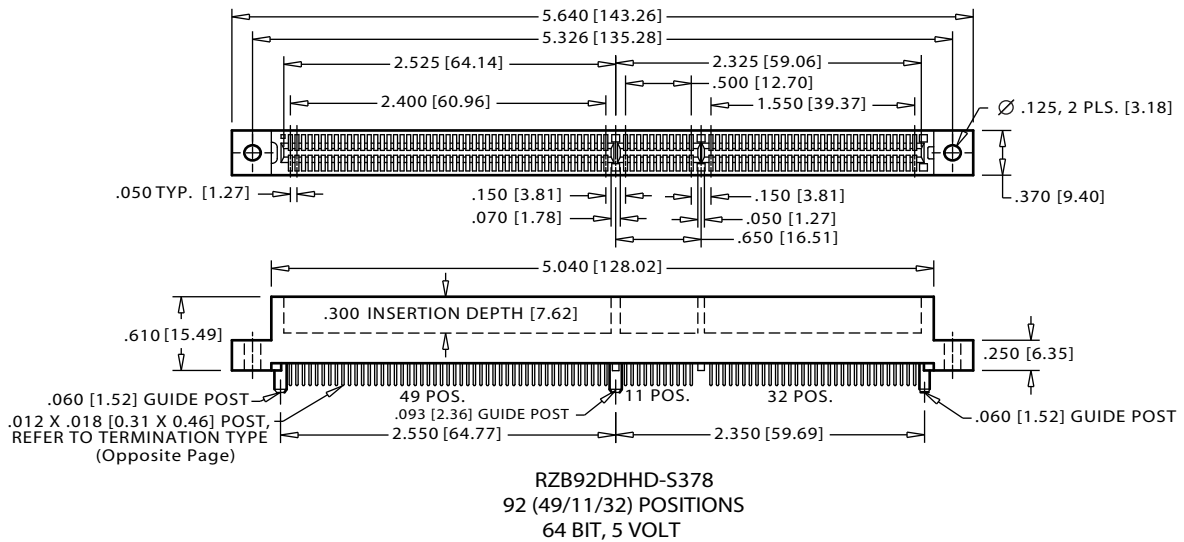
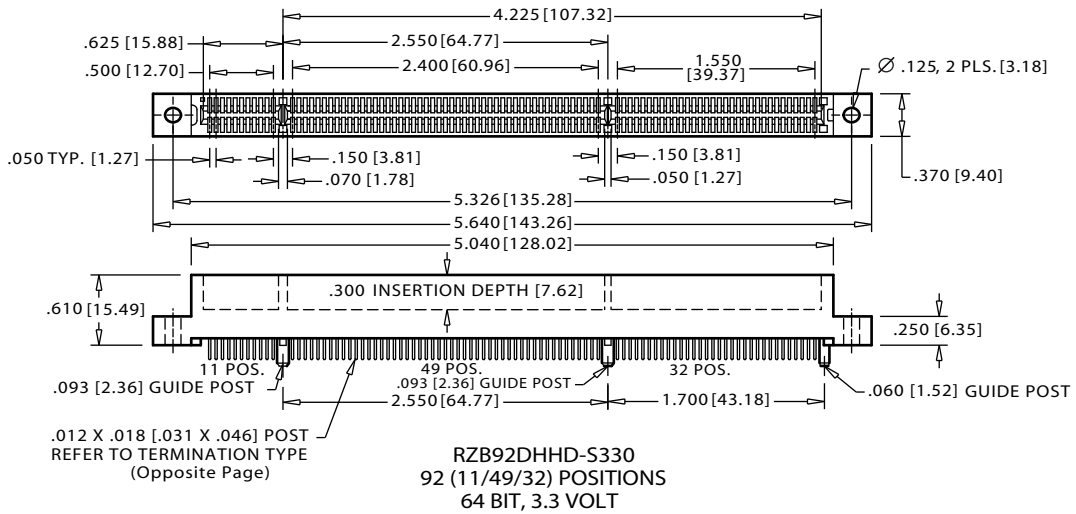
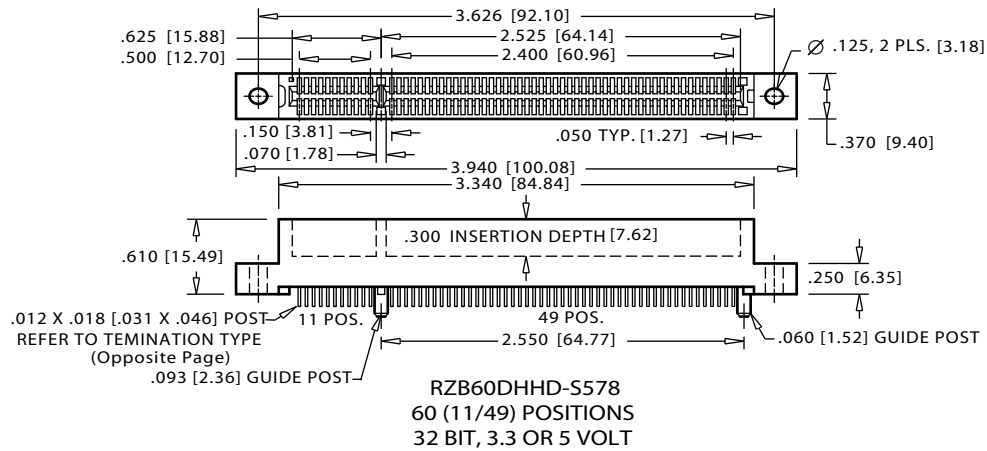

.050" [1.27mm] CONTACT CENTERS [PCI]

PART NUMBER CODING

R Z B 60 D HH D -S578

MATERIALS (Insulator/Contact)

R = PPS/Phosphor Bronze
 A = PPS/Beryllium Copper
 L = PCT/Phosphor Bronze
 M = PCT/Beryllium Copper
 Consult Factory for Other Materials

CONTACT FINISH

| Contact Surface | Termination | Underplate |
|-------------------|--------------|-----------------|
| Z = .000010" Gold | .000100" Tin | .000050" Nickel |
| X = .000030" Gold | .000100" Tin | .000050" Nickel |

CONTACT CENTERS

B = .050" [1.27 mm]

NUMBER OF CONTACT POSITIONS

60 = 11/49 (32 Bit, 3.3 or 5 Volt)
 92 = 11/49/32 (64 Bit, 3.3 Volt)
 or 92 = 49/11/32 (64 Bit, 5 Volt)

READOUT

D = Dual

MODIFICATIONS

PCI WITH GUIDE POSTS:

-S330 = 92 (11/49/32) Positions (64 Bit, 3.3 Volt)
 -S378 = 92 (49/11/32) Positions (64 Bit, 5 Volt)
 -S578 = 60 (11/49) Positions (32 Bit, 3.3 or 5 Volt)

PCI WITHOUT GUIDE POSTS:

-S329 = 92 (11/49/32) Positions (64 Bit, 3.3 Volt)
 -S250 = 92 (49/11/32) Positions (64 Bit, 5 Volt)
 -S621 = 60 (11/49) Positions (32 Bit, 3.3 or 5 Volt)

MOUNTING STYLE

D = Flush Mounting
 N = No Mounting
 T = Flush Mounting With Threaded Insert
 Q = Straddle Mount
 R = Metal Boardlocks

TERMINATION TYPE

HH = Staggered Dip Solder
 HR = Card Extender
 HF = Surface Mount
 HL = .250" [6.35mm] x .160" [4.06mm] Dip Solder

READOUT

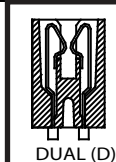

DUAL (D)

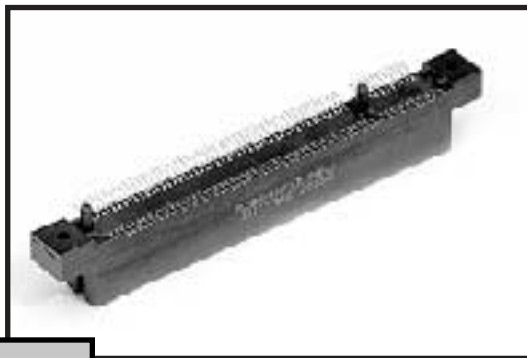

FEATURES

- * Accommodates .062 ±.008" PC board (Consult factory for other board thicknesses)
- * PPS or PCT insulator
- * Molded-in key available
- * High reliability/high cycle hairpin bellows contact
- * 1 amp current rating
- * 150 grams normal force minimum

TERMINATION TYPE

FOR PC BOARD LAYOUTS REFER TO WWW.EDGE CARDS.COM

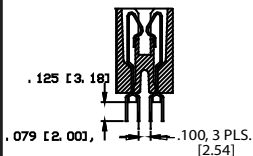

STAGGERED DIP SOLDER (CH)

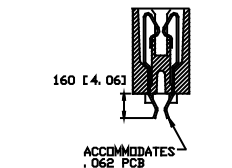

CARD EXTENDER (CR)

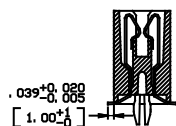

SURFACE MOUNT (CF)

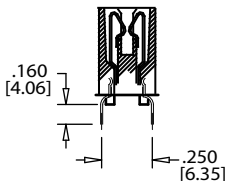

DIP SOLDER (CL)

MOUNTING STYLE

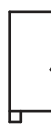

NO MOUNTING EARS (N)

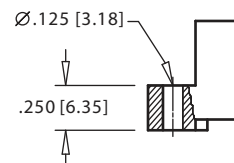

FLUSH MOUNTING (D)

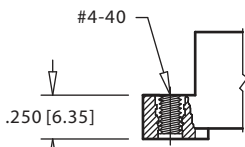

FLUSH MOUNTING WITH THREADED INSERT (T)

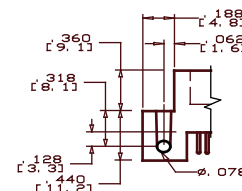

STRADDLE MOUNT (Q)
Formally (Z)

