

# 1032X225H-SS

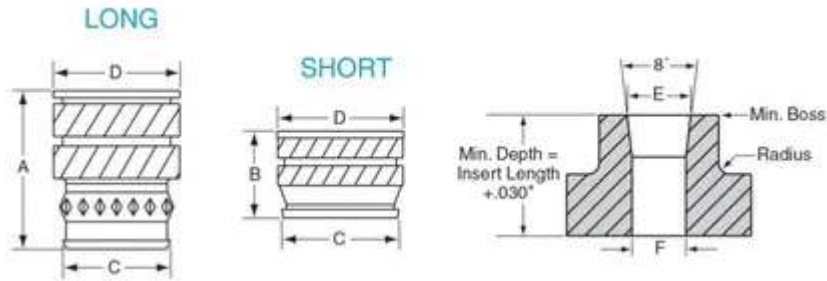

B	0.225 in
Boss Size	0.554 in
Brand	RAF
C	0.272 in
D	0.297 in
F	0.267 in
Finish	None
Length E	0.277 in
Material	Stainless Steel
Series	H
Thread Size	10-32

## PRODUCT OPTIONS

<b>Finish</b>
None
Black Oxide (26)
Chrome - Bright (10)
Chrome - Satin (11)
Chrome over Nickel (4)
Passivate - AMS 2700 TYPE 2 (48)
Passivate - ASTM A 380-96 (47)



Passivate - ASTM A 967 Nitric 1 (46)
Passivate - QQ-P-35C Type VI (45)
Passivation (20)

