

LOADING PATTERN MATING SIDE

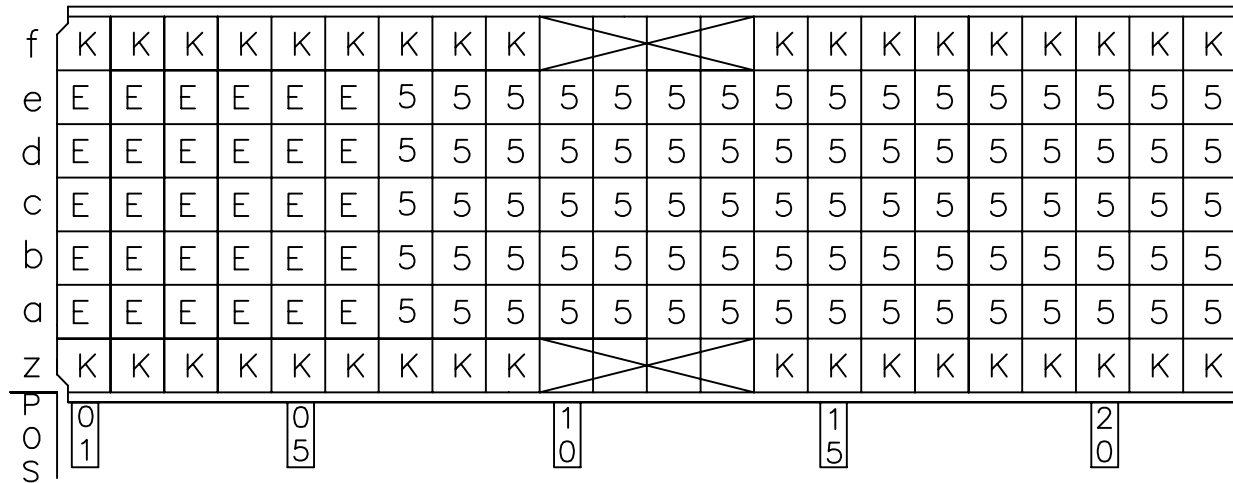

LOADED CONNECTOR ASSEMBLY (FOR EXAMPLE)

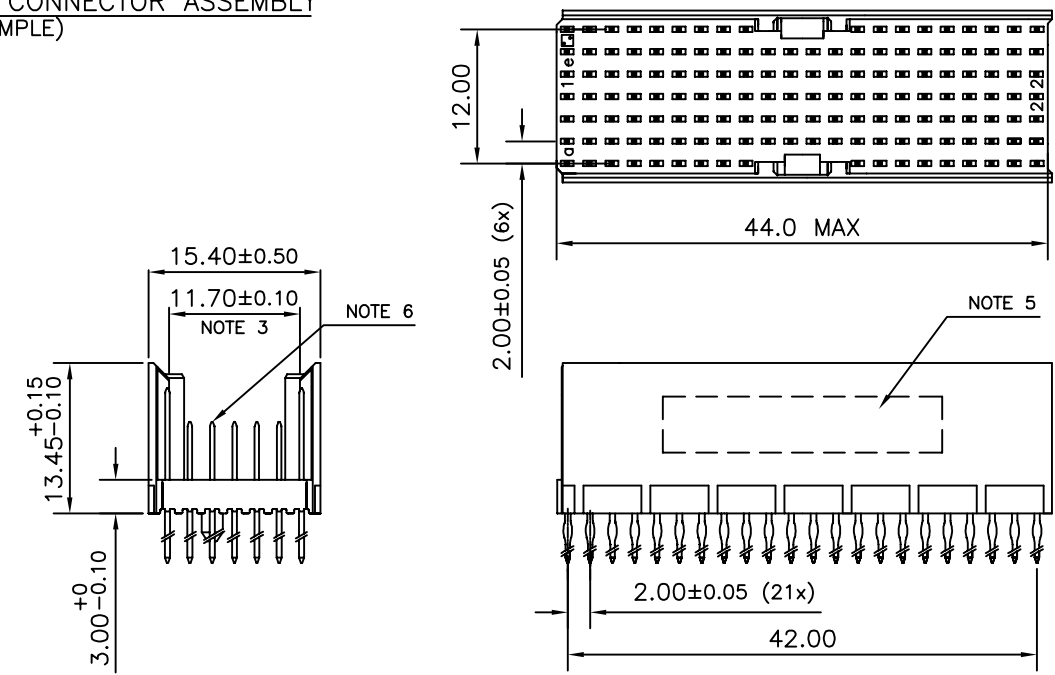

CONTACT OVERVIEW

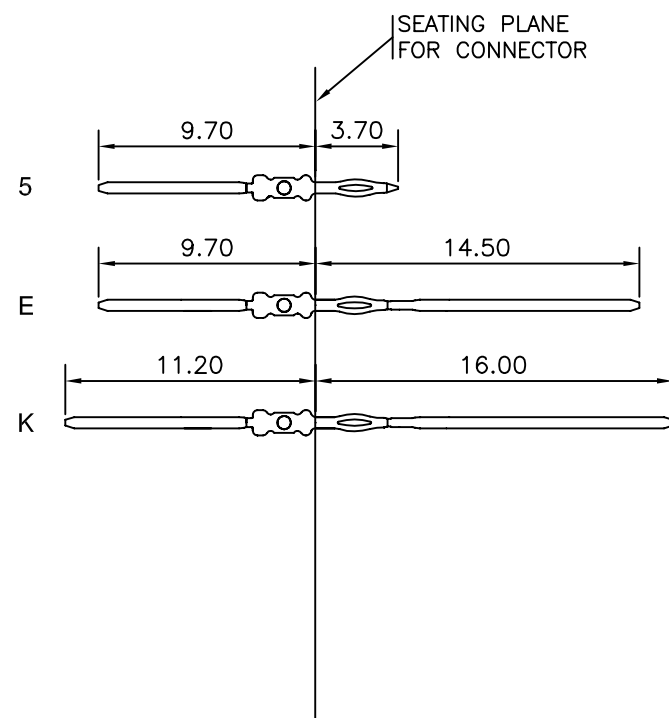

LAY-OUT P.C.B.-HOLE

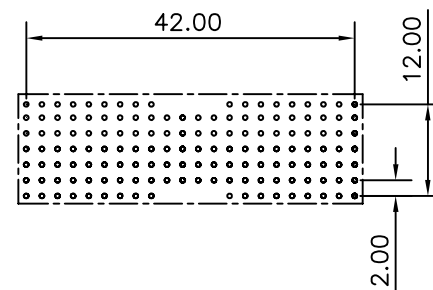

HM2P66PMA3U4 **LEAD FREE INDICATOR : LF = LEAD FREE (DIGIT 15 & 16)**

PLATING CODE (DIGIT 13 AND 14)
(REF DRW NO. BS,C , 201844 , 003)

NOTES

- THIS PRODUCT IS CSA APPROVED.
- THIS PRODUCT IS UL RECOGNIZED.
- MEASURED AT THE BOTTOM.
- MATERIAL CONTACT: PHOSPHORBRONZE
HOUSING: CREAM WHITE GLASS FILLED POLYESTER UL-94V0
- CONNECTOR PRINTED WITH P/N AND DATE CODE.
- FOR ACTUAL CONTACT LOADINGS, SEE LOADING PATTERN MATING SIDE.
- SHAPE OF CONNECTOR HOUSING CAN ALTER DEPENDING ON PRODUCTION LOCATION
- THE PRODUCT (LF) MEETS EUROPEAN UNION DIRECTIVES AND OTHER COUNTRY REGULATIONS AS DESCRIBED IN GS-22-008
- FOR RECOMMENDED PTH DIMENSIONS REFER DRAWING : BS, A , 201572 , 001

CATALOG NO: HM2P66PMA3U4----

| | | | | | |
|---------------------------|----------|-----------------------|-------------------------------|------------------|---------------------------------------|
| mat'l. code SEE NOTE 4 | | surface ISO 1302 ✓ | tolerance ISO 406 ISO 1101 | projection MM | product family MILLIPACS |
| ltr | | ecn no | dr | date | tolerances unless otherwise specified |
| A | 104-0019 | MINI | 2004/03/15 | | .0±0.2 |
| B | 105-0187 | MINI | 2005/10/13 | | .00±0.1 |
| C | 106-0090 | MINI | 2006/06/26 | | 0°±1° |
| | | dr | MINI K VANDANATH | 2004/03/15 | |
| | | enr | BIJU K PAUL | 2004/03/15 | |
| | | chr | BIJU K PAUL | 2006/06/26 | |
| | | appd | BIJU K PAUL | 2006/06/26 | |
| sheet index | | revision | c | 1 | |
| | | sheet | | | |
| | | dwg no | | sheet 1 of 1 | size 5 |
| | | BS, C ,203028, 117 | | | A3 |
| | | type | | Product Customer | Drawing |