

| REVISIONS | | | |
|-----------|---------------------------|-----------|--------|
| REV | DESCRIPTION, ECN, EAR NO. | DATE | APP'D |
| A | PROPOSAL | APR 08/18 | L.CHAN |

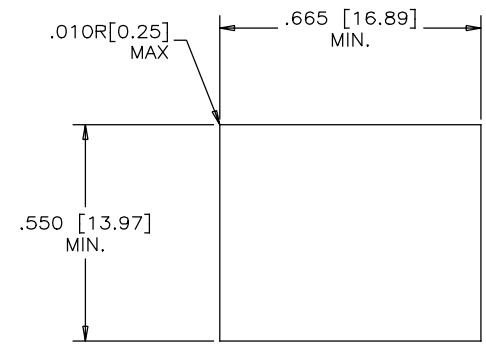

RECOMMENDED PANEL CUTOUT

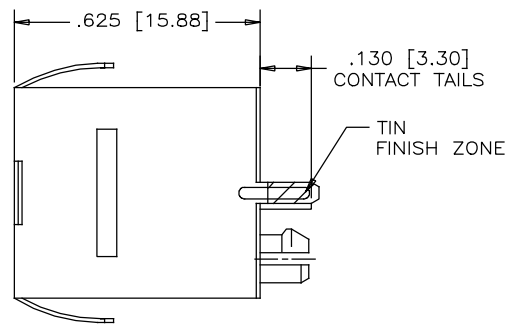
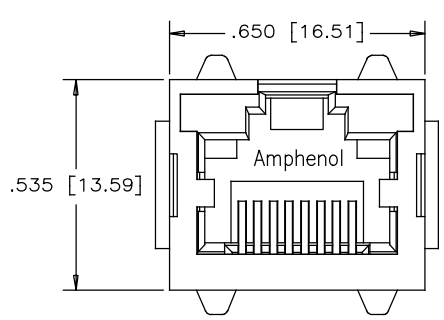
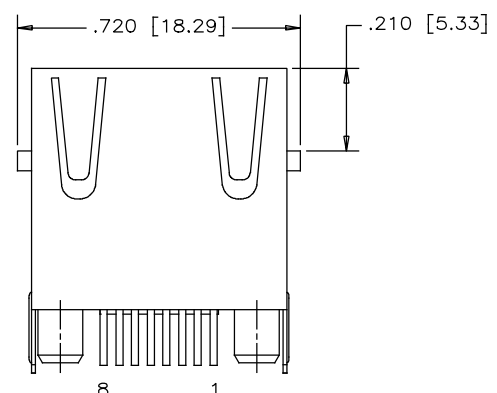

MATERIALS:

PLASTIC HOUSING: HIGH TEMPERATURE THERMOPLASTIC
 FLAMMABILITY RATING UL 94V-0
 COLOR: BLACK

CONTACTS: PHOSPHOR BRONZE
 PLATING: 30 μ" [0.76 MICRONS]
 MIN. GOLD ON MATING SURFACES.
 50 μ" [1.27 MICRONS]
 MIN. NICKEL UNDERPLATE
 100 μ" [2.54 MICRONS]
 MIN. MATTE TIN ON CONTACT TAILS.

SHIELD: STAINLESS STEEL WITH TIN FINISH ON SOLDER TAILS

RECOMMENDED SOLDERING TEMPERATURE:
 WAVE SOLDERING TEMPERATURE AT 260°C MAXIMUM
 FOR 5 SEC MAXIMUM.

AMPHENOL PART NUMBER: RJHSE-3P80-A1

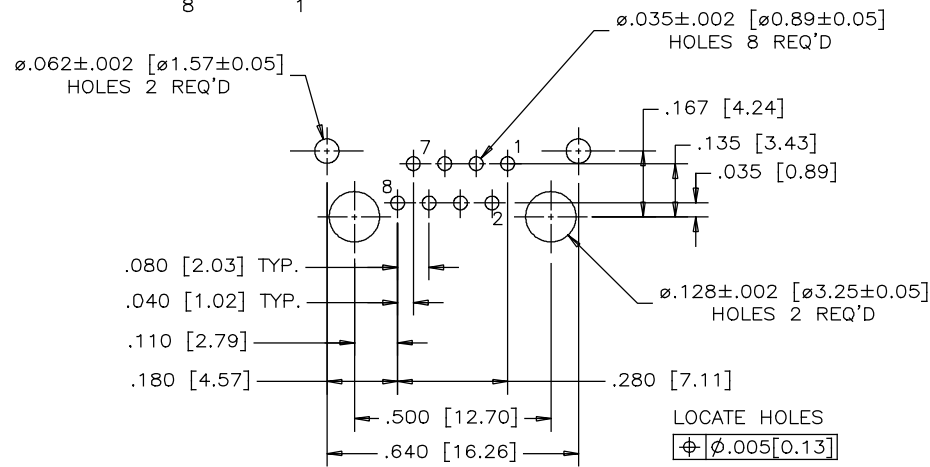

RECOMMENDED P.C.B. LAYOUT
 (COMPONENT SIDE OF BOARD)
 LOCATE HOLES
 $\phi \pm 0.005 [0.13]$
 POSITION DIMENSIONS
 ARE BASIC

| | | | | | |
|----------------------------|--|------------------------|--------|----------------------|-----------|
| UNLESS SPECIFIED OTHERWISE | | DRAWN | W.QIU | DATE | APR 08/18 |
| PRIMARY UNITS INCH | | CHECKED | L.CHAN | DATE | APR 08/18 |
| SECONDARY MILLIMETERS | | M.E. APP'D | | | |
| REFERENCE IN PARENTHESES | | Q.A. APP'D | | | |
| GENERAL TOLERANCES | | DWG APPR. | | | |
| 1 DECIMAL PLACE ±0.025 | | ENG. REL. NO. | | | |
| 2 DECIMAL PLACES ±0.020 | | REF. | | | |
| 3 DECIMAL PLACES ±0.015 | | THIRD ANGLE PROJECTION | | DO NOT SCALE DRAWING | |
| ANGULAR DEGREES ±1.0° | | | | | |

| | | | |
|---|-----------------|------------------------|--------|
| Amphenol Canada Corp. | | www.amphenolcanada.com | |
| TITLE | | | |
| SINGLE-PORT HIGH SPEED MODULAR JACK, 8 POSITIONS, 8 FLAT CONTACTS, SHIELD WITH TOP & BOTTOM TABS - RoHS COMPLIANT | | | |
| DWG. NO. | P-RJHSE-3P80-A1 | | |
| REV | A | | |
| CODE ID NO. | 03554 | DWG SIZE: | C |
| SCALE: | N/A | SHEET | 1 OF 1 |