

# 5mm x 20mm FUSE HOLDERS

## SLIM LINE

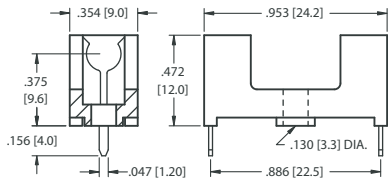

Mounting Detail

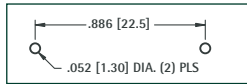

- Optional cover with window protects and insulates fuse
- Flame Retardant
- Not UL rated

**CAT. NO. 4628 - Holder**

**CAT. NO. 4628C - Cover only (with window)**

### SPECIFICATIONS

**Base & Cover:** Nylon,  
UL Rated 94V-0  
**Clips:** Brass, Tin Plate  
**Rated:** 5 Amps @ 250V AC

## LOW PROFILE

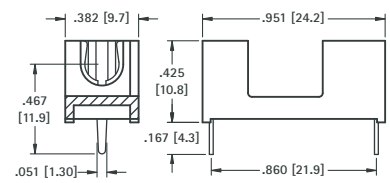

Mounting Detail

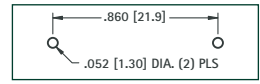

- Low profile, space saving design
- Optional cover protects and insulates fuse
- Flame Retardant
- Not UL rated

**CAT. NO. 4527 - Holder**

**CAT. NO. 4527C - Cover only**

### SPECIFICATIONS

**Base & Cover:** Nylon,  
UL Rated 94V-0  
**Clips:** Brass, Tin Plate  
**Rated:** 5 Amps @ 250V AC

## FULLY INSULATED

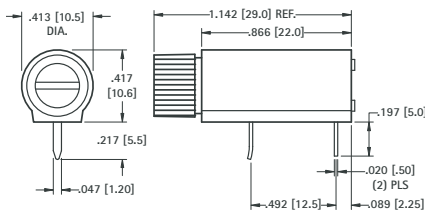

Mounting Detail

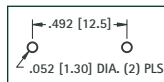

- Supplied unassembled
- Shock resistant
- Fuse can be accessed from board edge
- Fuse is completely enclosed, protecting use from shorting and breaking
- Not UL rated

**CAT. NO. 4525**

### SPECIFICATIONS

**Base:** PBT  
**Contacts:** Brass, Tin Plate  
**Rated:** 10 Amps @ 250V AC

## PC SNAP-IN

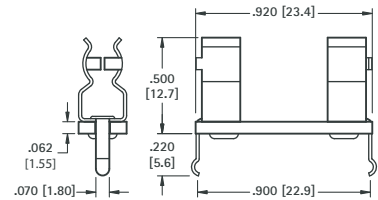
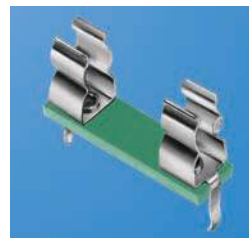

Mounting Detail

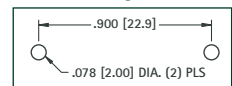

- Snap-in design for wave soldering
- Flame Retardant
- Optional cover protects and insulates fuse - **Cat. No. 3527C**

**CAT. NO. 3527 - Holder**

### SPECIFICATIONS

**Base:** .062 (1.57) FR-4, UL Rated 94V-0  
**Clips:** Brass, Tin Plate  
**UL Rated:** 6.3 Amps @ 250V AC

# 3AG FUSE HOLDERS



## TERMINATION LUGS CAN BE USED WITH WIRES OR PC MOUNT

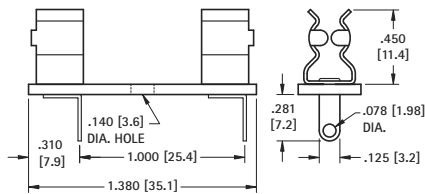

Mounting Detail

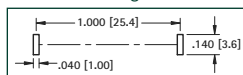

**SPECIFICATIONS**  
**Base:** .062 (1.57) FR-4, UL Rated 94V-0  
**Clips:** Brass, Tin Plate  
**UL Rated:** 15 Amps @ 500VAC

**CAT. NO. 3526**

Optional cover available - **Cat. No. 4245C**

## PRESS-FIT, IDEAL FOR WAVE SOLDERING

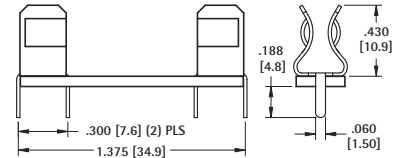

Mounting Detail

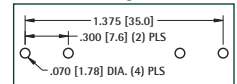

**SPECIFICATIONS**  
**Base:** .062 (1.57) FR-4, UL Rated 94V-0  
**Clips:** Brass, Tin Plate  
**UL Rated:** 15 Amps @ 500VAC

**CAT. NO. 4245**

Optional cover available - **Cat. No. 4245C**

## SNAP-IN DESIGN ASSURES STABILITY DURING WAVE SOLDERING

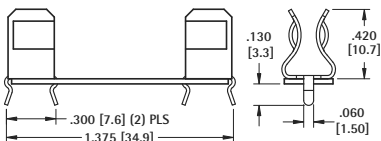

Mounting Detail

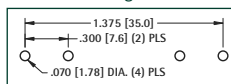

**SPECIFICATIONS**  
**Base:** .032 (1.57) FR-4, UL Rated 94V-0  
**Clips:** Brass, Tin Plate  
**UL Rated:** 15 Amps @ 500VAC

**CAT. NO. 4250**

Optional cover available - **Cat. No. 4245C**

## MOLDED CASE

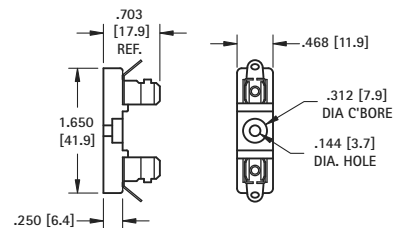

**SPECIFICATIONS**  
**Base:** LCP, UL Rated 94V-0  
**Clips:** .020 (.51) Brass - Nickel Plated  
**UL Rated:** 15 Amps @ 250 VAC

**CAT. NO. 3523**

Optional cover available - **Cat. No. 4245C**

Mounting Hole:  
.144 (3.7) Dia.