

## Connector assembly frame - HC-SMP 150-B24-AMQ - 1660944

Please be informed that the data shown in this PDF Document is generated from our Online Catalog. Please find the complete data in the user's documentation. Our General Terms of Use for Downloads are valid (<http://download.phoenixcontact.com>)



HEAVYCON connector assembly frame with panel mounting base with double locking latch, for contact inserts of type B24, 150 mm long

The illustration shows version HC-SMP 125-B 10 with double locking latch



### Key commercial data

Packing unit	1 1
GTIN	 4 017918 022358
Weight per Piece (excluding packing)	240.0 GRM
Custom tariff number	85389099
Country of origin	Germany

### Technical data

#### Dimensions

Length	150 mm
Height	52 mm
Hole diameter	4.5 mm
Drill hole distance, horizontal	130 mm
Drill hole distance, vertical	32 mm

#### General

Note	For contact inserts B24, BB48, DD108 and HV10
Material	PA
Inflammability class according to UL 94	HB
Design	B24

# Connector assembly frame - HC-SMP 150-B24-AMQ - 1660944

## Classifications

### eCl@ss

eCl@ss 4.0	27140816
eCl@ss 4.1	27140816
eCl@ss 5.0	27143424
eCl@ss 5.1	27143424
eCl@ss 6.0	27143424
eCl@ss 7.0	27440209
eCl@ss 8.0	27440209

### ETIM

ETIM 3.0	EC002310
ETIM 4.0	EC002310
ETIM 5.0	EC002310

### UNSPSC

UNSPSC 6.01	43172601
UNSPSC 7.0901	39121416
UNSPSC 11	43172601
UNSPSC 12.01	39121408
UNSPSC 13.2	39121408

## Approvals

### Approvals

---

Approvals

GOST

---

Ex Approvals

---

Approvals submitted

---

### Approval details

GOST 
--

# Connector assembly frame - HC-SMP 150-B24-AMQ - 1660944

## Drawings

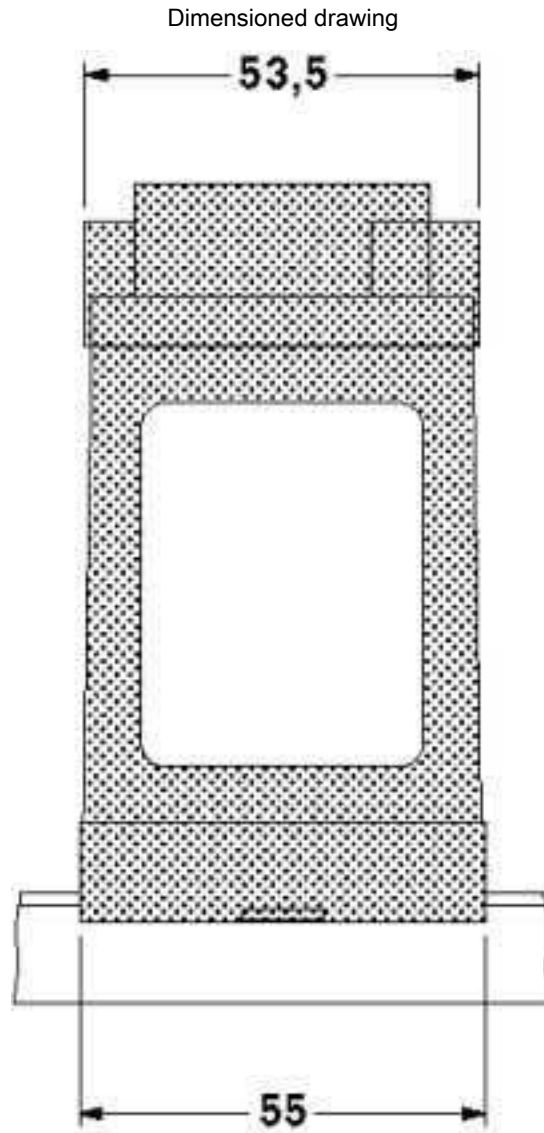

# Connector assembly frame - HC-SMP 150-B24-AMQ - 1660944

Dimensioned drawing

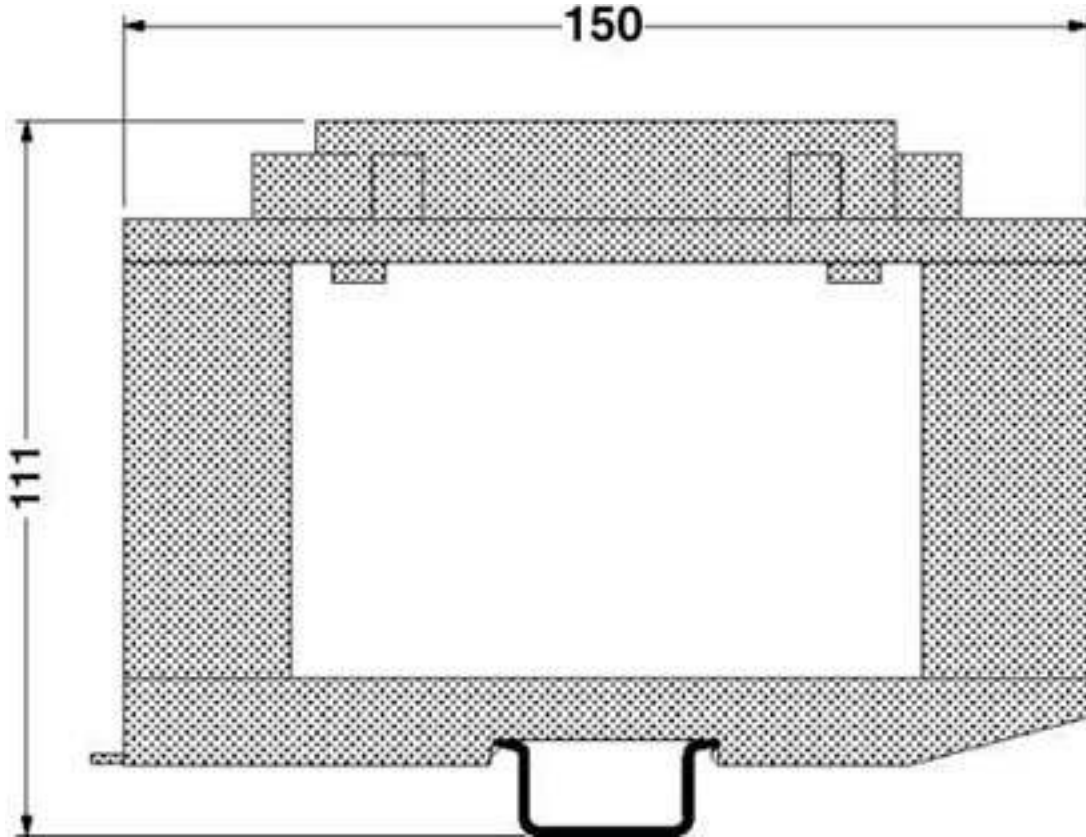

## Connector assembly frame - HC-SMP 150-B24-AMQ - 1660944

