



APPLICATION SPECIFICATION

ASSEMBLY INSTRUCTIONS FOR THE 130199 MAXLOC

1.0 SCOPE

To ensure that all components are correctly assembled and the shielded cable is correctly terminated

2.0 PRODUCT DESCRIPTION

<u>PART NO.</u>	<u>DESCRIPTION</u>
1301990030	1 AWG GRIP ASSEMBLY, HNBR (SINGLE ASSEMBLY)
1301990130	1 AWG GRIP ASSEMBLY, HNBR (KIT ASSEMBLY, 420 LOOSE PCS)
1301990230	1 AWG GRIP ASSEMBLY, SILICONE (SINGLE ASSEMBLY)
1301990330	1 AWG GRIP ASSEMBLY, SILICONE (KIT ASSEMBLY, 420 LOOSE PCS)
1301990020	1/0 AWG GRIP ASSEMBLY, HNBR (SINGLE ASSEMBLY)
1301990120	1/0 AWG GRIP ASSEMBLY, HNBR (KIT ASSEMBLY, 420 LOOSE PCS)
1301990220	1/0 AWG GRIP ASSEMBLY, SILICONE (SINGLE ASSEMBLY)
1301990320	1/0 AWG GRIP ASSEMBLY, SILICONE (KIT ASSEMBLY, 420 LOOSE PCS)
1301990025	2/0 AWG GRIP ASSEMBLY, HNBR (SINGLE ASSEMBLY)
1301990125	2/0 AWG GRIP ASSEMBLY, HNBR (KIT ASSEMBLY, 420 LOOSE PCS)
1301990225	2/0 AWG GRIP ASSEMBLY, SILICONE (SINGLE ASSEMBLY)
1301990325	2/0 AWG GRIP ASSEMBLY, SILICONE (KIT ASSEMBLY, 420 LOOSE PCS)

3.0 REFERENCE DOCUMENTS

- PK-130199-001
- PS-130199-001
- SD-130199-001
- MAXLOC is designed to accept the Molex 1AWG, 1/0AWG & 2/0AWG Battery Cable Lugs. Reference SD-19221-010 and SD-19221-011.

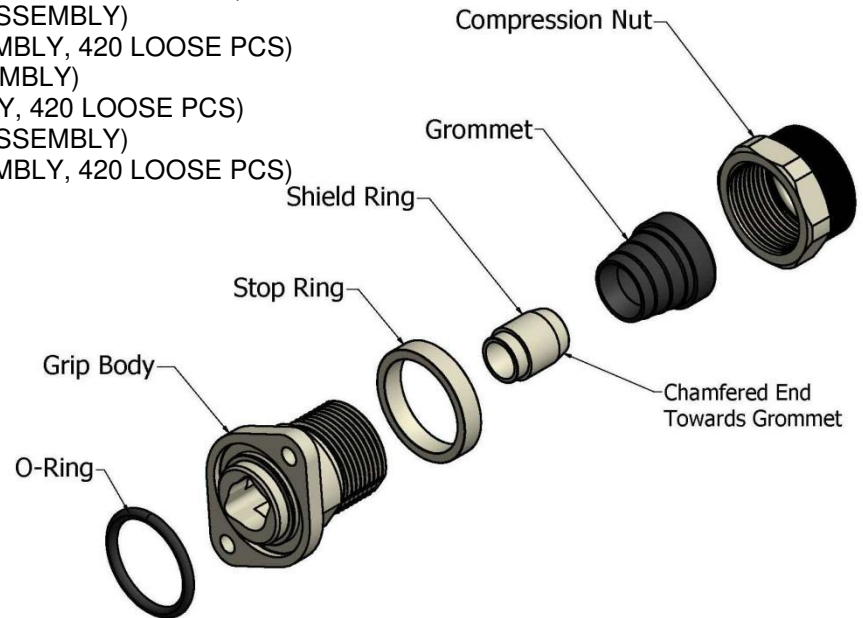

<u>REVISION:</u> J	<u>ECR/ECN INFORMATION:</u> EC No: IPG2016-0883 DATE: 2016 / 2 / 15	<u>TITLE:</u> ASSEMBLY INSTRUCTIONS FOR THE 130199 MAXLOC 1AWG, 1/0AWG, 2/0AWG	<u>SHEET No.</u> 1 of 2
<u>DOCUMENT NUMBER:</u> AS-130199-001	<u>CREATED / REVISED BY:</u> WLEUNG	<u>CHECKED BY:</u> GSUDHINI	<u>APPROVED BY:</u> BWOODMAN



APPLICATION SPECIFICATION

4.0 ASSEMBLY INSTRUCTIONS

a) Strip the Cable according to the dimensions below:

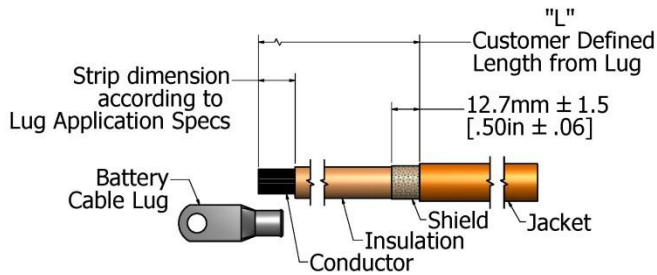

d) Crimp the Battery Cable Lug onto the Conductor

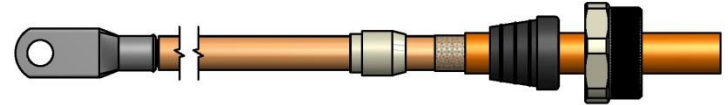

e) Fold the exposed Cable Shield back around the Grommet

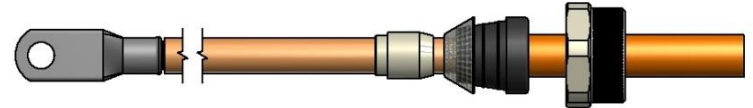

f) Slide the Stop Ring and Grip Body onto the Cable

g) Apply P-80® lubricant or equivalent to O-Ring.

h) Press the O-Ring into the O-Ring Groove of the Grip Body.

i) Apply P-80® Lubricant to the Top of the Grommet and between the Cable Jacket and the Grommet

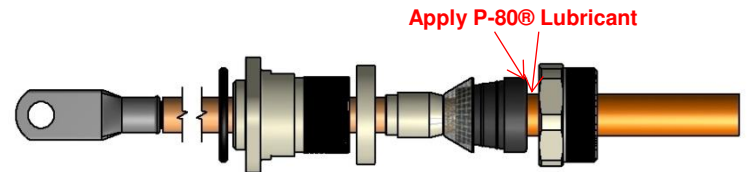

j) Tighten the Compression Nut to the Stop Ring. Then apply the recommended torque to Compression Nut. Recommended Torque: 24 ft-lbf (32.5 N-m) ±20% Maximum Torque: 30 ft-lbf (40.7 N-m)

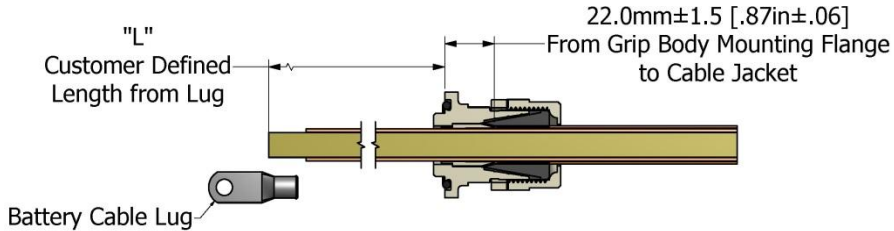
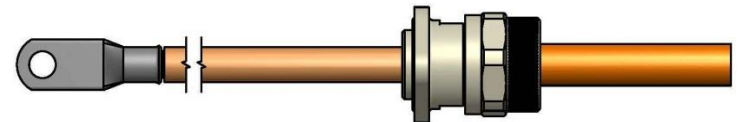

b) Slide the Compression Nut and Grommet onto the Cable Jacket



c) Slide the Shield Ring onto the Cable Insulation (before crimping the Battery Cable Lug)

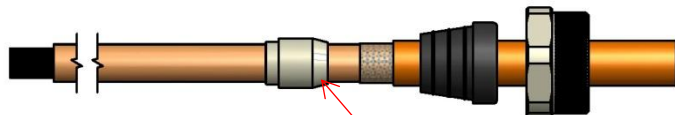

Chamfered End of Shield Ring pointed towards Grommet

REVISION:

J

ECR/ECN INFORMATION:

EC No: IPG2016-0883

DATE: 2016 / 2 / 15

TITLE:

ASSEMBLY INSTRUCTIONS
FOR THE 130199 MAXLOC
1AWG, 1/0AWG, 2/0AWG

SHEET No.

2 of 2

DOCUMENT NUMBER:

AS-130199-001

CREATED / REVISED BY:

WLEUNG

CHECKED BY:

GSUDHINI

APPROVED BY:

BWOODMAN