

DESCRIPTION CONTROL			
REV	DESC	DATE	ECN NO.
B	A	09-05-11	GX-N20905004

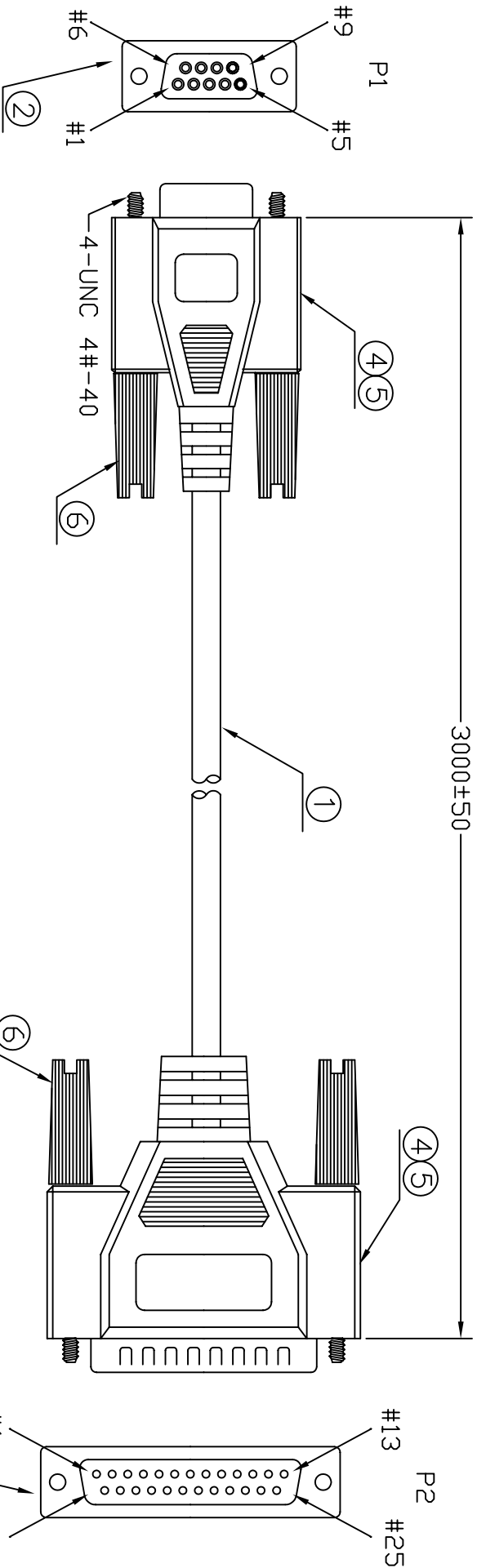

ROHS COMPLIANT

NOTE:
CABLE COLOR : BEIGE 02#.

INNER MOLDING	IDB9-1507	IDB2514	
OUTER MOLDING	IDB9-1505	IDB2523	



ITEM:	M02-116A	REV	B
SCALE:	NONE	DATE:	06/03/18

CHECK BY:	CUSTOMER:	C337
APP. BY:	CUSTOMER P/N:	
ALL DIMENSIONS IN		

PIN ASSIGNMENT		P2	ND	PART NO.	DESCRIPTION	QTY	UNIT
P1	1	8	6	370	SRV-E31.5/BE02	4	PCS
	2	3	5	370	PVC-BE02/50	51	G
	3	2	4	370	PVC-IN	11	G
	4	20	3	220	CDS-25P<BU>	1	PCS
	5	7	2	220	CDS-09S<BU>	1	PCS
	6	6	1	210	30-9C+1+A-BE02-4.5N	3.0	M
	7	4	22				
	8	5					
	9	22					
	S	S					

DESCRIPTION CONTROL			
REV	DESC	DATE	APP
B		09-05-11	GX-N20905004

M1092540000004A	普通包裝	390	CARTON:46*30*25CM	A/R	PCS
		390	PE BAG:30*28*0.08MM	A/R	PCS
		390	PE-BAG:6*10*0.06MM	1	PCS
		390	TIE-A/BE02	120*1	MM
		390	CARTON:46*30*25CM	A/R	PCS
M1092540000004B	條碼包裝	390	PE BAG:30*28*0.08MM	A/R	PCS
		390	PE BAG:6*10*0.06MM	1	PCS
		390	PRINT BAR CODE AND P/N (M02-116A)		
		390	TIE-A/BE02	120*1	MM
		390	CARTON:46*30*25CM	A/R	PCS
		390	PE BAG:30*28*0.08MM	A/R	PCS
		390	PE BAG:6*10*0.06MM	1	PCS
M1092540000004C	吊卡包裝	390	TIE-A/BE02	100*1	MM
		330020000265	HANG-TAG:M02-116A	1	PCS
		390	TIE-A/BE02	120*1	MM
		310000000779	CARTON:62*50*22CM	1/50	PCS
		320020000321	CARTON-P:61*49*0.3CM	3/50	PCS
		320080000185	真空盒(251*93MM(PKG-205))	1	PCS
		3300600000607	紙卡:95*318MM(PKG-210)	1	PCS
		320120000032	棉紙:350*150MM	1/2	PCS
		55114451	料号貼紙:54*23(M02-116A)	1	PCS



貼紙卡正面小方框中

ROHS COMPLIANT

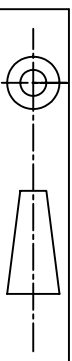

ITEM: M02-116A
 REV: B

DRAWN, BY: PQJING
 CHECKED, BY: JOHN
 APPROVED, BY: _____
 SCALE: NDT
 CUSTOMER: C337
 DATE: 2006/03/18
 PAGE: 2/2
 CUSTOMER P/N: _____



ALL DIMENSIONS IN mm