

REVISIONS			
REV	DESCRIPTION, ECN, EAR NO.	DATE	APP'D
A	PROPOSAL	MAR13/18	L.CHAN

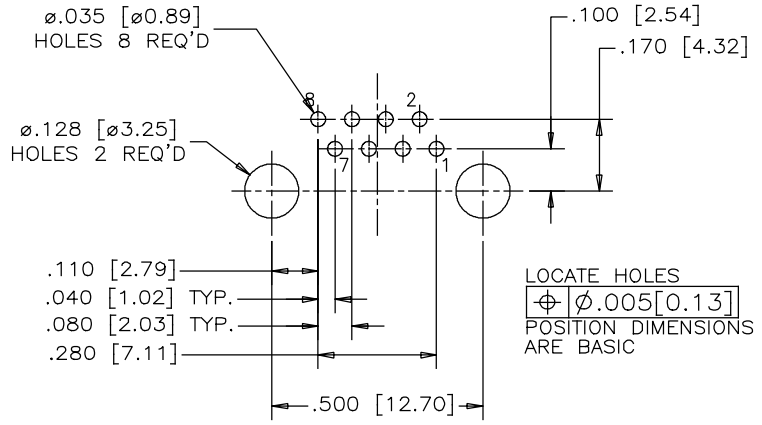
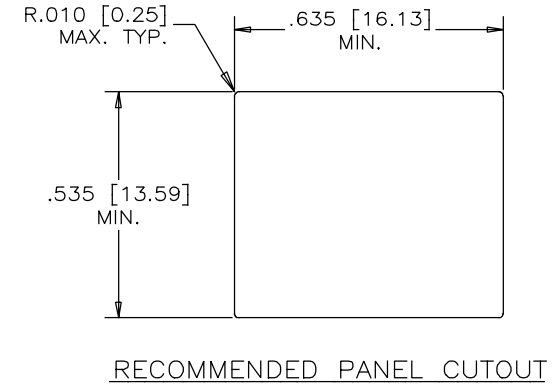
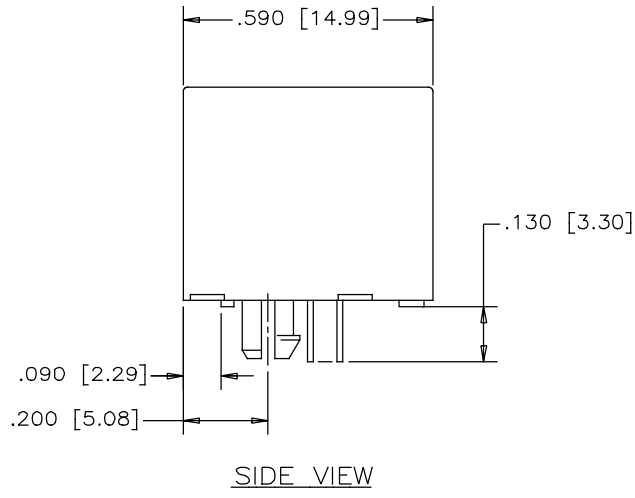
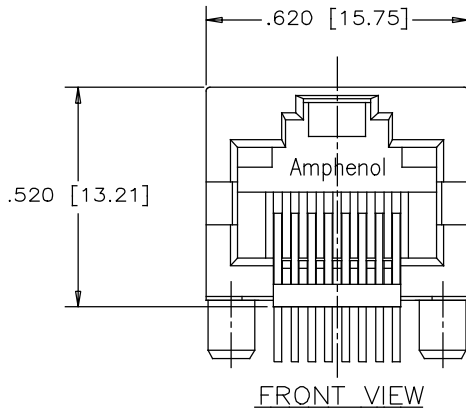

LOCATE HOLES
 $\phi \phi .0005 [0.13]$
 POSITION DIMENSIONS
 ARE BASIC

MATERIALS:
 PLASTIC HOUSING: HIGH TEMPERATURE THERMOPLASTIC
 FLAMMABILITY RATING UL 94V-0, COLOR BLACK

CONTACTS: PHOSPHOR BRONZE
 PLATING: GOLD PLATING ON MATING SURFACE.
 [SEE PART NUMBER FOR THICKNESS]
 50 μ " [1.27 MICRONS]
 MIN. NICKEL UNDERPLATE
 100 μ " [2.54 MICRONS]
 MIN. MATTE TIN ON CONTACT TAILS.

PART NUMBER: RJHSE-X080-A1

GOLD PLATING
 E=RJ45 FLAT CONTACT 6u"
 G=RJ45 FLAT CONTACT 15u"
 J=RJ45 FLAT CONTACT 30u"
 5=RJ45 FLAT CONTACT 50u"



UNLESS SPECIFIED OTHERWISE		DRAWN	W.QIU	DATE	MAR13/18	Amphenol Canada Corp. www.amphenolcanada.com
PRIMARY UNITS	INCH	CHECKED	L.CHAN	DATE	MAR13/18	
SECONDARY UNITS	MILLIMETER	M.E. APP'D		TITLE		SINGLE-PORT HIGH SPEED RJ45, 8P8C WITHOUT SHIELD & LEDS, 0.13" LONG CONTACT TAIL, -RoHS COMPLIANT
REFERENCE IN PARENTHESES		Q.A. APP'D		DWG. NO.		
GENERAL TOLERANCES		DWG APPR.		REV		P-RJHSE-X080-A1
1 DECIMAL PLACE	±0.025	ENG. REL. NO.		A		
2 DECIMAL PLACES	±0.020	REF.		CODE ID NO. 03554		DWG SIZE: C SCALE: N/A SHEET 1 OF 1
3 DECIMAL PLACES	±0.015	THIRD ANGLE PROJECTION		DRAWING		
ANGULAR DEGREES	±1.0°	DO NOT SCALE DRAWING				

THIS DOCUMENT CONTAINS PROPRIETARY INFORMATION AND SUCH INFORMATION MAY NOT BE DISCLOSED TO OTHERS FOR ANY PURPOSE OR USED FOR MANUFACTURING PURPOSES WITHOUT WRITTEN PERMISSION FROM AMPHENOL CANADA CORP.