

© - TE Connectivity. All Rights Reserved.

REVISIONS 変更					
P	LTR	DESCRIPTION	DATE	DWN	APVD
	H5	REVISED PER ECR-22-143790	29JUN2022	RE	EW
	H4	REVISED PER ECR-20-005366	21APR2020	SS	DL

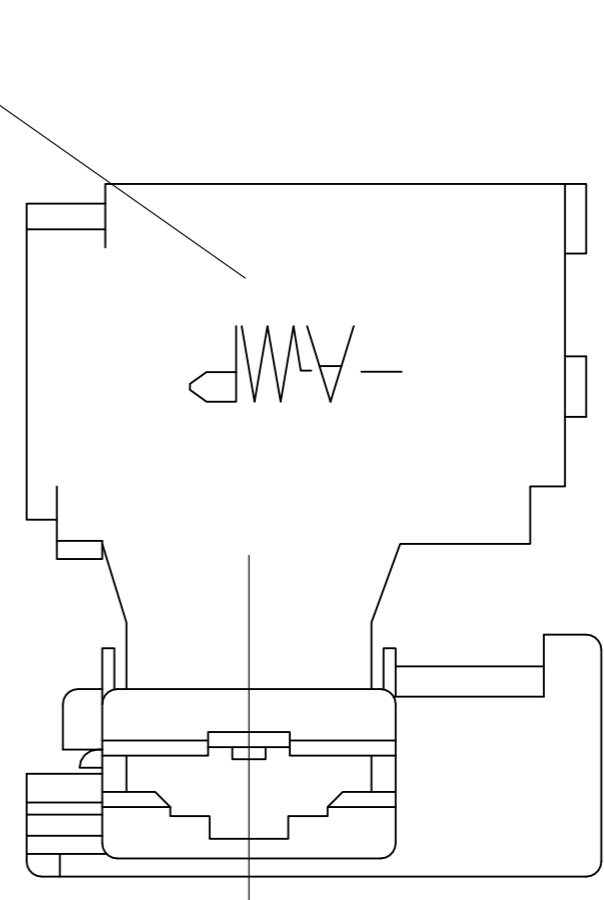
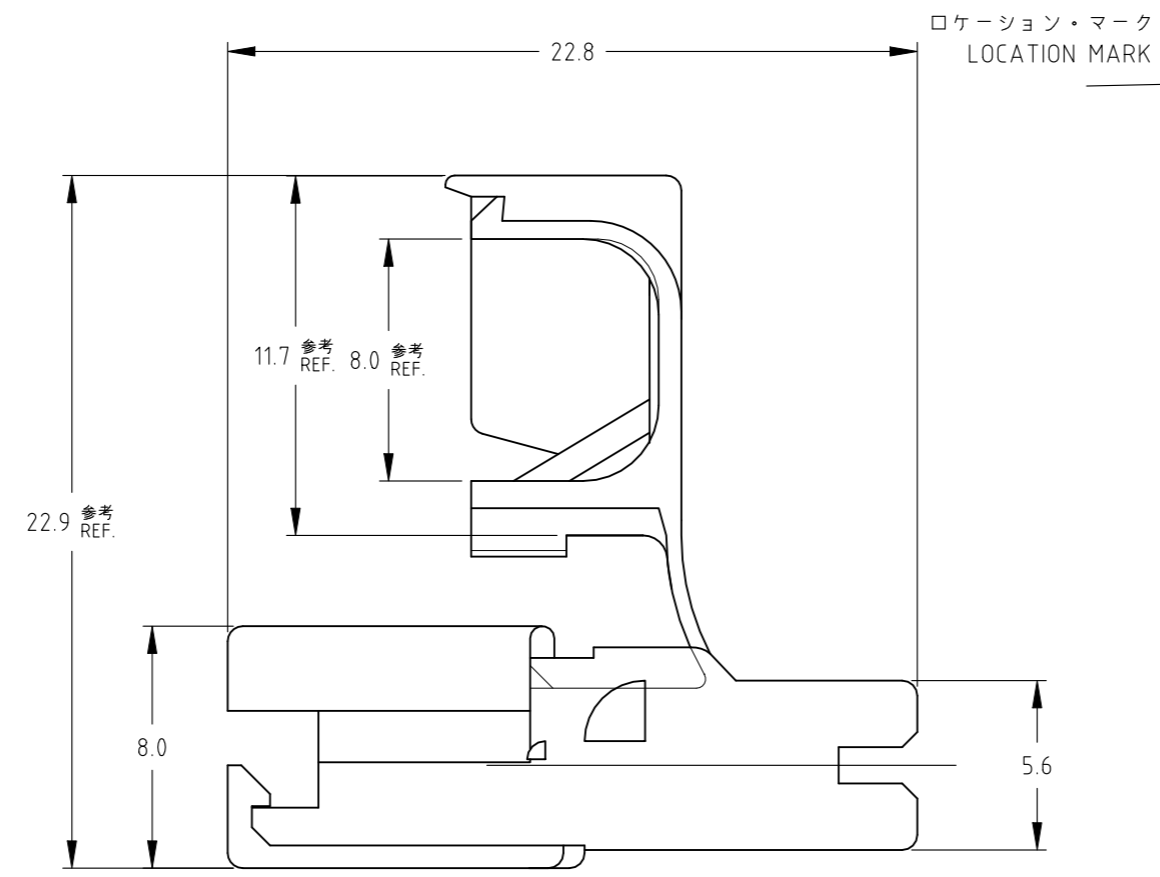
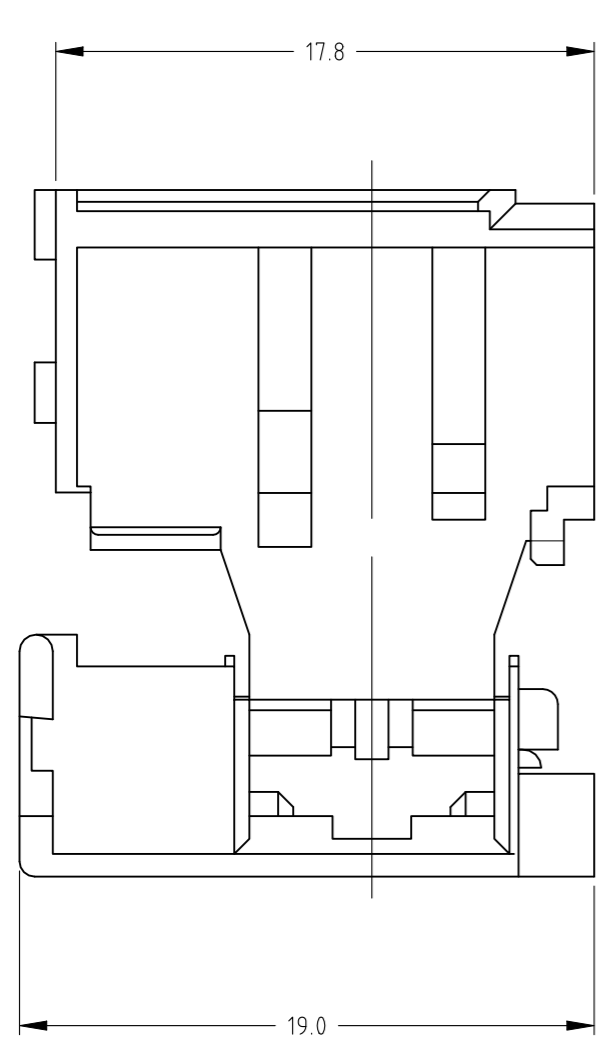

- 注；
- 適用コンタクト；
型番：172761,172782,172763
 - 取扱説明書；411-5212

- NOTES；
- APPLICABLE CONTACT PARTS NUMBER：172761,172762,172763
 - INSTRUCTION SHEET：411-5212
 - OBSOLETE PARTS: OBSOLETE CIS STREAMLINING PER D.RENAUD/D.SINISI
 - COMPLY WITH GLOW WIRE REQUIREMENT FOR PARTS OF NON-METALLIC MATERIAL SUPPORTING A CURRENT CARRYING CONNECTION DETAILED IN IEC 60335-1, SECTION 30 (GWT)
 - GENERAL TOLERANCE: ±0.3, ±2°

OBSOLETE	7-172469-1	自然色 NATURAL	6/6ナイロン 6/6 NYLON	UL94V-0, GWT
	1-172469-3	黄 YELLOW		UL94V-0
	1-172469-2	青 BLUE		UL94V-0
	1-172469-1	自然色 NATURAL		UL94V-0
	172469-8	黒 BLACK		UL94V-2
	172469-7	赤 RED		UL94V-2
	172469-4	緑 GREEN		UL94V-2
OBSOLETE	1-172469-3	黄 YELLOW		UL94V-2
	172469-2	青 BLUE		UL94V-2
	172469-1	自然色 NATURAL		UL94V-2
型番	PART NUMBER	色調 COLOR	材料 MATERIAL	MATERIAL

THIS DRAWING IS A CONTROLLED DOCUMENT.		DWN M.SUZUKI 17.APR.'02	TE Connectivity 250 SERIES FLAG POSITIVE LOCK MARK-II HOUSING				
DIMENSIONS: 単位： 耗 mm		CHK M.SHINDO 17.APR.'02				NAME 名称	RESTRICTED TO
TOLERANCES UNLESS OTHERWISE SPECIFIED: 一般公差		APVD M.SHINDO 17.APR.'02				PRODUCT SPEC 製品規格 108-5162	SCALE 尺度 4:1
 0 PLC ± 1 PLC ± 2 PLC ± 3 PLC ± 4 PLC ± ANGLES ±		APPLICATION SPEC 取付適用規格				SIZE A3	CAGE CODE 00779
MATERIAL 材料 SEE TABLE	FINISH 仕上	WEIGHT 0.000000	DRAWING NO 番号 C-172469	SHEET 1 OF 1			
CUSTOMER DRAWING			REV H5				