

REV.	DATE	DESCRIPTION
NC	09/25/06	INITIAL RELEASE

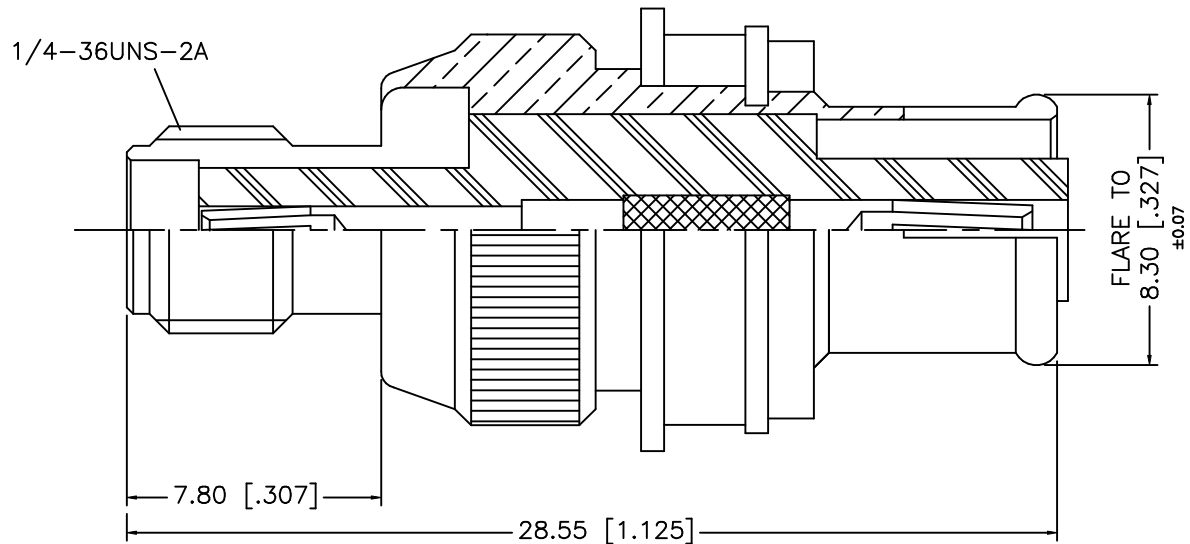

					UNLESS OTHERWISE SPECIFIED DIMENSIONS ARE IN MILLIMETERS. DIMENSIONS IN [] ARE IN INCHES AND FOR CUSTOMER REFERENCE ONLY.	APPROVALS	DATE	Amphenol Connex			
8					UNLESS OTHERWISE SPECIFIED TOLERANCES FOR MILLIMETERS ARE: 0.5 - 8mm ± 0.20mm 8 - 30mm ± 0.40mm 30 - 120mm ± 0.50mm UNLESS OTHERWISE SPECIFIED TOLERANCES FOR INCHES ARE: .020 - .315 = ± 0.007" .315 - 1.180 = ± 0.015" 1.180 - 4.724 = ± 0.020" DO NOT SCALE DRAWING	DRAWN	G.R.S.				09/25/06
7	GASKET	RUBBER	RED	1		CHECKED					
6	RETAINING RING	BRASS	NICKEL	1		ISSUED					
5	RING	DELRIN	NATURAL	1		SHEET	1 OF 1		DWG. NO. 242105RP-10.DWG		
4	WASHER	BRASS	NICKEL	1	CAD FILE C:/242/242105RP-10.DWG			REV. NC	SIZE A	SCALE NA	
3	CONTACT PIN	PHOS. BRONZE	GOLD	1							
2	INSULATOR	TEFLON	NATURAL	1							
1	BODY	BRASS	NICKEL	1							
	DESCRIPTION	MATERIAL	FINISH	QTY							