

# SS220K-23

## Miniature Slide Switches

RoHS Compliant



### Features

#### 1. For Embedded Use

The switch can be embedded in the plastic mold housing of equipment or power tools to reduce the overall size.

#### 2. Power Switch Application

Suitable for power supplies where small size and large current capacity is required (inrush current: 70 A).

#### 3. Anti-welding (forced separation) mechanism

In case the contacts are welded, the switch is structured to force separation of the contacts.

### Specifications

Rating	Resistive load	20A 250VAC
	Inductive load	250VAC 70A (p.f.=0.7)/20A (p.f.=0.9)
Initial contact resistance	20mΩ max. (1A 2~4VDC)	
Dielectric strength	250VAC 1 minute	
Insulation resistance	100MΩ min. (500VDC)	
Electrical life	10,000 operations.	
Operating force	3.43~7.35 N	
Operating temperature range	-10~+50°C	
Storage temperature range	-20~+70°C	

### Terminal style

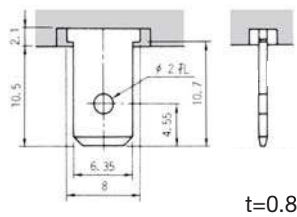

(TAB terminals)

t=0.8

### Structure

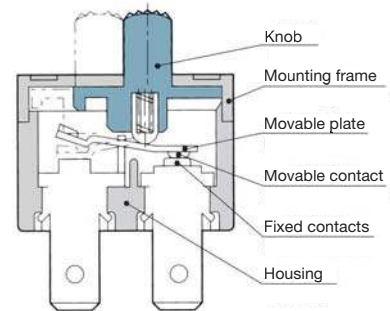

### SS220K-23-Z DPST



#250  
(TAB terminals)

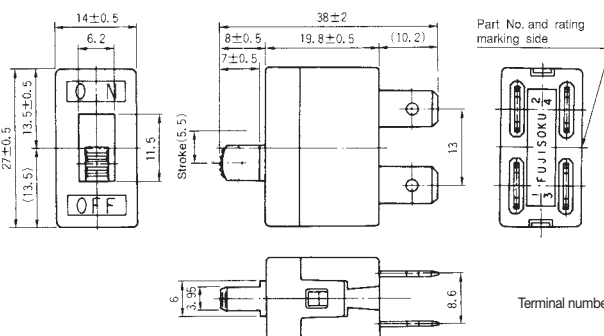

Terminal numbers are shown on the bottom of the switch.

Switchingfunction	Viewed from part No. marking side	
Part No.	ON	OFF
★SS220K-23-Z	ON	OFF
Connecting terminals	1-2 3-4	—