

THIS DRAWING CONTAINS INFORMATION THAT IS PROPRIETARY TO J.S.T. AND SHALL NOT BE USED OR SHOWN WITHOUT WRITTEN PERMISSION.

ITEM	CONNECTOR PART NO.	DESCRIPTION	IPI CHECK	EOR CHECK
1	SLEB-001T-P0.2	LEB CONNECTOR CONTACT		
2	UL1061, 22 AWG	BLACK		

1	
Applicable Tooling	
APPLICATOR	

Applicable Housings	
NO. OF CIRCUITS	HOUSING PART NO.
1	LEBRP-01V-S
2	LEBRP-02V-S

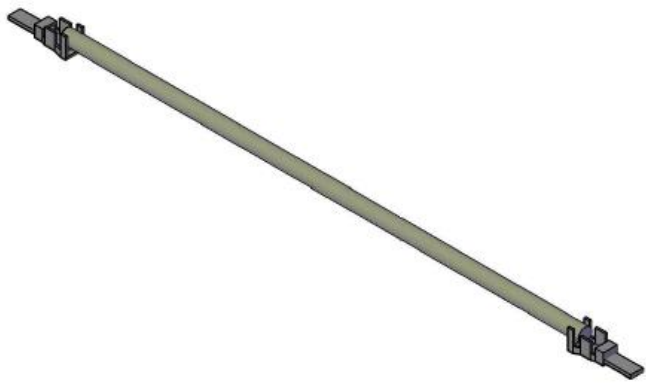
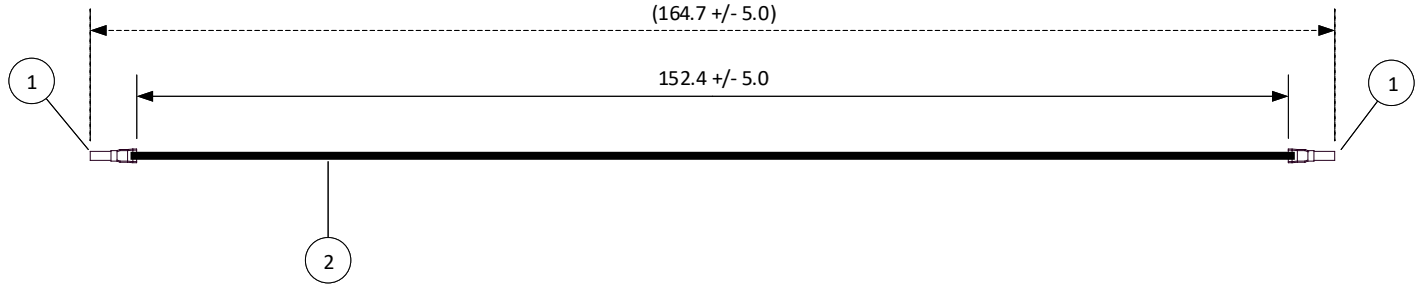

SCALE 1: 1	CUSTOMER NAME	CUSTOMER PART NO.
DIMENSIONS All dimensions are in MM with a tolerance of +/- 3.0 unless otherwise specified.	DESCRIPTION 4.0 mm Pitch LEB Series Standard Leads - 6" Inside Length DOUBLE-END LEADS, F-F	
DRAWN BY STEVEN PILKINGTON	ASSEMBLY PART NO. ALEBLEB22K152	
CHECKED BY JUSTIN BAKER	DRAWING NO. & REVISION GAM-182	REVISED 5/6/2016

REV.	DESCRIPTION	DATE	BY

4 | 3 | 2 | 1