

PRODUCT NO.
SEE TABLE

10127805 - XXX LF
 L LEAD FREE OPTION
 NO. OF POSITIONS PER ROW
 PLATING CODE
 BASE PART NUMBER

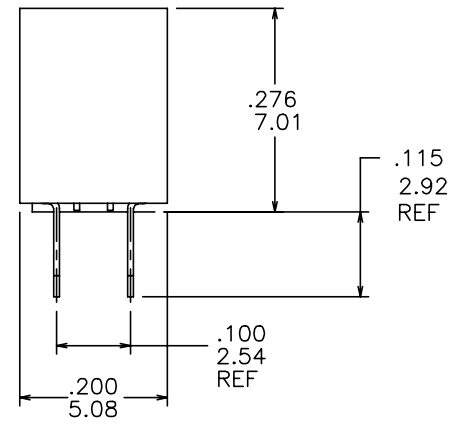
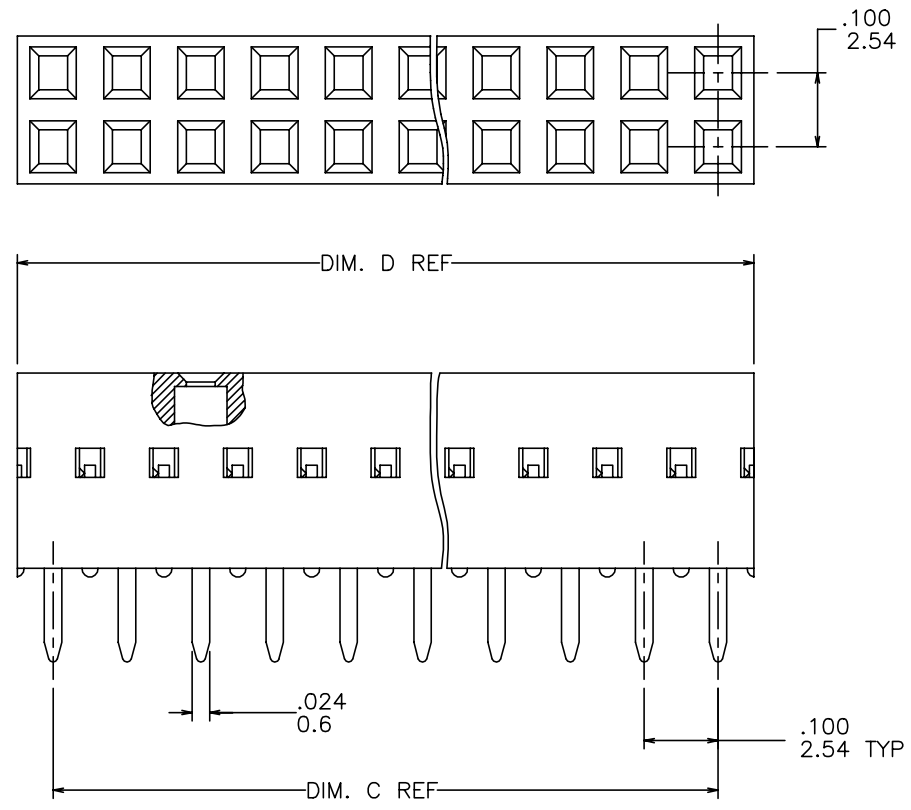

mat'l. code		surface		tolerance		projection		product family	
-		ISO 1302 ✓		ISO 406 ISO 1101				DUBOX	
l	tr	ec	n	o	r	date		title	
A	NEW	ZK	10/25/13	tolerances unless otherwise specified				DUBOX DBL. ROW VERT. CARD CONN. ASS'Y	
				angles	linear	$\pm .01 / \pm .03$ $\pm .008 / \pm .020$ $\pm .0040 / \pm .010$		dwg no	
				$0^\circ \pm 2^\circ$		scale 2:1		sheet 1 of 3	
				dr	ZK HU	10/25/13		size	
				engr	ZK HU	10/25/13		10127805	
				chr	RICK BIAN	10/25/13		A3	
				appd	RICK BIAN	10/25/13		type Product Customer Drawing	
sheet	revision	A	A	A	A				
index	sheet	1	2	3	4				

FCI
FCIconnect.com

Copyright FCI

PRODUCT NO NOTE 8	PLATING CONTACT AREA	PLATING SOLDER TAIL
10127805-8XXLF	30u"/.76u Au MIN OVER 50u"/1.27u Ni MIN	100μ"/160μ" 2.54μ/4.06μ

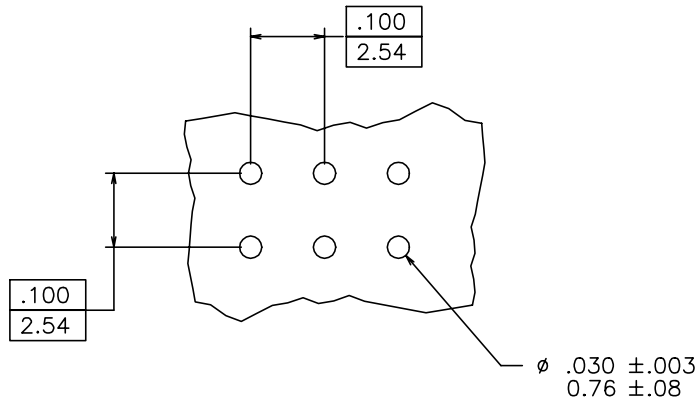

FIGURE A

NOTES:

1. MATERIAL TERMINAL: COPPER ALLOY
2. RECOMMENDED APPLICATION DATA:
 - A. RECOMMENDED HOLE PATTERN IS SHOWN IN FIGURE A.
 - B. ALL MATING PINS TO BE .025/.64 SQUARE ON TRUE CENTER OF GIVEN TERMINAL SPACINGS WITHIN .015/.38 DIA.
 - C. SUGGESTED MATING PIN LENGTH .210±.020/5.33±.51
 - D. RECOMMENDED PC BOARD THICKNESS: .062/1.58
- ③ MATERIAL HOUSING HIGH TEMPERATURE THERMAL PLASTIC, COLOR BLACK, FLAME RETARDANT PER UL 94V-0 THIS PART WILL WITHSTAND EXPOSURES TO 260°C PEAK TEMPERATURE FOR 20 SECONDS IN WAVE SOLDER, INFRA-RED OR VAPOR PHASE SOLDER PROCESS.
- 4 FCI, FCI FINAL PART NUMBER AND DATE CODE TO BE MARKED ON TUBE LABEL.
5. PREPLATED, STAMPED TERMINALS.
6. PART NUMBER WITH SUFFIX "U" IS FOR SAWING PURPOSES ONLY.
- ⑦ STANDARD TUBE PACKAGE.
- ⑧ ADD LF SUFFIX AT THE END OF PART NUMBER FOR LEAD FREE OPTION.
9. THESE PRODUCTS MEETS EUROPEAN UNION DIRECTIVES AND OTHER COUNTRY REGULATION AS DESCRIBED IN GS-22-008.
10. PRODUCT SPEC: BUS-12-055

mat'l. code	surface	tolerance	projection	product family
-	ISO 1302 ✓	ISO 406 ISO 1101		DUBOX
tr	ecn	nodr	date	title
A				DUBOX DBL. ROW VERT. CARD CONN. ASS'Y
	angles	linear	scale 2:1	dwg no
	0°±2'	XXX±.01/XX±0.3 XXX±.008/XX±0.20 XXX±.0040/XX±0.10	INCH/MM	sheet 2 of 3
	dr	ZK HU	10/25/13	size
	engr	ZK HU	10/25/13	10127805
	chr	RICK BIAN	10/25/13	A3
	appd	RICK BIAN	10/25/13	type Product Customer Drawing
sheet	revision			
index	sheet			

PRODUCT NUMBER	NO. OF POSITION	C DIM	D DIM	LF OPTION
10127805-Y02	2 X 2	. 100/2. 54	. 217/5. 51	NOTE 8
-Y03	2 X 3	. 200/5. 08	. 317/8. 05	
-Y04	2 X 4	. 300/7. 62	. 417/10. 59	
-Y05	2 X 5	. 400/10. 16	. 517/13. 13	
-Y06	2 X 6	. 500/12. 70	. 617/15. 67	
-Y07	2 X 7	. 600/15. 24	. 717/18. 21	
-Y08	2 X 8	. 700/17. 78	. 817/20. 75	
-Y09	2 X 9	. 800/20. 32	. 917/23. 29	
-Y10	2 X 10	. 900/22. 86	1. 017/25. 83	
-Y11	2 X 11	1. 000/25. 40	1. 117/28. 37	
-Y12	2 X 12	1. 100/27. 94	1. 217/30. 91	
-Y13	2 X 13	1. 200/30. 48	1. 317/33. 45	
-Y14	2 X 14	1. 300/33. 02	1. 417/35. 99	
-Y15	2 X 15	1. 400/35. 56	1. 517/38. 53	
-Y16	2 X 16	1. 500/38. 10	1. 617/41. 07	
-Y17	2 X 17	1. 600/40. 64	1. 717/43. 61	
-Y18	2 X 18	1. 700/43. 18	1. 817/46. 15	
-Y19	2 X 19	1. 800/45. 72	1. 917/48. 69	
-Y20	2 X 20	1. 900/48. 26	2. 017/51. 23	
-Y21	2 X 21	2. 000/50. 80	2. 117/53. 77	
-Y22	2 X 22	2. 100/53. 34	2. 217/56. 31	
-Y23	2 X 23	2. 200/55. 88	2. 317/58. 85	
-Y24	2 X 24	2. 300/58. 42	2. 417/61. 39	
10127805-Y25	2 X 25	2. 400/60. 96	2. 517/63. 93	

PRODUCT NUMBER	NO. OF POSITION	C DIM	D DIM	LF OPTION
10127805-Y26	2 X 26	2. 500/63. 50	2. 617/66. 47	NOTE 8
-Y27	2 X 27	2. 600/66. 04	2. 717/69. 01	
-Y28	2 X 28	2. 700/68. 58	2. 817/71. 55	
-Y29	2 X 29	2. 800/71. 12	2. 917/74. 09	
-Y30	2 X 30	2. 900/73. 66	3. 017/76. 63	
-Y31	2 X 31	3. 000/76. 20	3. 117/79. 17	
-Y32	2 X 32	3. 100/78. 74	3. 217/81. 71	
-Y33	2 X 33	3. 200/81. 28	3. 317/84. 25	
-Y34	2 X 34	3. 300/83. 82	3. 417/86. 79	
-Y35	2 X 35	3. 400/86. 36	3. 517/89. 33	
-Y36	2 X 36	3. 500/88. 90	3. 617/91. 87	
-Y37	2 X 37	3. 600/91. 44	3. 717/94. 41	
-Y38	2 X 38	3. 700/93. 98	3. 817/96. 95	
-Y39	2 X 39	3. 800/96. 52	3. 917/99. 49	
-Y40	2 X 40	3. 900/99. 06	4. 017/102. 03	
-Y41	2 X 41	4. 000/101. 60	4. 117/104. 57	
-Y42	2 X 42	4. 100/104. 14	4. 217/107. 11	
-Y43	2 X 43	4. 200/106. 68	4. 317/109. 65	
-Y44	2 X 44	4. 300/109. 22	4. 417/112. 19	
-Y45	2 X 45	4. 400/111. 76	4. 517/114. 73	
-Y46	2 X 46	4. 500/114. 30	4. 617/117. 27	
-Y47	2 X 47	4. 600/116. 84	4. 717/119. 81	
-Y48	2 X 48	4. 700/119. 38	4. 817/122. 35	
-Y49	2 X 49	4. 800/121. 92	4. 917/124. 89	
10127805-Y50	2 X 50	4. 900/124. 46	5. 017/127. 43	

NOTE 8

NOTE 8

mat'l. code	surface	tolerance	projection	product family
-	ISO 1302 ✓	ISO 406 ISO 1101		DUBOX
ltr ecn nodr date	tolerances unless otherwise specified			title
A	angles	linear	INCH/MM	DUBOX DBL. ROW VERT. CARD CONN. ASS'Y
	0°±2'	XXX±.01/XXX.03 XXX±.008/XXX.020 XXX±.0040/XXX±.010	scale 2:1	
dr	ZK HU	10/25/13		dwg no
engr	ZK HU	10/25/13		sheet 3 of 3
chr	RICK BIAN	10/25/13		size
appd	RICK BIAN	10/25/13		A3
sheet index	revision sheet			type Product Customer Drawing



Copyright FCI