

REMARK:
 1.CHARACTERISTICS:
 RATED VOLTAGE: 250V
 RATED CURRENT: 5AMP
 CONTACT RESISTANCE: 25mohms MAX.INITIAL;40mohmsMAX.AFTER.
 INSULATION RESISTANCE: 5000Mohms MIN.at 500V DC
 DIELECTRIC STRENGTH: 1000VRMS
 OPERATING TEMPERATURE RANGE: -55°C~105°C
 INSERTION/EXTRACTION FORCE PER CONTACT: 5N Max./0.3N Min.
 MATING/UNMATING CYCLES:50MATINGS MIN.

2.MATERIAL:
 INSULATORS: GLASS-FILLED THERMOPLASTIC UL94V-0, COLOR IN BLACK.
 CONTACTS: COPPER ALLOY, SELECTIVE GOLD ON CONTACT AREA,
 100u" Min MATTE TIN TOP OVER SOLDER AREA
 30u" Min NICKEL UNDER PLATE.
 SHELL: STEEL,100u" Min NICKEL TOP OVER,
 50u" Min COPPER UNDER PLATE.
 BOARD LOCK: COPPER ALLOY,100u" Min MATTE TIN PLATED.

3. PART NUMBER DESCRIPTION: **10090768-S XX X X LF**

SERIES NO. _____ LF: ROHS COMPLIANT
 TYPE _____ FLANGE MOUNTING OPTION
 S: SOCKET (FEMALE) X: UNC #4-40 CLINCHNUTS
 L: M3 CLINCHNUTS
 CONTACT FINISH
 4: GOLD FLASH
 6: 30u" PLATING OPTION
 AVAILABLE ON REQUEST

POS.	PART NO.				THREAD TYPE
09P	10090768-S09*LLF				M3*0.5
15P	10090768-S15*LLF				M3*0.5
25P	10090768-S25*LLF				M3*0.5
37P	10090768-S37*LLF				M3*0.5
09P	10090768-S09*XLf				UNC 4-40
15P	10090768-S15*XLf				UNC 4-40
25P	10090768-S25*XLf				UNC 4-40
37P	10090768-S37*XLf				UNC 4-40
POS.	A	B	C	G	
09P	30.81	24.99	16.33	2.74	
15P	39.24	33.32	24.66	2.74	
25P	53.04	47.04	38.38	2.77	
37P	69.32	63.50	54.84	2.77	

mat'l. code				tolerances unless otherwise specified		CUSTOMER COPY		FCI	
ltr	ecn no	dr	date	linear	.X ± 0.38	projection	title	www.fciconnect.com	
A	T09-1033	J.H	3/12/09		.XX ± 0.25		D-SUB FEMALE RIGHT-ANGLE EU STYLE		
B	T09-1044	J.H	4/2/09	angles	.XXX ± 0.10				
C	ELX-I-13433	AB	9/11/12		0° ± 2°		product family D-SUB size dwg no	code	
				dr	JASON HSU 3/12/09	MM	10090768		TWN
				enr	JASON HSU 3/12/09	scale	1:1		sheet
				chr	ALIAS BABU 9/11/12			1 of 2	
				appd	MITHUN PAUL 9/11/12				
sheet index	revision sheet	C	C						
		1	2						

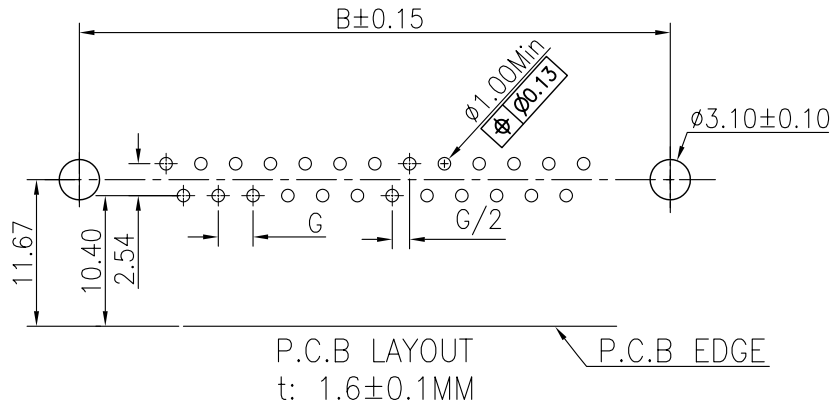
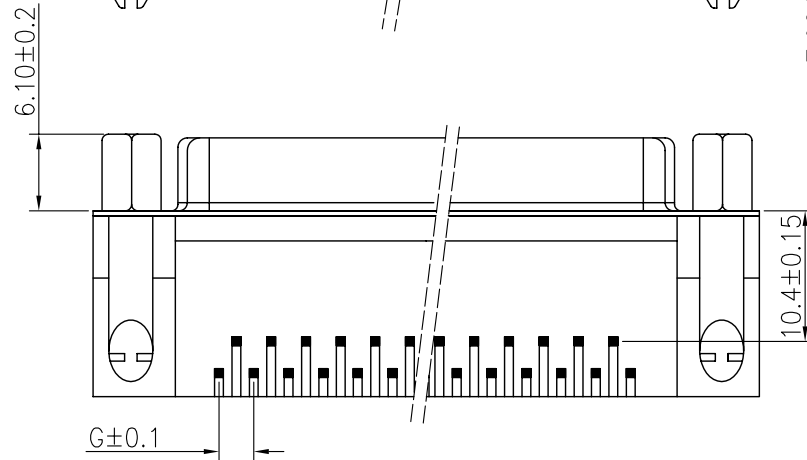
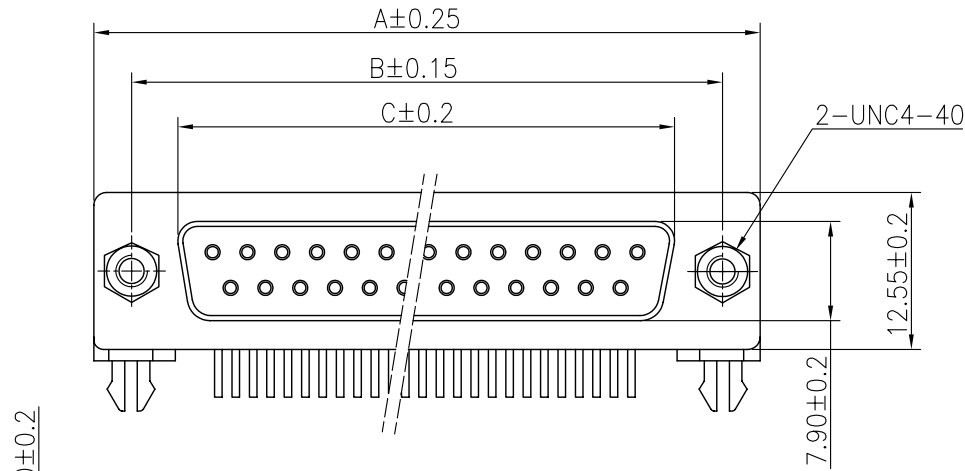

REMARK:

1.CHARACTERISTICS:
 RATED VOLTAGE: 250V
 RATED CURRENT: 5AMP
 CONTACT RESISTANCE: 25mohms MAX.INITIAL,40mohms MAX.AFTER.
 INSULATION RESISTANCE: 5000Mohms MIN.at 500V DC
 DIELECTRIC STRENGTH: 1000VRMS
 OPERATING TEMPERATURE RANGE: -55 °c~105 °c
 INSERTION/EXTRACTION FORCE PER CONTACT :5N Max./0.3N Min.
 MATING/UNMATING CYCLES:50MATINGS MIN.

2.MATERIAL:

INSULATORS: GLASS-FILLED THERMOPLASTIC UL94V-0, COLOR IN BLACK.
 CONTACTS: COPPER ALLOY,SELECTIVE GOLD ON CONTACT AREA,
 100u" Min MATTE TIN TOP OVER SOLDER AREA,
 30u" Min NICKEL UNDER PLATE.
 SHELL: STEEL,100u" Min NICKEL TOP OVER,
 50u" Min COPPER UNDER PLATE.
 BOARD LOCK:COPPER ALLOY, 100u" Min MATTE TIN PLATED.
 SCREW LOCK: COPPER ALLOY, 100u" Min BRIGHT NICKEL PLATED.

3. PART NUMBER DESCRIPTION: **10090768-S XX X X LF**

SERIES NO. _____ LF: ROHS COMPLIANT
 TYPE _____ FLANGE MOUNTING OPTION
 S: SOCKET (FEMALE) V: UNC #4-40 SCREWS/LOCKS
 NUMBER OF CONTACTS _____ CONTACT FINISH
 09: 9-PIN 4: FLASH GOLD
 15: 15-PIN 6: 30u" PLATING OPTION AVAILABLE
 25: 25-PIN ON REQUEST
 37: 37-PIN

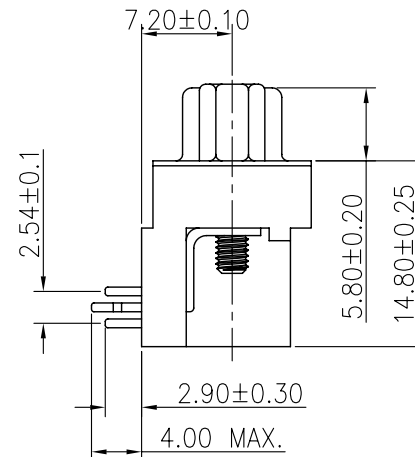

POS.	PART NO.
09P	10090768-S09*VLF
15P	10090768-S15*VLF
25P	10090768-S25*VLF
37P	10090768-S37*VLF

POS.	A	B	C	G
09P	30.81	24.99	16.33	2.74
15P	39.24	33.32	24.66	2.74
25P	53.04	47.04	38.38	2.77
37P	69.32	63.50	54.84	2.77

mat'l. code				tolerances unless otherwise specified		CUSTOMER COPY		FCI	
ltr	ecn no	dr	date	linear	.X ± 0.38	projection	www.fciconnect.com		
C					.XX ± 0.25		title		
				angles	.XXX ± 0.10		D-SUB FEMALE RIGHT-ANGLE EU STYLE		
					0° ± 2°		product family		code
				dr	JASON HSU 6/30/08		D-SUB		TWN
				enr	JASON HSU 6/30/08	MM	size		sheet
				chr	ALIAS BABU 9/11/12	1:1	10090768		2 of 2
				appd	MITHUN PAUL 9/11/12				
sheet index	revision sheet								