

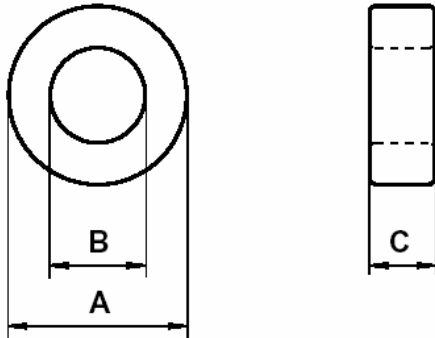

Specification for:
ZW49725TC

110 Delta Drive
Pittsburgh, PA 15238
Phone: 412/696-1333
Fax: 412/696-0333
Email: magnetics@spang.com

DIMENSIONS



(mm)	Uncoated Nominal:	Coated Min:	Coated Max:
O.D. (A)	107	105.3	109.5
I.D. (B)	65.0	63.3	66.1
Ht. (C)	25.0	24.55	26.05

Eff. Parameters		
A_e mm ²	l_e mm	V_e mm ³
514.3	259.31	133351

INDUCTANCE

AL value (nH/T ²)	Test conditions
21184 ± 30%	10 kHz, 0.5 mT (For N = 5, use 1.43 mA), 25°C
Permeability = 8500 ± 30% (See Note)	

ELECTRICAL LOSSES

$\tan \delta / \mu_i$	Test conditions	
$\leq 20 \cdot 10^{-6}$	10 kHz	0.5 mT, 25°C
$\leq 300 \cdot 10^{-6}$	100 kHz	

COATING

Epoxy rated for 200°C continuous operation.
Voltage breakdown rating 2000 V Min Wire-to-Wire.

NOTE

For toroids > 87 mm OD, W material nominal permeability is 8500

Spec. modification	Previous	Revised
2011-03-25	Loss Factor Reference Only	Loss Factor Limits