

## XLM-15.0-M5

### Industrial LCD Monitors (Touch Optional)

Since 1994 EarthLCD has supplied LCD monitor solutions for industrial machines, CRT replacement, point-of-sale and medical equipment. Available interfaces include NTSC, HDMI and VGA. Touchscreens are available in resistive and capacitive touch interfaces. By using our open frame, our LCD expertise has been honed to help customers meet their specific needs.

Earth Computer Technologies, Inc is a maker of industrial LCDs and embedded products including the award-winning ezLCD technology from EarthLCD, the recognized leader in smart touch LCDs.



## 15" Industrial LCD Monitor

Commercial and industrial applications include: ATM machines, industrial equipment, instrumentation, kiosks, military, medical, arcade games, marine, security, test equipment, gaming, or any application requiring a color LCD display.

### Features:

- 15" XGA LCD panel with LED backlight
- HDMI, VGA and NTSC/PAL video inputs
- Commercial and industrial applications
- 0°C ~ +60°C operating temperature range
- Contrast ratio: 350:1 typical
- 350 cd/m2 Brightness typical
- 20,000 hours LED life typical
- OSD Controls: contrast, phase, clock, color, H&V position, auto-tune, recall
- VESA and multiple mounting hole options
- Base stand with tilt included
- +12V power supply included

### Options (sold separately):

- USB four wire resistive touchscreen
- HDMI or VGA Cable

### Product Specifications:

Screen Size (Diagonal):	15"
Display Technology:	TFT
Resolution:	1024 x 768 (XGA)
Brightness:	350 Nits
Interface Input Modes:	VGA
Colors:	16 Million
Active Area (mm):	228.09 x 304.13
Contrast Ratio:	350:1
Horizontal Viewing Angle:	80° L/R
Vertical Viewing Angle:	55° (U) / 80° (D)
Operating Temperature:	0°C to 60°C
Storage Temperature:	-25°C to 60°C
Input Voltage:	+12V DC
Power Consumption:	1300 mA
Display Backlight:	CCFL
RoHS Compliant:	Yes
Outline Dimensions:	273.69 x 352.93 (mm)
Outline Dimensions (in):	10.78 x 13.90
High-Bright Option:	1,000 Nits
Touch Screen Version Available:	Yes
Standard:	XLM-15.0-M5
Hi-Bright:	XLM-15.0-M5-HB
Touch:	XLM-15.0-M5-RT-USB
Hi-Bright:	XLM-15.0-M5-HB-RT-USB

GENERAL NOTES:

/1/ XLM-15.0-M5 DATASHEET REFERENCE

REVISIONS				
ZONE	REV.	DESCRIPTION	DATE	APPROVED
	X1	XLM-15.0-.5	2020-06-25	

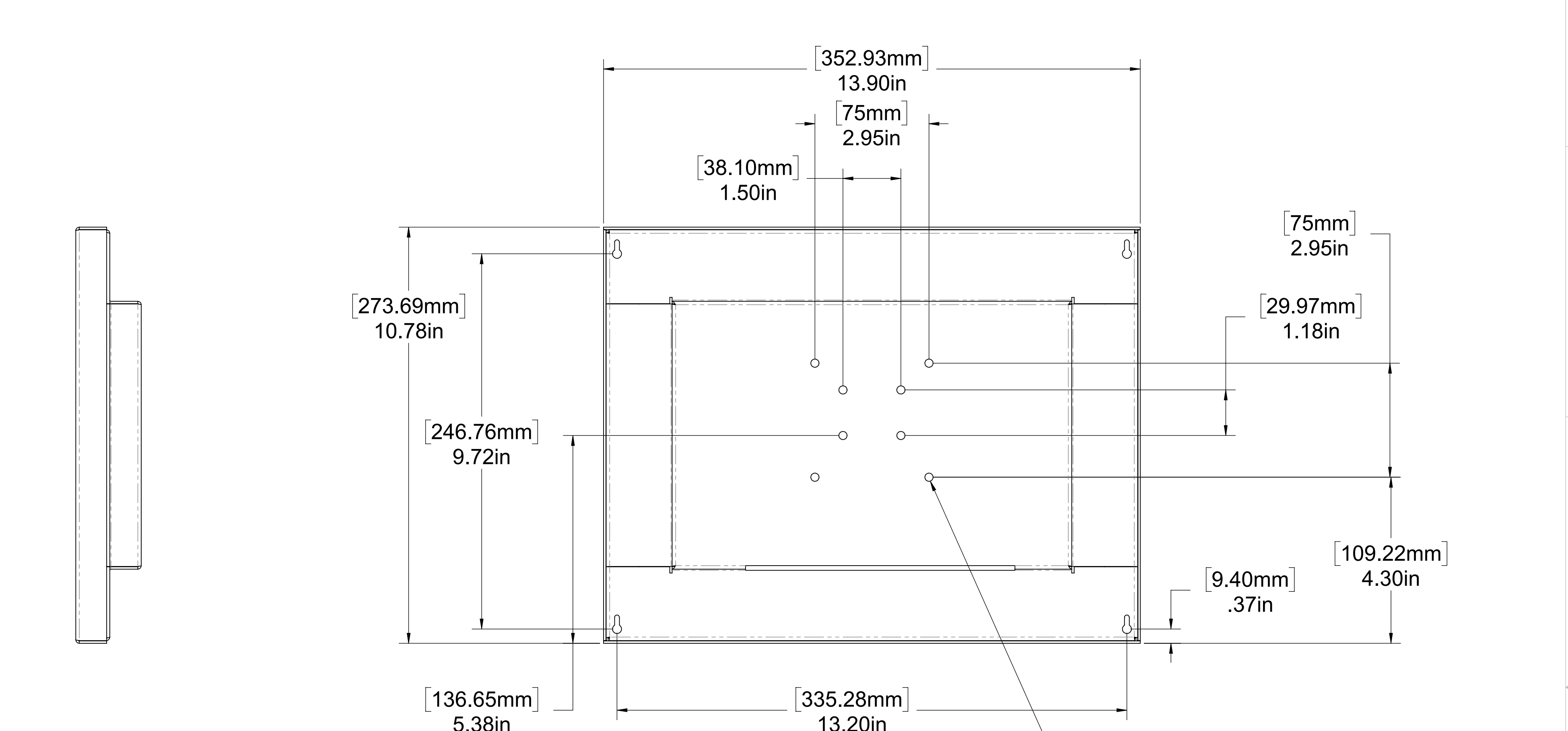
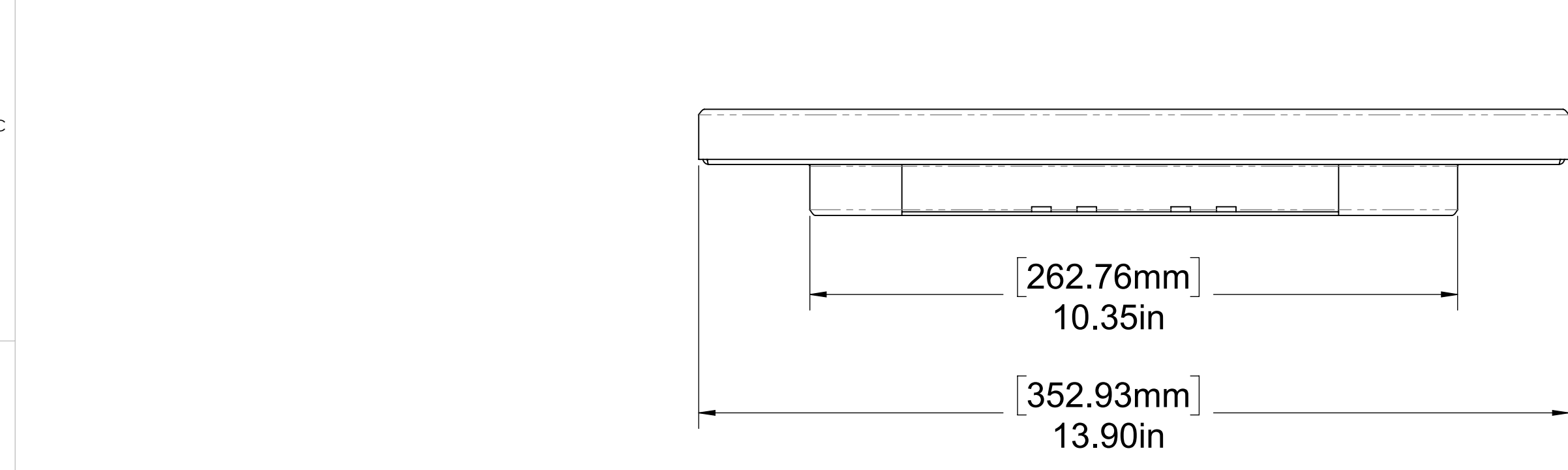
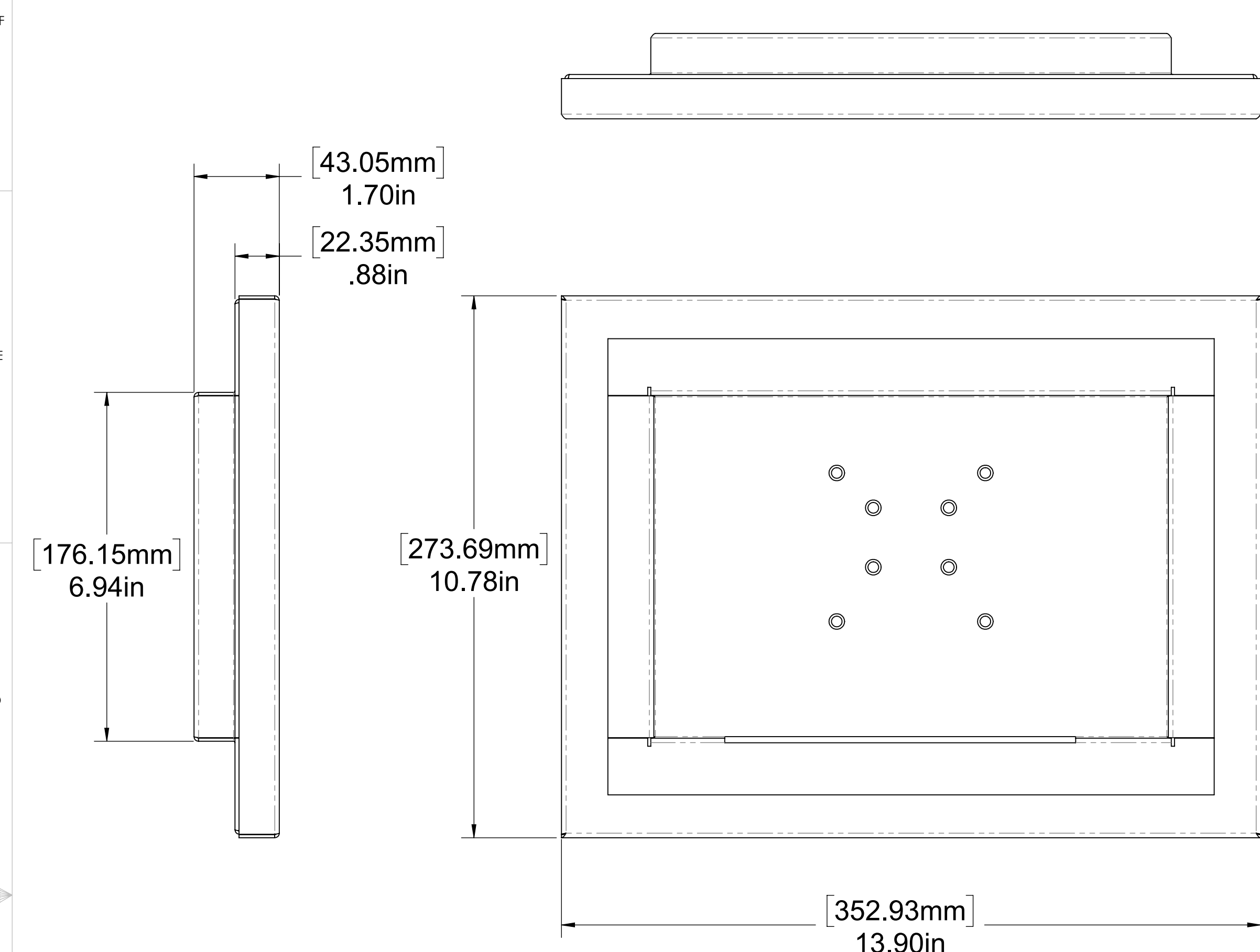

M4 HARDWARE (8X)

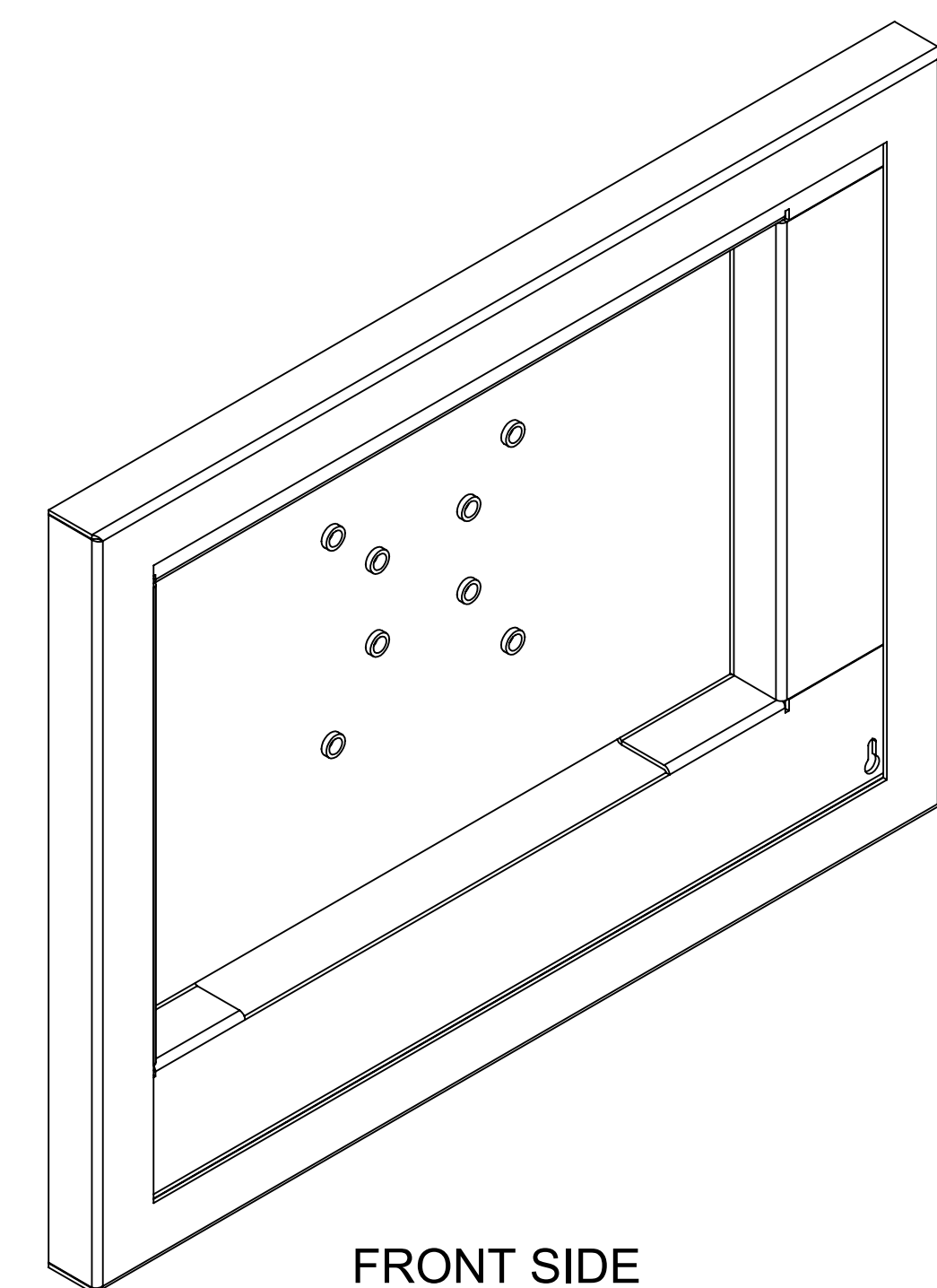

FRONT SIDE

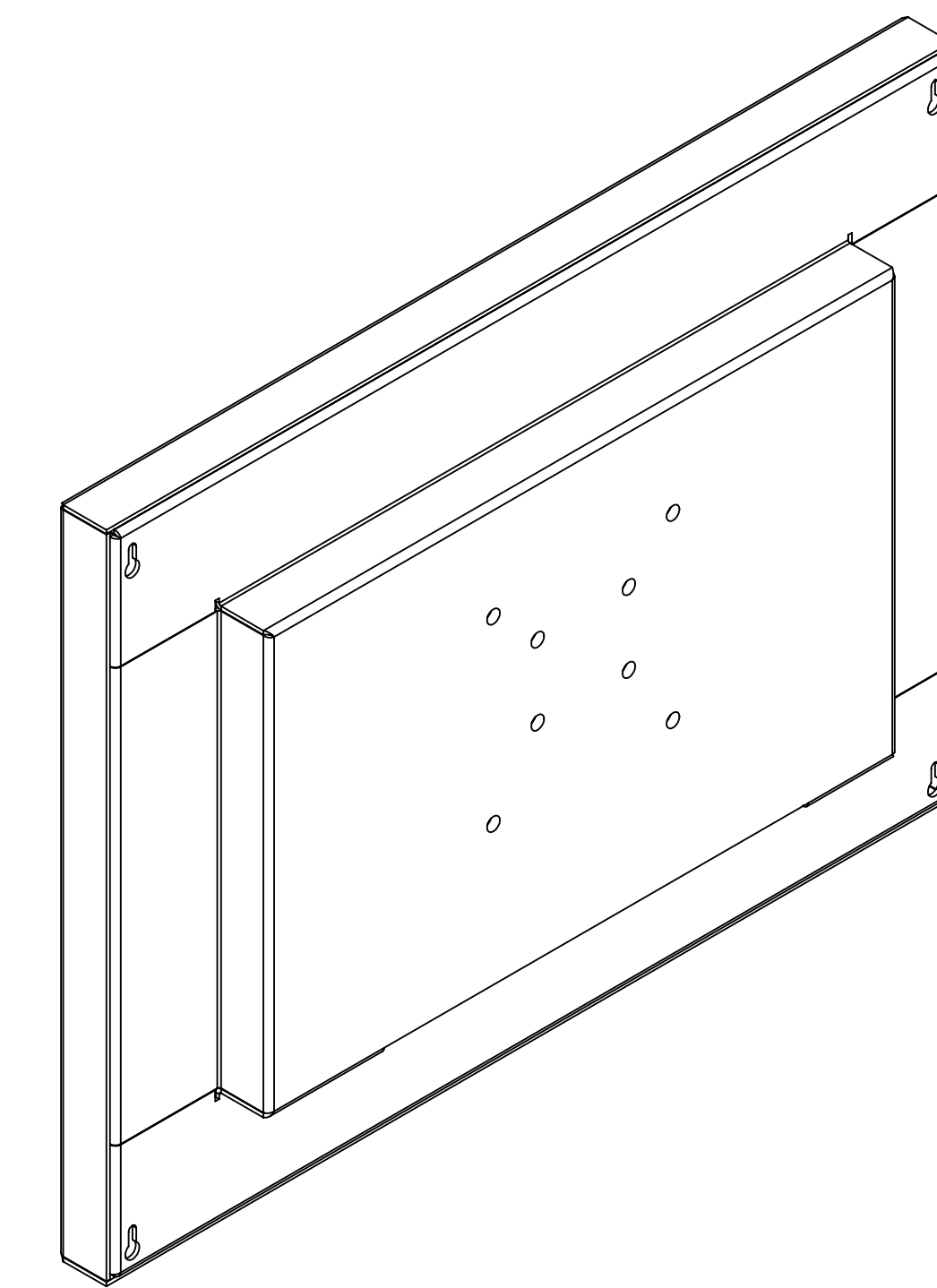

BACK SIDE

THIRD ANGLE PROJECTION

PROPRIETARY AND CONFIDENTIAL  
THE INFORMATION CONTAINED IN THIS DRAWING IS THE SOLE PROPERTY OF EARTH LCD. ANY REPRODUCTION IN PART OR AS A WHOLE WITHOUT THE WRITTEN PERMISSION OF EARTH LCD IS PROHIBITED.

UNLESS OTHERWISE SPECIFIED:		NAME	DATE	EarthLCD	
DRAWN	JTU	2020-06-25	TITLE:		
CHECKED			XLM-15.0-M5		
ENG APPR.			SIZE   PART NO:		
MFG APPR.			D   XLM-15.0-M5		
G.A.			REV		
DRAWING NO:	XLM_15.0_M5_ASY_X1		X1		
MATERIAL	SEE NOTES		SCALE: 1:2 WEIGHT:		
FINISH	SEE NOTES		SHEET 1 OF 1		

GENERAL NOTES:

/1/ TILT STAND DATASHEET.

REVISIONS				
ZONE	REV.	DESCRIPTION	DATE	APPROVED
	X1	TILT STAND	2020-06-25	

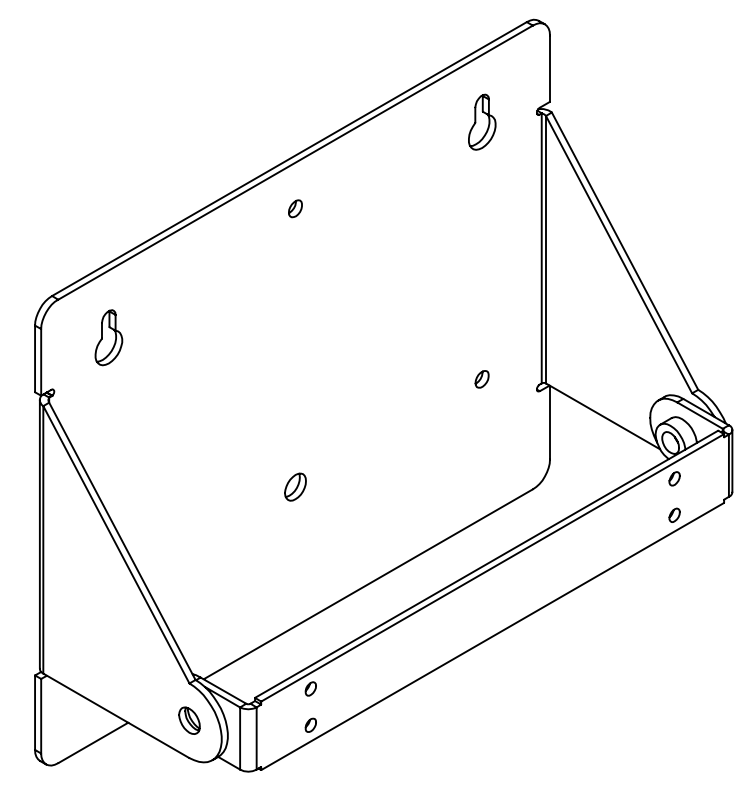
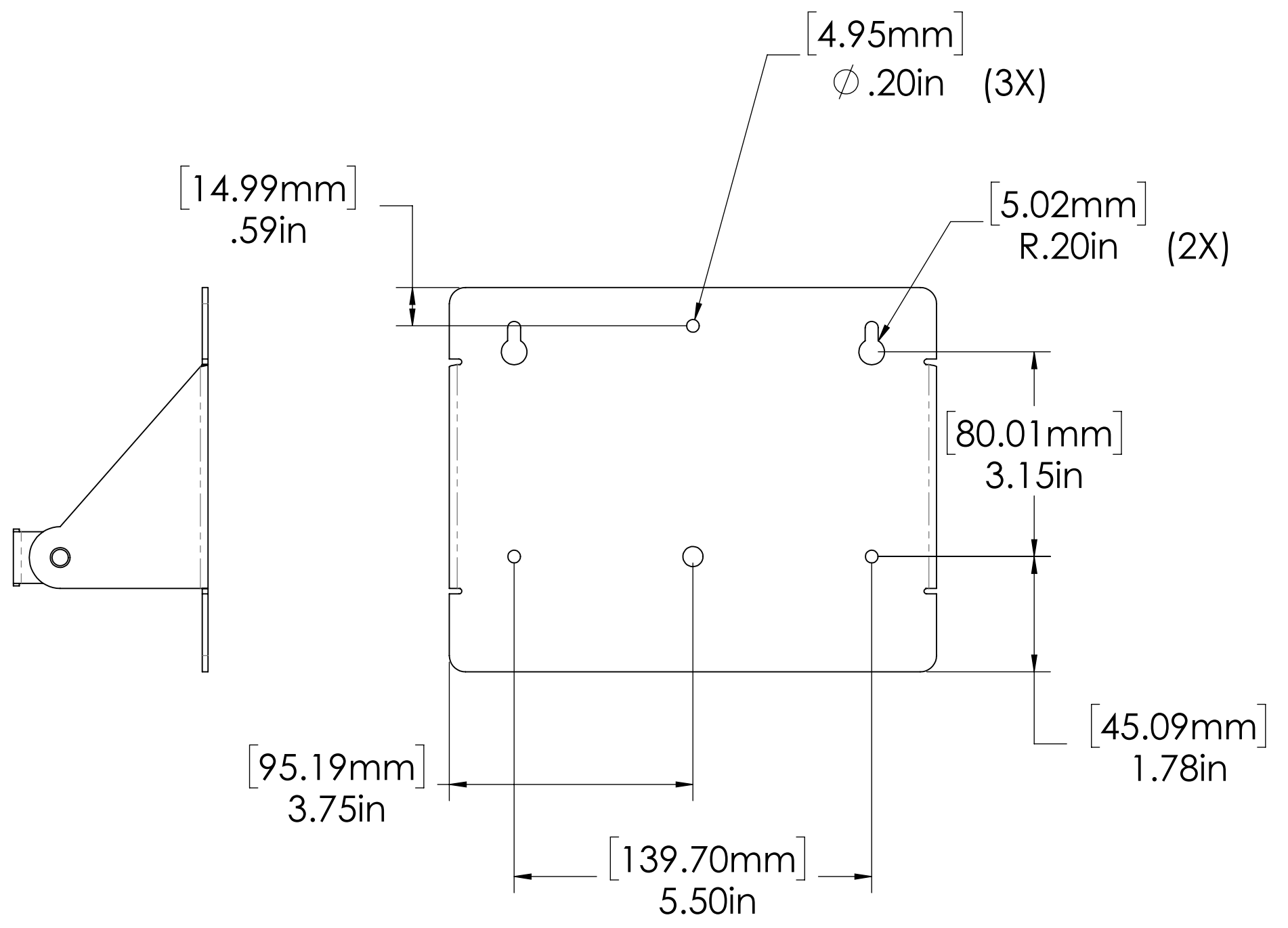
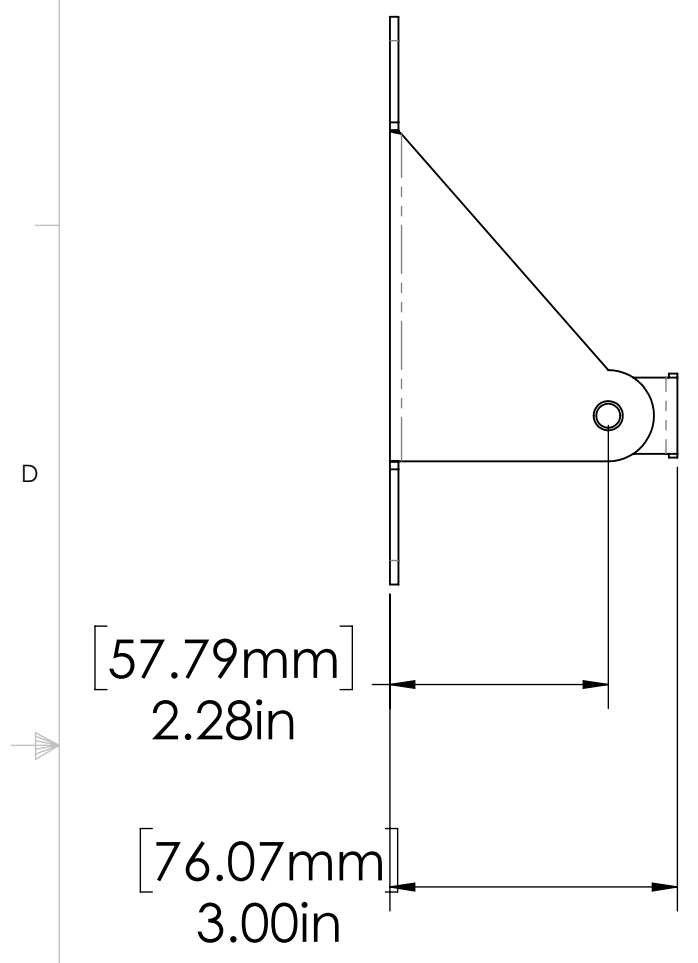
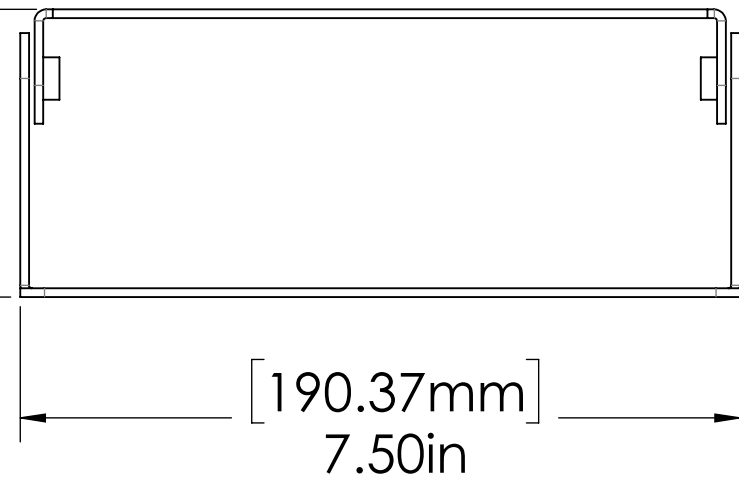
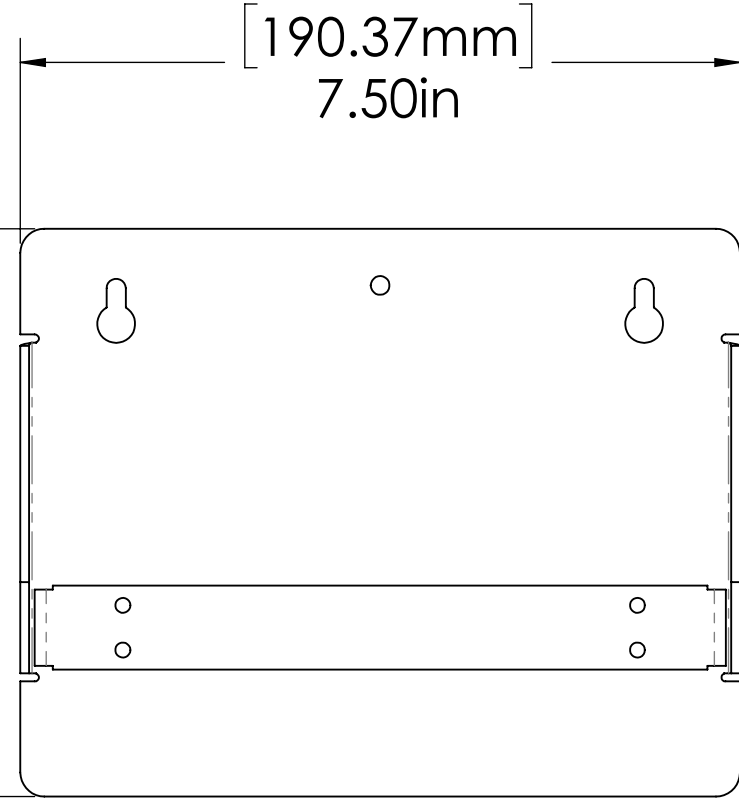
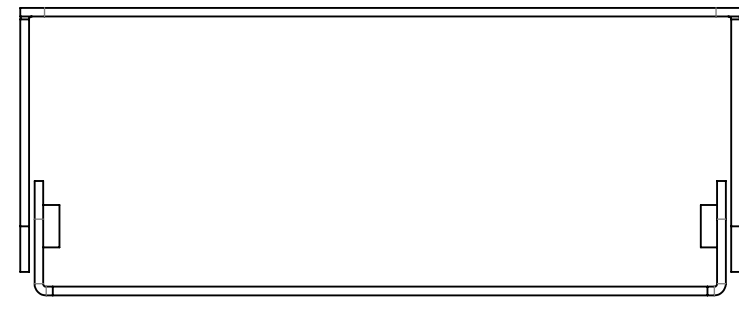

<p><b>THIRD ANGLE PROJECTION</b></p> <p><b>PROPRIETARY AND CONFIDENTIAL</b> THE INFORMATION CONTAINED IN THIS DRAWING IS THE SOLE PROPERTY OF EARTH LCD. ANY REPRODUCTION IN PART OR AS A WHOLE WITHOUT THE WRITTEN PERMISSION OF EARTH LCD IS PROHIBITED.</p>			<p>UNLESS OTHERWISE SPECIFIED:</p> <p>DIMENSIONS ARE IN INCHES</p> <p>TOLERANCES:</p> <p>FRACTIONAL ±</p> <p>ANGULAR: BEND ± 1/2°</p> <p>TWO PLACE DECIMAL ±0.01</p> <p>THREE PLACE DECIMAL ±0.005</p>	<table border="1"> <tr><th>NAME</th><th>DATE</th></tr> <tr><td>JYU</td><td>2020-06-25</td></tr> </table>	NAME	DATE	JYU	2020-06-25	<p><b>EarthLCD</b></p> <p>TITLE:</p> <p><b>TILT STAND</b></p>									
	NAME	DATE																
	JYU	2020-06-25																
		TC_PROG_2020_006	<p>INTERPRET GEOMETRIC TOLERANCING PER:</p> <p>MATERIAL SEE MATERIAL</p> <p>FINISH SEE MATERIAL</p>	<table border="1"> <tr><th>DRAWN</th><th>ENG APPR.</th><th>MFG APPR.</th><th>Q.A.</th></tr> <tr><td></td><td></td><td></td><td></td></tr> </table>	DRAWN	ENG APPR.	MFG APPR.	Q.A.						<table border="1"> <tr><th>SIZE</th><th>PART NO:</th><th>REV</th></tr> <tr><td><b>C</b></td><td>TILT STAND</td><td>X1</td></tr> </table>	SIZE	PART NO:	REV	<b>C</b>
DRAWN	ENG APPR.	MFG APPR.	Q.A.															
SIZE	PART NO:	REV																
<b>C</b>	TILT STAND	X1																
	NEXT ASSY	USED ON	<p>DO NOT SCALE DRAWING</p>	<p>DRAWING NO:</p> <p>TILT_STAND_ASY_X1</p>	<table border="1"> <tr><th>SCALE: 1:2</th><th>WEIGHT:</th><th>SHEET 1 OF 1</th></tr> <tr><td></td><td></td><td></td></tr> </table>	SCALE: 1:2	WEIGHT:	SHEET 1 OF 1										
SCALE: 1:2	WEIGHT:	SHEET 1 OF 1																
	APPLICATION																	