

PRODUCT NUMBER
85928-XYLFF

X DENOTES PLATING CODE

PLATING CODE	PERFORMANCE LEVEL
85928-1YYLF	IEC PERFORMANCE LEVEL 1 (250 Mating cycles) /
85928-2LYLFF (NOTE-5)	TELCORDIA CO (200 MATING CYCLE)
85928-EYYLFF (NOTE-4)	TELCORDIA UE (HIGH PERFORMANCE FOR AEROSPACE APPLICATION)
85928-3YYLFF (NOTE-4)	TELCORDIA UE (200 MATING CYCLES)

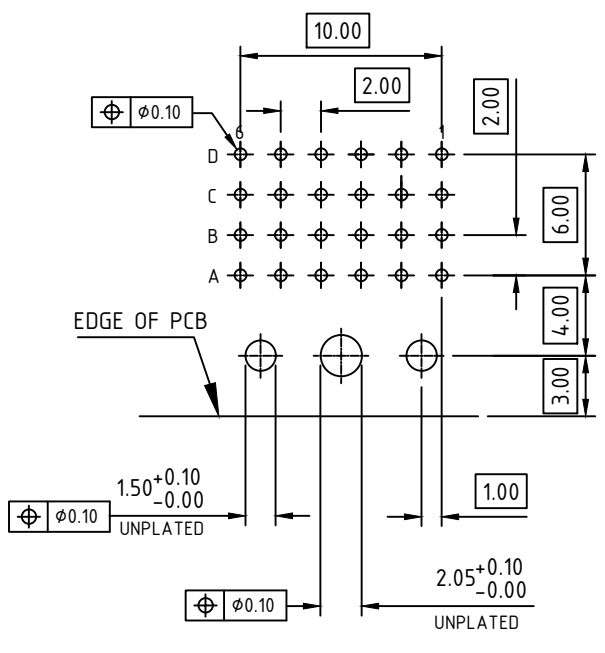
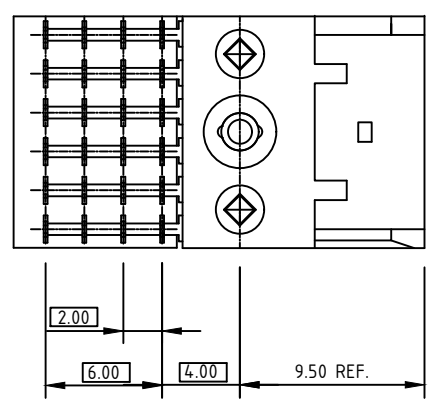
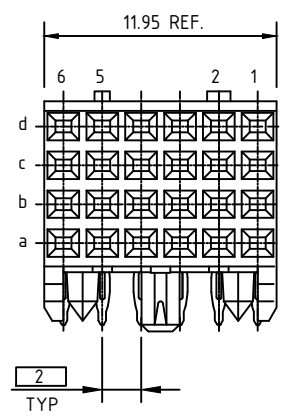
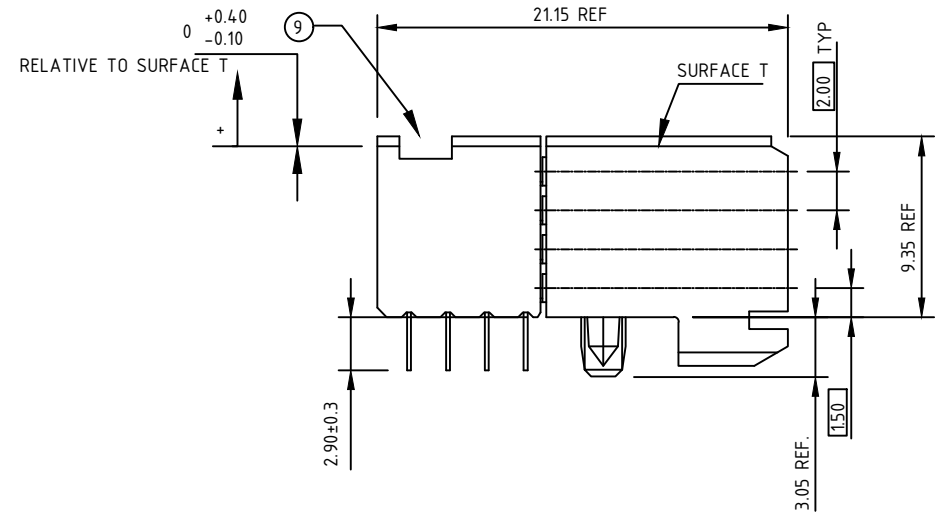

PART NUMBER	CONFIGURATION						
	ROW	6	5	4	3	2	1
85928-X01 SEE NOTE 11 LEAD FREE OPTION	D	1	0	1	0	1	0
	C	0	1	0	1	0	1
	B	1	0	1	0	1	0
	A	0	1	0	1	0	1
85928-X02 SEE NOTE 11 LEAD FREE OPTION	D	0	1	0	1	0	1
	C	1	0	1	0	1	0
	B	0	1	0	1	0	1
	A	1	0	1	0	1	0
85928-X03 SEE NOTE 11 LEAD FREE OPTION	D	1	1	0	0	1	1
	C	1	1	0	0	1	1
	B	1	1	0	0	1	1
	A	1	1	0	0	1	1

LOAD PATTERN	
1	LOADED
0	NOT LOADED

NOTES :

- EXTENSIONS CAN BE ADDED TO THE PART NUMBER LOGIC IF LUBRICATED CONTACTS ARE REQUIRED
IF LUBRICATED CONTACTS ARE REQUIRED
e.g. 85928-XYLFF L DENOTES LUBRICATED
- PLATING AT TERMINAL AREA : Sn MATT FINISH PLATING (LF)
- PLATING ON CONTACT AREA MEETS THE PERFORMANCE LEVELS SHOWN IN TABLE ON THIS SHEET .
PRECIOUS METAL PLATING MAY BE EITHER GOLD OR PALLADIUM NICKEL
- SPECIAL PLATING CODE IS GOLD OVER NICKEL PLATING FOR INCREASED RESISTANCE TO FRETTING CORROSION UNDER HIGH VIBRATION APPLICATION.
- PLATING CODE - 2L : GXT PLUS - ADDITIONAL HIGH PERFORMANCE LUBE OVER GXT PLATING.
- CONNECTOR MATERIALS:
HOUSING : THERMOPLASTIC UL 94-V0
CONTACT : COPPER ALLOY
- PRODUCT SPECIFICATION : GS-12-002
- APPLICATION SPECIFICATIONS : BUS-20-061, GS-20-001 & TA-941
- TOP SURFACE OF PRESS BLOCK MAY EXTEND UP TO 0.4MM HIGHER THAN HOUSING. THIS MAY AFFECT THE TAIL LENGTH BEFORE APPLICATION TO A BOARD.
- THESE PRODUCTS WHERE THE PART NUMBER ENDS IN "LF" MEET THE EUROPEAN UNION DIRECTIVES AND OTHER COUNTRY REGULATIONS AS DESCRIBED IN GS-47-0004.
- THIS PRODUCTS WILL WITHSTAND EXPOSURE TO 240°C FOR 60 SECONDS IN A CONVECTION, INFAR-RED OR VAPOR PHASE REFLOW OVEN.
- FOR RECOMMENDED PTH DIMENSIONS REFER DRAWING NO : 58351.
- SYMBOL WILL BE NEXT TO ANY DIMENSION, VIEW OR NOTE WHICH HAS BEEN MODIFIED WITH CURRENT DRAWING REVISION.

PCB LAYOUT - COMPONENT SIDE.

mat'l. code				surface		tolerance		projection		product family	
				ISO 1302		ISO 406 ISO 1101		mm		METRAL	
ltr	ecn no	dr	date	tolerances unless otherwise specified						title	
P	DG08-0171	Cenh	2007-05-22	angles	linear	.X±0.3				B SERIES RA SIGNAL REC.ASSY	
R	DG09-0068	TER	2008-08-26			.XX±0.10				4 ROW, 1 MOD, PF	
S	ELX-I-38044	ARUN	2020-08-17	0°±2°		.XXX±0.050		scale		sheet 1 of 1	
T	ELX-I-40832	RAHUL	2021-03-28	dr	R.VISSCHERS	1995-06-14		Amphenol FCI		85928	
				enrg	RAHUL	2021-04-28				A3	
				chr	ALEX BABU	2021-04-28				type	
				appd	SANOJ	2021-04-28				Product Customer Drawing	
sheet index	revision sheet	T									
		1									

Amphenol FCI

© 2016 AFCI