

EDP NUMBER	FRONT SHELL PLATING
70665-1009	BRIGHT NICKEL

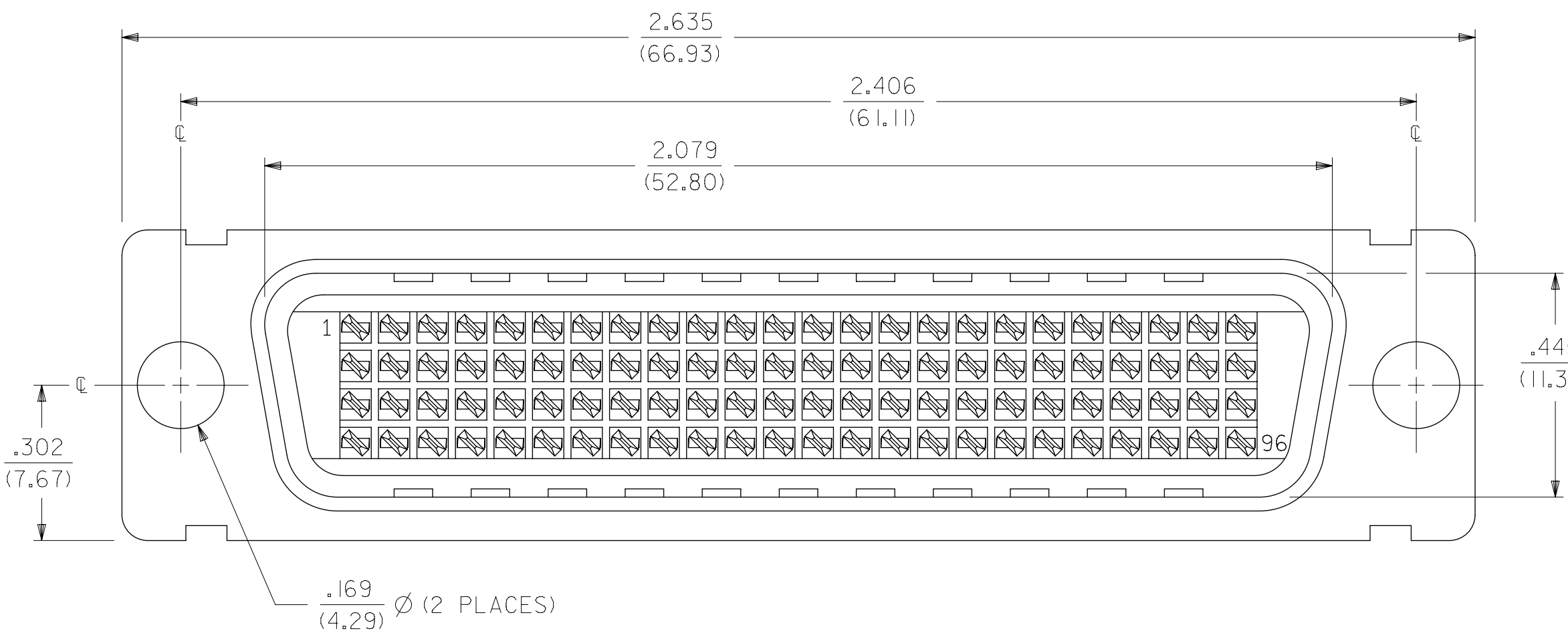

NOTES:

- CONNECTOR MATERIALS:  
HOUSING AND INSERT-MOLDED STICKS ARE MADE OF GLASS FILLED LCP (LIQUID CRYSTAL POLYMER), U.L. 94 V-0, COLOR IS BLACK; TERMINALS ARE .018/(0.46) THICK PHOSPHOR BRONZE; TERMINAL PLATING IS .000030/(.00076) MINIMUM GOLD IN CONTACT AREA, AND .000100/(.00254) MINIMUM TIN ON P.C. TAILS, OVER NICKEL UNDERPLATE OVERALL.
- FRONT SHELL:  
DRAW QUALITY STEEL, .020/(0.51) THICK;  
**PLATING: SEE TABLE**  
BRIGHT TIN: 150-250 MICROINCHES/(3.81-6.35 MICROMETERS) BRIGHT TIN OVER 50-150 MICROINCHES/(1.27-3.81 MICROMETERS) NICKEL OVER COPPER FLASH OVERALL (OPTIONAL).  
BRIGHT NICKEL: 100-175 MICROINCHES/(2.54-4.44 MICROMETERS) BRIGHT NICKEL OVER 50 MICROINCHES/(1.27 MICROMETERS) MAXIMUM COPPER OVERALL.
- BACK SHELL:  
DRAW QUALITY STEEL, .016/(0.41) THICK;  
**PLATING: 150-250 MICROINCHES/(3.81-6.35 MICROMETERS) BRIGHT TIN OVER 50-150 MICROINCHES/(1.27-3.81 MICROMETERS) NICKEL OVER COPPER FLASH OVERALL (OPTIONAL).**
- ALL DIMENSIONS ARE SHOWN FOR REFERENCE ONLY UNLESS SPECIFIED OTHERWISE.
- THIS CONNECTOR CONFORMS TO PRODUCT SPECIFICATION PS-70660.  
NOTE FOR LEAD FREE CONVERSION:  
THE PRIMARY SHIPPING CARTON WILL BE LABELED "COMPLIANT TO RoHS DIRECTIVE 2002/95/EC AND ELV ANNEX II OF DIRECTIVE 2000/53/EC". CARTONS WITHOUT THIS LABEL MAY CONTAIN PRODUCT WITH LEAD.

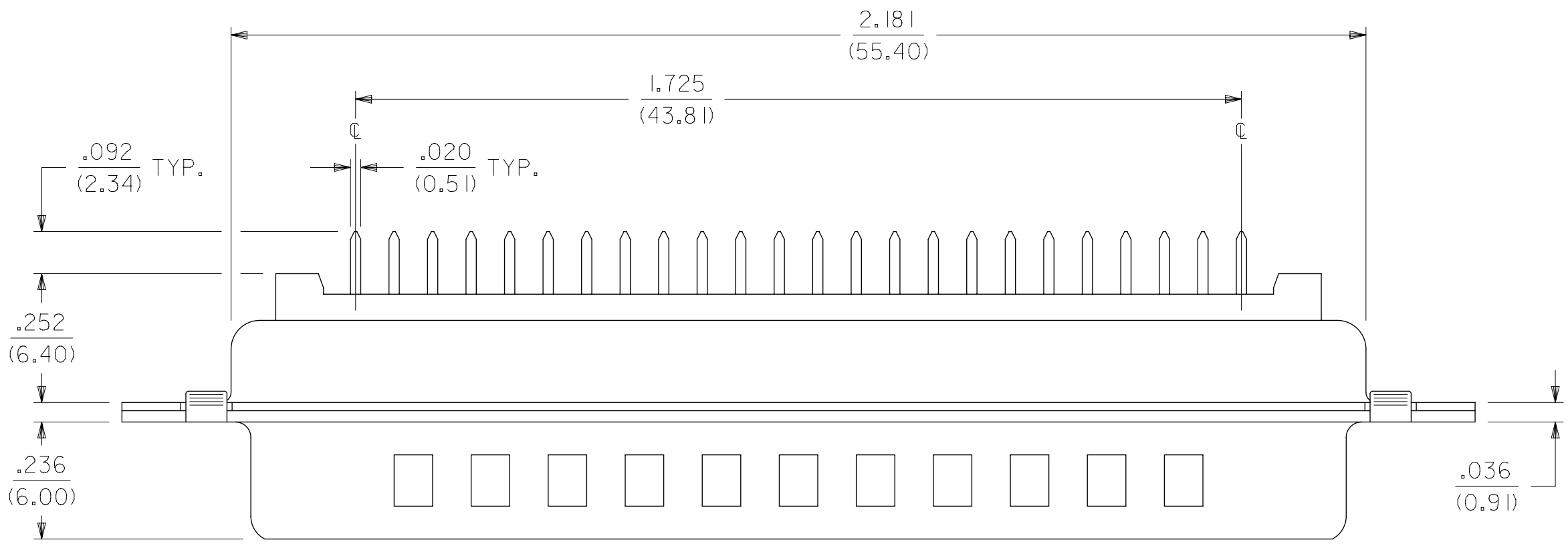
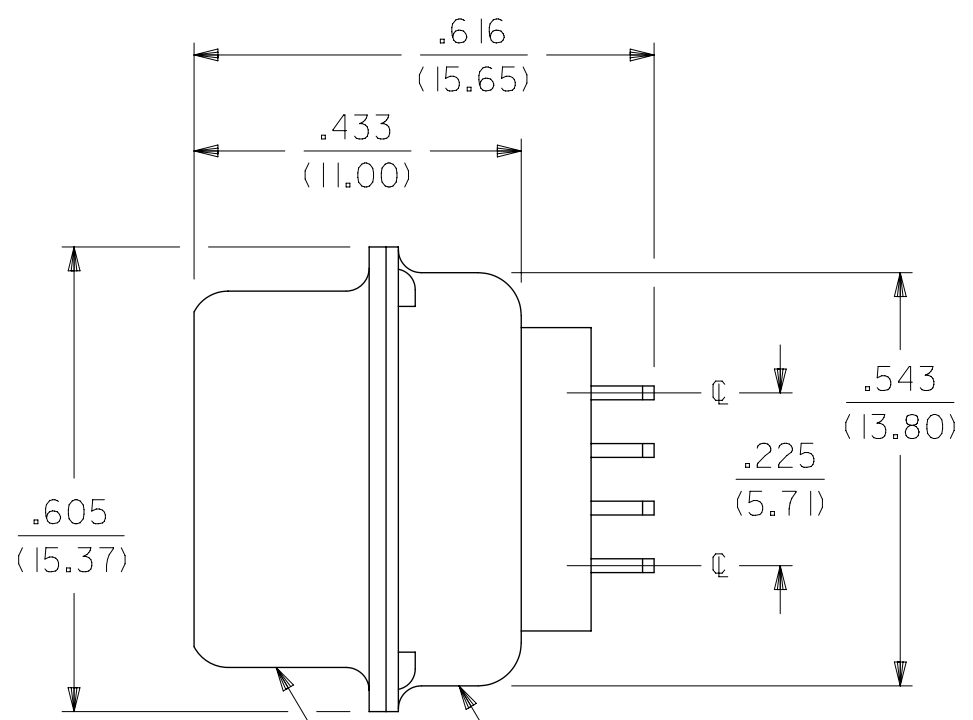

SEE NOTE #3  
SEE NOTE #2

THIS DRAWING CONTAINS INFORMATION THAT IS PROPRIETARY TO MOLEX ELECTRONIC TECHNOLOGIES, LLC AND SHOULD NOT BE USED WITHOUT WRITTEN PERMISSION																																																			
DIMENSION UNITS		SCALE		CURRENT REV DESC: OBSOLETE PART NO																																															
IN/MM		4:1		<table border="0"> <tr> <td colspan="2">GENERAL TOLERANCES (UNLESS SPECIFIED)</td> <td colspan="2">EC NO: 625872</td> <td colspan="2">2019/06/12</td> </tr> <tr> <td>4 PLACES</td> <td>±</td> <td>±</td> <td>DRWN: AKUMAR19</td> <td colspan="2">2019/11/06</td> </tr> <tr> <td>3 PLACES</td> <td>±</td> <td>±</td> <td>CHK'D: GB</td> <td colspan="2">2019/11/12</td> </tr> <tr> <td>2 PLACES</td> <td>±</td> <td>±</td> <td>APPR: GGA</td> <td colspan="2">2019/11/12</td> </tr> <tr> <td>1 PLACE</td> <td>±</td> <td>±</td> <td colspan="3">INITIAL REVISION:</td> </tr> <tr> <td>0 PLACES</td> <td>±</td> <td>±</td> <td>DRWN: GLT</td> <td colspan="2">1991/09/30</td> </tr> <tr> <td>ANGULAR TOL</td> <td>± 0.5°</td> <td></td> <td>APPR: CAB</td> <td colspan="2">1991/09/30</td> </tr> </table>						GENERAL TOLERANCES (UNLESS SPECIFIED)		EC NO: 625872		2019/06/12		4 PLACES	±	±	DRWN: AKUMAR19	2019/11/06		3 PLACES	±	±	CHK'D: GB	2019/11/12		2 PLACES	±	±	APPR: GGA	2019/11/12		1 PLACE	±	±	INITIAL REVISION:			0 PLACES	±	±	DRWN: GLT	1991/09/30		ANGULAR TOL	± 0.5°		APPR: CAB	1991/09/30	
GENERAL TOLERANCES (UNLESS SPECIFIED)		EC NO: 625872								2019/06/12																																									
4 PLACES	±	±	DRWN: AKUMAR19							2019/11/06																																									
3 PLACES	±	±	CHK'D: GB							2019/11/12																																									
2 PLACES	±	±	APPR: GGA							2019/11/12																																									
1 PLACE	±	±	INITIAL REVISION:																																																
0 PLACES	±	±	DRWN: GLT	1991/09/30																																															
ANGULAR TOL	± 0.5°		APPR: CAB	1991/09/30																																															
DOCUMENT NUMBER				DOC TYPE		DOC PART		REVISION																																											
SDA-70665-1001				PSD		001		G																																											
DRAFT WHERE APPLICABLE MUST REMAIN WITHIN DIMENSIONS		THIRD ANGLE PROJECTION		DRAWING		SERIES		MATERIAL NUMBER																																											
		C-SIZE		70665		SEE TABLE		CUSTOMER																																											
						GENERAL MARKET		SHEET NUMBER																																											
								1 OF 2																																											

DOCUMENT STATUS	P1	RELEASE DATE	2019/11/12	07:18:08
-----------------	----	--------------	------------	----------



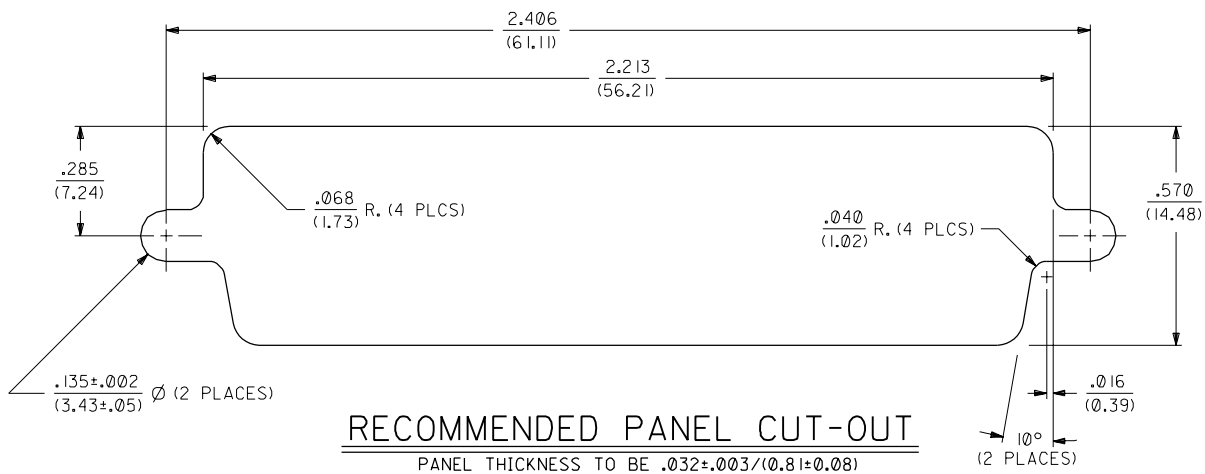

**RECOMMENDED PANEL CUT-OUT**  
 PANEL THICKNESS TO BE  $.032 \pm .003 / (0.81 \pm 0.08)$

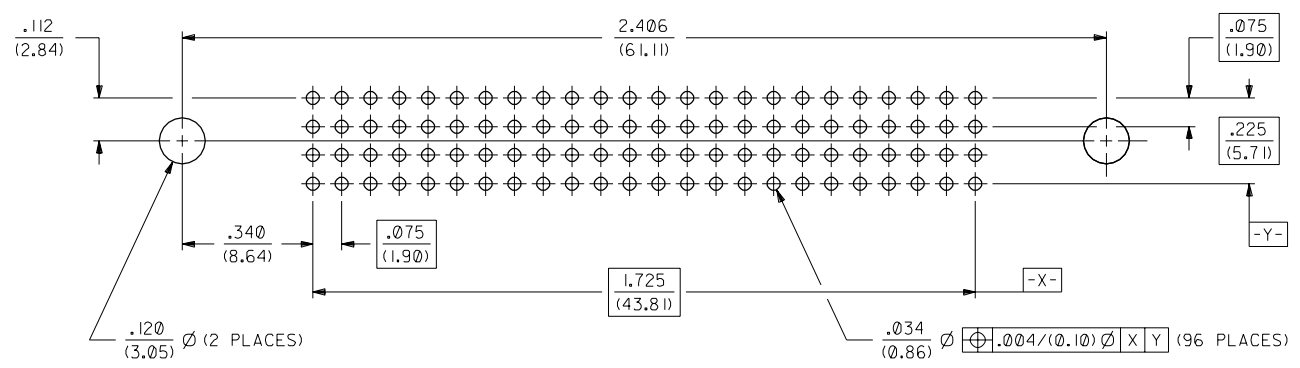

**RECOMMENDED PCB AND MTG HOLE LAYOUT**  
 BOARD THICKNESS TO BE  $.062 \pm .007 / (1.57 \pm 0.18)$

D	SEE SHEET #1
---	--------------

DIMENSIONS SHOWN (METRIC) INCH		REVISIONS	
UNLESS OTHERWISE SPECIFIED TOLERANCES ANGULAR $\pm .0000$ AP		MFG. SH.	REV. LTR.
3 PLACE $\pm .003$		REVISE ONLY ON CAD SYSTEM	
2 PLACE $\pm$ $\pm 0.08$		TITLE	
1 PLACE $\pm$		LFH, .075 PITCH, 96 CKT., VERTICAL I/O PLUG CONNECTOR (SALES DRAWING)	
DRAFT WHERE APPLICABLE MUST REMAIN WITHIN DIMENSIONS		MOLEX INCORPORATED SHEET NO. DATE	
DRAWN BY SCHMIDGALL BY GWF		L1SLE,ILL. 60532 U.S.A. 2 06/05/96	
CHK'D. BY GWF		PART NO. DRWG. NO.	
SCALE 4:1		SEE SHEET #1 SDA-70665-1001	
APP'D. BY GWF		FILE NAME DIV. SIZE	
		SD70665K3 DCN MOLEX INC. AND SHOULD NOT BE USED WITHOUT WRITTEN PERMISSION DA C	