

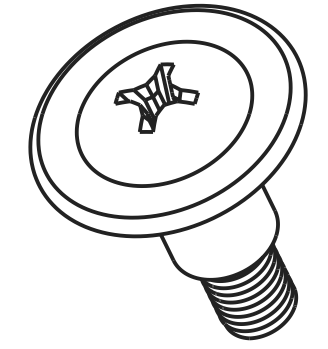

REVISIONS				
DRAWN	REV	DESCRIPTION	DATE	APPROVED
PAM	-	ORIGINAL	12-5-03	JS
PAM	A	E DIMENSION ADDED, SB-4105 WAS .215-.185	1-14-04	JS
PAM	B	M3-0.5 WAS M3, REMOVED NOTE	2-2-04	JS
PAM	C	ADDED SB-4107 & SB 4114	2-17-04	JS
PAM	D	"NO CR6" NOTE ADDED	2-18-04	JS
PAM	E	.196± .006 WAS .194	7-12-04	JS
PAM	F	ITEM CODE CHANGES	6-07-05	JS
PAM	G	QC NOTE ADDED	9-1-06	JS
PAM	H	HEAD GEOMETRY BETTER DEFINED	8-15-07	JS
TC	09	UPDATED DRAWING AND REV FORMAT, CHANGED TO DUAL DIM, SHOULDER AND THREAD GEOMETRY BETTER DEFINED, REMOVED US AND ASIA ITEM CODES	6-18-12	MS

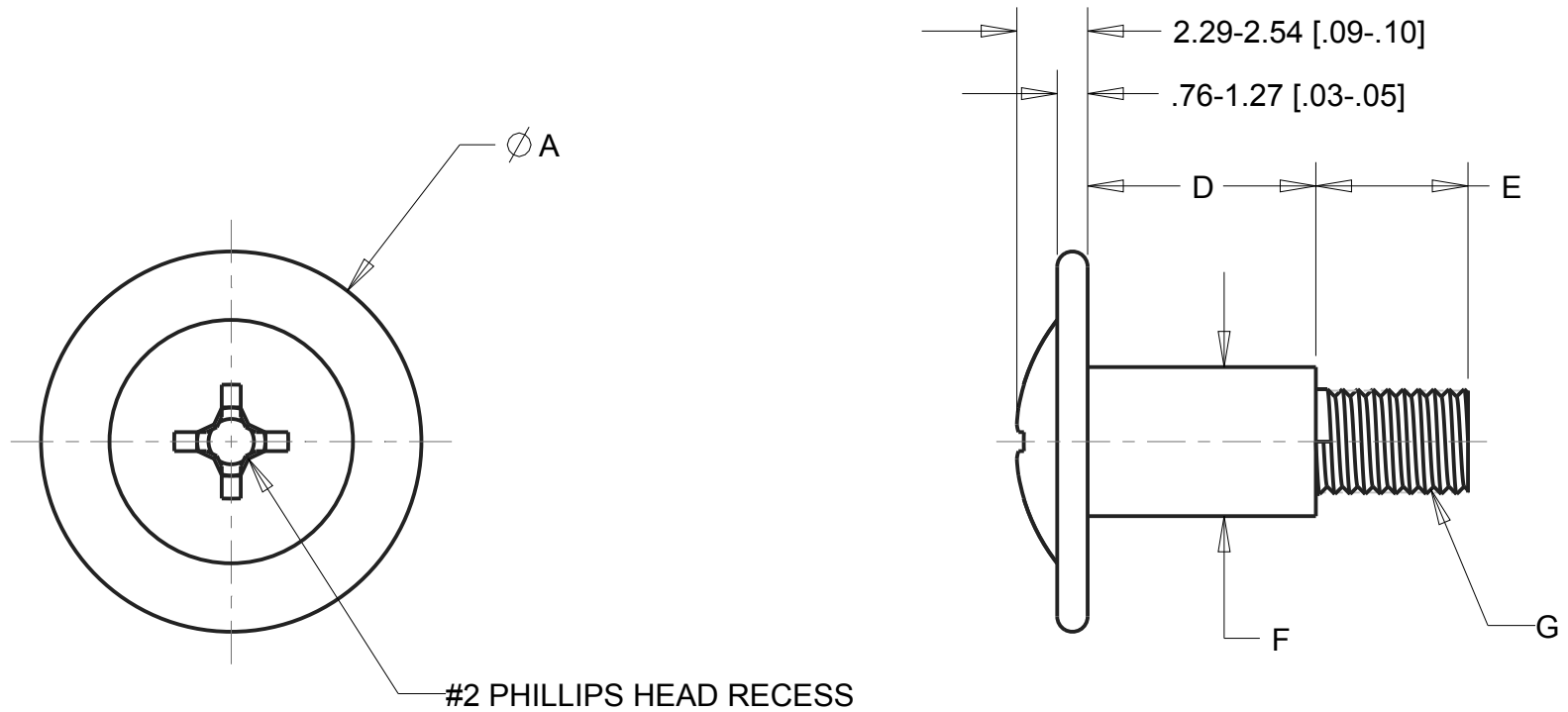

PART #	A: HEAD \varnothing	D: SHOULDER LENGTH	E: THREAD LENGTH	F: SHOULDER \varnothing	G: THREAD TYPE
SB-4102	8.89± .50 [.350± .020]	5.44± .13 [.214± .005]	4.70-5.46 [.185-.215]	4.09± .06 [.161± .0025]	6-32 UNC-2A
SB-4105	8.89± .50 [.350± .020]	5.44± .13 [.214± .005]	3.20-3.81 [.126-.150]	4.09± .06 [.161± .0025]	M3-0.5
SB-4107	8.89± .50 [.350± .020]	5.44± .13 [.214± .005]	4.70-5.46 [.185-.215]	4.09± .06 [.161± .0025]	M3-0.5
SB-4112	12.7± .50 [.500± .020]	7.62± .13 [.300± .005]	4.70-5.46 [.185-.215]	4.98± .15 [.196± .006]	6-32 UNC-2A
SB-4114	12.7± .50 [.500± .020]	7.62± .13 [.300± .005]	4.70-5.46 [.185-.215]	4.93± .06 [.194± .0025]	M4-0.7
SB-4118	12.7± .50 [.500± .020]	6.35± .13 [.250± .005]	4.70-5.46 [.185-.215]	4.78± .06 [.188± .0025]	6-32 UNC-2A

1. Zn COATING, Cr6 FREE, ASTM B-117 (72 HOURS).

NOTES:

UNLESS OTHERWISE SPECIFIED UNITS ARE: MM [IN] TOLERANCE FOR ANGLES: $\pm 1.0^\circ$	MATERIAL: LOW CARBON STEEL	AEARO TECHNOLOGIES LLC * a 3M company		
	ALLOWABLE FLASH: N/A	QUALITY CONTROL: MUST COMPLY WITH E-A-R SPECIALTY COMPOSITES SUPPLIER QUALITY MANUAL REQUIREMENTS	TITLE MACHINE SCREW - PHILLIPS - WITH SHOULDER	
GATE: N/A	NOTES: ANY FEATURE NOT DIMENSIONED IN PRINT MUST BE VISIBLY PRESENT, UTILIZE 3D CAD FOR CREATION	SIZE B	DRAWING NO. SB-41XX	PAGE NO. 1 OF 1
CALC WT.				