

Thermofit[®] Molded Parts

Specification Control Drawing

Limited Distribution

Part Number : 207W2XX-X-A15
Description : Feedthrough, Seal

NOTES

- All dimensions are in inches [millimeters]
- Dimensions appearing in table are as follows:
a - As Supplied
b - After Unrestricted Recovery
- Type "B" nut supplied with part.
- Coating is optional. As supplied dimensions appearing in table are for uncoated parts. "J" entry diameter shown will be reduced by .06 max when coating is added (see ordering information)
- "O" ring is supplied with each part. (for -12 compound "O" ring not required)

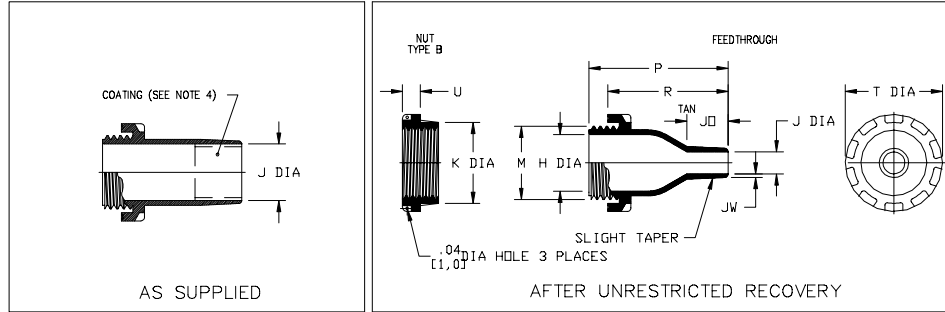

TABLE OF DIMENSIONS													
PART NUMBER	H Ref b	J		K Ref b	M Thread b	P ±10% b	R ±10% b	T Ref b	U ±10% b	JO Max b	JW ±20% b	HOLE DIA ±.02	
		Min -100 a	Max b										
207W213-A15	.47 [11,9]	.33 [8,5]	.16 [4,1]	.91 [23,1]	.79 [20,0]	2.44 [62,0]	1.93 [49,0]	1.26 [32,0]	.39 [9,9]	.60 [15,2]	.06 [1,5]	.94 [23,9]	
207W223-A15	.79 [20,1]	.65 [16,5]	.28 [7,1]	1.30 [33,02]	1.18 [30,0]	2.83 [71,9]	2.32 [58,9]	1.65 [42,0]	.39 [9,9]	.76 [19,3]	.08 [2,03]	1.34 [34,0]	
207W234-A15	1.22 [30,1]	1.04 [26,5]	.47 [11,9]	1.81 [45,9]	1.65 [42,0]	3.43 [87,1]	2.91 [73,9]	2.28 [57,9]	.39 [9,9]	1.06 [26,9]	.10 [2,54]	1.85 [47,0]	
207W245-A15	1.77 [45,0]	1.59 [40,5]	.71 [18,0]	2.34 [59,4]	2.20 [56,0]	4.02 [102,1]	3.50 [88,9]	2.80 [71,1]	.39 [9,9]	1.26 [32,0]	.12 [3,05]	2.38 [60,5]	
207W256-A15	2.68 [68,1]	2.46 [62,4]	1.18 [30,0]	3.31 [84,0]	3.15 [80,0]	4.80 [121,9]	4.29 [109,0]	3.82 [97,0]	.39 [9,9]	1.54 [39,1]	.12 [3,05]	3.35 [85,1]	

Raychem

RAYCHEM CORPORATION
300 CONSTITUTION DRIVE
MENLO PARK, CALIFORNIA 94025

Revision : F
Date : 5/7/97

Part Number : 207W2XX-X-A15
Description : Feedthrough, Seal

Thermofit[®] Molded Parts

Specification Control Drawing

Limited Distribution

Part Number : 207W2XX-X-A15
Description : Feedthrough, Seal

COMPATABILITY CHART					
MATERIAL DASH NO.	MATERIAL DESCRIPTION	RT SPEC	COATING SLASH NO.	COATING S NO.	COATING DESCRIPTION
-100	Polyolefin, Semi-flexible ZEROHAL [™]	RT-1323	/184	S-1030	Adhesive

ORDERING INFORMATION

Base part number 207W2XX -X -A15 /XXX

Material dash number (See Compatability Chart) _____

Modification number _____

Adhesive slash number (If necessary, see Compatability Chart) _____

THIS DRAWING IS SUBJECT TO CHANGE WITHOUT NOTICE; CONSULT YOUR NEAREST FIELD REPRESENTATIVE FOR CURRENT REVISION

If this document is printed it becomes uncontrolled. Check for the latest revision.

Raychem

RAYCHEM CORPORATION
300 CONSTITUTION DRIVE
MENLO PARK, CALIFORNIA 94025

Revision : F
Date : 5/7/97

Part Number : 207W2XXX-X-A15
Description : Feedthrough, Seal

CAD FILE MP97097