

**SPECIFICATIONS:**

**MATERIALS:**

SHELL: NICKEL PLATED STEEL  
 INSULATOR: PA6T, UL94 V-0  
 PROCESS TEMP: 260°C  
 CONTACTS: GOLD PLATED BRASS (FLOATING CONTACTS)

**ELECTRICAL:**

RATED CURRENT: 5A  
 VOLTAGE: 500VAC FOR 1 MINUTE  
 INSULATION RESISTANCE: 1000 MOhms MIN.  
 CONTACT RESISTANCE: 15 mOhms MAX.

**ENVIRONMENT:**

OPERATING TEMPERATURE: -50°C TO +100°C

DIMENSIONS(mm)							
SIZE	A <sup>±.36</sup>	B <sup>±.10</sup>	C <sup>±.15</sup>	D <sup>±.15</sup>	E <sup>±.38</sup>	F <sup>±.25</sup>	G (REF)
9	30.80	24.99	16.30	8.00	19.20	12.60	10.75
15	39.15	33.32	24.60	8.00	27.70	12.60	10.75
25	53.04	47.04	38.40	8.00	41.10	12.60	10.75
37	69.32	63.50	54.80	8.00	57.30	12.60	10.75
50	66.93	61.11	52.30	10.80	55.10	15.20	13.30

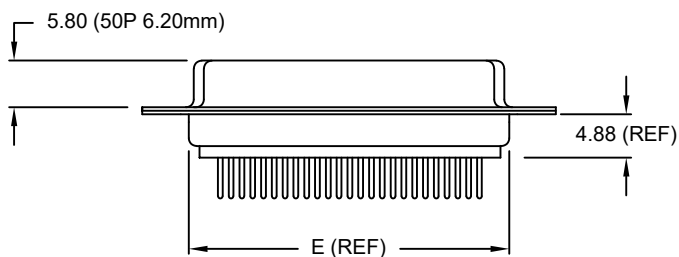
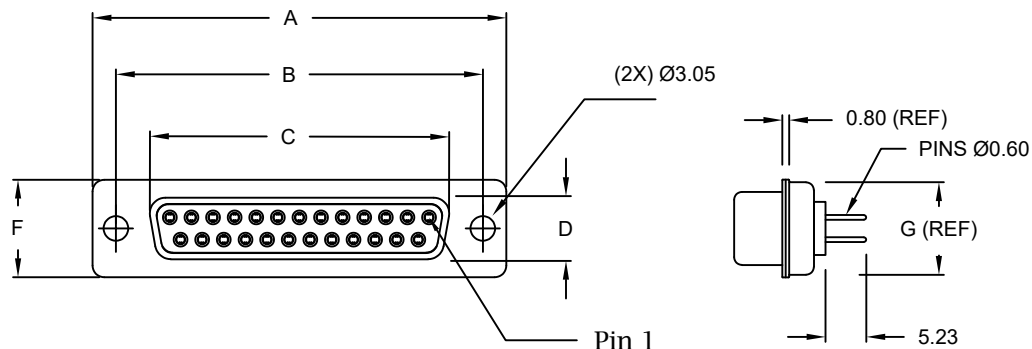

**172-YYY-213RYY1**

- SERIES \_\_\_\_\_
- POSITIONS \_\_\_\_\_
- 009 \_\_\_\_\_
- 015 \_\_\_\_\_
- 025 \_\_\_\_\_
- 037 \_\_\_\_\_
- 050 \_\_\_\_\_
- GENDER \_\_\_\_\_
- 2 = FEMALE \_\_\_\_\_
- TERMINATION \_\_\_\_\_
- 1 = DIP SOLDER \_\_\_\_\_
- SHELL PLATING \_\_\_\_\_
- 3 = NICKEL \_\_\_\_\_
- HARDWARE OPTIONS \_\_\_\_\_
- 00 = NO HARDWARE \_\_\_\_\_
- 01 = .098" NUT (PCB SIDE) \_\_\_\_\_
- 02 = .236" NUT (PCB SIDE) \_\_\_\_\_
- 03 = .236" NUT (MATING SIDE) \_\_\_\_\_
- 05 = .237" 4-40 BOARD LOCK \_\_\_\_\_
- 90 = .237" 4-40 BOARD LOCK \_\_\_\_\_
- FOR 0.093" BOARD MAX. \_\_\_\_\_
- 91 = .237" 4-40 SPACER/ BOARD LOCK \_\_\_\_\_
- 92 = .237" 4-40 SPACER/ BOARD LOCK \_\_\_\_\_
- FOR 0.093" BOARD MAX. \_\_\_\_\_
- PLATING OPTIONS \_\_\_\_\_
- 1 = GOLD FLASH \_\_\_\_\_
- 2 = 30MICRO-INCH GOLD \_\_\_\_\_

RoHS COMPLIANT

UNITS = mm

DO NOT SCALE FROM DRAWING



THESE DRAWINGS AND SPECIFICATIONS ARE THE PROPERTY OF NorComp AND SHALL NOT BE REPRODUCED, COPIED OR USED AS THE BASIS FOR THE MANUFACTURE OR SALE OF APPARATUS WITHOUT WRITTEN PERMISSION.

DRAWN:  
P. JENKINS

DATE:  
09/12/2005

NorComp

SCALE:  
NTS

SHEET OF  
1 3

REV  
24

DWG NO.

172-YYY-213RYY1

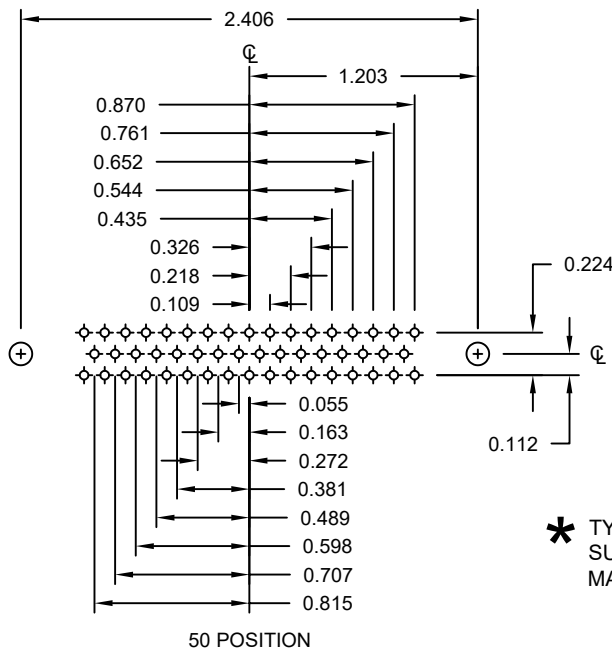
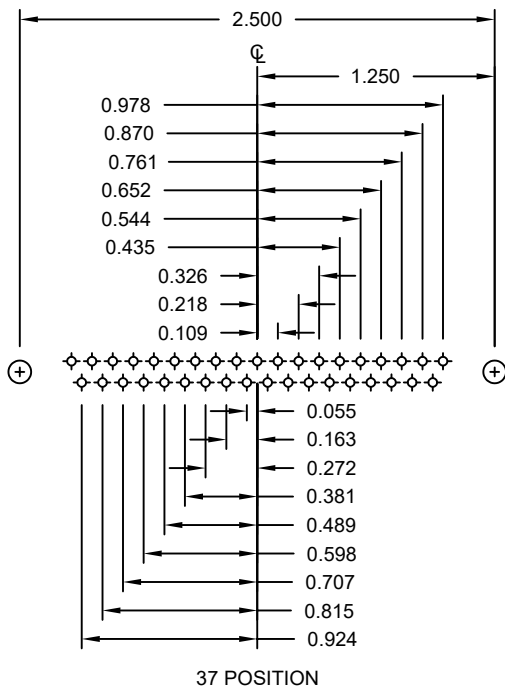
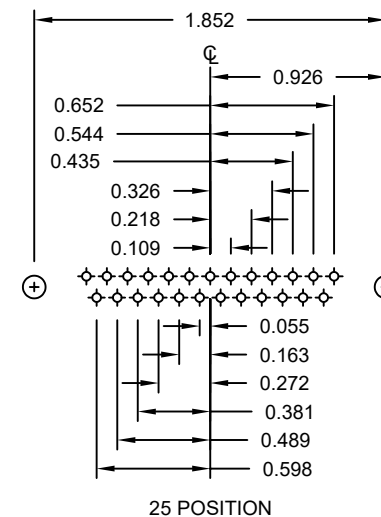
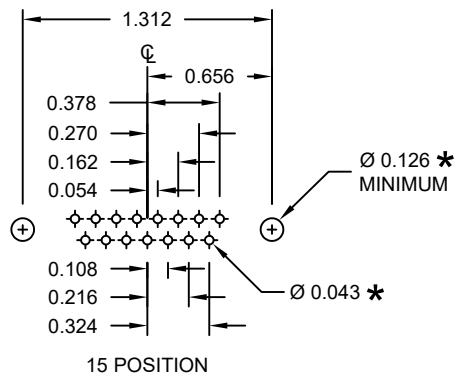
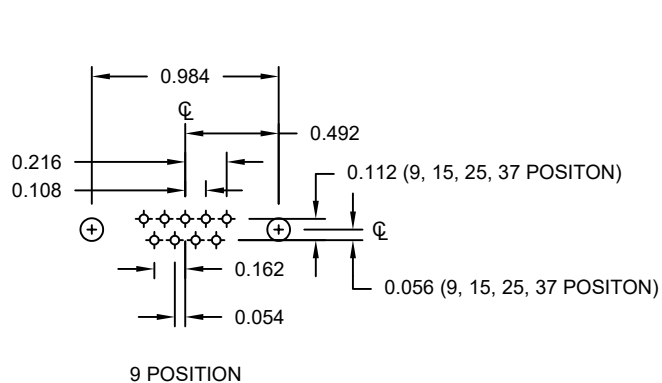

\* TYP.  
SUGGESTED SIZE  
MAY NOT BE SUITABLE FOR ALL APPLICATIONS

RoHS COMPLIANT

UNITS = inch

DO NOT SCALE FROM DRAWING



THESE DRAWINGS AND SPECIFICATIONS ARE THE PROPERTY OF NorComp AND SHALL NOT BE REPRODUCED, COPIED OR USED AS THE BASIS FOR THE MANUFACTURE OR SALE OF APPARATUS WITHOUT WRITTEN PERMISSION.

DRAWN:  
P. JENKINS

DATE:  
09/12/2005

NorComp

SCALE:  
NTS

SHEET OF  
2 3

REV  
24

DWG NO.

172-YYY-213RYY1

**TOLERANCE:**  
 ALL DIMENSIONS ARE ±0.010  
 UNLESS OTHERWISE  
 SPECIFIED

**ALL CLINCH-NUTS ARE 4-40 INTERNAL THREADS**

**\*\*NOTE: 90 & 92 OPTION FOR 0.093" MAX. BOARD THICKNESS**

"01" // PCB SIDE

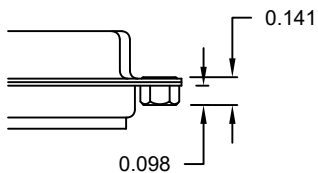

"02" // PCB SIDE

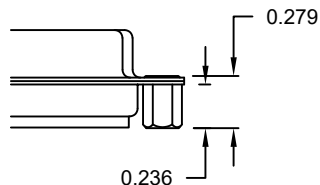

"03" // MATING SIDE

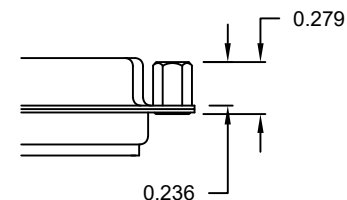

"05" // PCB SIDE

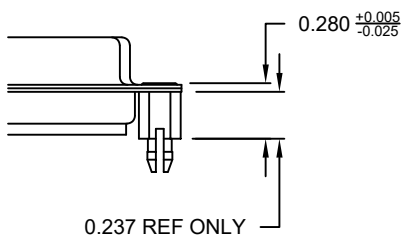

"91" // PCB SIDE

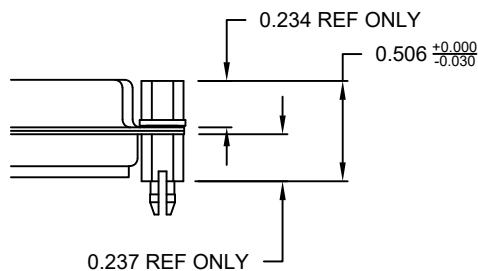

"90" // PCB SIDE \*\*

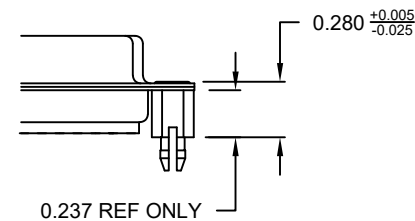

NOTE: 4-40 FEMALE SCREW LOCK IS REMOVABLE

"92" // PCB SIDE \*\*

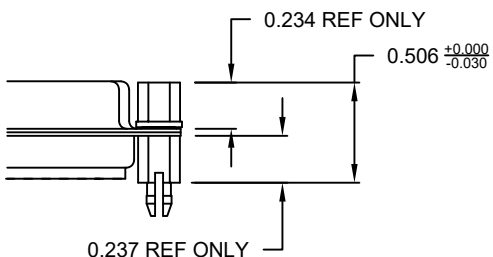

**50 in-oz  
 Max Torque**

UNITS = inch

**DO NOT SCALE FROM DRAWING**

**RoHS COMPLIANT**



THESE DRAWINGS AND SPECIFICATIONS ARE THE PROPERTY OF NorComp AND SHALL NOT BE REPRODUCED, COPIED OR USED AS THE BASIS FOR THE MANUFACTURE OR SALE OF APPARATUS WITHOUT WRITTEN PERMISSION.

DRAWN:  
**P. JENKINS**  
 DATE:  
**09/12/2005**

**NorComp**

SCALE: NTS	SHEET 3	OF 3	REV 24
DWG NO. <b>172-YYY-213RYY1</b>			