

Copyright FCI.  
FCI

spec ref	-	dr	NotFound DuWa	2010/04/28	projection	MM	size	A2	scale	3:1
tolerance std	ASME Y14.5	eng	De-Ming Lu	2014/12/28			ecn no	ELX-DG-19849-1		
TOLERANCES UNLESS OTHERWISE SPECIFIED		chr	-	rel level			Released			
surface	ASME Y14.5	appr	Pei-Ming Zheng	2014/12/29			product family	HCI	rel level	Released
linear	0.X ±0.5 0.XX ±0.25 0.XXX ±0.10	title	R/A HDR 14DC+24S+14DC HCI POWER CONNECTOR			dwg no	10084757			
angular	0° ±2°	www.fci.com	cat. no.	-	Product - Customer Drw	sheet 1 of 5	rev	B		

PDS: Rev :B

STATUS:Released

Printed: Dec 30, 2014

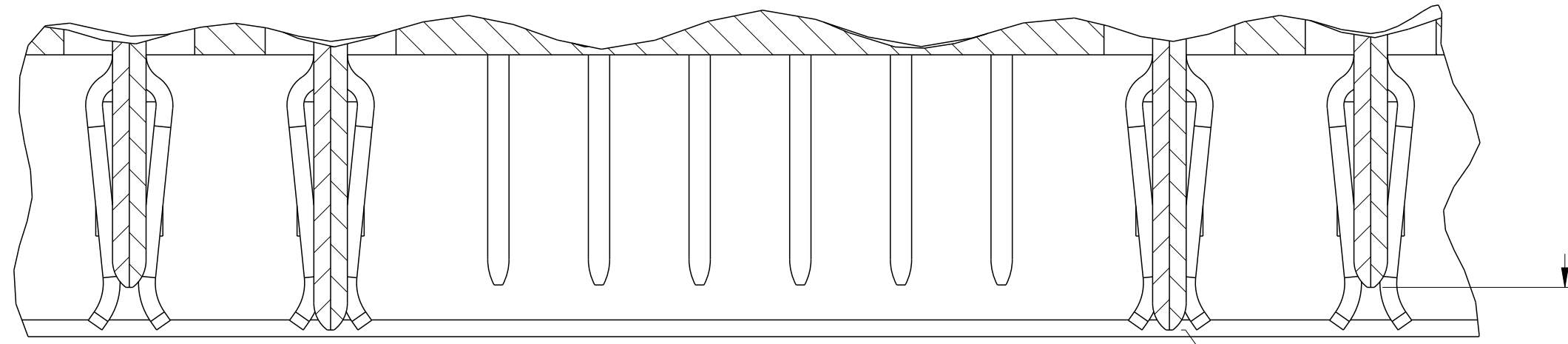

**DETAIL A**  
**SCALE 6:1**  
POWER MATING SEQUENCE

(1.27)  
SHORT/LONG  
MATING SEQUENCE

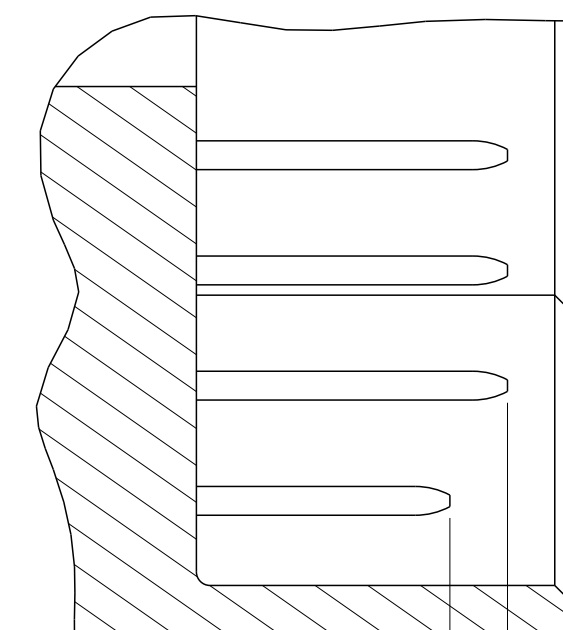

**SECTION W-W**  
**SCALE 6:1**  
SIGNAL MATING SEQUENCE

(1.27)

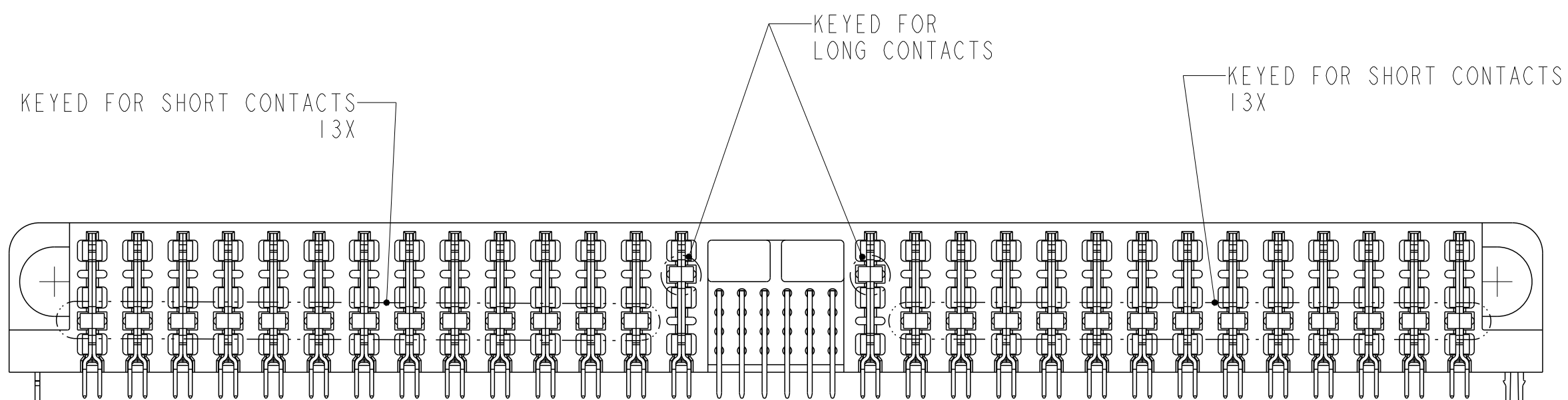

KEYED FOR SHORT CONTACTS  
13X

KEYED FOR  
LONG CONTACTS

KEYED FOR SHORT CONTACTS  
13X

**VIEW G-G**

dr	NotFound DuWa	2010/04/28	projection	MM	size	A2	scale	3:1
eng	De-Ming Lu	2014/12/28			ecn no	ELX-DG-19849-1		
chr	-	-			rel level	Released		
appr	Pei-Ming Zheng	2014/12/29	product family	HCI				
		title	R/A HDR 14DC+24S+14DC		dwg no	10084757		rev
www.fci.com		cat. no.	-		Product - Customer Drw	sheet 2 of 5		<b>B</b>

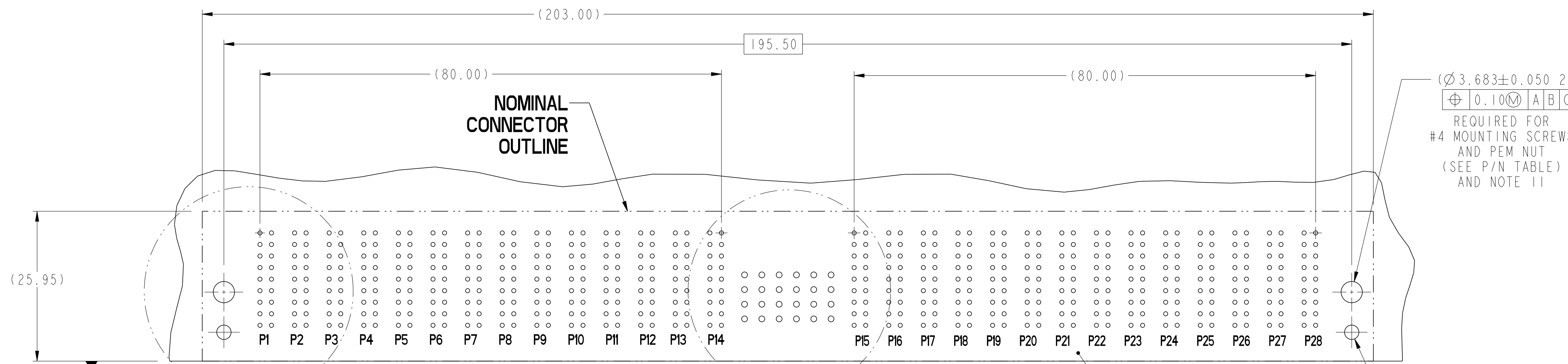

$(\varnothing 3.683 \pm 0.050 \text{ 2X})$   
 $\oplus 0.10 \text{ (M) A B C}$   
 REQUIRED FOR  
 #4 MOUNTING SCREWS  
 AND PEM NUT  
 (SEE P/N TABLE)  
 AND NOTE 11

$(\varnothing 2.49 \pm 0.08 \text{ 2X})$   
 $\oplus 0.10 \text{ (M) A B C}$   
 REQUIRED ONLY FOR  
 -003LF AND -004LF  
 (SEE P/N TABLE)  
 AND NOTE 11

### RECOMMENDED PCB LAYOUT COMPONENT SIDE

NOTE 6

SEE DETAIL D

SEE DETAIL E

-A-  
OPPOSITE SURFACE

$(\varnothing 0.80)$   
 $(\varnothing 0.65)$   
 $\oplus 0.10 \text{ (M) A B C}$   
 504X  
 (TABLE 1)

$(\varnothing 1.016 \pm 0.080)$   
 $\oplus 0.10 \text{ (M) A B C}$   
 24X  
 (TABLE 2)

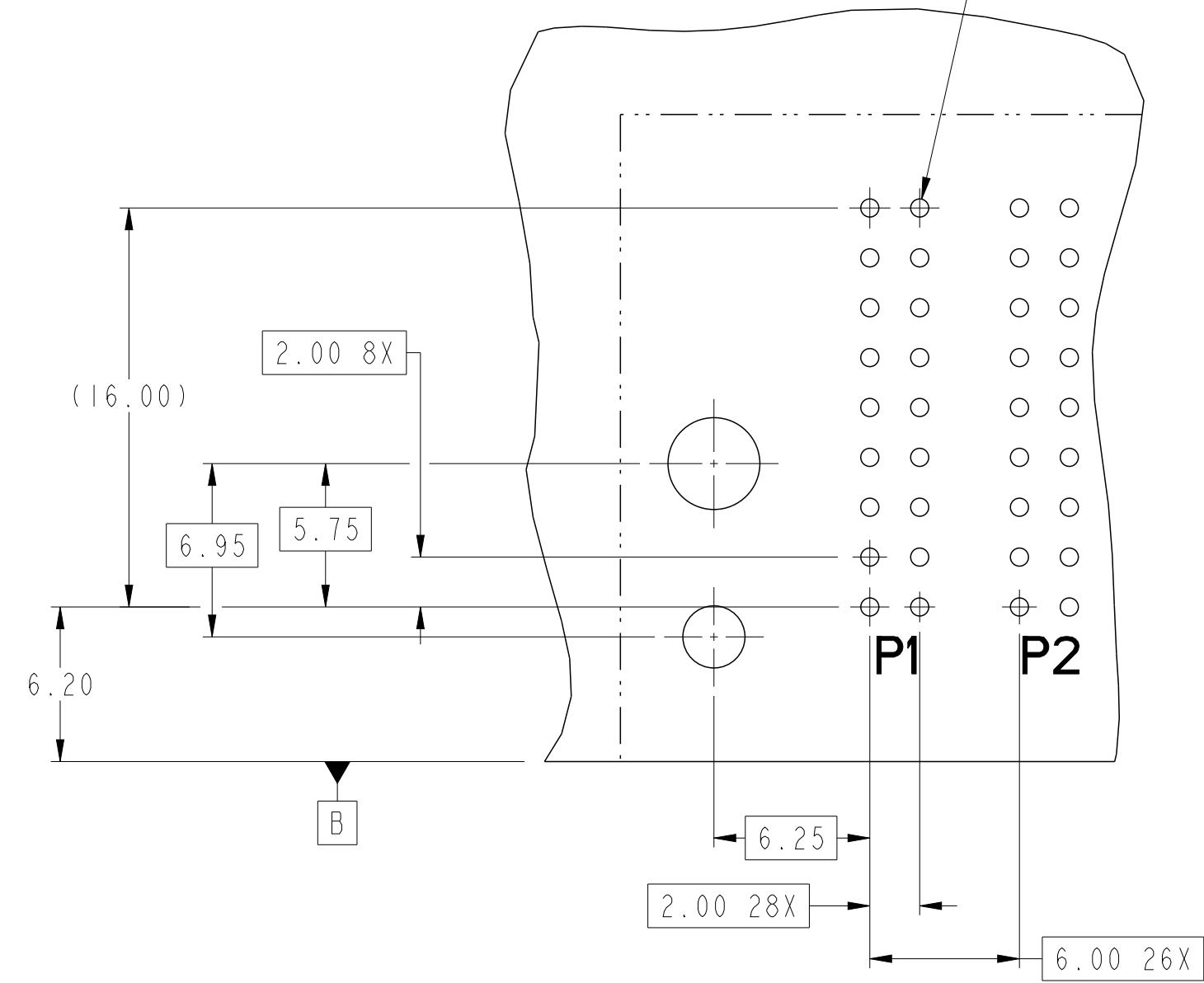

DETAIL D  
SCALE 4:1

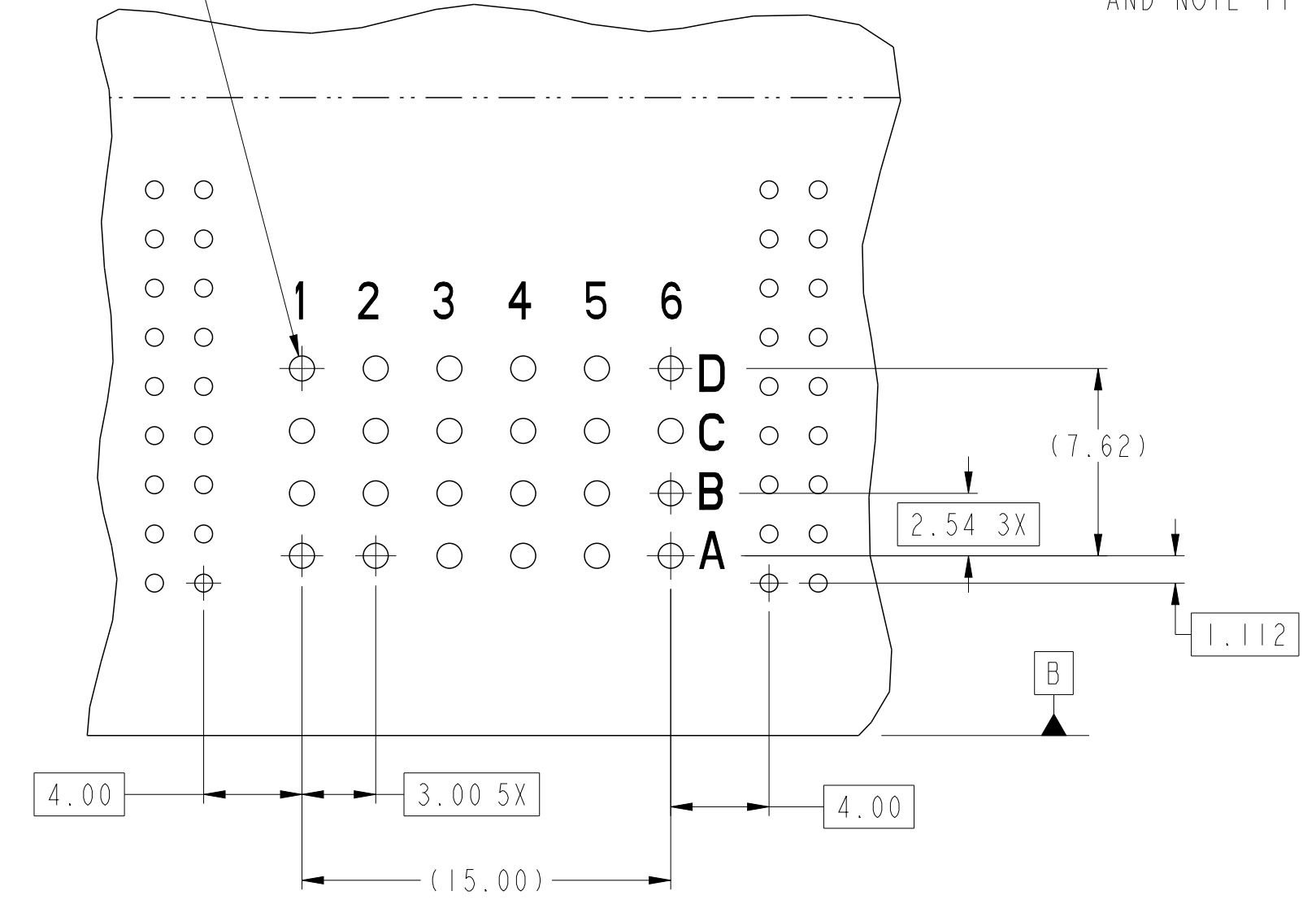

DETAIL E  
SCALE 4:1

dr	Not Found DuWa	2010/04/28	projection	MM	size	A2	scale	4:1
eng	De-Ming Lu	2014/12/28			ecn no	ELX-DG-19849-1	rel level	Released
chr	-	-						
appr	Pei-Ming Zheng	2014/12/29	product family	-	rel level	-	Blue	
		title R/A HDR 14DC+24S+14DC HCI POWER CONNECTOR			dwg no 10084757	rev B		
www.fci.com		cat. no.	Product - Customer Draw			sheet 3 of 5		

Copyright FCI. FCI

A  
B  
C  
D  
E  
F

A  
B  
C  
D  
E  
F

TOP LAYER DESCRIPTION	TABLE 1 (HCI POWER) PLATED THROUGH-HOLE REQUIREMENTS							
	DRILLED HOLE DIAMETER	COPPER THICKNESS	TIN-LEAD THICKNESS	NICKEL THICKNESS	GOLD THICKNESS	TIN THICKNESS	SILVER THICKNESS	FINISHED HOLE DIAMETER
TIN-LEAD	0.81-0.86 (0.85 DRILL)	0.025 - 0.050	0.005 - 0.015	--	--	--	--	0.65 - 0.80
IMMERSION TIN	0.81-0.86 (0.85 DRILL)	0.025 - 0.050	--	--	--	0.9 - 1.5um	--	0.70 - 0.80
IMMERSION SILVER	0.81-0.86 (0.85 DRILL)	0.025 - 0.050	--	--	--	--	0.15 - 0.65um	0.70 - 0.80
COPPER (SEE NOTE 9)	0.81-0.86 (0.85 DRILL)	0.025 - 0.050	--	--	--	--	--	0.70 - 0.80
GOLD	0.81-0.86 (0.85 DRILL)	0.025 - 0.050	--	0.003 - 0.007	FLASH UP TO 0.0002	--	--	0.69 - 0.80

TOP LAYER DESCRIPTION	TABLE 2 (HPC SIGNALS) PLATED THROUGH-HOLE REQUIREMENTS							
	DRILLED HOLE DIAMETER	COPPER THICKNESS	TIN-LEAD THICKNESS	NICKEL THICKNESS	GOLD THICKNESS	TIN THICKNESS	SILVER THICKNESS	FINISHED HOLE DIAMETER
TIN-LEAD	1.125-1.175 ( $\varnothing .0453 \pm .0010$ )	0.025-0.050	0.005-0.015	--	--	--	--	0.94 - 1.10 ( $\varnothing .040 \pm .003$ )
IMMERSION TIN			--	--	--	--	--	
IMMERSION SILVER			--	--	--	--	--	
COPPER (SEE NOTE 9)			--	--	--	--	--	
GOLD			--	--	--	--	--	



dr	NotFound DuWa	2010/04/28	projection		MM	size	A2	scale	4:1
eng	De-Ming Lu	2014/12/28	chr	-		ecn no	ELX-DG-19849-1		
appr	Pei-Ming Zheng	2014/12/29	product family	-	rel level	Released			
		title R/A HDR 14DC+24S+14DC HCI POWER CONNECTOR			dwg no 10084757		rev B		
www.fci.com		cat. no.		-		Product - Customer Drw		sheet 4 of 5	

PART NUMBER	RETENTION CLIPS	#4 SCREW	DIM A (TAIL LENGTH)	TAIL TYPE
10084757-001LF	NO	YES	3.43	SOLDER TAIL
10084757-002LF	NO	YES	4.70	SOLDER TAIL
10084757-003LF	YES	NO	3.43	SOLDER TAIL
10084757-004LF	YES	NO	4.70	SOLDER TAIL

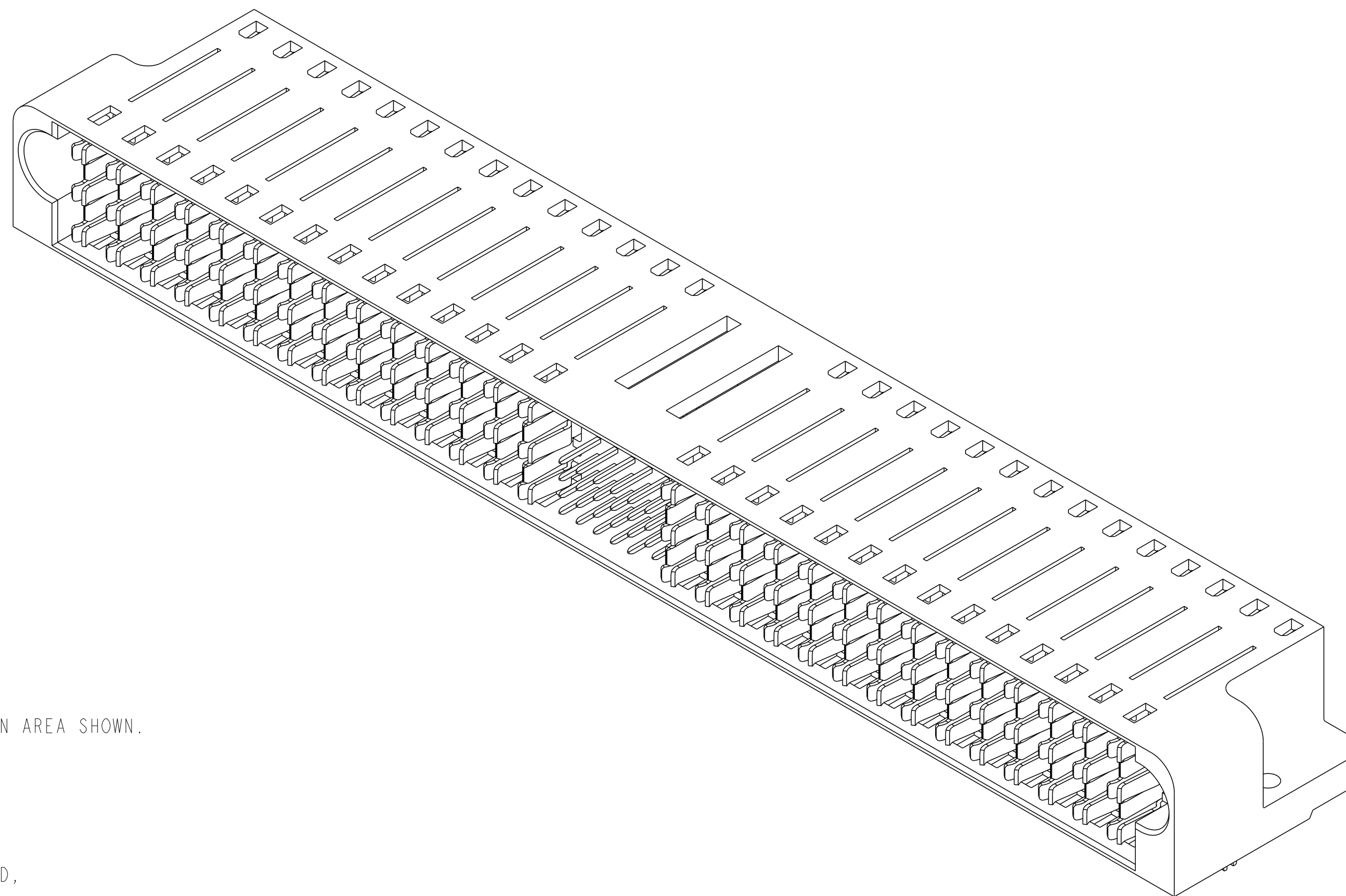

NOTES:

1. CONNECTOR MATERIALS:  
HOUSING: HIGH TEMPERATURE THERMOPLASTIC, BLACK  
UL 94V-0 COMPLIANT  
CONTACTS: HIGH PERFORMANCE COPPER ALLOY
2. CONTACT FINISH (ref GS-12-380 SECTION 5.2)
3. PRODUCT SPECIFICATION: GS-12-380.
4. APPLICATION SPECIFICATION: GS-20-070.
5. PRODUCT MARKING (PRODUCT NUMBER & DATE CODE) ON HOUSING IN AREA SHOWN.
6. MINIMUM NOMINAL PCB THICKNESS: 1.6mm
7. PACKAGING MEETS FCI SPECIFICATION GS-14-1073.
8. HOUSING COMPONENT WILL WITHSTAND EXPOSURE TO 260°C PEAK TEMPERATURE FOR 60 SECONDS IN A CONVECTION, INFRA-RED, OR VAPOR PHASE REFLOW OVEN.
9. COPPER PLATING THICKNESS IN CENTER OF VIA-HOLE CAN BE NO MORE THAN 0.003 LESS THAN OTHER AREAS.
10. ALL HOLE SIZES ARE FINISHED HOLE SIZES.
11. MOUNTING HOLES ARE UNPLATED.

dr	NotFound DuWa	2010/04/28	projection	MM	size	A2	scale	3:1
eng	De-Ming Lu	2014/12/28			ecn no	ELX-DG-19849-1		
chr	-	-			rel level	Released		
appr	Pei-Ming Zheng	2014/12/29	product family	HCI	rel level	Released		
		title	R/A HDR 14DC+24S+14DC		dwg no	10084757		rev
www.fci.com		cat. no.	-		Product - Customer Drw	sheet 5 of 5		B