

PRODUCT NUMBER  
10135177-XXXXXLF

- NOTE:
- MATERIAL SPECIFICATION:
    - INSULATION: HIGH TEMP. THERMOPLASTIC, UL 94V-0.
    - CONTACT: COPPER ALLOY
    - NAIL: COPPER ALLOY
  - FINISH SPECIFICATION:
    - CONTACT: Ni UNDERPLATE. SEE P/N FOR PLATING ON CONTACT AREA AND TAILS.
    - NAIL: TIN PLATE OVER Ni UNDERPLATE.
  - RoHS & HF COMPLIANCE
  - PART NO SCHEME:  
10135177- XX X X X LF
- No. OF POS.: 02~15
- HSG COLOR: 1: NATURAL
- PLATING: 1: TIN
- PACKAGE: 1: TAPE AND REEL
- THE CONNECTOR MATES WITH FCI WIRE CONNECTOR, HSG 10135175 AND CRIMPED TERMINAL 10135176
  - THE HOUSING WILL WITHSTAND EXPOSURE TO 260°C PEAK TEMPERATURE 10 SEC. IN A CONVECTION REFLOW OVEN.
  - PRODUCT SPECIFICATION: GS-12-1321
  - PACKAGE SPECIFICATION: GS-14-2471
  - DIMENSIONAL TABLE:

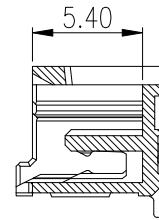

SECTION A-A

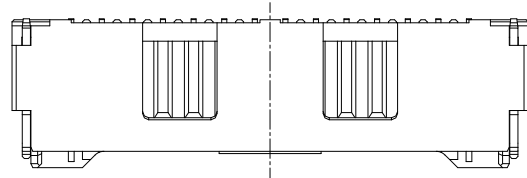
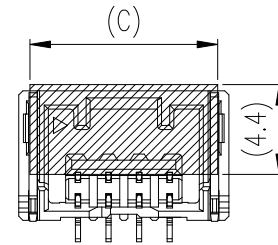
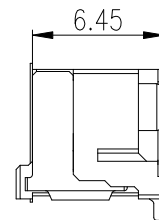

MYLAR FIGURE OF 2P~6P CIRCUIT

Pos.	A	B	C	D
02	7.30	—	6.10	5.5
03	8.80	3.00	7.60	7.0
04	10.30	4.50	9.10	8.5
05	11.80	6.00	10.60	10.0
06	13.30	7.50	12.10	11.5
07	14.80	9.00	5.00	13.0
08	16.30	10.50	5.00	14.5
09	17.80	12.00	5.00	16.0
10	19.30	13.50	5.00	17.5
11	20.80	15.00	5.00	19.0
12	22.30	16.50	5.00	20.5
13	23.80	18.00	5.00	22.0
14	25.30	19.50	5.00	23.5
15	26.80	21.00	5.00	25.0

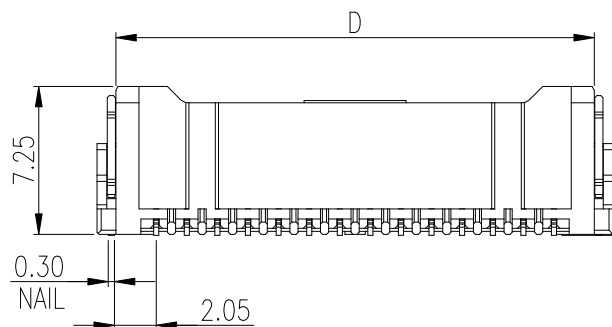
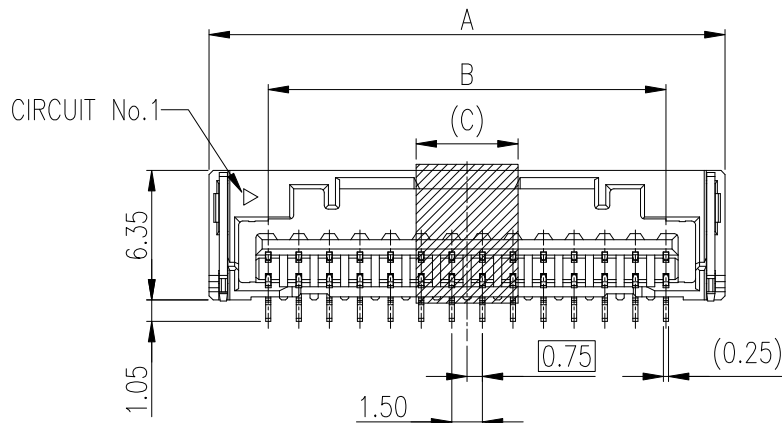

0.10  
CONTACT & NAIL

mat'l. code		surface		tolerance	projection	product family	
ltr		ecn no	dr	date	tolerances unless otherwise specified		MINITEK 1.5mm WTB
A			TAI	2015-06-16	angles	X.X±0.3	title
					±2'	X.XX±0.20	MINITEK 1.5mm, RECEPTACLE
					linear	X.XXX±0.100	CONNECTOR, VERTICAL MOUNT, SMT
					dr	KENNY TAI	2015-05-08
					enr	KENNY TAI	2015-05-08
					chr	KENNY TAI	2015-06-10
					appd	PM ZHENG	2015-06-16
sheet index	revision sheet	A	A	1	2	FCI	
						dwg no	
						sheet 1 of 2	
						size	
						10135177	
						type	
						CUSTOMER Drawing	

PRODUCT NUMBER  
10135177-XXXXXLF

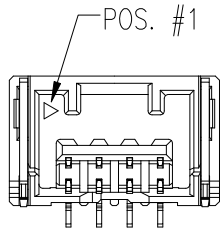

CASE OF 2~5 POSITIONS

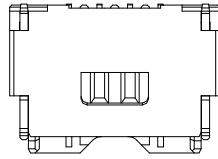

CASE OF 2~5 POSITIONS

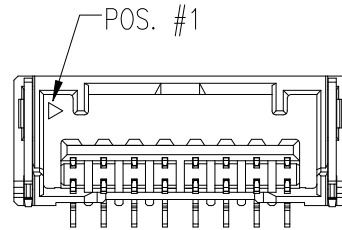
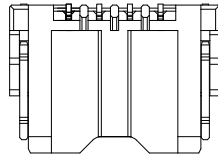

CASE OF 6~11 POSITIONS

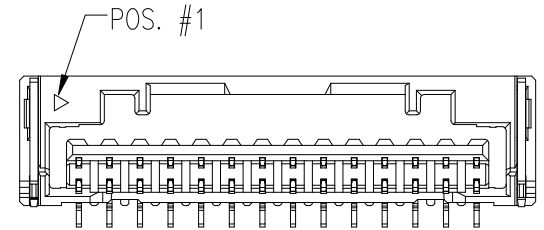

CASE OF 12~15 POSITIONS

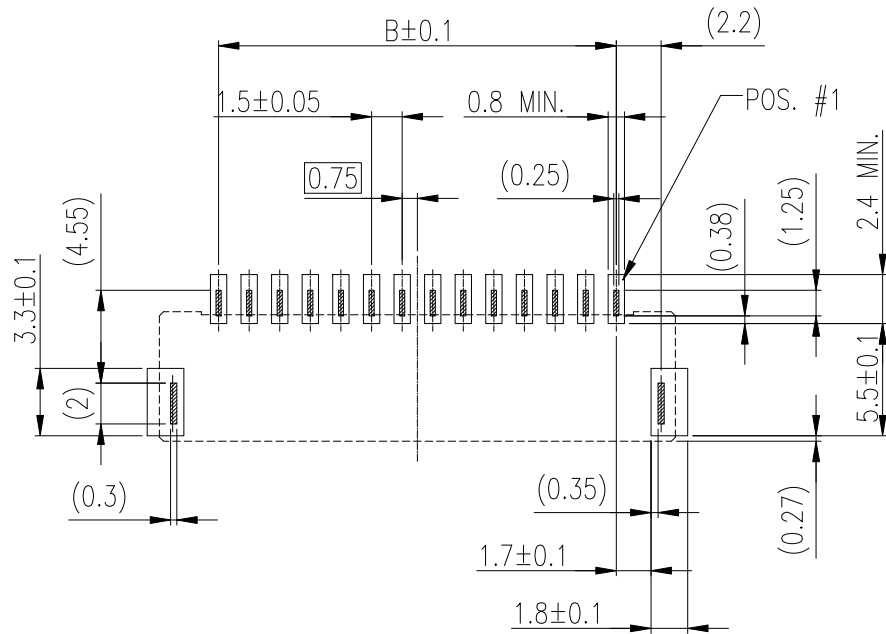

RECOMMENDED P.C.B BOARD LAYOUT  
GENERAL TOLERANCE  $\pm 0.05$

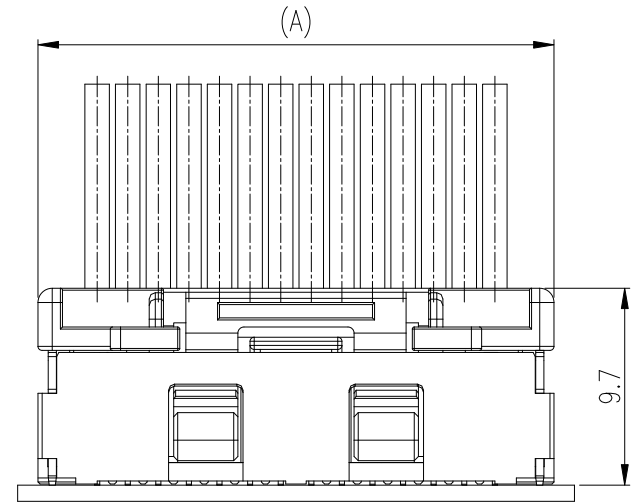
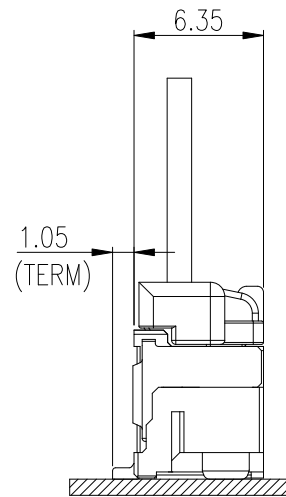

MATED CONNECTORS

mat'l. code		surface		tolerance	projection	product family	
ltr		ecn	no	dr	date	MINITEK 1.5mm WTB	
angles		linear		X.X $\pm$ 0.3	mm	title	
$\pm 2^\circ$		linear		X.XX $\pm$ 0.20		MINITEK 1.5mm, RECEPTACLE	
dr		KENNY TAI		2015-05-08	scale		CONNECTION, VERTICAL MOUNT, SMT
enr		KENNY TAI		2015-05-08	FCI		dwg no
chr		KENNY TAI		2015-06-10	sheet 2 of 2		size
appd		PM ZHENG		2015-06-16	10135177		A4
sheet index		revision	A	A	type		CUSTOMER Drawing
sheet		1	2				