

**TECHNICAL:**  
LISTED: UL AND cUL  
RATED SUPPLY VOLTAGE: 120 VAC  
RATED CURRENT: UP TO 15 AMPS OR CABLE RATING  
RESET TYPE: AUTOMATIC OR MANUAL  
OPERATING FREQUENCY: 60 Hz  
TYPE: CLASS A  
GROUND TRIP CURRENT: 4-6 mA  
OVERLOAD CURRENT: 90 AMP 125 VAC  
INSULATION VOLTAGE: 1,500 VRMS - 1 MINUTE  
ENDURANCE OPERATIONS: 3000 OPERATIONS

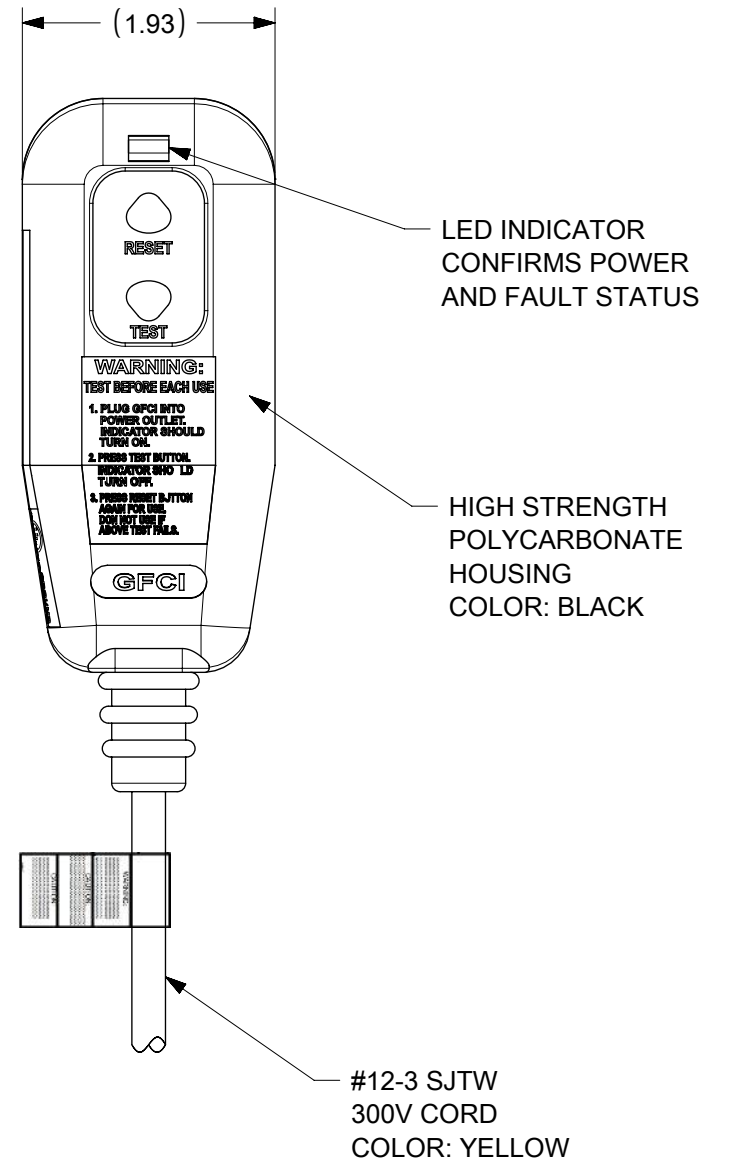
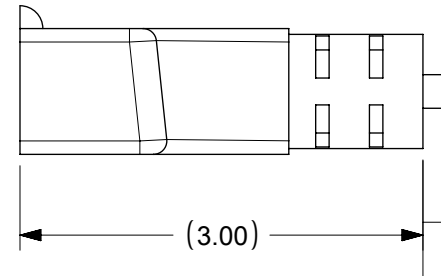
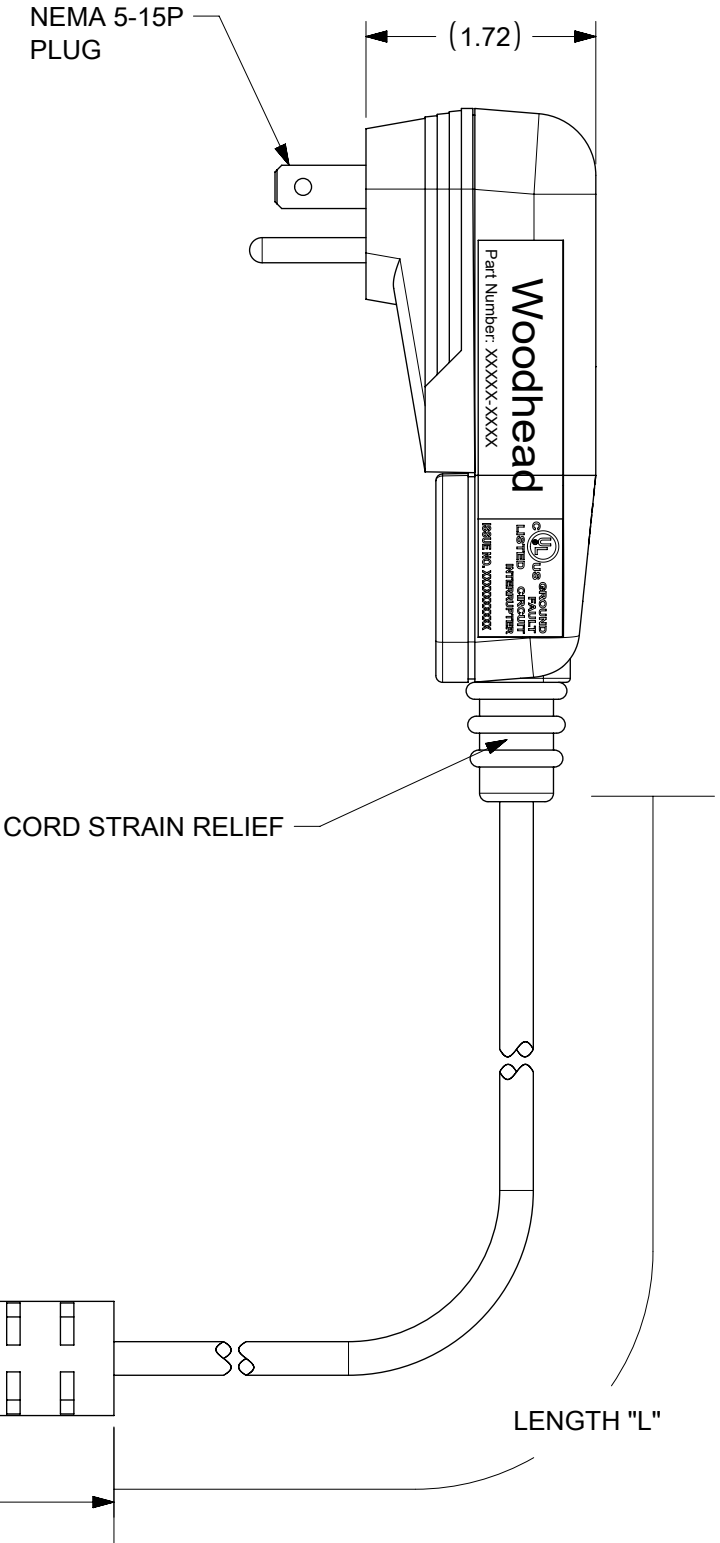

MATERIAL NO.	ENGINEERING NO.	LENGTH "L"	POWER-UP
1301530093	15054-1TTA	2 FT ± 1 IN	AUTO
1301530097	15054-25TTA	25 FT ± 2 IN	AUTO
1301530094	15054-1TTM	2 FT ± 1 IN	MANUAL
1301530098	15054-25TTM	25 FT ± 2 IN	MANUAL

THIS DRAWING CONTAINS INFORMATION THAT IS PROPRIETARY TO MOLEX ELECTRONIC TECHNOLOGIES, LLC AND SHOULD NOT BE USED WITHOUT WRITTEN PERMISSION											
FUNCTIONAL SYMBOLS		DIMENSION UNITS		SCALE		CURRENT REV DESC: MIGRATION TO ECTR/NX					
INCH		NTS		<p>EC NO: 683960 DRWN: VBASUTHKARP 2021/10/27 CHKD: DNGUYEN62 2021/11/15 APPR: HKNEELAND 2022/01/21</p> <p>INITIAL REVISION: DRWN: MC 2005/12/06 APPR:</p>							
GENERAL TOLERANCES (UNLESS SPECIFIED)											
ANGULAR TOL ± °											
4 PLACES ±											
DIVISIONAL SYMBOLS		3 PLACES ±		2 PLACES ±		1 PLACE ±		0 PLACES ±		DRAFT WHERE APPLICABLE MUST REMAIN WITHIN DIMENSIONS	
THIRD ANGLE PROJECTION				DRAWING		SERIES		MATERIAL NUMBER		CUSTOMER	
B-SIZE				130153		SEE TABLE		GENERAL MARKET		SHEET NUMBER 1 OF 1	

**molex**

120V 15A PLUG GFCI  
W/ MOLDED TRIPLE TAP NEMA 5-15

PRODUCT CUSTOMER DRAWING

DOCUMENT NUMBER: SD-130153-018  
DOC TYPE: PSD  
DOC PART: 001  
REVISION: A1