

PRODUCT DATA DRAWING

R & D DEVELOPED PRODUCT	HFSS & DCN CONTROLLED DOCUMENT	DWG. NO. SF3375-6001
		ROHS COMPLIANT

MATERIAL:

BODY, INSERT & SLEEVE: STAINLESS STEEL PER AMS-5640, UNS S30300, TYPE I

CONTACT: BERYLLIUM COPPER PER ASTM-B-196, ALLOY C17300, COND.

DIELECTRIC BEAD: KEL-F PER MILP-46036B, TYPE II

FINISH:

BODY, INSERT & SLEEVE: PASSIVATED PER QQ-P-35, TYPE II

CONTACT: GOLD PER MIL-G-45204, TYPE I, GRADE C, CLASS 00; OVER NICKEL PER QQ-N-290, CLASS 1

PERFORMANCE:

IMPEDANCE: 50 OHMS ±2 OHMS

FREQ. RANGE: DC TO 67.0 GHz

VSWR: DC TO 40 GHz = 20 dB MAX.
40 TO 67 GHz = 17 dB MAX.

TEMP RATING: -55°C TO +150°C

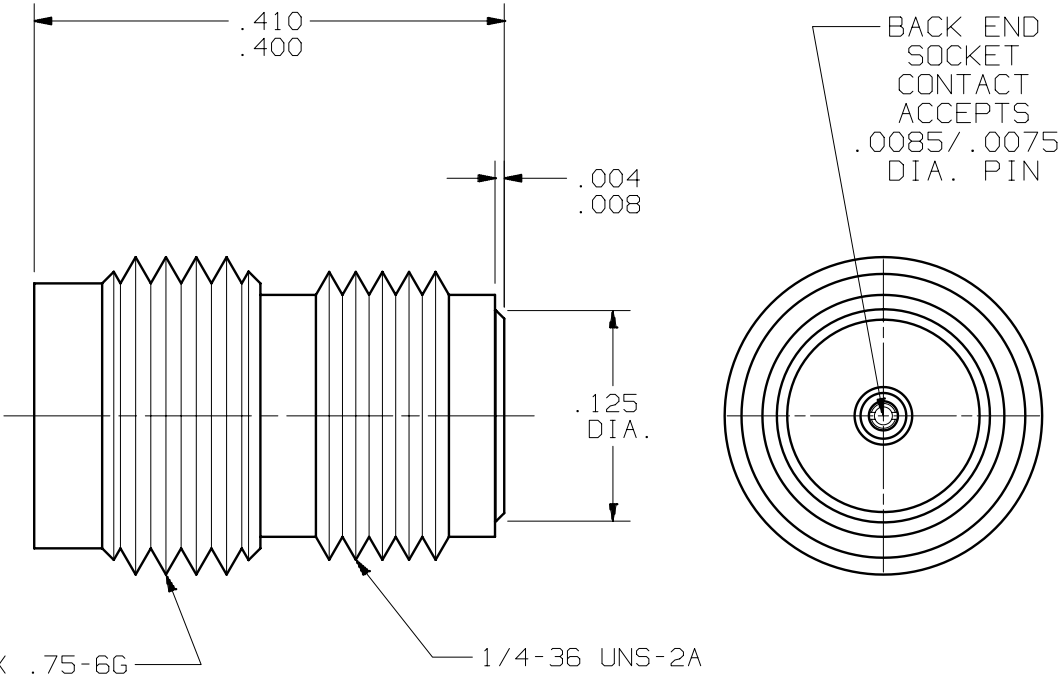

SYM.	DESCRIPTION	DATE	APPR.	UNLESS OTHERWISE SPECIFIED: 1) ALL DIMENSIONS ARE AFTER PLATING. 2) BREAK CORNERS & EDGES .005 R. MAX. 3) CHAM. 1st & LAST THDS. 4) SURFACE ROUGHNESS 63 / MIL-STD-10. 5) DIAS. ON COMMON CENTERS TO BE CONCENTRIC WITHIN .005 T.I.R. 6) REMOVE ALL BURRS.	DIMENSIONS ARE IN INCHES TOLERANCES:			SV Microwave, Inc. 2400 Centrepark West Drive, Suite 100 West Palm Beach, FL 33409
-	REL. NRN 28975	10/02	JM		DECIMALS .XX ±.030 .XXX ±.001 .XXXX ±.0006	FRACTIONAL ±1/64	ANGULAR X° ±1°0' X°X' ±15'	
A	DCN 38837	02/12	STW		MATERIAL: SEE ABOVE		□" AREA: N/A	DWG. NO. SF3375-6001
				DESIGNED: DWC 10/02/02	FINISH: SEE ABOVE			
				HFSS CHK: SVG 10/02/02	SIZE: A	CAGE NO. 95077	SCALE: N/A	
				MECH CHK: DWC 10/02/02				