

# CAPTIVE PANEL SCREWS

MATERIAL: Stainless Steel per ASTM-A581/A-582

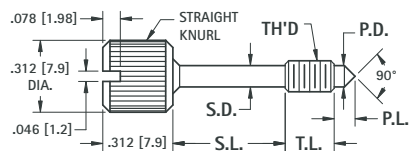
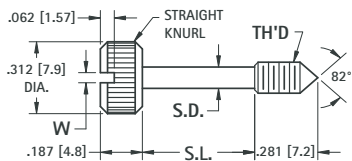

CAT. NO.	THREAD	S.D. ± .005 (.13)	S.L. ± .010 (.25)	W + .015 (+.38) - .000
8700	4-40	.078 (2.0)	.375 (9.5)	.036 (.091)
8701	4-40	.078 (2.0)	.500 (12.7)	.036 (.091)
8702	4-40	.078 (2.0)	.625 (15.9)	.036 (.091)
8703	6-32	.095 (2.41)	.375 (9.5)	.045 (1.14)
8704	6-32	.095 (2.41)	.500 (12.7)	.045 (1.14)
8705	6-32	.095 (2.41)	.625 (15.9)	.045 (1.14)

CAT. NO.	THREAD	T.L. ± .015 (.38)	S.D. ± .005 (.13)	S.L. ± .010 (.25)	P.D. +0.00, -.016 (-.40)	P.L. ± .015 (.38)
8706	4-40	.125 (3.2)	.078 (2.0)	.171 (4.3)	.078 (2.0)	.078 (2.0)
8707	4-40	.125 (3.2)	.078 (2.0)	.296 (7.5)	.078 (2.0)	.078 (2.0)
8708	4-40	.125 (3.2)	.078 (2.0)	.421 (10.7)	.078 (2.0)	.078 (2.0)
8709	6-32	.218 (5.5)	.095 (2.41)	.187 (4.7)	.095 (2.41)	.093 (2.36)
8710	6-32	.218 (5.5)	.095 (2.41)	.312 (7.9)	.095 (2.41)	.093 (2.36)
8711	6-32	.218 (5.5)	.095 (2.41)	.437 (11.1)	.095 (2.41)	.093 (2.36)

## 4-40

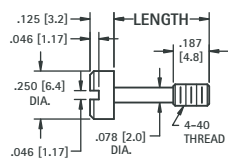

CAT. NO.	LENGTH
2413	.469 (11.9)
2414	.531 (13.4)

## 6-32

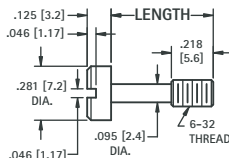

CAT. NO.	LENGTH
2415	.531 (13.5)
2416	.593 (15.1)
2417	.656 (16.7)

## 8-32

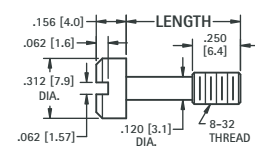
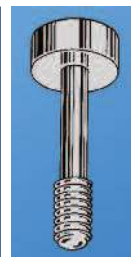

CAT. NO.	LENGTH
2418	.656 (16.7)
2419	.718 (18.2)
2420	.781 (19.8)

# THUMB SCREWS

## STAINLESS

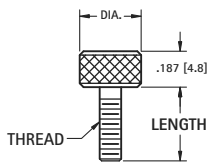

MATERIAL: Stainless Steel

CAT. NO.	LENGTH	THREAD	DIA
2400	.312 (7.9)	4-40	.312 (7.9)
2401	.375 (9.5)		
2402	.437 (11.1)		
2403	.500 (12.7)		
2404	.312 (7.9)	6-32	.312 (7.9)
2405	.375 (9.5)		
2406	.437 (11.1)		
2407	.500 (12.7)		
2408	.375 (9.5)	8-32	.375 (9.5)
2409	.437 (11.1)		
2410	.500 (12.7)		

## BRASS

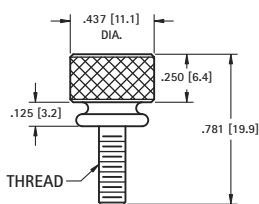

MATERIAL: Brass, Nickel Plate

CAT. NO.	THREAD
1708	6-32
1709	8-32
1710	10-32

## NYLON

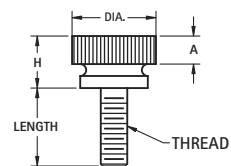

MATERIAL: Nylon 6/6, UL Rated 94V-2

CAT. NO.	LENGTH	THREAD	DIA.	H	A
2500	.250 (6.4)	4-40	.300 (7.6)	.280 (7.1)	.125 (3.2)
2501	.375 (9.5)				
2502	.500 (12.7)				
2503	.250 (6.4)	6-32	.360 (9.1)	.275 (7.0)	.125 (3.2)
2504	.375 (9.5)				
2505	.500 (12.7)				
2506	.250 (6.4)	8-32	.425 (10.8)	.305 (7.7)	.140 (3.6)
2507	.375 (9.5)				
2508	.500 (12.7)				