

- NOTES:
1. MATERIAL:
SHIELD: DEEP DRAW STEEL;
HOUSING: LCP, UL94V-0, NATURAL (WHITE);
CONTACT: COPPER ALLOY.
 2. PLATING: SEE SHEET 2.
 3. PRODUCT CONFORMS TO MOLEX PRODUCT SPECIFICATION NUMBER PS-74320-001.
 4. SEE SHEET 2 FOR RECOMMENDED PANEL CUT-OUT AND P.C.B. LAYOUT.
 5. PARTS WILL BE PACKAGED IN TRAYS PER PK-74320-010.
 6. PRODUCT CONFORMS TO DDWG DVI SPECIFICATION. REFER TO THIS SPECIFICATION FOR CONNECTOR MATING DIMENSIONS.
 7. RECOMMENDED MOUNTING HARDWARE IS MOLEX P/N 71781-0001 OR 82007-0300 OR 88780-6066. REFER TO PRODUCT SPECIFICATION NUMBER PS-74320-001 FOR THIS APPLICATION TORQUE REQUIREMENT FOR ASSMBLING MOUNTING HARDWARE.

74320-5005	2	.050/1.27	.080/2.03
74320-5004	2	.092/2.34	.080/2.03
74320-5001	1	.050/1.27	.080/2.03
PART NUMBER	PLATING OPTION	DIM A	DIM B

THIS DRAWING CONTAINS INFORMATION THAT IS PROPRIETARY TO MOLEX ELECTRONIC TECHNOLOGIES, LLC AND SHOULD NOT BE USED WITHOUT WRITTEN PERMISSION

DIMENSION UNITS INCH	SCALE 1:1	CURRENT REV DESC:	molex		
GENERAL TOLERANCES (UNLESS SPECIFIED)		EC NO: 620398			
ANGULAR TOL ± 1.0 °	4 PLACES ± 0.01	DRWN: AKUMAR19 2019/01/09	PRODUCT CUSTOMER DRAWING		
3 PLACES ± 0.01	2 PLACES ± 0.01	CHK'D: GGA 2019/10/18	DOCUMENT NUMBER		
1 PLACE ±	0 PLACES ±	APPR: GGA 2019/10/18	SD-74320-004		
DRAFT WHERE APPLICABLE MUST REMAIN WITHIN DIMENSIONS		INITIAL REVISION:	DOC TYPE	DOC PART	REVISION
THIRD ANGLE PROJECTION		DRWN: XQZHANG 2014/12/10	PSD	000	H
DRAWING		APPR: AYIN 2014/12/10	SHEET NUMBER		
A3-SIZE		SERIES	1 OF 2		
74320		MATERIAL NUMBER	SEE TABLE		
CUSTOMER		GENERAL MARKET			

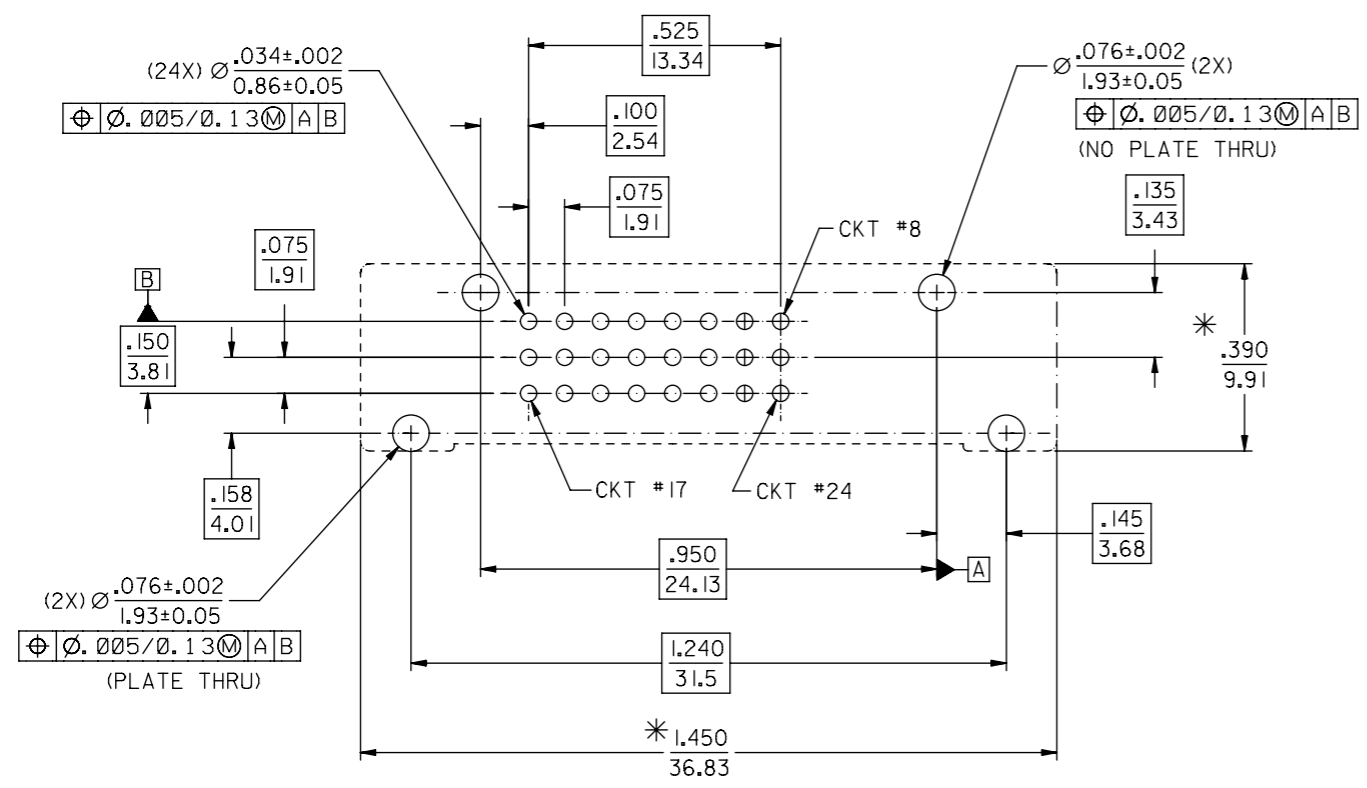

RECOMMENDED PCB LAYOUT

* THESE DIMENSIONS REPRESENT CONNECTOR OVERLAY ON PCB.

PLATING OPTIONS:
 PLATING OPTION #1:
 OUT SHIELD -- 60u"/(1.5um) MIN. SOLDERABLE NICKEL OVER
 30u"/(0.75um) MIN. COPPER OVERALL.
 .075"/(1.91mm) CONTACTS -- 30u"/(0.75um) MIN. SELECT GOLD AND
 100u"/(2.50um) MIN. SELECT PURE TIN
 OVER 50u"/(1.27um) MIN. NICKEL OVERALL.

PLATING OPTION #2:
 OUT SHIELD -- 60u"/(1.5um) MIN. SOLDERABLE NICKEL OVER
 30u"/(0.75um) MIN. COPPER OVERALL.
 .075"/(1.91mm) CONTACTS -- SELECT GOLD FLASH AND
 100u"/(2.50um) MIN. SELECT PURE TIN
 OVER 50u"/(1.27um) MIN. NICKEL OVERALL.

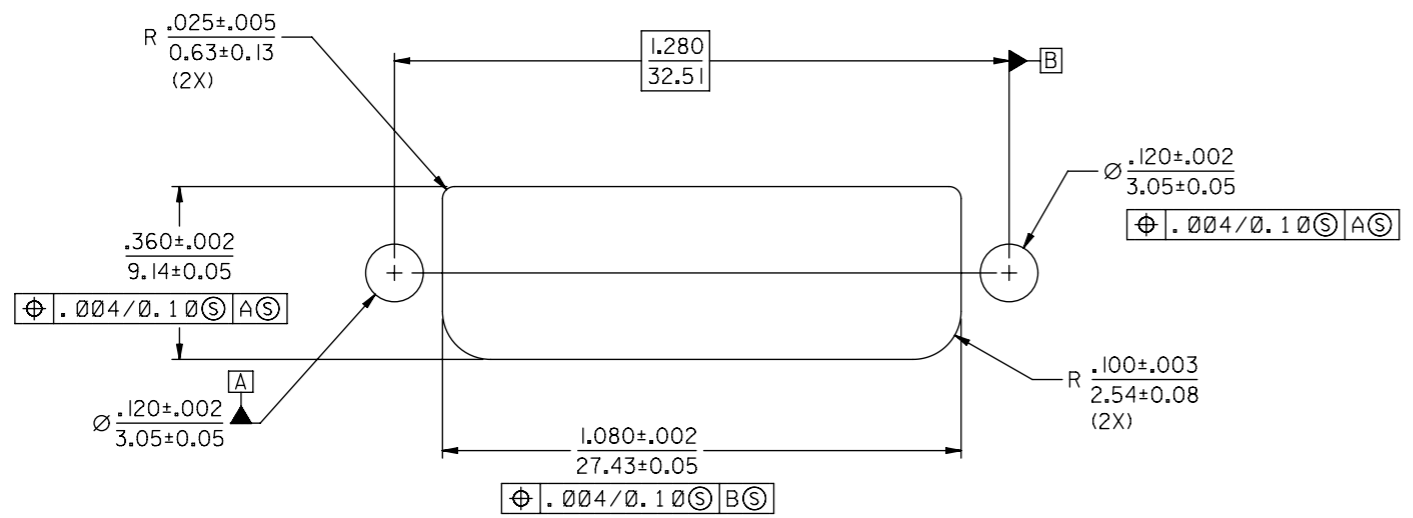

RECOMMENDED PANEL CUT-OUT
 PANEL THICKNESS: .030/0.76-.040/1.02

THIS DRAWING CONTAINS INFORMATION THAT IS PROPRIETARY TO MOLEX ELECTRONIC TECHNOLOGIES, LLC AND SHOULD NOT BE USED WITHOUT WRITTEN PERMISSION									
DIMENSION UNITS INCH		SCALE 1:1		CURRENT REV DESC:				molex	
GENERAL TOLERANCES (UNLESS SPECIFIED)				EC NO: 620398					
ANGULAR TOL ± 1.0°		4 PLACES ± 0.01		DRWN: AKUMAR19		2019/01/09		DVI-DIGITAL VERTICAL RECEPTACLE CONNECTOR	
3 PLACES ± 0.01		2 PLACES ± 0.01		CHK'D: GGA		2019/10/18		PRODUCT CUSTOMER DRAWING	
1 PLACE ±		0 PLACES ±		APPR: GGA		2019/10/18		INITIAL REVISION:	
DRAFT WHERE APPLICABLE MUST REMAIN WITHIN DIMENSIONS		THIRD ANGLE PROJECTION		DRWN: XQZHANG		2014/12/10		DOCUMENT NUMBER	
DRAWING		SERIES		APPR: AYIN		2014/12/10		SD-74320-004	
A3-SIZE		74320		MATERIAL NUMBER		CUSTOMER		DOC TYPE DOC PART REVISION	
SEE TABLE		GENERAL MARKET		SHEET NUMBER		2 OF 2		PSD 000 H	