

Electrical Testing
per Tusonix standard
test plans and Mil-Std-202
Test Methods.

MARKETING SALES DRAWING
DIMENSIONS IN INCHES - DO NOT SCALE THIS DRAWING
DIMENSIONS IN METRIC - []

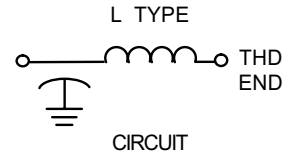
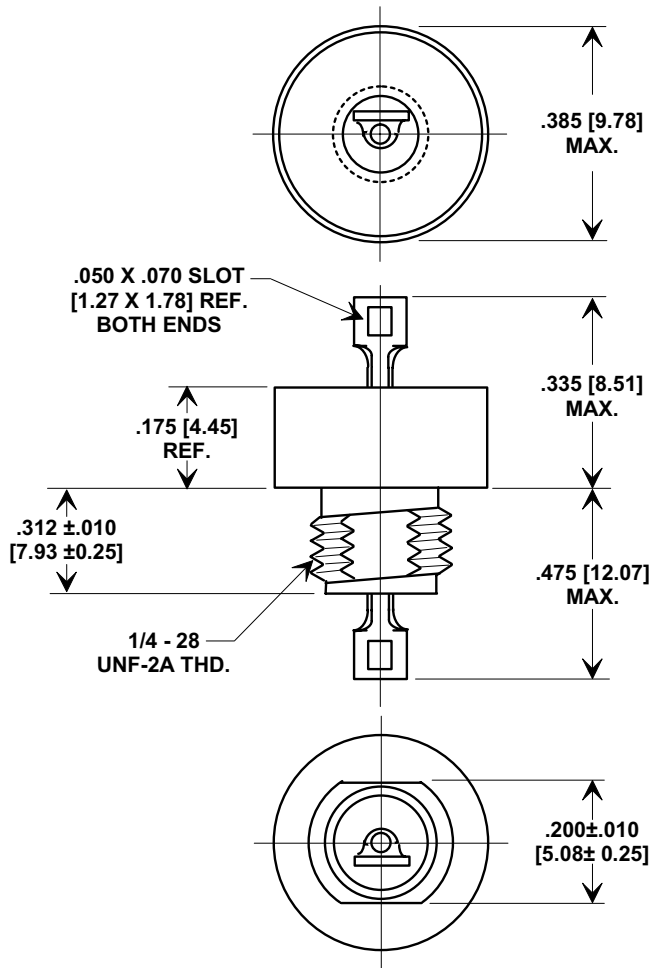
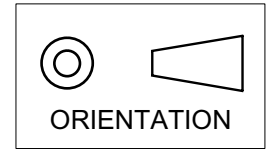

NOTES:

MATERIALS:

- BUSHING - TIN PLATED STEEL**
- LEAD - SOLDER PLATED COPPER**
- NUT - TIN PLATED BRASS**
- L"WASHER - TIN PLATED PHOSPHOR BRONZE**

MOUNTING TORQUE: 8 lb - ins. max

DCR - .01Ω max.

MAX. SOLDER TEMPERATURE 500°F

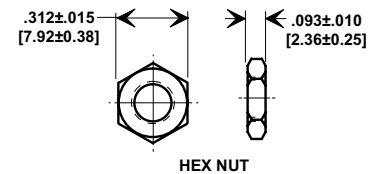
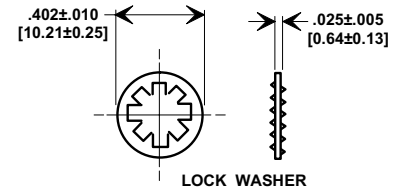

MIN. CAP (UF)	DWV (VDC)	I.R. MIN. @ 100 (VDC.)	WORKING VOLTAGE D.C.		CURRENT DC (AMPS.)	MIN. NO LOAD INSERTION LOSS (dB) @ 25°C PER MIL-STD-220					
			85°C	125°C		30 KHz	100 KHz	300 KHz	1 MHz	10 MHz	1 GHz
1.4	250	500 M	100	50	15	15	25	34	44	60	70

REVISION RECORD	Original Release C.O.	0	RDN TO COMP FMP. STYLE DWG SPLIT FOR EACH VAR. S.M. 06-20-02	TABLE REVISED	5	50 WVDC @ 125° WAS 70WVDC @ 125° L.E. 01-17-03	ADDED IR & DWV. SM 03-06-03	6	20030106-1-14	20030304-2-14	7
	--TOLERANCES-- Unless Otherwise Specified			Title COAXIAL BROADBAND - "L" HERMETICALLY SEALED							
	DECIMAL ±			Drawn S.M. 06-20-02			Scale 3 X				
	ANGLES ±			Approved J.Mc. 06-20-02							
TUSONIX TUCSON, ARIZONA		A	4601-054								

X-2015 Rev-0