

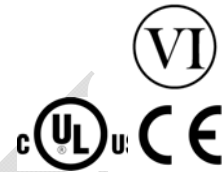

18W, 12V Wall Mount Adapter



Features

- DOE Level VI Efficiency Compliant¹
- EU CoC Tier 2 Compliant²
- Non-vented/Spill-proof Case
- Class B EMI

Applications

- Networking
- Peripherals
- Portable Equipment
- Test and Measurement

Safety Compliance

- UL62368-1¹
- CE²
- IEC62368-1

Mechanical Characteristics – US Models

- Length: 72mm(2.83in)
- Width: 34mm(1.34in)
- Height: 69mm(2.72in)
- Weight: 170g(6oz)

Mechanical Characteristics – EU Models

- Length: 72mm(2.83in)
- Width: 34mm(1.34in)
- Height: 90mm(3.54in)
- Weight: 170g(6oz)

Output Specifications

Model	Prong Style	Output Voltage	Max Current	Output Power	Regulation	Ripple & Noise ³ p-p(max)
PPL18A-120	US	12V	1.6A	19.2W	± 5 %	120mV
PPL18E-120	EU	12V	1.6A	19.2W	± 5 %	120mV

Notes:

1. PPL18A-120 model
2. PPL18E-120 model
3. 20MHz bandwidth frequency oscilloscope, add a 0.1µF multilayer Cap. and Low ESR Electrolytic Cap. (10µF) at output connector terminals (nominal line voltage, full load)

Input:**AC Input Voltage**

100 to 240VAC

AC Input Frequency

50 to 60Hz

Input Current

0.48A max.

Leakage Current

<0.25mA

Inrush Current50A max/100VAC; 60A max, 230VAC
(Cold Start at 25°C, full load)**Input Power Saving**≤0.1W at 115VAC & 230VAC, no load for
Level VI
≤0.075W at 230VAC, no load for CoC Tier2**OUTPUT:****Efficiency²**DOE Level VI³
CoC V5 Tier 2⁴**Over-Voltage Protection**

22V max

Short-Circuit ProtectionAuto-recover after short-circuit fault being
removed**Over-Current Protection**

5A max

ENVIRONMENTAL**Temperature**Operating 0°C to + 40°C
Non-operating -20°C to +80°C
Operating Humidity 20°C to 80%**Emissions**Complies with FCC Class B
Complies with EN55032 Class B**Dielectric Withstand (Hi-Pot) Test**Primary to Secondary: 3000VAC for 1 min,
10mA**Insulation Resistance**

Primary to Secondary: 10M ohm for 500 VDC

DC Cable Length

1500MM

DC Cable Type

20AWG

DC Output Connector

2.1mm x 5.5mm x 9.5mm

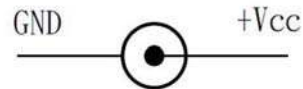
DC Plug pin assignment**Notes:**

1. The characteristics defined are at ambient temperature of 25°C unless otherwise specified
2. Efficiency is measured after 30 minutes burn-in
3. PPL18A-120 model
4. PPL18E-120 model

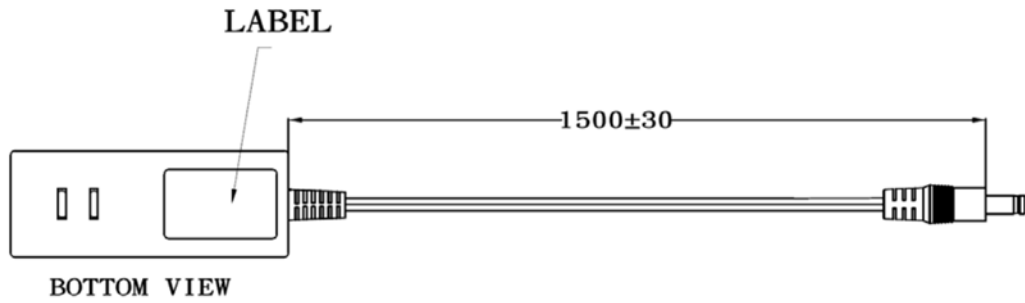
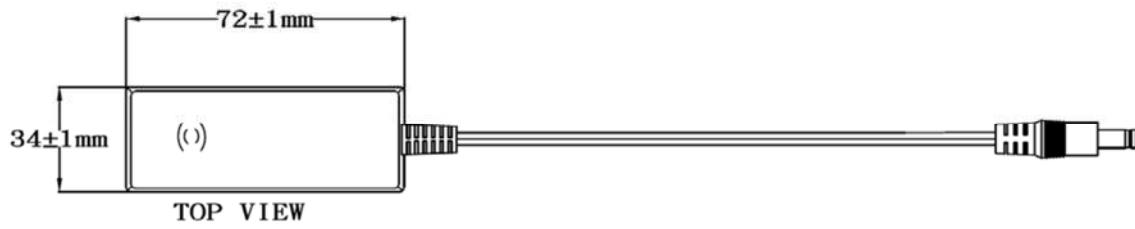
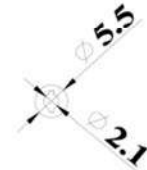
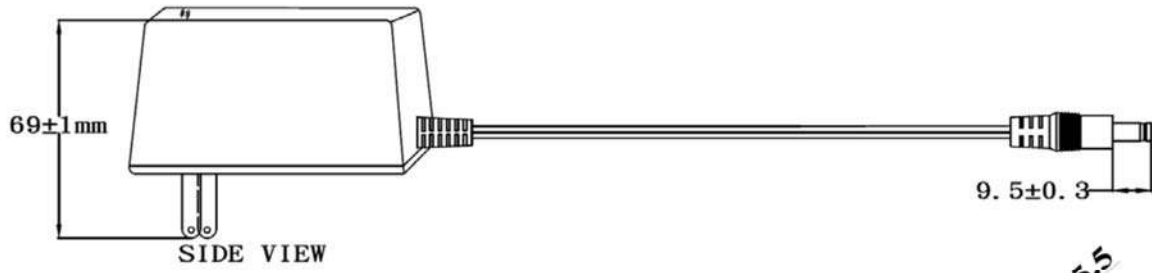

PPL

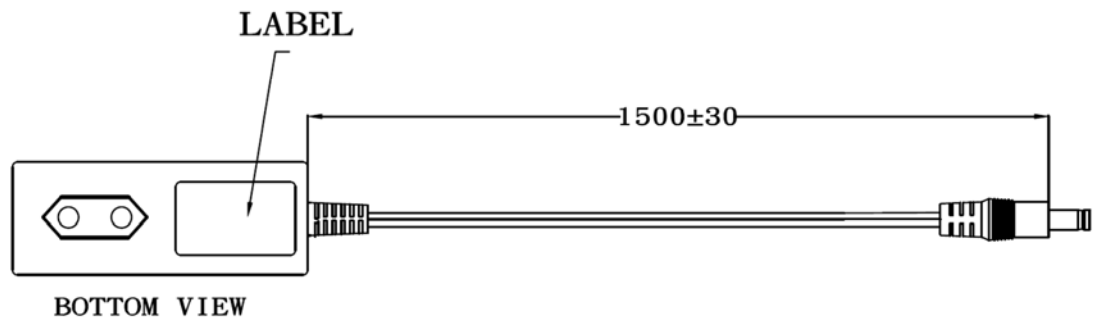
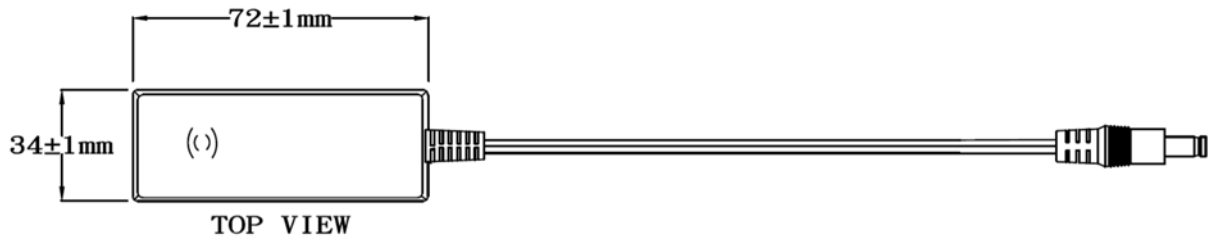
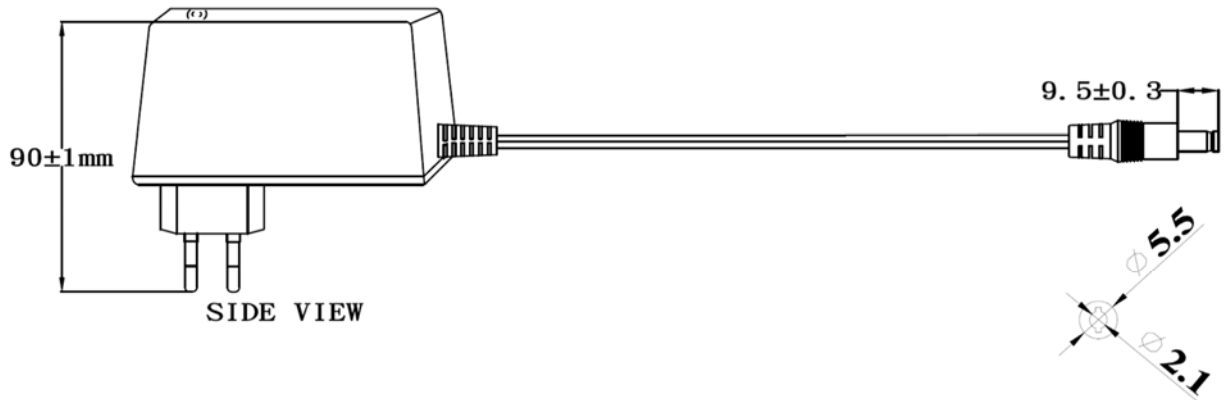

PK

**Supplier's Declaration of Conformity
47 CFR § 2.1077 Compliance Information**

PPL18A-120

Phihong USA Corporation
47800 Fremont Boulevard
Fremont, CA 94538
Telephone: (510) 445-0100
www.phihong.com

NOTE: This model has/The models in this product series have been tested and found to comply with the limits for a Class B digital device, pursuant to part 15 of the FCC Rules. These limits are designed to provide reasonable protection against harmful interference in a residential installation. This equipment generates, uses and can radiate radio frequency energy and, if not installed and used in accordance with the instructions, may cause harmful interference to radio communications. However, there is no guarantee that interference will not occur in a particular installation. If this equipment does cause harmful interference to radio or television reception, which can be determined by turning the equipment off and on, the user is encouraged to try to correct the interference by one or more of the following measures:

- Reorient or relocate the receiving antenna.
- Increase the separation between the equipment and receiver.
- Connect the equipment into an outlet on a circuit different from that to which the receiver is connected.
- Consult the dealer or an experienced radio/TV technician for help.

Changes or modifications to equipment not expressly approved by PHIHONG could void the user's authority to operate the equipment.