

# Commercial Grade Terminations

## Features

- Best combination of price and performance
- For general commercial use
- Up to 18 GHz operation
- Gold and tri-alloy plated brass construction
- SMA, N, TNC Male 2W average power

## Applications

- Cellular base stations
- Public safety systems
- Wi-Fi networks hardware
- Active antenna systems
- 5G network hardware
- GPS systems

## Part Numbers

Part Number	Termination Type	Frequency
CGT-1180-M0-SMA-09	SMA Male Termination	DC-18 GHz
CGT-1180-M0-NNN-34	N Male Termination	DC-18 GHz
CGT-1060-M0-TNC-34	TNC Male Termination	DC-6 GHz

## Specifications

### Electrical

Part Number	CGT-1180-M0-SMA-09	CGT-1180-M0-NNN-34	CGT-1060-M0-TNC-34
Frequency of Operation	DC-18 GHz	DC-18 GHz	DC-6 GHz
Impedance	50Ω (Nominal)	50Ω (Nominal)	50Ω (Nominal)
VSWR	1.20:1 (max.)	1.18 (max.)	1.25 (max.)
Input Power (at 25°C)	2W (CW)	2W (CW)	2W (CW)

### Materials and Finish

	CGT-1180-M0-SMA-09	CGT-1180-M0-NNN-34	CGT-1060-M0-TNC-34
Housing	Gold plated brass	Tri-Alloy plated brass	Tri-Alloy plated brass
Male Center Contact	Gold plated brass	Gold plated brass	Gold plated brass

### Environmental

Operating Temperature	-55°C to 85°C	-55°C to 85°C	-55°C to 85°C
-----------------------	---------------	---------------	---------------

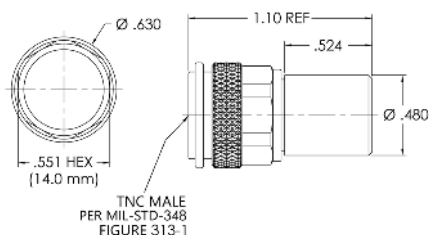
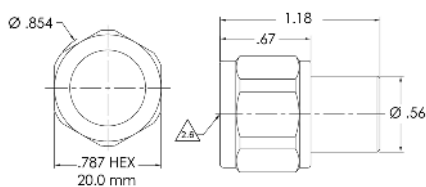
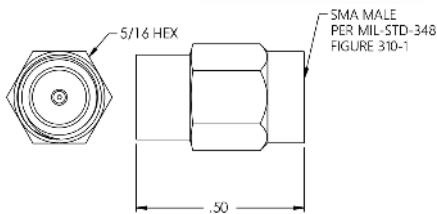
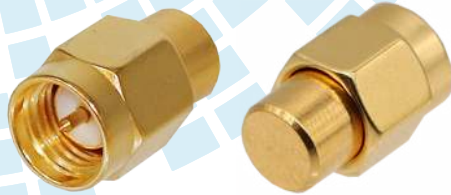

Asia Pacific  
+86 21 5442 7668  
ccs.asia.sales@as.cinch.com

Europe, Middle East & Africa  
+44 (0) 1245 342060  
cinchconnectivity@eu.cinch.com

North America  
+1 507 833 8822  
ccsorders@us.cinch.com

[belfuse.com/cinch](http://belfuse.com/cinch)