

Turned contacts Radsok contact 6mm for 16mm²

Part No. N02 060 6117 001

Series Contacts

Subseries Contact Turned contacts



COMMON CHARACTERISTICS

Wire gauge from		16
Wire gauge (AWG) from		6
Packaging / supplied as		Single contact
No. of pieces		1
Sex of Contact		Socket
Type of contact		Turned crimp contact

ELECTRICAL CHARACTERISTICS

Contact resistance	DIN EN 60512-2-1, Test 2a / IEC 60512-2-1, Test 2a	≤ 1 mΩ
--------------------	--	--------

Turned contacts Radsok contact 6mm for 16mm²

Part No. N02 060 6117 001

Series Contacts

Subseries Contact Turned contacts

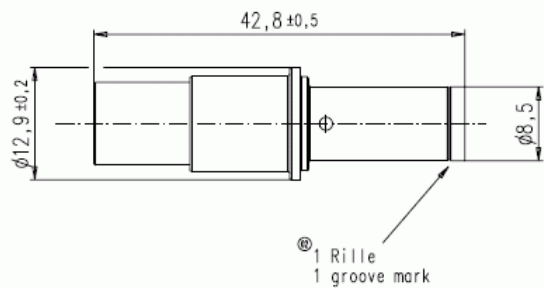

03.04.2012

Drawing Dimensions in mm (Inch)