

THIS DRAWING IS UNPUBLISHED. RELEASED FOR PUBLICATION
 © COPYRIGHT BY TYCO ELECTRONICS CORPORATION. ALL RIGHTS RESERVED.

LOC	DIST	REVISIONS					
AJ	16	P	LTR	DESCRIPTION	DATE	DWN	APVD
		E		PER EC 0S14-0180-04	06OCT2004	JGH	JGH

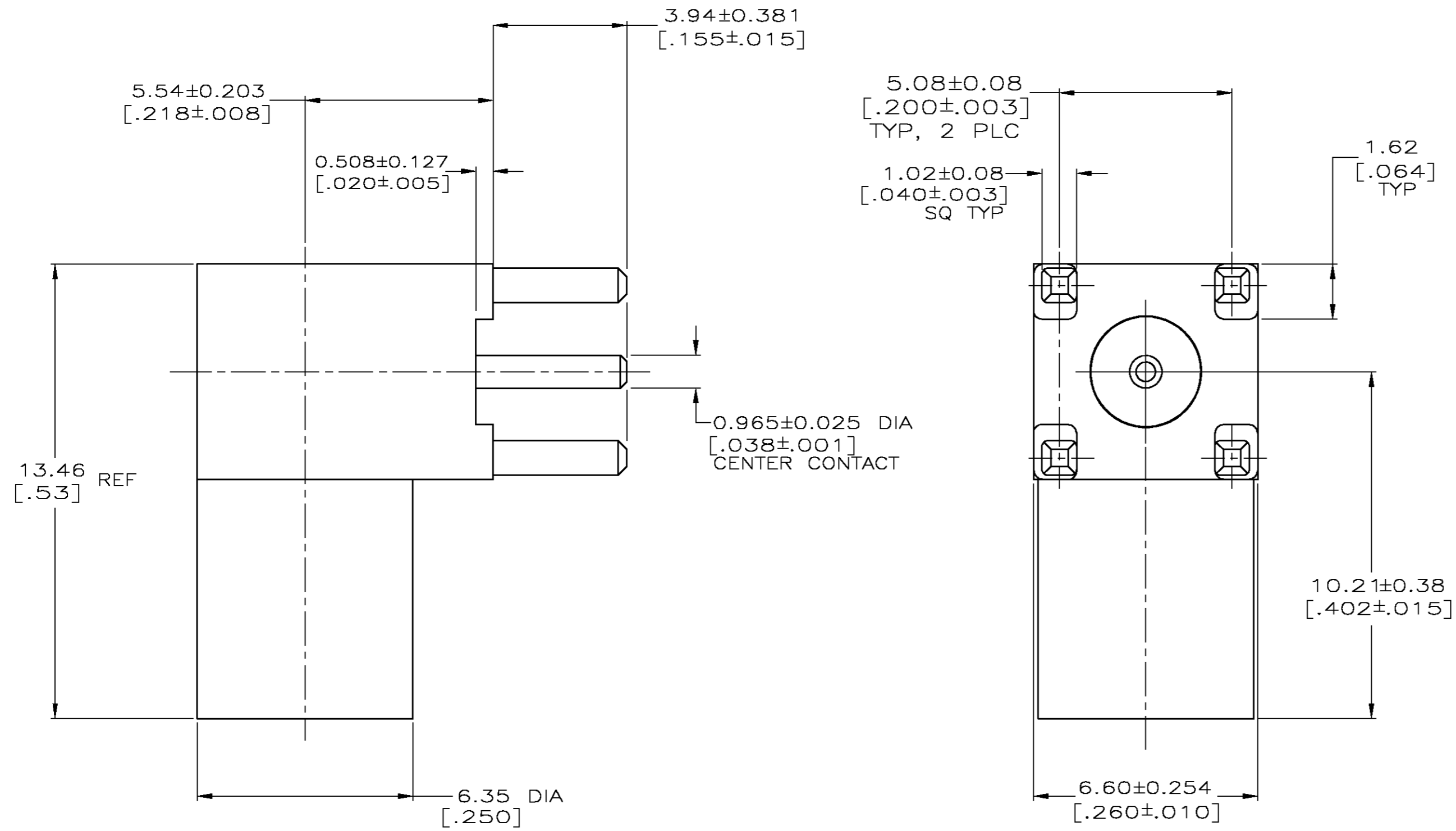

- 1 MATERIALS:
 BODY (LEG): ZINC ALLOY (ZAMAK 3)
 BODY (FRONT): BRASS PER QQ-B-626
 CENTER CONTACT: BRASS PER QQ-B-626
 INSULATORS: TEFLON PER ASTM-D-1710
 END CAP: BRASS PER QQ-B-626
- 2 FINISH:
 CENTER CONTACT: GOLD PLATE PER MIL-G-45204
 BODY (LEG): TIN PLATE PER ASTM-B-545
 BODY (FRONT): ELECTROLESS NICKEL
 PL PER MIL-C-26074
 END CAP: NICKEL PLATE PER QQ-N-290
3. INTERFACE PER MIL-C-39012

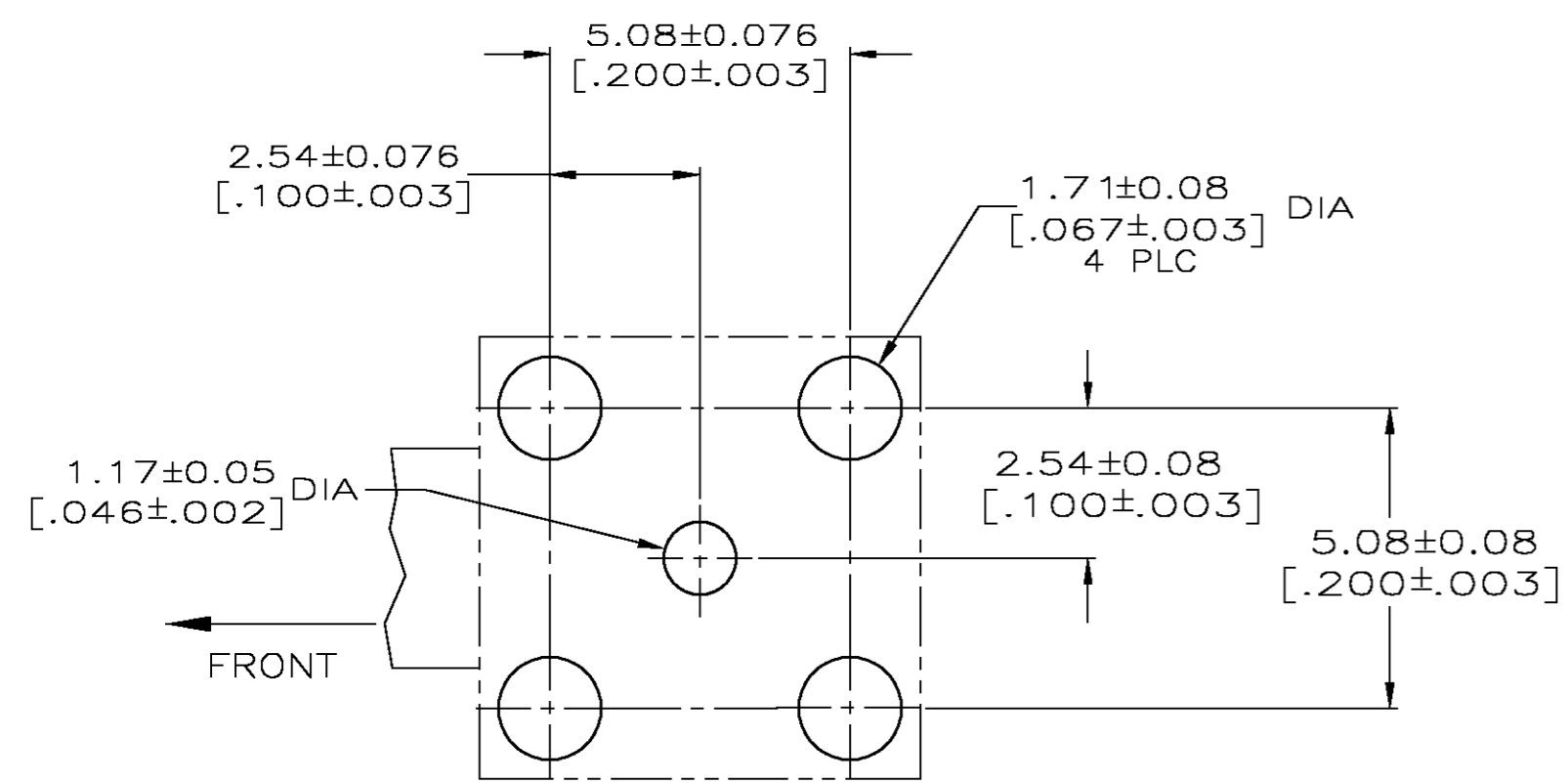

RECOMMENDED PCB CONFIGURATION

414338-1
 PART NUMBER

THIS DRAWING IS A CONTROLLED DOCUMENT.		DWN 3/10/92	Tyco Electronics Corporation Harrisburg, PA 17105-3608	
DIMENSIONS: INCHES		CHK G. MICHAEL 4/6/92	NAME PLUG, RTANG, SMB/PCB WITH KEYING LEG	
TOLERANCES UNLESS OTHERWISE SPECIFIED:		APVD G. MICHAEL 4/6/92	SIZE A2	CAGE CODE 00779
0 PLC ± -		PRODUCT SPEC	DRAWING NO C=414338	RESTRICTED TO
1 PLC ± -		APPLICATION SPEC	SCALE 8:1	SHEET 1 OF 1
2 PLC ± .25 [.010]		WEIGHT -	REV E	
3 PLC ± .13 [.005]				
4 PLC ± -				
ANGLES ± -				
FINISH				

414338

A