

LOC		DIST		REVISIONS			
AD	00	P	LTR	DESCRIPTION	DATE	OWN	APPD
		P		REVISED PER ECO-11-004835	11MAR11	RK	HMR

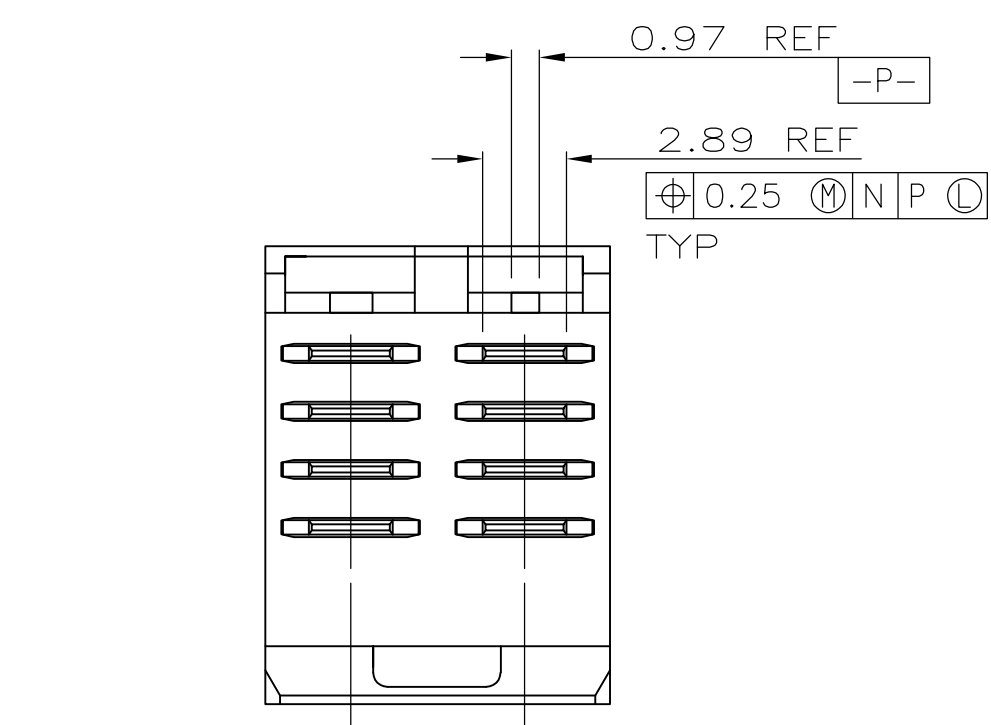

F SPACES @  
6.00 = G

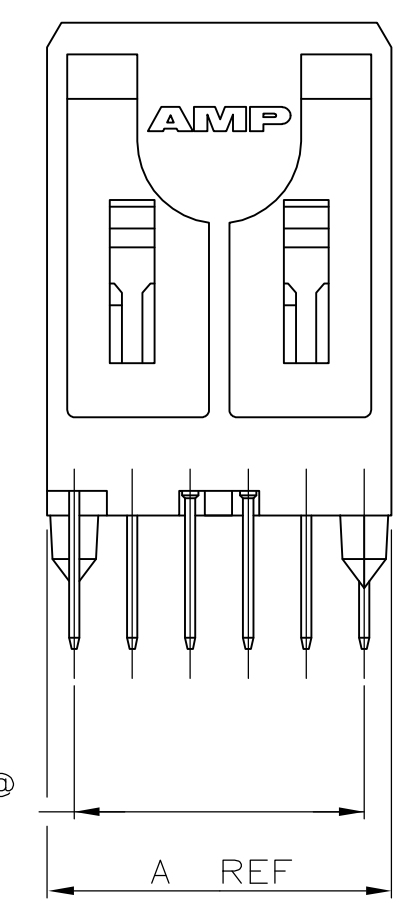

B SPACES @  
2.00 = C

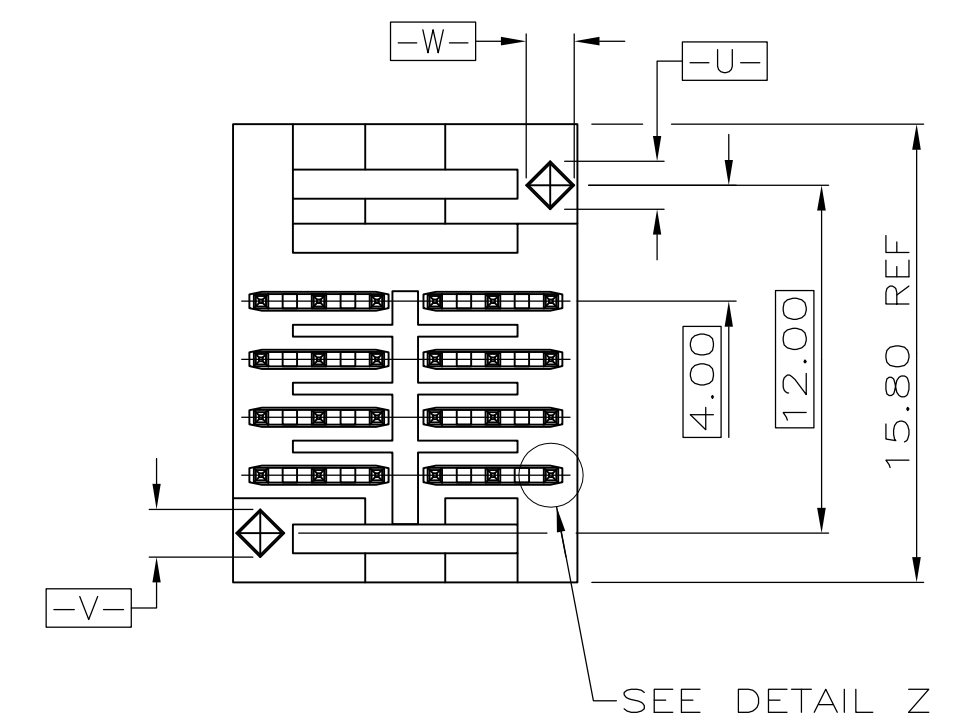

SEE DETAIL Z

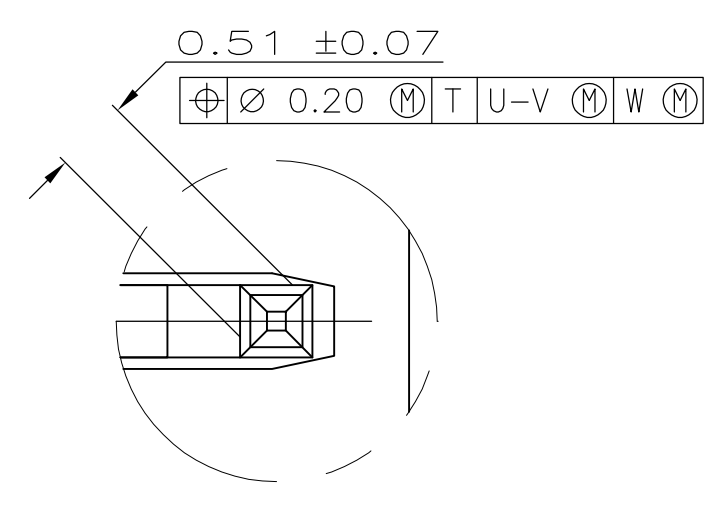
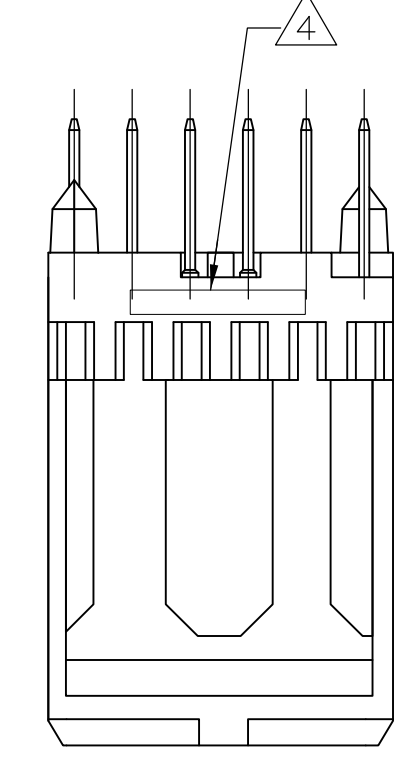

DETAIL Z  
SCALE 20:1

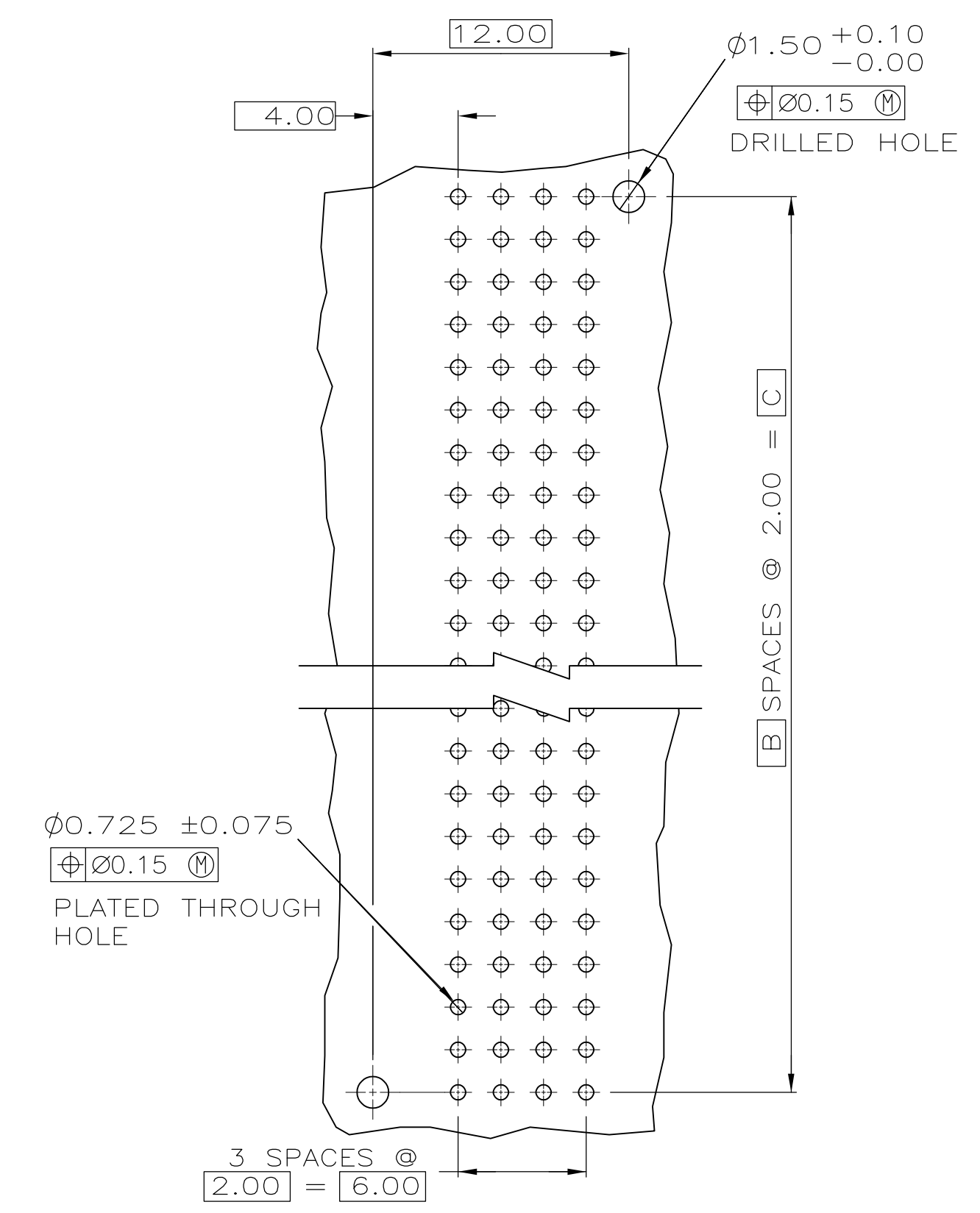

RECOMMENDED CIRCUIT PATTERN  
PER IPC-D300 TYPE II, CLASS C  
(COMPONENT SIDE)

- 1 HOUSING MATERIAL: LIQUID CRYSTAL POLYMER PER ASTM D5138 LCPO00 G30A 32250.
- 2 CONTACT MATERIAL: PHOSPHOR BRONZE PER UNS ALLOY NO. C51100, TEMPER: H04.
- 3 CONTACT FINISH:(E)  
UNDERPLATE (ENTIRE CONTACT):  
0.00127 MIN NICKEL PER SAE-AMS-QQ-N-290  
ON MATING SURFACES:  
FLASH GOLD PER ASTM B 488, OVER  
0.00076 MIN PALLADIUM-NICKEL OVER UNDERPLATE, OR  
0.00076 MIN GOLD PER ASTM B 488 OVER UNDERPLATE.  
ON LEADS:  
0.00381 MIN MATTE TIN PER ASTM B 545 OVER UNDERPLATE.  
LUBRICATION (MIN MATING SURFACES):  
SURFACE CONDITIONER AFTER PLATING.
- 4 PART MARKING, LOCATED APPROXIMATELY AS SHOWN.

6.00	1	4.25	6.50	10.00	5	11.83	3	8	5536600-1
G	F	E	D	C	B	A	FINISH	NO OF POSN	PART NUMBER

THIS DRAWING IS A CONTROLLED DOCUMENT.		OWN D.R.BENDER 08/11/92	CHK R.L.BENDORF 09/03/92	APVD -	NAME Z-PACK 2mm FB, POWER MODULE, PIN ASSEMBLY 2mm CL, 4 ROW, TABLED MATING & LEAD LENGTHS
DIMENSIONS: mm		TOLERANCES UNLESS OTHERWISE SPECIFIED:		PRODUCT SPEC -	APPLICATION SPEC -
0 PLG ± -		1 PLG ± -		SIZE A1	
2 PLG ± 0.13		3 PLG ± -		CAGE CODE 00779	
4 PLG ± -		ANGLES ± -		DRAWING NO C=5536600	
MATERIAL 1		FINISH 2		RESTRICTED TO -	
3		CUSTOMER DRAWING		SCALE 4:1	
SHEET 1		OF 1		REV P	